

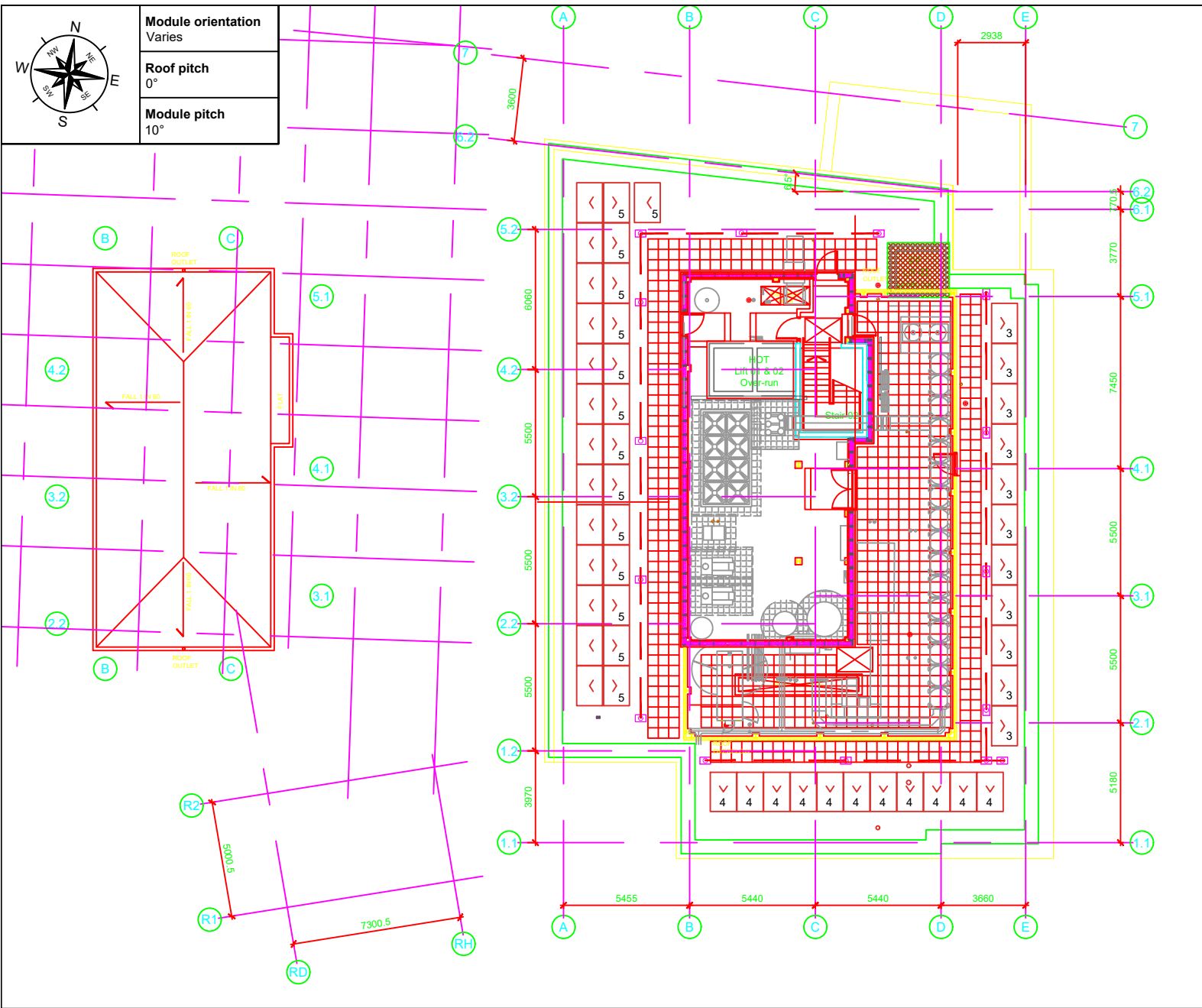

Module orientation
Varies

Roof pitch
0°

Module pitch
10°



Ballast & Weights	
East/West array	
Modules: 27 x 21.3kg = 575.1kg	
Mounting system (VdV Report) = 493N per peak	= 50.27kg x 13.5 peaks = 678.65kg
Ballast required (VdV Report) = 90kg x 13.5 peaks = 1215kg	
Ballast as 18kg blocks = 70 x 18kg = 1260kg	
Total Weight= 575.1kg + 678.65kg + 1260kg	= 2514kg
Portrait array	
Modules: 11 x 21.3kg = 234.3kg	
Mounting system (VdV Report) = 292N per module	= 29.78kg x 11 modules = 327.58kg
Ballast required (VdV Report) = 72kg x 11 modules = 792kg	
Ballast as 18kg blocks = 44 x 18kg = 792kg	
Total Weight= 234.3kg + 327.58kg + 792kg	= 1411kg
Landscape array	
Modules: 11 x 21.3kg = 234.3kg	
Mounting system (VdV Report) = 276N per module	= 28.14kg x 11 modules = 309.54kg
Ballast required (VdV Report) = 49.5kg x 11 modules = 544.5kg	
Ballast as 18kg blocks = 33 x 18kg = 594kg	
Total Weight= 234.3kg + 309.54kg + 594kg	= 1138kg
TOTAL qty of 18kg blocks	= 70 + 44 + 33 = 147

Notes

Roof surface
Blue roof - Gravel surface

Mounting system
ValkPro+ Ballasted system

Ridge / roof height
28m

Module qty & type
49 x Canadian Solar 410 Wp mono

PV peak output
20.09 kWp

Inverter qty and type
1 x SolarEdge SE16K 3ph + S440

Module length
1722mm

Module width
1134 mm

Module depth
30 mm

Site address
Vine Hill
London
EC1R 5LB

Drawing type
Ballast

Revision number
07

Scale
1:250 @ A4

Project reference
VINE4484

Drawn by
GP

Date
16/08/2023

Solstice energy

020 8789 4717
www.solsticeenergy.co.uk
Little Willow, Upper Anstey Lane GU34 4BP