

Lyndhurst House
Preparatory School



Key:

- Application Area
- Existing LP Main

Interest:

Belsize Court Properties Limited

Location:

Belsize Court, Wedderburn Road,
London, NW3 5QL

Coords: 526939, 185248

Scheme Name:

EP - Flats 14-24 Belsize Court, NW3 5QJ

Drawing Name:

Site Plan

Drawing No: 23010031_PLN_SI_3.1

Rev	Date	Description
-	13.10.2023	First Issue

Drawn:	LB
Approved:	DH/ES
Sheet No:	1 of 1
Sheet Size:	A4



Cadent
Your Gas Network

The information contained in this document is confidential and protected by copyright. The use, copying or disclosure to a third party, either wholly or in part, except with the written permission of, and in the manner prescribed by Cadent Gas Limited constitutes an infringement of copyright. Dalcour MacLaren does not warrant that this document is definitive nor free of error and does not accept liability for any loss caused or arising from reliance upon information provided herein. Although our best efforts have been made to ensure the accuracy of these plans, all measurements must be confirmed on site. BASED UPON THE ORDNANCE SURVEY MAP WITH THE SANCTION OF THE CONTROLLER OF HM STATIONERY OFFICE. CROWN COPYRIGHT RESERVED. OS LICENCE No. 100024896

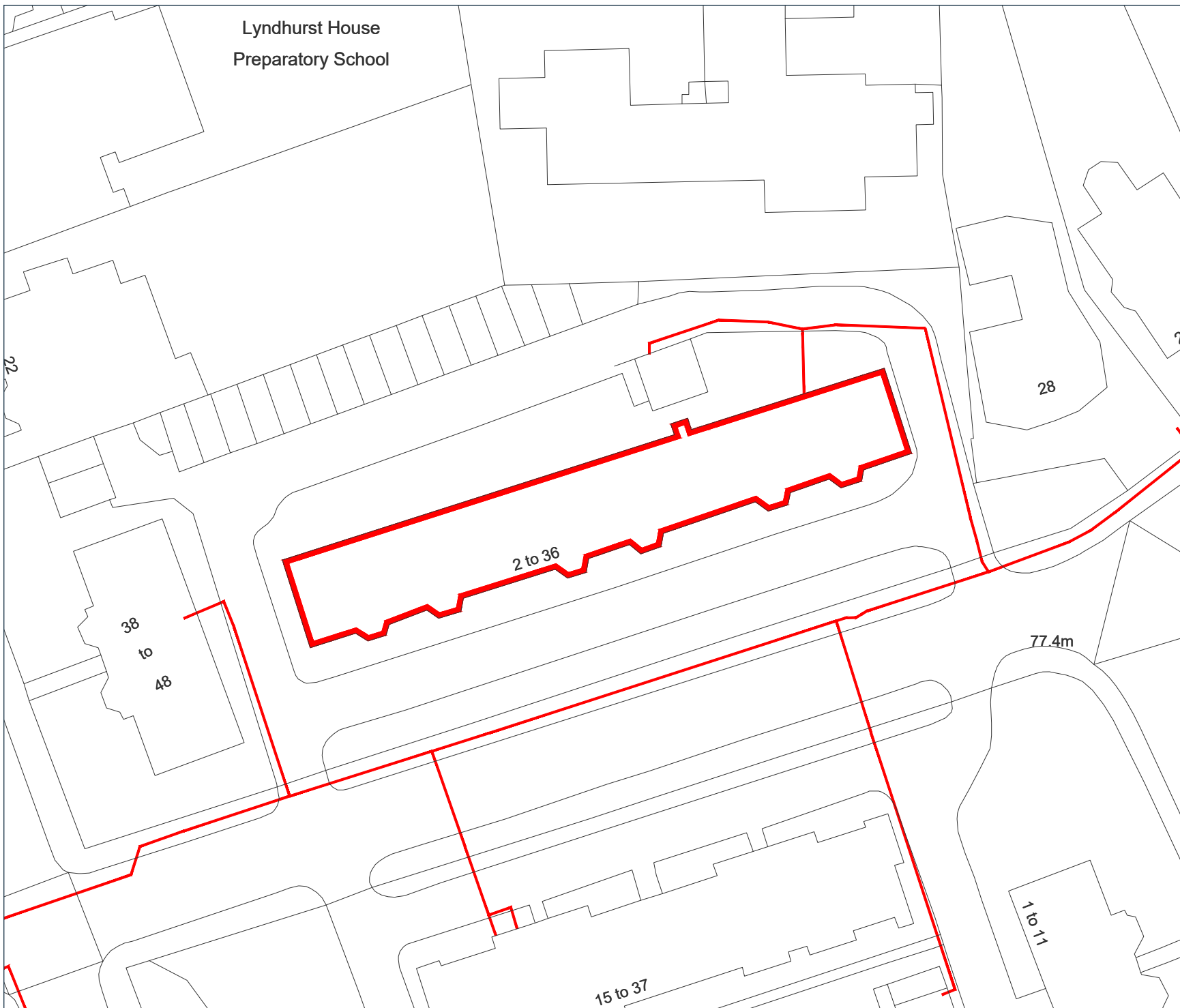

Site Plan



Scale 1:500