

KEY

IMPERIAL HOTEL OUTLINE

PLANT AREA SUBMITTED AS PART OF ADJACENT PLANNING APPLICATION REFERENCE: 2019/2766/NEW

SOURCES:

Survey supplied by Maltby Surves. Original data received April 2018, with updates October 2018 and March 2019.

Landscape proposals received by Indigo Landscape Architects Ltd on 15th Sep 2023.

Planning Application Area

GIFA - 1586.9 m<sup>2</sup>

CORRESPONDING APPROVED PLANNING DRAWING (REF: 2019/2985/P):

1289 - P1052 - A-Proposed First Floor Plan

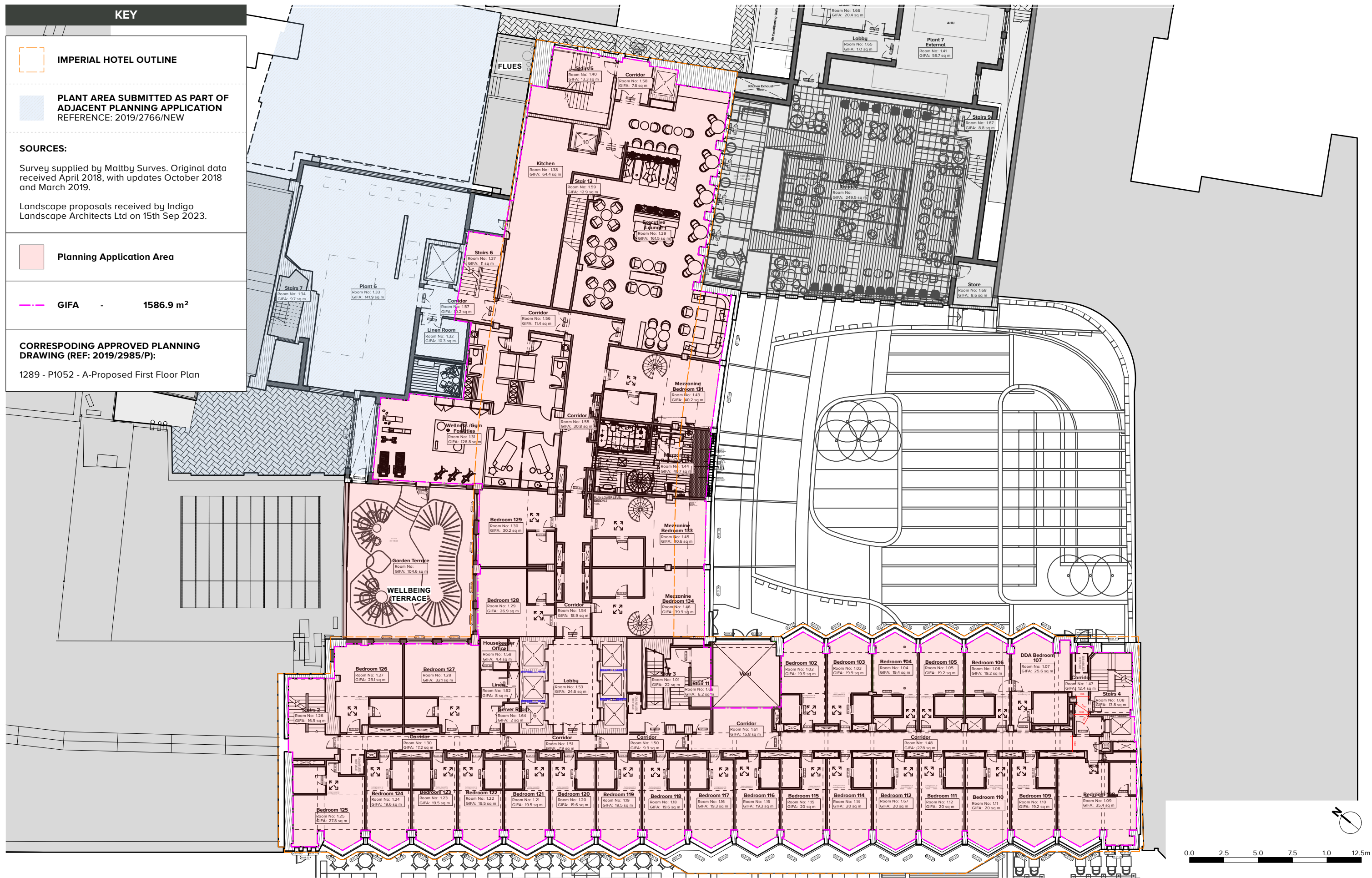

Revisions: A VL JLS 01/11/2023 Initial issue.

PLANNING

scale 1:250 @ A3 date 19/10/2023  
drawn VL checked JLS

1417-P002 (A)

www.cube-designltd.co.uk

T: 01425 481 999

cube\_design ©