

- Roadway and kerbs re-aligned to suit new layout.
- New pick up point/taxi layby
- Re-located minicab booth
- Continuous homogenous surface of 600x600mm paving slabs to match Planning Application Number 2021/0911/P
- New Cycle stands
- Proposed office development as per Planning Application Number 2021/0911/P under planning
- Existing ramp to basement car park.
- Concrete wall to be demolished, proposed bollards
- Cleaned existing concrete slabs
- Existing relocated trolley grid, to suit proposals under Planning Application Number 2021/0911/P. Any damage to ground under removed trolley grid to be repaired / made good - to match existing surrounding ground surface.
- Layby area for buses retained.
- New cycle stands
- Continuous homogenous surface of 600x600mm paving slabs as per Planning Application Number 2021/0911/P

- Hard landscaping to be continued to entrance area.
- Wall finish to match existing external facade
- New customer lift, bespoke car required to fit existing shaft and lift pit (1600kg / 21 persons)
- New fire escape door
- New travellers, 11.5° pitch with transition curve; travellers to be fitted into existing pit.
- Glazed balustrade extended to suit new traveller
- Area for approx. 69 trolleys @245t and 104 trolleys @101t.
- Trolley 'cattle grids' to be kept as existing.

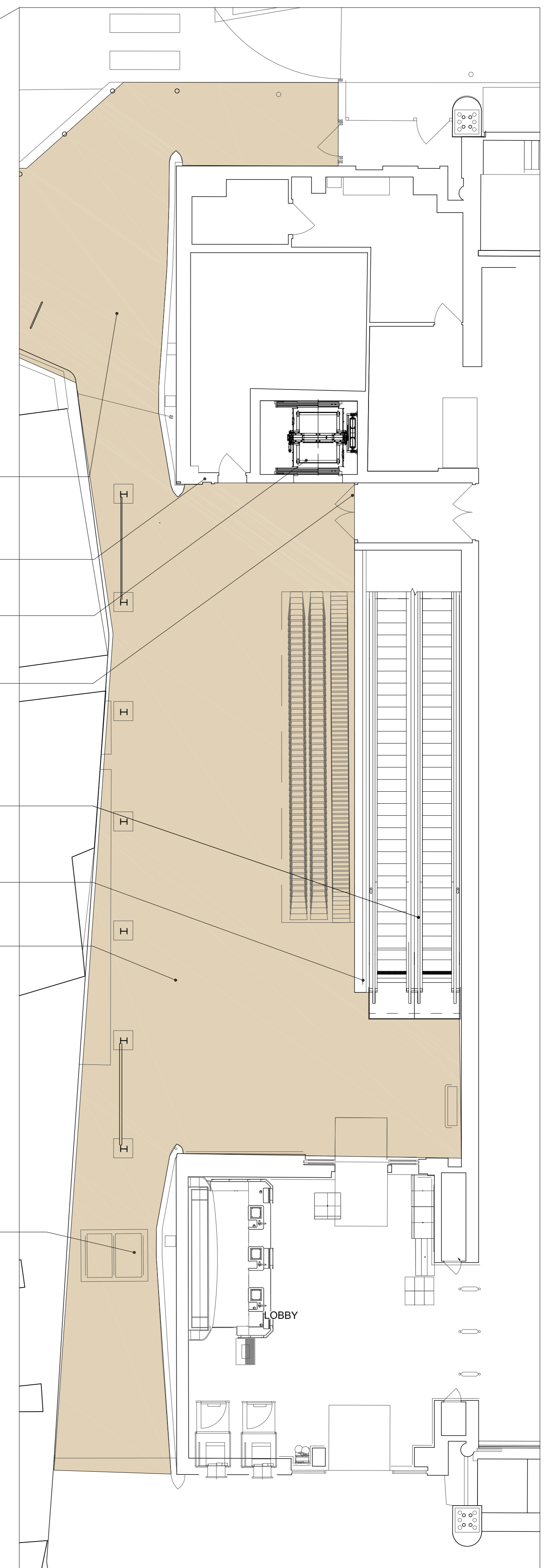

Entrance Area @ 1:100

PLANNING

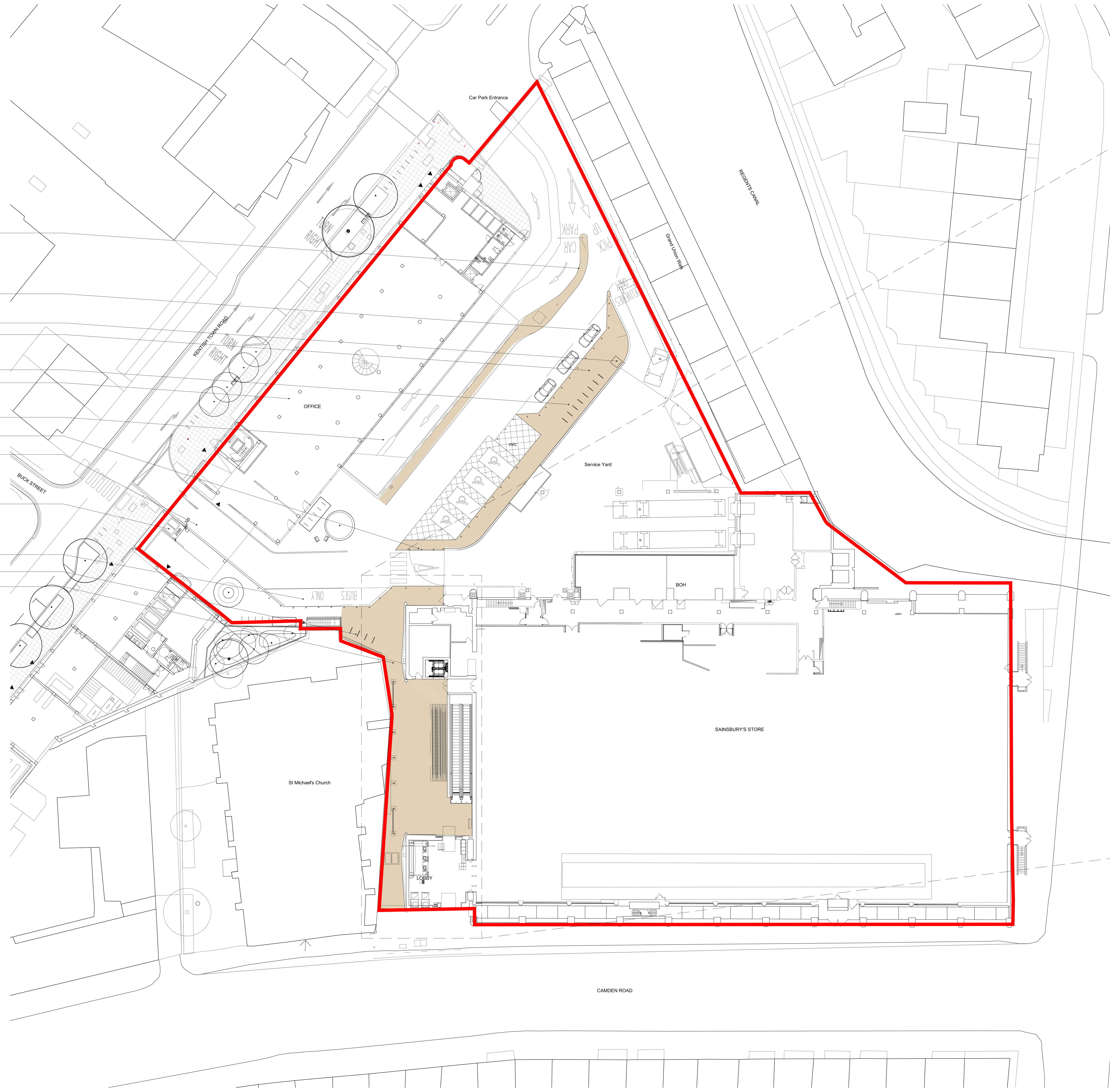

P5	03/11/23	Issued for Planning - dimensions added to Kentish Town Road trolley grid.	EG
P4	28/09/23	Issued for Planning - Trolley cattle grids reinstated / relocated.	AV
P3	31/07/23	Issued for Planning - Trolley parking bay relocated	UM
P2	14/06/23	Issued for Planning - Site boundary amended	BF
P1	19/02/23	Issued for Planning	BF
REV	DATE	NOTES	INT

**PLANNING**

**SP STEVE RITCHIE PARTNERSHIP Limited**  
 25 Links Yard, Spelman Street, London, E11 5LX  
 T: 0202 371 3662 e: info@steveritchiepartnership.co.uk  
 www.steveritchiepartnership.co.uk

J&H  
**SSL Z2LoR, CAMDEN ROAD, CAMDEN, LONDON**  
 drawing site location  
**Proposed Ground Floor Plan**

drawn by	checked	scale	status
AV	EG	1:200 @ A0	PLANNING
Project	drawing no.	revision	
17027	AP 0010 102	P5	

client  
**Sainsbury's**  
 33 HOLBORN, LONDON, EC1N 2HT, ENGLAND, T. 0207 695 6000  
 © 2019 Steve Ritchie Partnership Limited

