

Architectural plan of Block C, showing a brown roof with a PV array, pipe runs, and biodiversity features. The plan includes a central vertical red line and a horizontal blue line. Key features and labels include:

- Block C**: Large title at the top center.
- Grid Lines**: C.10, C.11, C.12, C.13, C.14, C.15, C.16, C.17, and C.A.
- Roof Features**:
 - pipe runs**: Multiple horizontal lines across the roof.
 - PV array**: A large rectangular area in the center.
 - Roof access hatch**: Located near the top right.
 - Roof access**: Located near the bottom right.
- Structural Elements**:
 - Uplift Over-run**: Two locations, one near the top left and one near the top right.
 - Services**: Located near the center.
 - Roof access**: Located near the center.
- Biodiversity Features**:
 - Brown Biodiverse Substrate area seeded**: Located near the bottom left.
 - Biodiverse Brown roof with Icopal type habitat pack item to encourage biodiversity.**: Located near the bottom right.
- Maintenance Access**:
 - Maintenance access / Circulation zones to BM spec/detail**: Two locations, one near the top center and one near the bottom center.
- Other Labels**:
 - davits to building**: Located near the top left.
 - Roof access**: Located near the center.
 - Roof access**: Located near the bottom right.

Block C - seeded areas - 157m2
 Biodiverse Brown roof. - Seeded with Bauder Urban
 Flora 5 seed mix osap (35g/m2)
 Seeded on Bauder substrate system for biodiverse
 /brown roofs osap. - lightweight substrate to BS8616.
 75mm- 125mm undulating thickness to give varying
 habitats. average 100mm depth.
<https://www.bauder.co.uk> - OSAP system

Block C - unseeded areas - 84m2
 Biodiverse brown roof - bare soil to naturally colonize -
 extensive roof system
 Bauder substrate system for biodiverse /brown roofs
 OSAP - lightweight substrate to BS8616. 75mm- 125mm
 undulating thickness to give varying habitats. average
 100mm depth.
<https://www.bauder.co.uk> - OSAP system

Total roof area = 1135m² inc roof equipment - biodiverse roof area 241m² = 22% of total area

Allow for area to be irrigated using hosepipe via roof tap. Approx area: 38m².

Irrigation by hosepipe to maintain roof area only for use in drought periods to prevent total plant failure.

All roof build ups to B+M/PAM details and specification including soil/substrates. Where necessary seeding to be adapted to fit final system all to manufacturers warranties

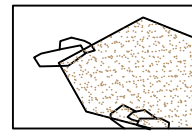

Ballast access surface around plant and pipework with concrete paving slabs (on pads) where more frequent access required to BM/Cfield, specialist contractor specifications

Roof Level - Habitat Pile Zones
Icopal Habitat of Zone Pack (osap) or equal approved mix of stone, sand, rope and logs to attract and support a range of invertebrate and birds and encourage biodiversity - supplied as a bulk bag to create 4 habitats. (1. Rocks, 2.Logs, 3.Sand, 4.Rope.)
All to architects and engineers final position and loading approvals. Icopal • web:
www.icopal.co.uk • email: info.uk@icopal.com
osap

- Maintenance Plan for vegetated area
- Check safety of all surfaces
- Clear up any debris
- Inspect all drainage and gutters
- Remove any weeds / unwanted growth e.g. budleja
- Repeat planting / seeding as necessary
- In periods of drought water to prevent plant failure
- Notify management co. of any issues.

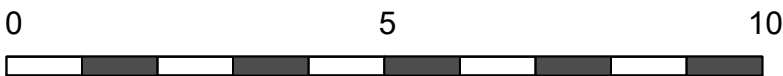
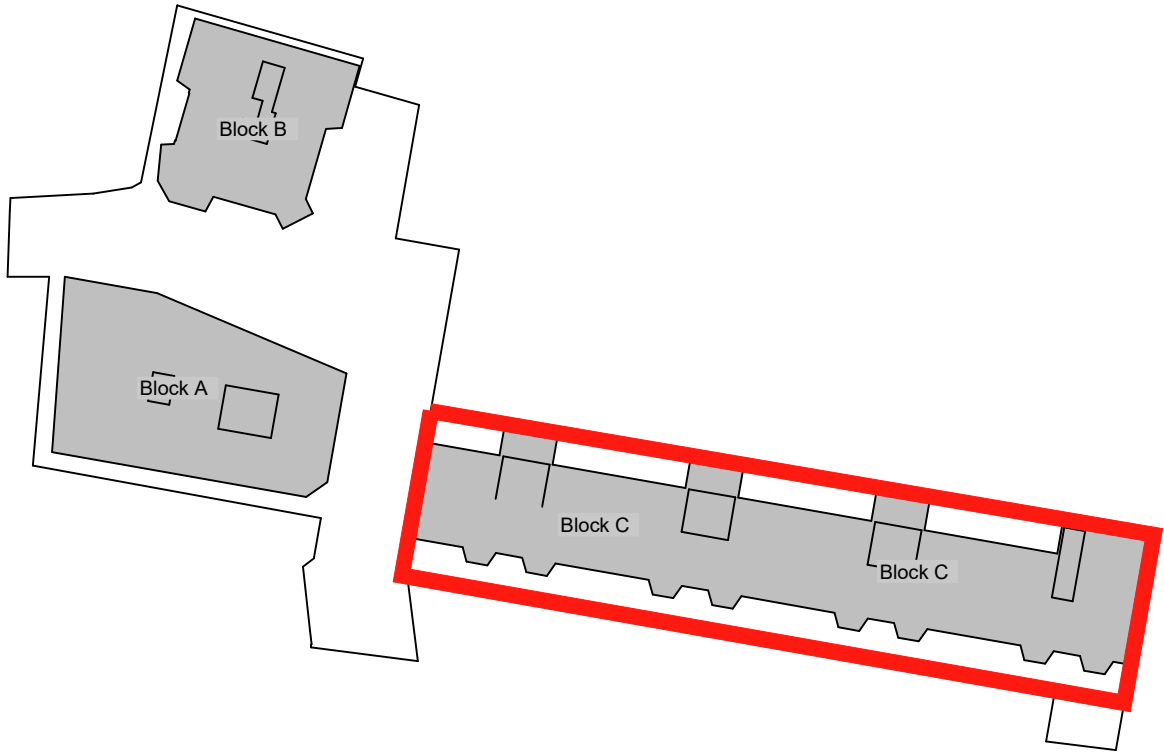

D	additional seeded areas added to C Field markup	CN	12.09.23
C	ballast edging strip added	CN	17.08.23
B	latest BM roof added to layout	CN	11.08.23
A	latest BM roof added for planning	CN	21.07.23
REV.	DESCRIPTION	APP.	DATE

T 020 70171786

NT

Liddell Road

Planting Plan Detail
Block C – Biodiverse brown roof

DATE	20.07.23	DRAWN	KK
SCALE	var@A1	CHECKED	NT
STATUS	Stage 4	APPROVED	NT
DWG. NO	D0461_060	D	

©Neil Tuffy Associates