

GROUND FLOOR PLAN - EXISTING

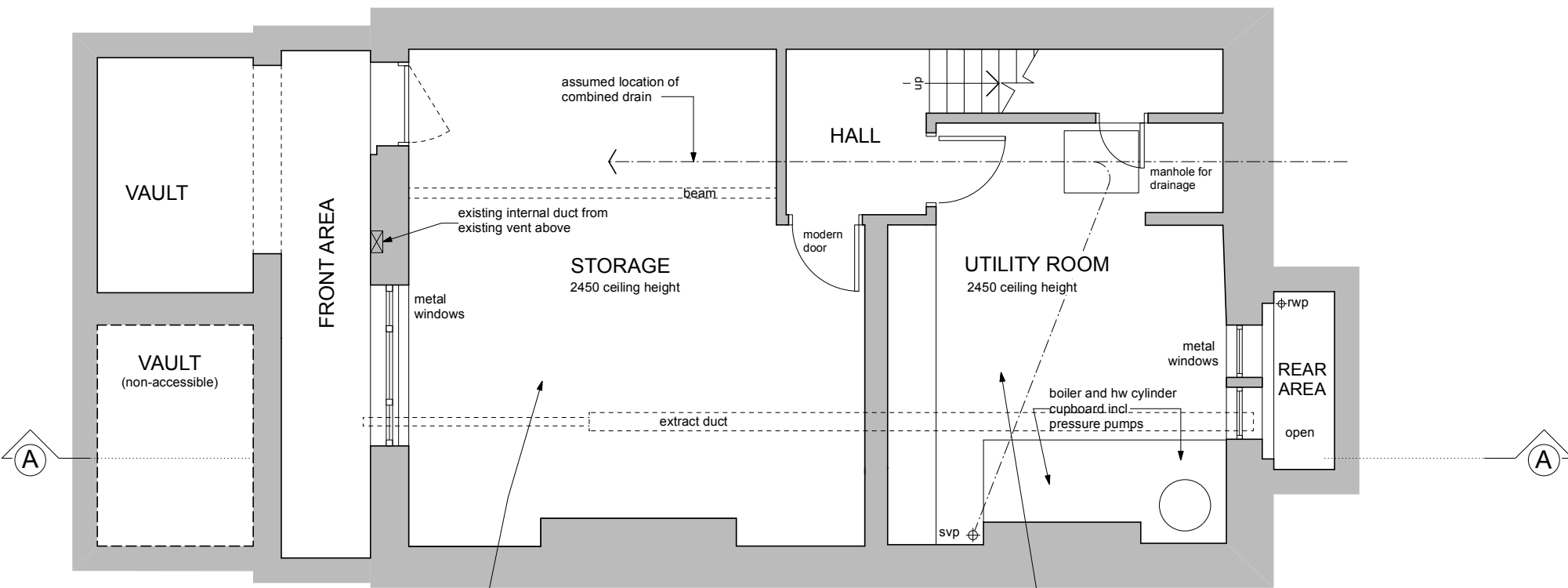

BASEMENT - EXISTING

Floor of basement has been waterproofed as follows: cavity membrane drainage system, overlaid with 25mm insulation, 75mm heated screed with carpet over in storage room and tiles in utility



BROD WIGHT
Architects
8a Baynes Mews --- London --- NW3 5BH

11 POND STREET
LONDON NW3

www.brodwight.co.uk office@brodwight.co.uk
Tel 020 7722 0810 This drawing is copyright

Drawing Title:
**EXISTING GROUND FLOOR
AND BASEMENT PLANS**

Drawing Ref:
1039-AP9-03A

Date July 2023 Scale 1:50 @ A3

