

EXISTING ROOM ELEVATION - F.07 BEDROOM SHEET 1 OF 2
NO.15 BONNY STREET - FIRST FLOOR

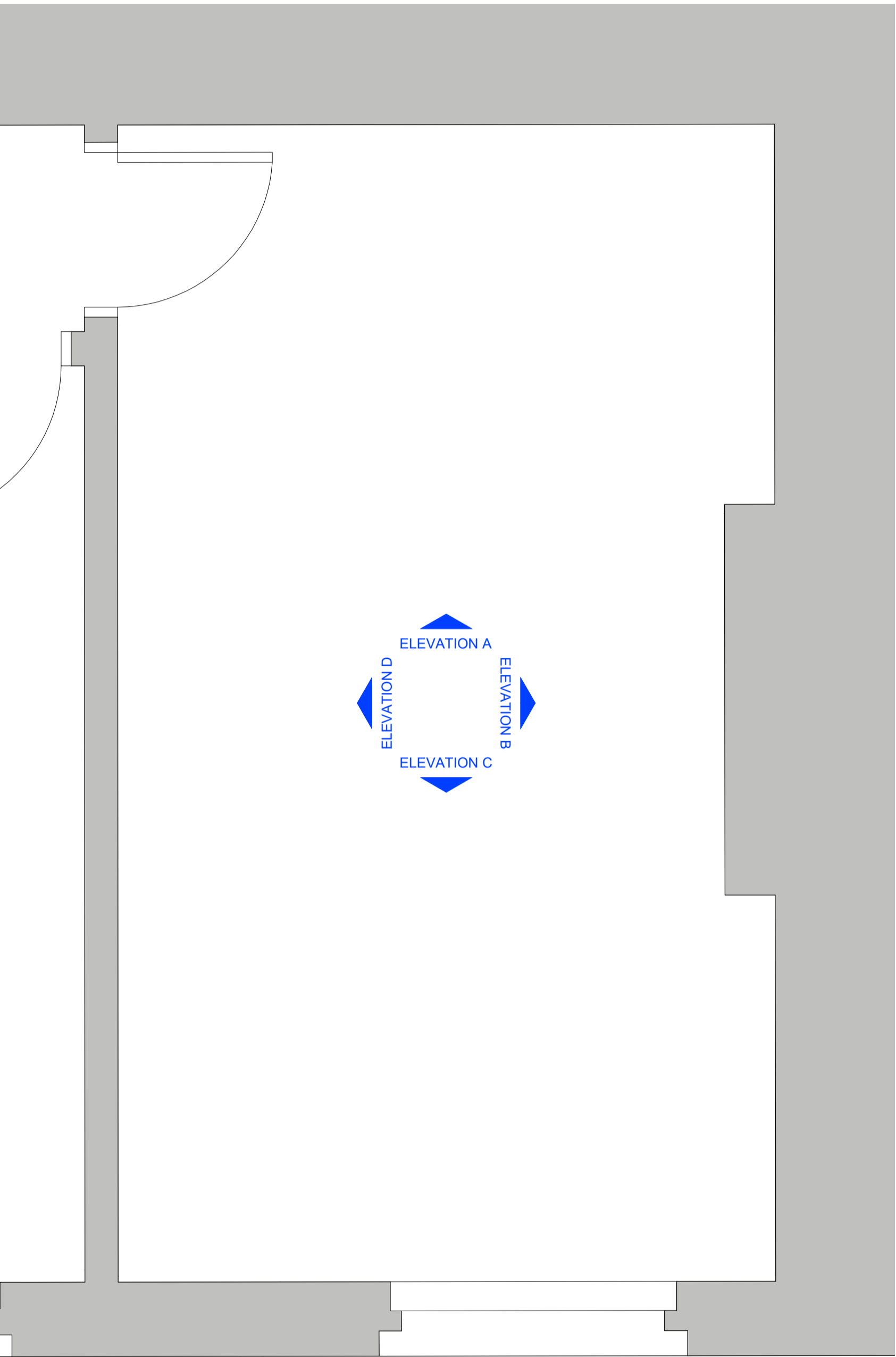

0 PLAN
SCALE 1:20 @A1, 1:40 @A3

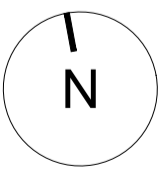

SCALE
1:20 @A1
1:40 @A3

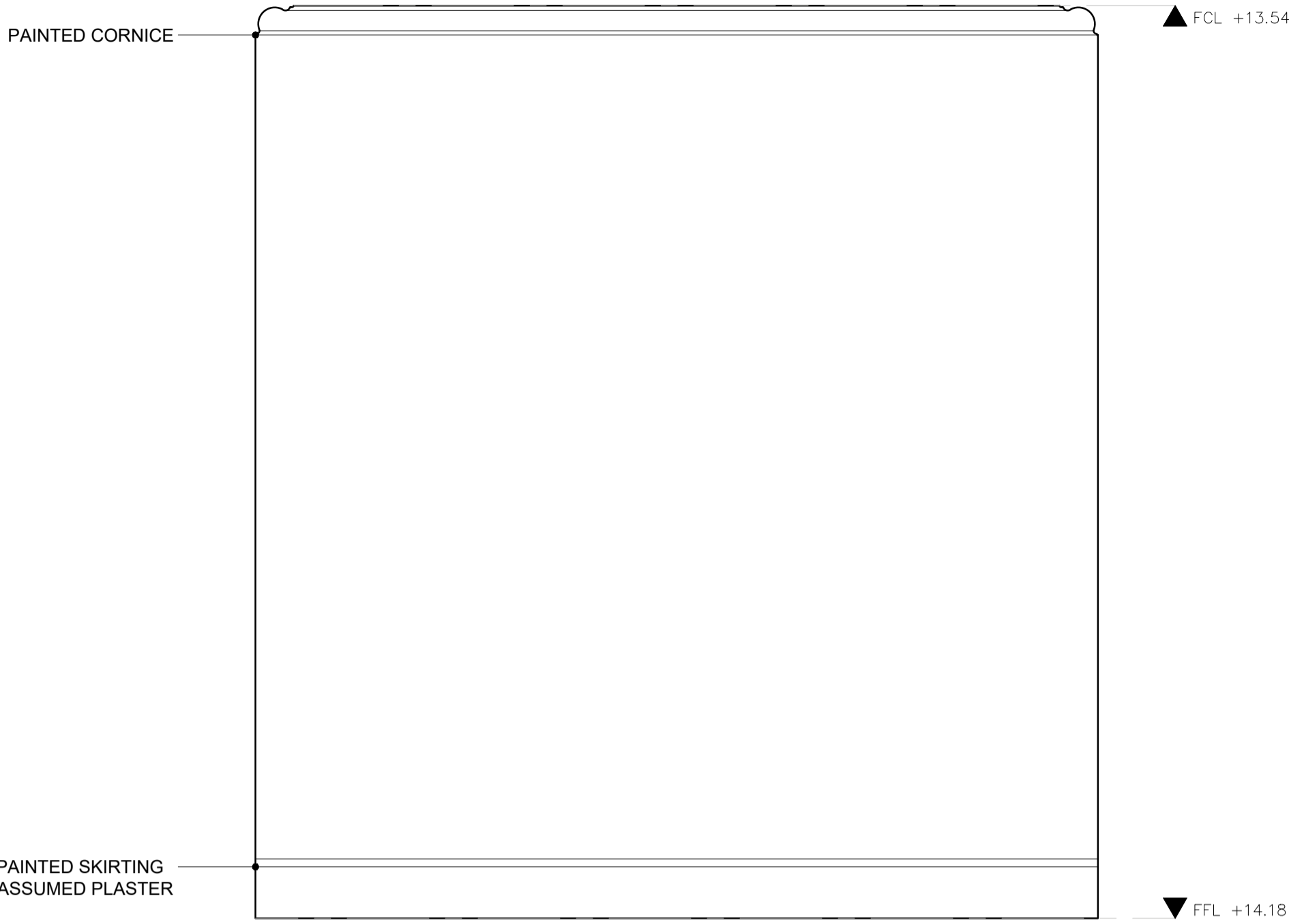
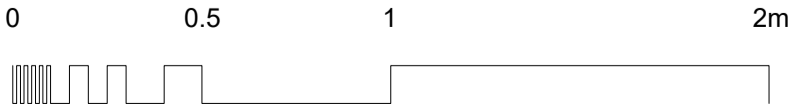

1 ELEVATION A
SCALE 1:20 @A1, 1:40 @A3

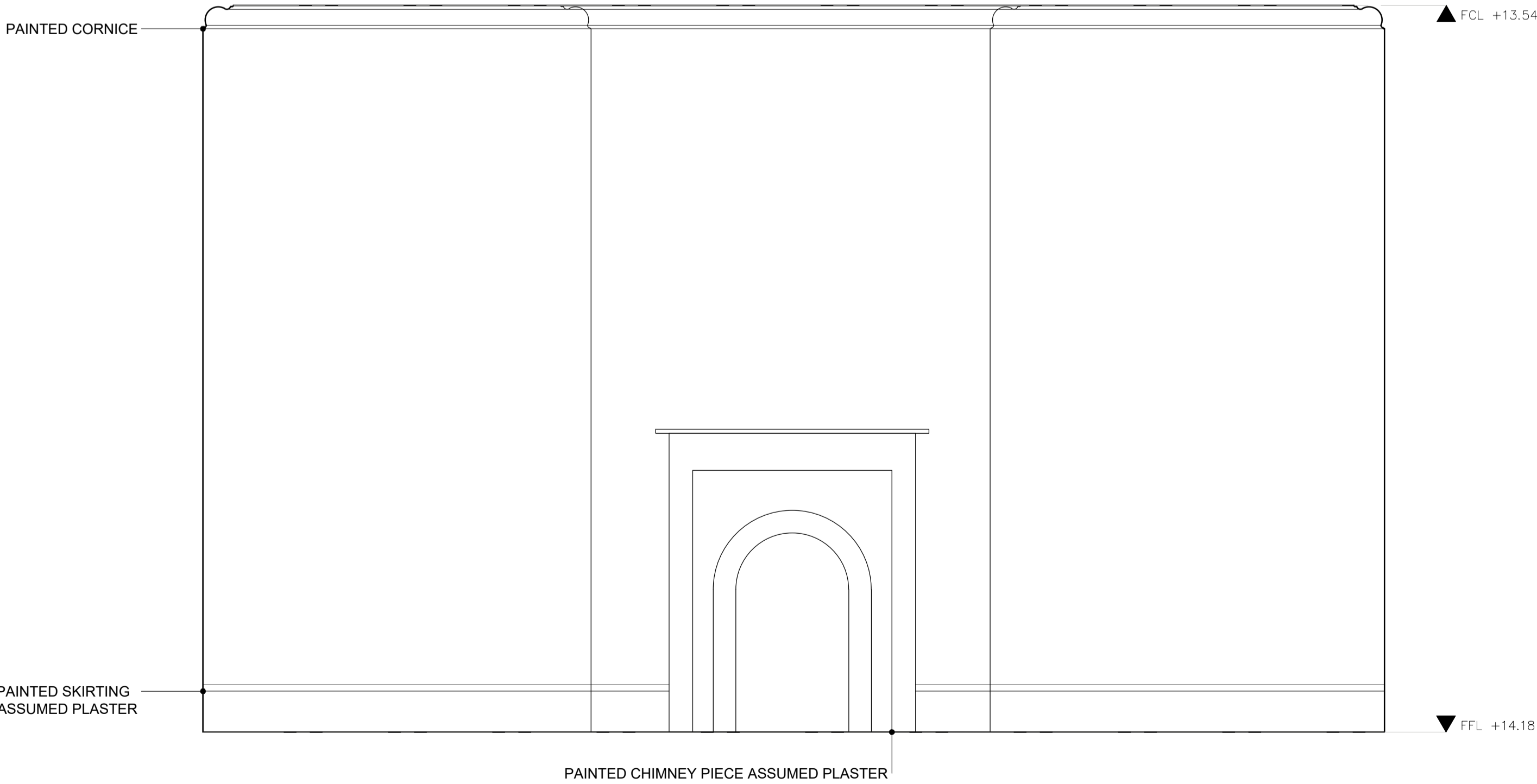

2 ELEVATION B
SCALE 1:20 @A1, 1:40 @A3

PLEASE NOTE:

FOR CONSTRUCTION PURPOSES USE FIGURED DIMENSIONS ONLY. THIS DRAWING IS TO BE READ IN CONJUNCTION WITH ALL RELEVANT PROJECT INFORMATION. ALL DIMENSIONS MUST BE CHECKED ON SITE PRIOR TO THE COMMENCEMENT OF WORKS. PLEASE REPORT ANY DISCREPANCY TO THE ARCHITECT OR CONTRACT ADMINISTRATOR.

| | | | |
|------|------------|----------------|-----|
| P1 | 03/10/2023 | First Issued | AM |
| Rev: | Date: | Revision note: | By: |

prime
BUILDING
CONSULTANTS LTD

Maidstone Innovation Centre,
Suite 44.45 & 46,
Glids Pond Way,
Maidstone, Kent, ME14 5FY

T 01622 692249
E pbc@primebc.co.uk
W www.primegrouppltd.co.uk

| SURVEYORS ARCHITECTS PLANNERS | | | |
|--|-------------------|------------------------|-----------------|
| Project: 13 & 15 BONNY STREET, NW1 9PE | | | |
| Client: THE ARCH COMPANY | | | |
| Title: EXISTING INTERNAL ELEVATION - F.07 BEDROOM SHEET 1 OF 2 | | | |
| Purpose of issue: PLANNING / LBC | | | |
| Drawing number: 014.2429-042 | | Revision: P1 | |
| Scale: 1:20 | Paper Size: A1 | Date: 09/2023 | Drawn By: AM |
| Copyright © Prime Building Consultants Limited. Do not reproduce without written permission. | | | |