

Do not scale from this drawing.
 Check drawing on receipt and immediately report any discrepancies to the Architect.
 Verify all dimensions and levels on site prior to construction.
 The contents of this drawing are Piercy&Company copyright and shall not be re-used without their written permission.

Notes

SPECIFICATION TAGS
 xxx-xxx Refer to FMD Specification
 xxx-xxx Refer to P&Co Specification

Refer to FMD Specification for Precast, Curtain Walling and Window & Doors performance specification
 For all facade pressings, sealant, flashings, associated elements etc, refer to FMD specifications and the systems descriptions/relevant clauses for the external wall type. Refer to signage consultants information for external signage design intent.
 Refer to 21-100 - 21-104 scoping set for Facade Types
 Refer to 04 series for CW Scoping Types
 Refer to 22-100 for opening vent and Door Types
Refer to Door, Ironmongery and operation schedule for further information.
External door operation and power/automation requirement under review. Sub contractor input required. All door hardware is indicative pending input - manufacturer to advise on shoot bolt suitability

Waterproofing
 Vapour Barrier

| | | |
|--------------|--|--------|
| P03 09.10.23 | Planning Issue - Discharge of conditions | KC |
| P02 16.01.23 | Stage 4 - Employer's Requirements Issue | TM |
| P01 14.12.22 | Stage 4 - Issue for Tender | TM |
| Rev Date | Description | Issued |

Piercy&Company

Piercy&Company
 39 Plender Street
 London NW1 0DT
 T +44(0)20 74249611
 info@piercyandco.com
 www.piercyandco.com

Client
DERWENT LONDON

Project
**THE NETWORK BUILDING
 95-100 Tottenham Court Rd.**

Drawing Title
**Terrace Door Threshold &
 Thermal Break Level 08**

| | | |
|-----------------|-------------|------------|
| Drawing Status | Drawing: MS | Revision |
| PLANNING | Checked: KC | P03 |

Date: 09.10.23
 Scale @ A1: 1 : 5
 Scale @ A3: 1 : 10

Drawing No.
13538-PCO-XX-XX-DR-A-21-641

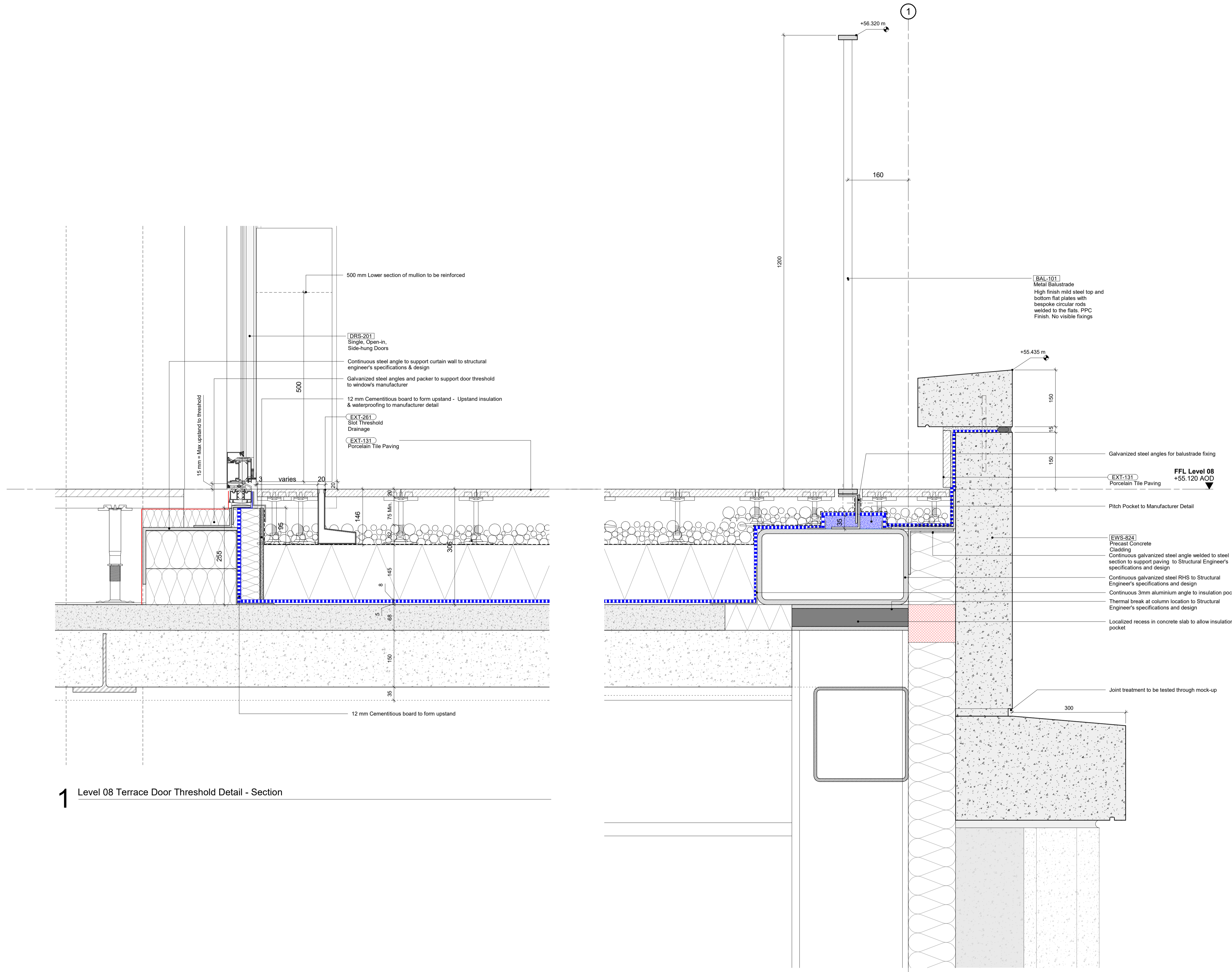

1 Level 08 Terrace Door Threshold Detail - Section

2 Level 08 Thermal Break Upstand Detail - Section