

© Copyright Rock Townsend Architects LLP
 All dimensions to be checked on site prior to commencement of works
 Rock Townsend Architects LLP to be notified of any omissions or errors
 THIS DRAWING IS NOT TO BE SCALED
 SETTING OUT - NOTE FOR CONTRACTOR
 It is the responsibility of the contractor to check all setting out information (levels, dimensions, co-ordinates, etc.) indicated on this drawing for the whole of the works prior to commencement of the works and record the results on a copy of this drawing. Rock Townsend Architects LLP shall be notified of any discrepancies and no work shall be commenced until further instructions are received in writing.

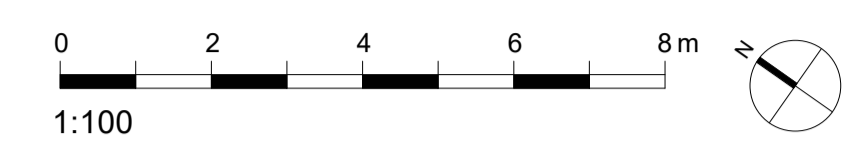

- Please ensure printed at 100% for A1 or 50% for A3
- Existing (Blue lines & hatches)
 - Demolition (Red lines & hatches)
 - New (Black Lines & hatches)
 - Client Supply Furniture
 - CHR demise
 - Outside of scope
 - Demolish floor finishes
 - Demolish floor and slab
 - Skirting Board to be removed

- NOTES**
 For Floor Finishes refer to drawing no. 35001
 For partition and wall types refer to drawing no. 26001.
1. Rooflight
 2. Big Steps
 3. New Roof Finish
 4. Contractor to make good water damage to plasterboard at top of courtyard.
 5. New glazed handrail

REVISIONS	DATE/DRAWN
P1 Planning Note	21/09/23 TR
ST4_T Tender	12/07/23 NV
ST4_F STAGE 4 FINAL ISSUE	16/06/23 NV
ST4 STAGE 4 DRAFT PLANNING	23/05/23 OR
ST3_F STAGE 3 ISSUE	10/03/23 OR
ST3 STAGE 3 DRAFT	24/02/23 OR
ST3 STAGE 3 DRAFT	22/02/23 OR
PR3 PRE APP	13/01/23 OR
PR2 STAGE 2 ISSUE UPDATE	09/11/22 TR
PR1 STAGE 2 ISSUE	04/11/22 TR

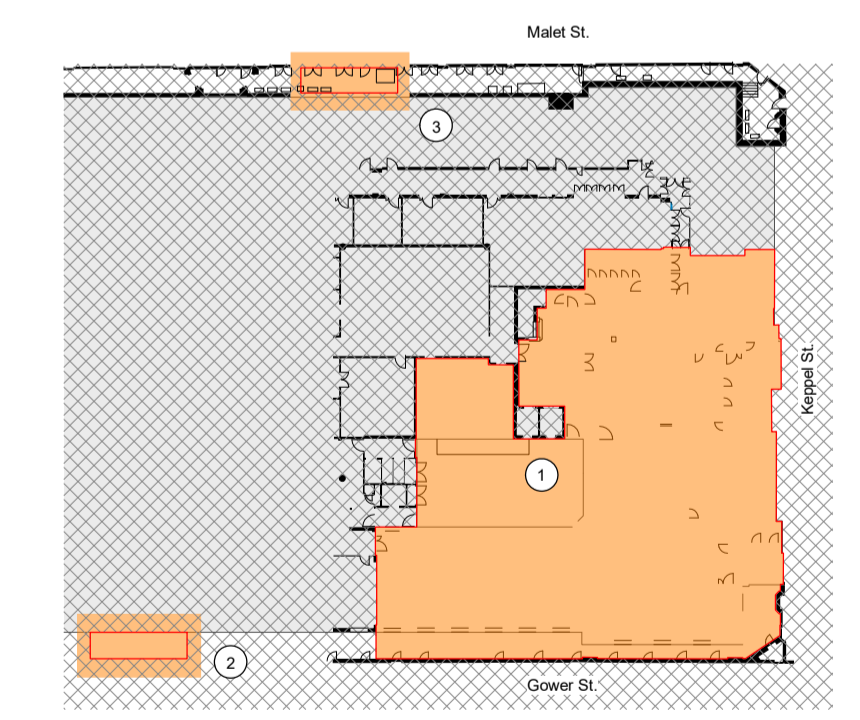

Key Plan

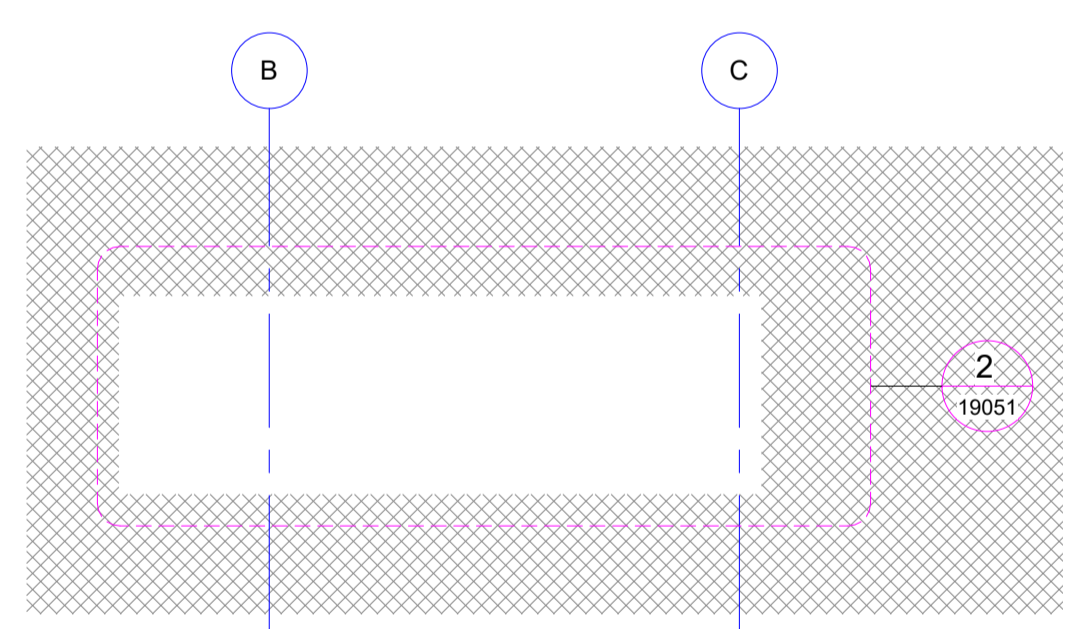
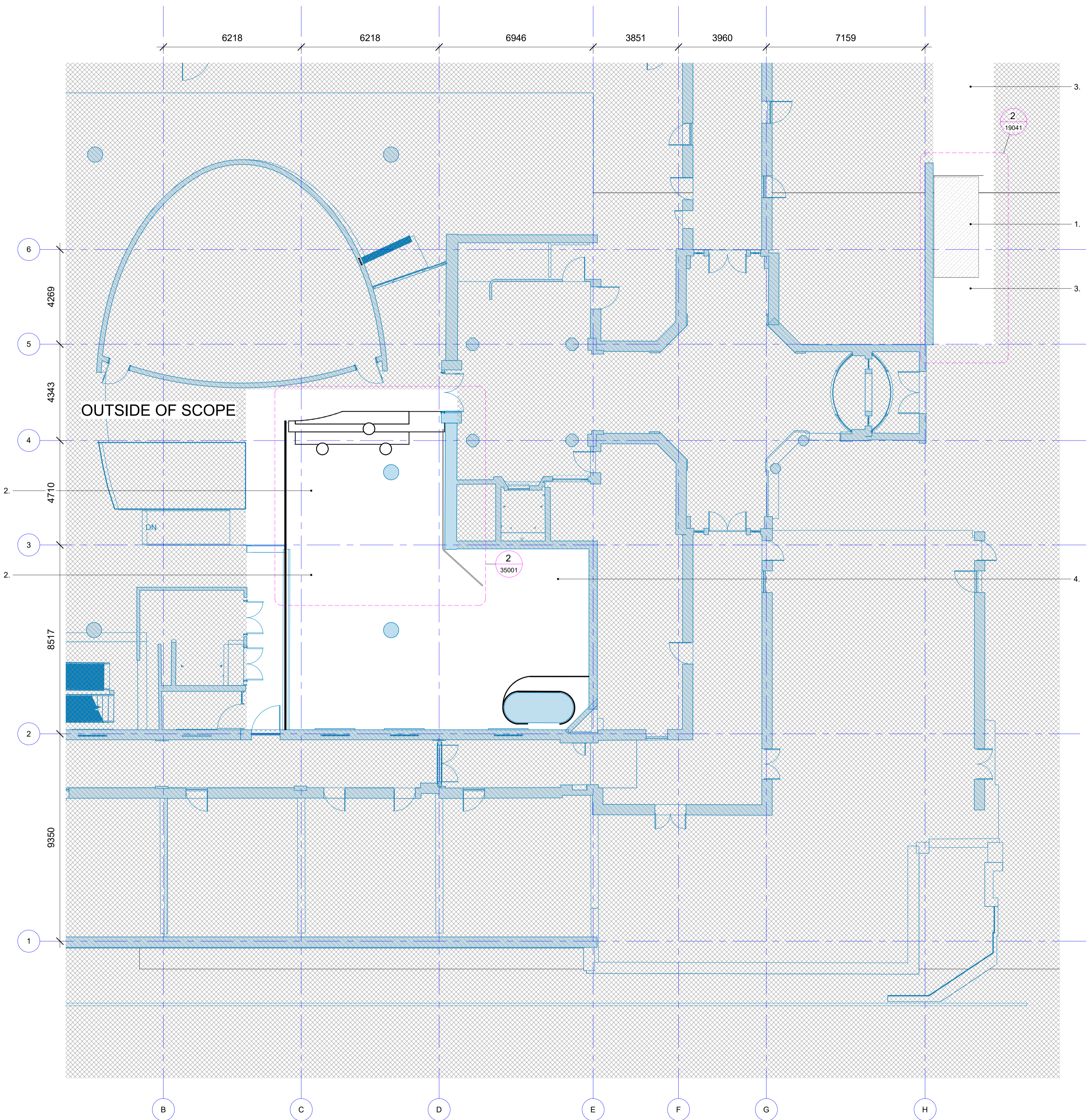

3 Proposed - Ground Malet Street Escape
1:100

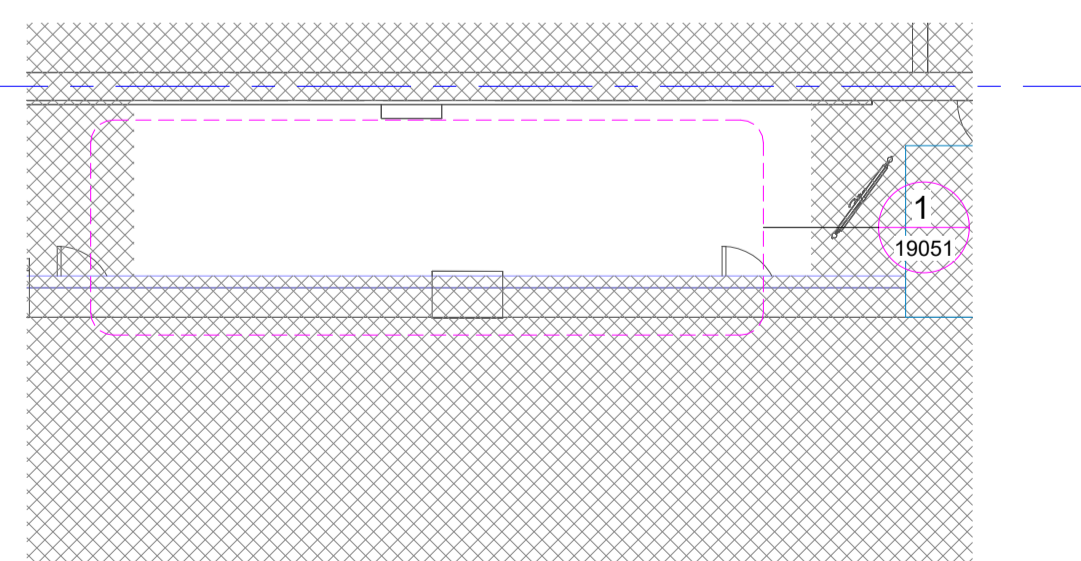

2 Proposed - Ground Gower Street Escape
1:100

1 Proposed GA - Ground Floor
1:100

PROJECT LSHTM Social Space KS3D
 Keppel Street, WC1E 7HT

DRAWING TITLE Proposed GA Plan
 Ground Floor

DATE OCT 22 DRAWN PP
 SCALE As indicated @ A1 CHECK

STATUS STAGE 4

RT JOB NO. RT22042 REVISION P1

DRAWING NO. PH3D-RTA-XX-G-DR-A-00406

Rock Townsend
 The Old School, Eton Street, London, SE1 8JL
 020 7261 9577
 rocktownsend.co.uk