

Report all discrepancies, errors and omissions
 Do not scale from this drawing
 Verify all dimensions on site before commencing any work or preparing shop drawings.
 All materials, components and workmanship are to comply with all the relevant British Standards, Codes of Practice and appropriate manufacturers recommendations that from time to time shall apply.
 For all specialist work, see relevant drawings.
 This drawing and design are copyright of PELLINGS LLP

0 1 2 3 4 5 metres

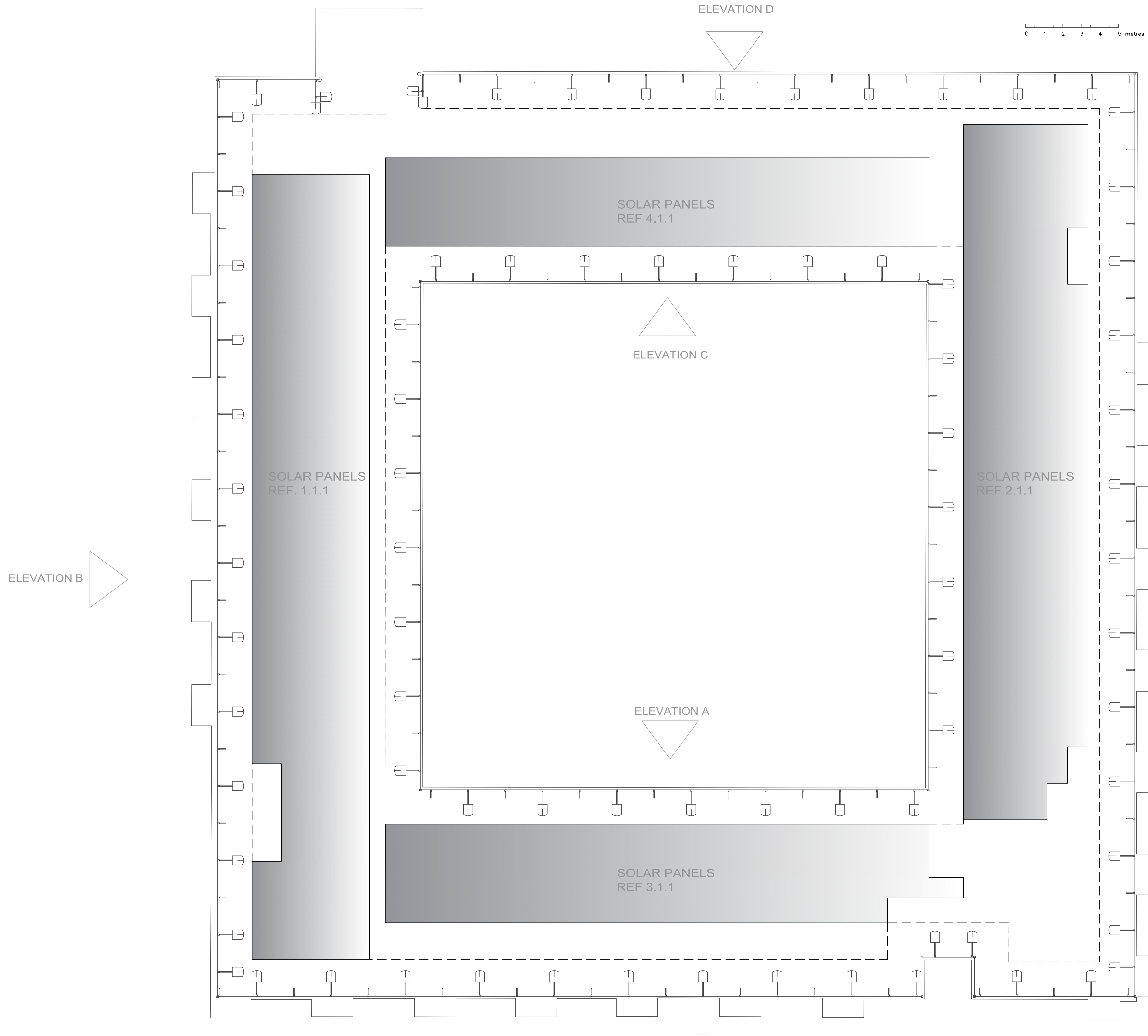

Rev	Date	Description	Name



Pellings LLP
 Northside House Mount Pleasant Barnet EN4 9EB
 t: 020 8441 8800 f: 020 8441 4616 e: barnet@pellings.co.uk
 www.pellings.co.uk
 Architecture & Planning ■ Building Surveying ■ Project Management ■
 Cost Consultancy ■ CDM Co-ordination

CLIENT
LONDON BOROUGH OF CAMDEN

PROJECT
**Henderson Court
 102 Fitzjohns Avenue
 London
 NW3 6NS**

TITLE
**ROOF PLAN
 AS PROPOSED
 PLANNING**

DATE 01/06/2022 SCALE 1:100 @A1 DRAWN RH

DRAWING No.
252|0983 | 104 |