

notes

Do not scale, except for planning purposes.
All dimensions to be checked on site and verified with the architect prior to construction.
Any discrepancies or uncertainties regarding this drawing to be discussed with the architect prior to construction.
Copyright © Theis and Khan Architects Ltd. All rights reserved

key

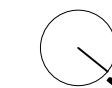
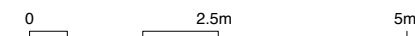

138.5m² gross internal floor area

revision notes

planning

revision	date	comment
p1	18/06/23	Issued for planning

**THEIS
+KHAN**

11-13 Lonsdale Gardens
Tunbridge Wells
Kent TN11 1NU
+44 (0)1892 518094
mail@theisandkhan.com
www.theisandkhan.com

project
22b harley road

drawing
ground floor plan
proposed

scale	date	revision
1:100 @ A3	august 22	
job number	drawing number	revision
1169	110	p1

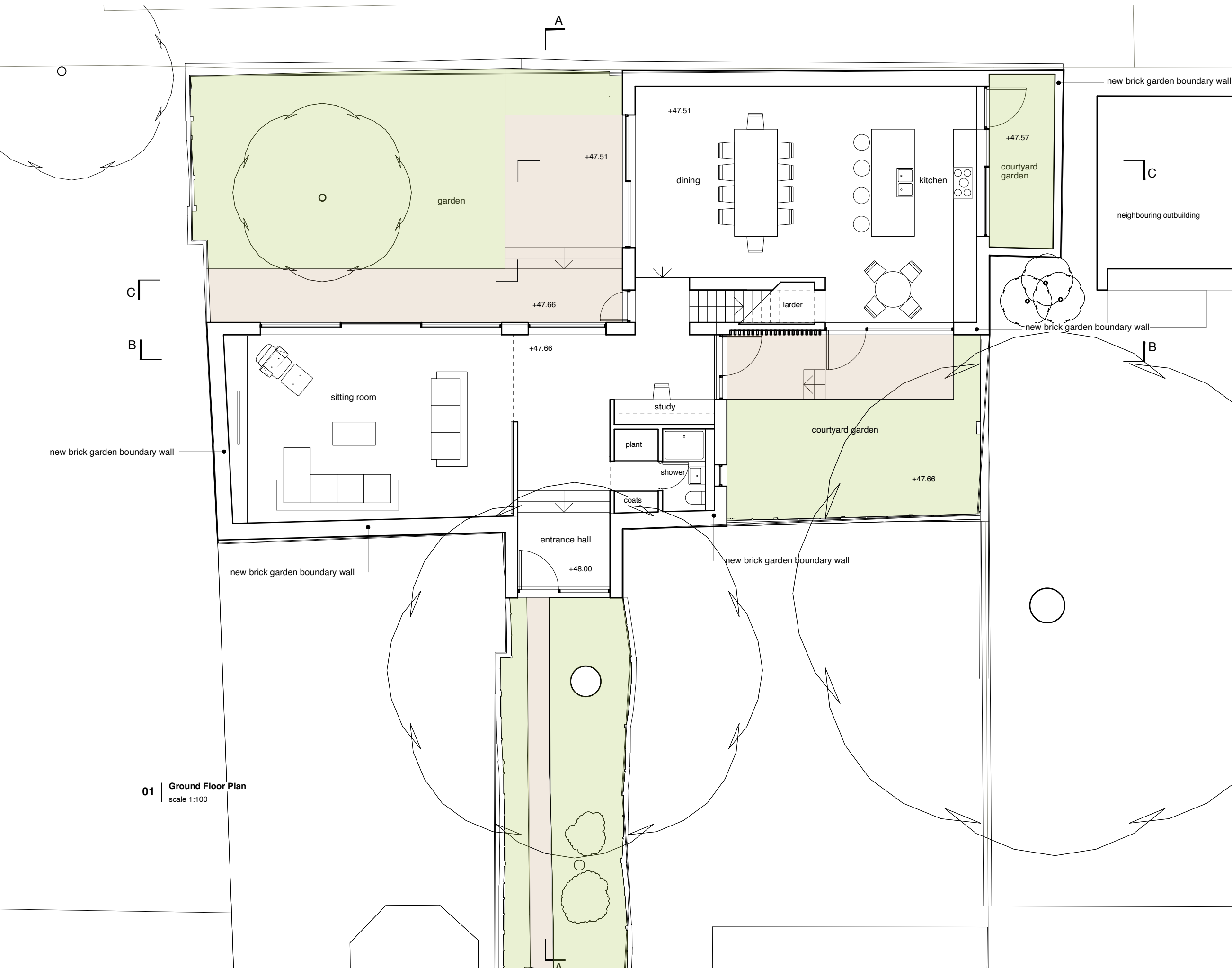

01 | Ground Floor Plan
scale 1:100