

BOSWELL STREET

OLD GLOUCESTER STREET

UF-200
1:50 A1

- Notes:**
1. Do not scale from this drawing.
 2. All dimensions to be verified prior to the commencement of any work or the production of any shop drawings.
 3. Matthew Lloyd Architects (MLA) shall be notified in writing of any discrepancies.
 4. Survey and boundaries indicative only.
 5. Proposals are subject to utilities surveys and specialist consultants' input & coordination.
 6. Any areas indicated are approximate and indicative only.
 7. Where an item is covered by drawings in different scales the larger scale drawing is to be worked to.
 8. Drawing to be read in conjunction with relevant consultant's drawings and specifications.
 9. Where MLA services on a project do not include site inspections and work surveys, MLA do not warrant that 'as built' issue drawings are a complete and accurate record of what has been built.
 10. MLA shall not be liable for the consequences of any use, misuse or variation of this drawing for any purpose other than that for which it was originally prepared.
 11. This title block is copyright of MLA and should not be used, removed, or altered without permission and clear identification.

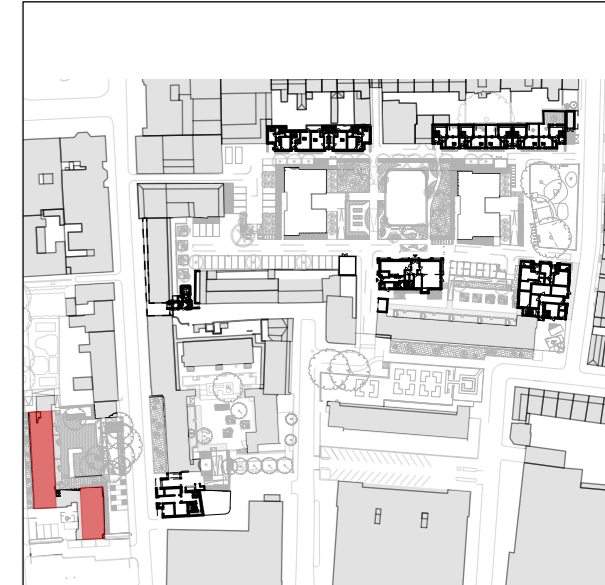

P01 27/09/2023 Updated ramp and landscape design in courtyard

Revisions:

PLANNING



MatthewLloydArchitects LLP
 1b The Hangar
 Perseverance Works
 38 Kingsland Road
 London E2 8DD
 T 020 7613 1934
 email: mail@matthewlloyd.co.uk
 www.matthewlloyd.co.uk

Original Sheet Size **A1**

Date: Sep-23	Scale: 1:100@ A1	Checked by: ASp	Drawn by: DZ
--------------	------------------	-----------------	--------------

Project:
**TYBALDS ESTATE
CAMDEN**

Drawing title:
**UNDERBUILDS: FALCON PROPOSED
LOWER GROUND FLOOR PLAN**

Reference: TE	Dep. No: UF-100	Rev: P01
----------------------	------------------------	-----------------