



A
GA_00
1:100@A1

Proposed Ground Floor Plan

Revisions		
G	05.07.23	Bike store and refuse areas updated.
H	28.07.2023	Residential waste storage updated.
I	31.08.23	Annotation updated.

Information contained within this drawing is the sole copyright of T2S Architecture Ltd. and is not to be reproduced without express permission. No implied licence exists. This drawing not to be used for land transfer or valuation purposes. Do not scale from this drawing. All dimensions & levels are to be checked on site by the contractor. Issued for purposes indicated only. Drawing errors and omissions to be reported to the architect.

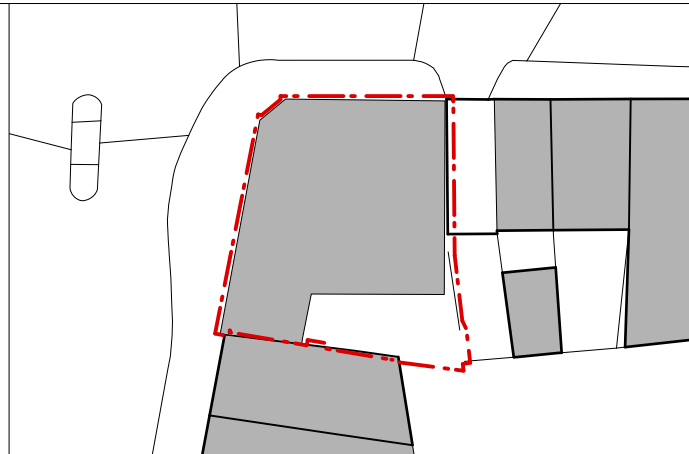

Client	Mendoza Limited	
Project	Newmarket Ale House	
	17 York Way	
	N7 9QG	
Drawing Title	Proposed Ground Floor Plan	

T2S ARCHIT ECTURE LTD			A: LMLF.302, The Leather Market Weston St. London, SE1 3ER M: +44 208 066 7078 E: admin@t2sarchitecture.com W: www.t2sarchitecture.com		
Status	Planning	Drawn	PB	Checked	TJS
Scale	1:100 @ A1, 1:200 @ A3			Date	01/06/2022
Drwg. No.	116_PL1_GA_00			Revision	I

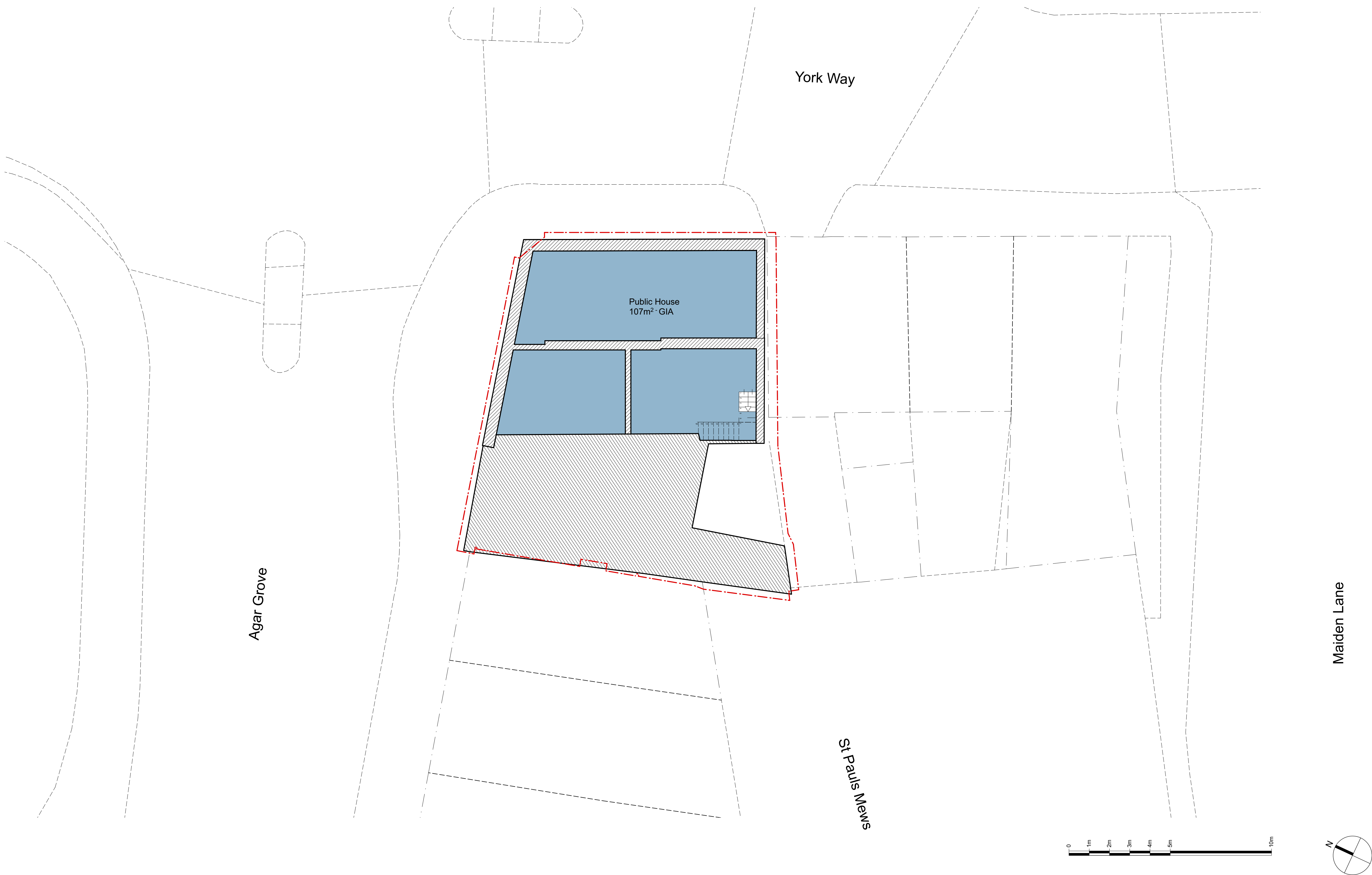

A
GA_-01

Basement Plan
1:100@A1

Revisions		
A	17.01.23	Issued for comment.
B	28.07.2022	Residential waste storage updated.
C	31.08.23	Annotation updated.

Information contained within this drawing is the sole copyright of T2S Architecture Ltd. and is not to be reproduced without express permission. No implied licence exists. This drawing not to be used for land transfer or valuation purposes. Do not scale from this drawing. All dimensions & levels are to be checked on site by the contractor. Issued for purposes indicated only. Drawing errors and omissions to be reported to the architect.

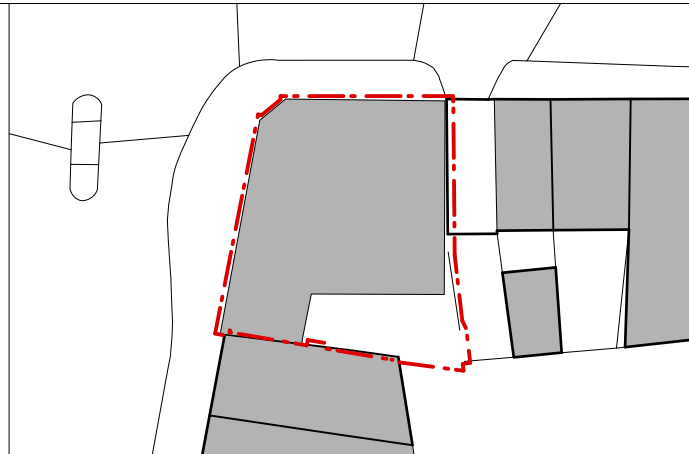

Client	Mendoza Limited		
Project	Newmarket Ale House 17 York Way N7 9QG		
Drawing Title	Basement Floor Plan		

T2S ARCHIT ECTURE LTD	A: LMLF.302, The Leather Market Weston St, London, SE1 3ER M: +44 208 066 7078 E: admin@t2sarchitecture.com W: www.t2sarchitecture.com		
	Status	Drawn	Checked
	Planning	PB	TJS
	Scale	Date	
	1:100 @ A1, 1:200 @ A3	01/06/2022	
Drwg. No.	Revision		
116_PL1_GA_-01	C		



A
GA_01
Proposed First Floor Plan
1:100@A1

Revisions			
C	10.05.23	Issued for comment.	
D	16.06.23	Issued for comment.	
E	19.06.23	Issued for comment.	

Information contained within this drawing is the sole copyright of T2S Architecture Ltd. and is not to be reproduced without express permission. No implied licence exists. This drawing not to be used for land transfer or valuation purposes. Do not scale from this drawing. All dimensions & levels are to be checked on site by the contractor. Issued for purposes indicated only. Drawing errors and omissions to be reported to the architect.

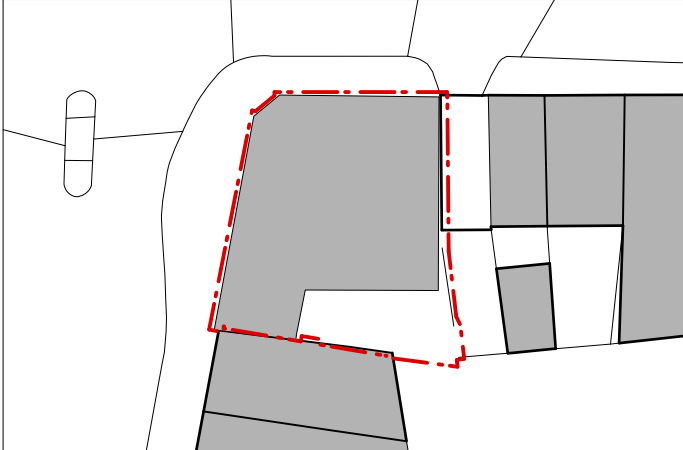

Client	Mendoza Limited		
Project	Newmarket Ale House 17 York Way N7 9QG		
Drawing Title	Proposed First Floor Plan		

T2S

ARCHIT

ECTURE

LTD

A: LMLF.302, The Leather Market
Weston St,
London, SE1 3ER
M: +44 208 066 7078
E: admin@t2sarchitecture.com
W: www.t2sarchitecture.com

Status	Drawn	Checked
Planning	PB	TJS
Scale	Date	
1:100 @ A1, 1:200 @ A3	01/06/2022	
Drwg. No.	Revision	
116_PL1_GA_01	E	

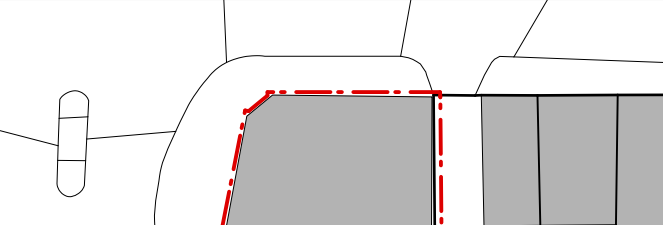

<div>Information contained within this drawing is the sole copyright of T2S Architecture Ltd. and is not to be reproduced without express permission. No implied licence exists. This drawing not to be used for land transfer or valuation purposes. Do not scale from this drawing. All dimensions & levels are to be checked on site by the contractor. Issued for purposes indicated only. Drawing errors and omissions to be reported to the architect.</div>	Revisions			Client Mendoza Limited		<div>T2S ARCHITECTURE LTD</div> <div>A: LMLF.302, The Leather Market Weston St, London, SE1 3ER M: +44 208 066 7078 E: admin@t2sarchitecture.com W: www.t2sarchitecture.com</div>		
	C	10.05.23		Issued for comment.	Project Newmarket Ale House 17 York Way N7 9QG			
	D	16.06.23		Issued for comment.	Drawing Title Proposed Second Floor Plan			
	E	19.06.23		Issued for comment.	Status Planning			
					Scale 1:100 @ A1, 1:200 @ A3			
			Drwg. No. 116_PL1_GA_02		Drawn PB		Checked TJS	
					Date 01/06/2022		Revision E	



A
GA_03
1:100@A1

Proposed Third Floor Plan

Revisions			
C	10.05.23	Issued for comment.	
D	16.06.23	Issued for comment.	
E	19.06.23	Issued for comment.	

Information contained within this drawing is the sole copyright of T2S Architecture Ltd. and is not to be reproduced without express permission. No implied licence exists. This drawing not to be used for land transfer or valuation purposes. Do not scale from this drawing. All dimensions & levels are to be checked on site by the contractor. Issued for purposes indicated only. Drawing errors and omissions to be reported to the architect.

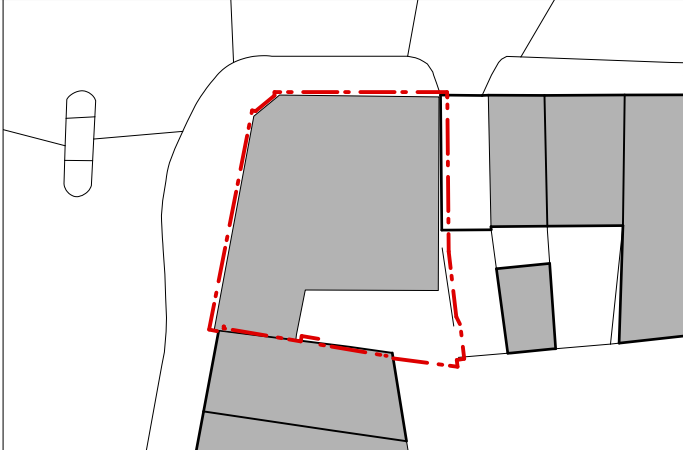

Client	Mendoza Limited		
Project	Newmarket Ale House 17 York Way N7 9QG		
Drawing Title	Proposed Third Floor Plan		

T2S

ARCHIT

ECTURE

LTD

A: LMLF.302, The Leather Market

Weston St,

London, SE1 3ER

M: +44 208 066 7078

E: admin@t2sarchitecture.com

W: www.t2sarchitecture.com

Status	Drawn	Checked
Planning	PB	TJS
Scale	Date	
1:100 @ A1, 1:200 @ A3	01/06/2022	
Drwg. No.	Revision	
116_PL1_GA_03	E	



A
GA_04

Proposed Fourth Floor Plan
1:100@A1

Revisions			
C	05.05.23	Issued for comment.	
D	10.05.23	Issued for comment.	
E	16.06.23	Issued for comment.	

Information contained within this drawing is the sole copyright of T2S Architecture Ltd. and is not to be reproduced without express permission. No implied licence exists. This drawing not to be used for land transfer or valuation purposes. Do not scale from this drawing. All dimensions & levels are to be checked on site by the contractor. Issued for purposes indicated only. Drawing errors and omissions to be reported to the architect.

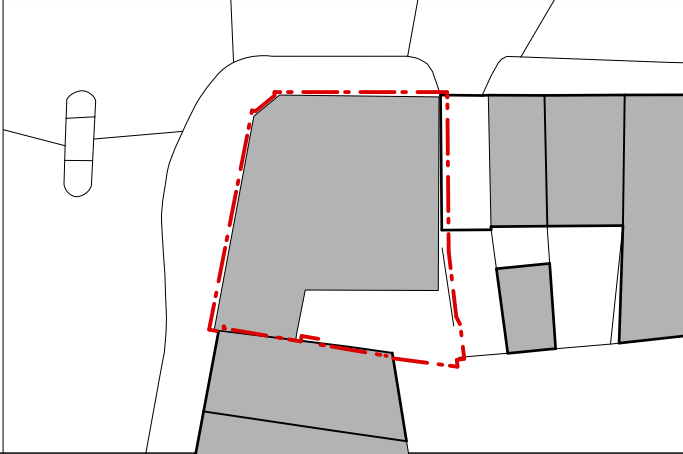

Client	Mendoza Limited		
Project	Newmarket Ale House 17 York Way N7 9QG		
Drawing Title	Proposed Fourth Floor Plan		

T2S ARCHIT ECTURE LTD	A: LMLF, 302, The Leather Market Weston St, London, SE1 3ER M: +44 208 066 7078 E: admin@t2sarchitecture.com W: www.t2sarchitecture.com		
	Status	Drawn	Checked
	Planning	PB	TJS
	Scale	Date	
	1:100 @ A1, 1:200 @ A3	01/06/2022	
Drwg. No.	Revision		
116_PL1_GA_04	E		

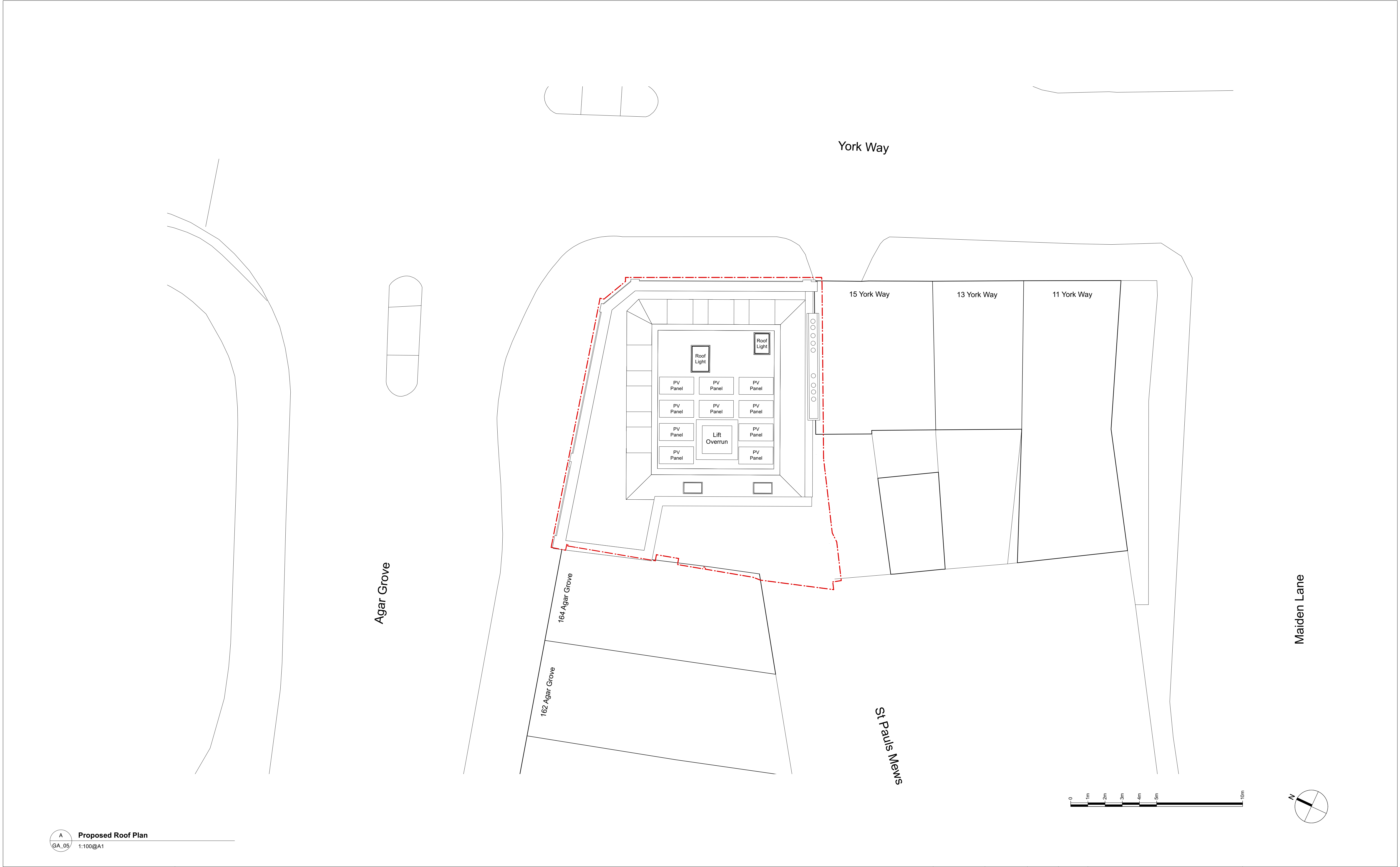

A
GA_05
1:100@A1
Proposed Roof Plan

Revisions			
A	16.06.23	Issued for comment.	
B	05.07.23	PV panels intergrated.	

Information contained within this drawing is the sole copyright of T2S Architecture Ltd. and is not to be reproduced without express permission. No implied licence exists. This drawing not to be used for land transfer or valuation purposes. Do not scale from this drawing. All dimensions & levels are to be checked on site by the contractor. Issued for purposes indicated only. Drawing errors and omissions to be reported to the architect.

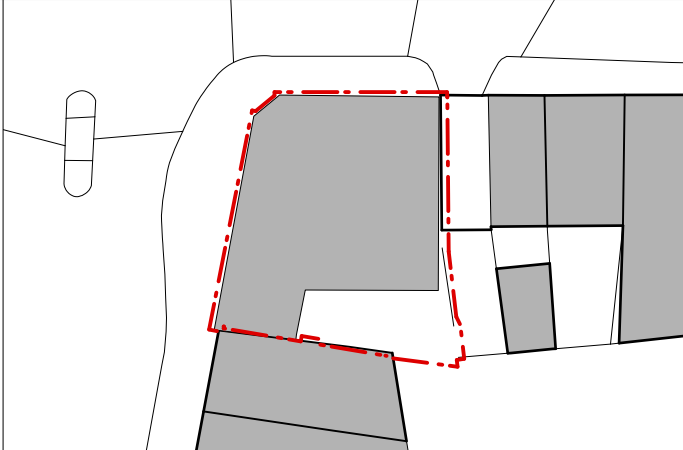

Client	Mendoza Limited		
Project	Newmarket Ale House 17 York Way N7 9QG		
Drawing Title	Proposed Roof Plan		

T2S
ARCHIT
ECTURE
LTD

A: LMLF.302, The Leather Market
Weston St,
London, SE1 3ER
M: +44 208 066 7078
E: admin@t2sarchitecture.com
W: www.t2sarchitecture.com

Status	Drawn	Checked
Planning	PB	TJS
Scale	Date	
1:100 @ A1, 1:200 @ A3	01/06/2022	
Drwg. No.	Revision	
116_PL1_GA_05	B	