

SOUTHAMPTON ROW

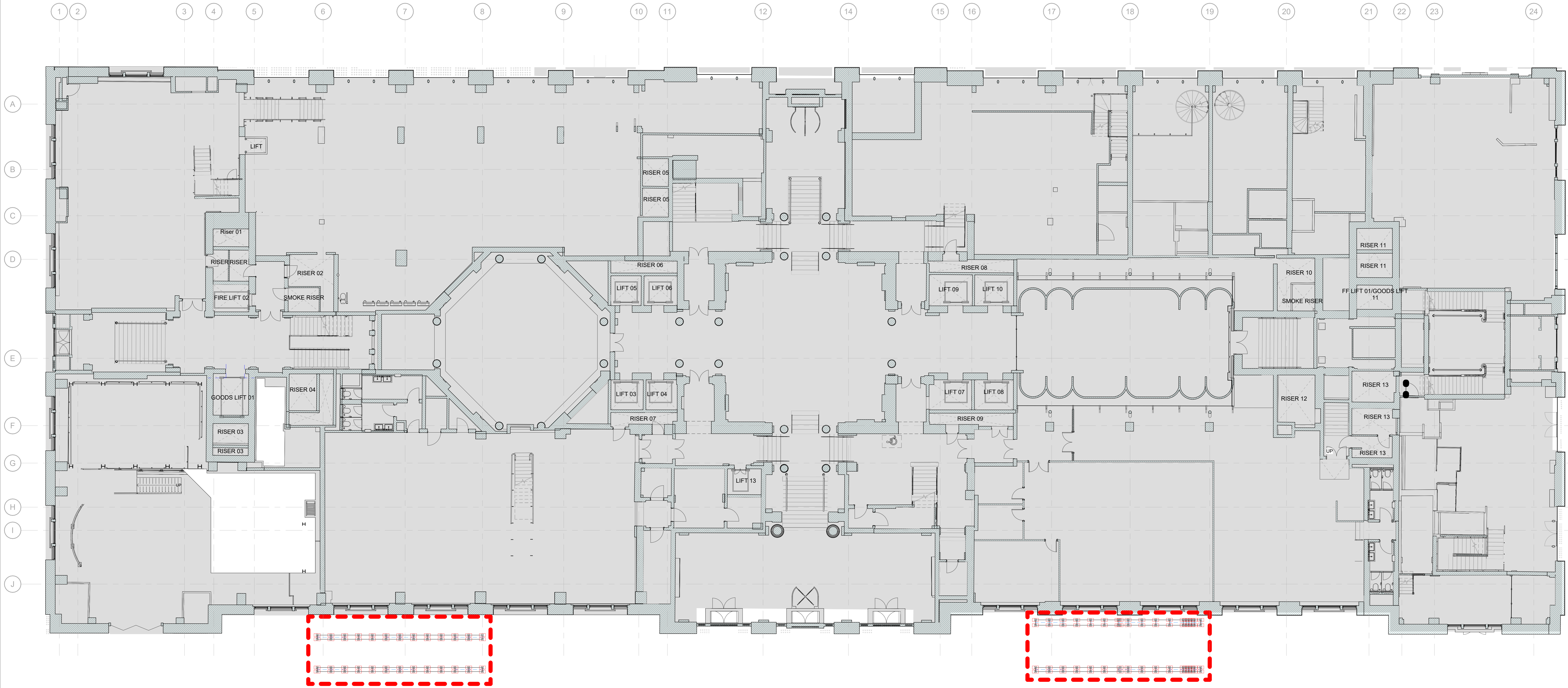

BLOOMSBURY SQUARE

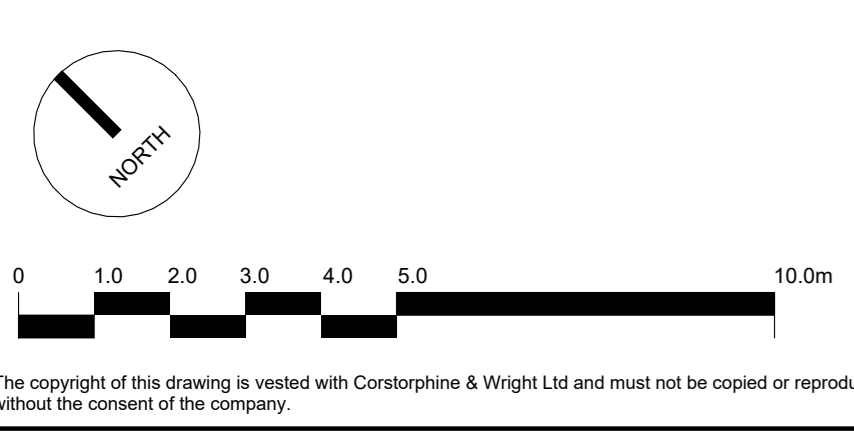
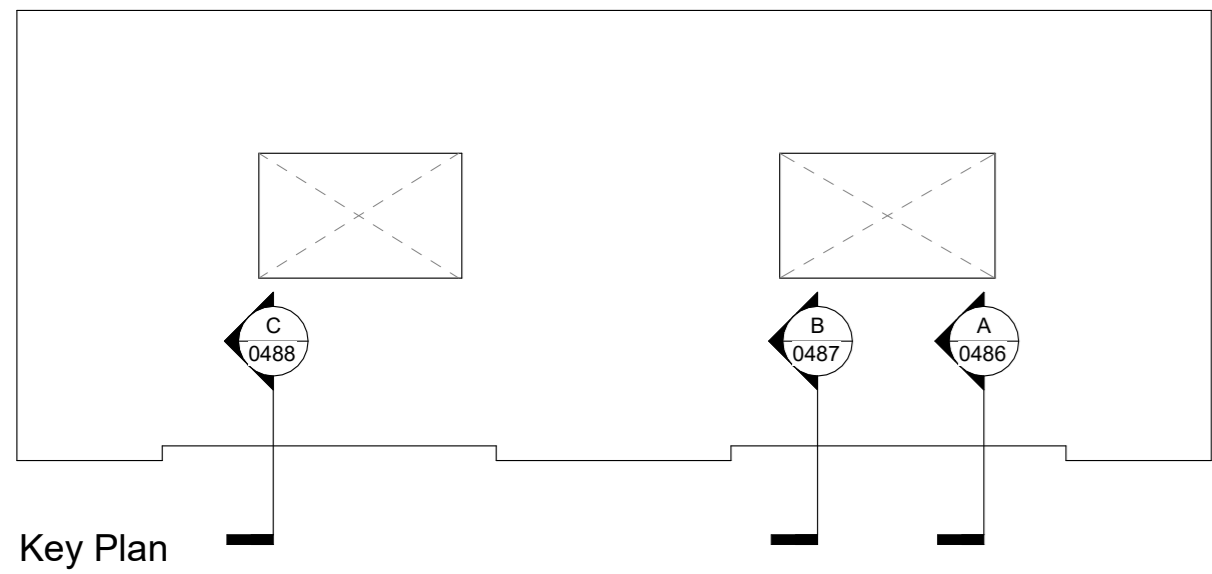

| Rev. | Description | Date | Drawn | Checked |
|------------|-------------|------|-------|---------|
| 19.12.2022 | DL ML | | | |

GENERAL LEGEND
 Area Outside of Application
 Area of Application

| | | | |
|---|-------------|--|--------------|
| Client: Oxford Victoria House Ltd. | | Corstorphine & Wright | |
| Project: 21593 - Victoria House | | London Studio 21-27 Lark's Court Street, Holborn, London, WC1N 3NL 020 7463 0520 | |
| Drawing Title: Plan - Proposed Hoist - Upper Ground Floor | | Drawing No: 21593-CWA-VH-UG-DR-A-0475 | |
| Drawing Status: INFORMATION | | Revision: P-00 | |
| Drawn: DL | Checked: ML | Paper Size: A0 | Scale: 1:100 |
| Date: 01/12/2022 | | | |

The copyright of this drawing is vested with Corstorphine & Wright Ltd and must not be copied or reproduced without the consent of the company.