

EXISTING NOTES

- ALL SERVICES SHOWN ON THIS DRAWING ARE INCLUDED FOR SCALE, SPATIAL CONTEXT & COORDINATION ONLY. PLEASE REFER TO INDIVIDUAL CONSULTANTS INFORMATION FOR DETAILS.
- THE PURPOSE OF THIS DRAWING AND IT'S RELEVANT PACKAGE IS FOR STAGE 4 INFORMATION ONLY.
- DO NOT SCALE DRAWING, USE FIGURED DIMENSIONS ONLY.
- ALL DIMENSIONS ARE IN MILLIMETERS.
- EXISTING DRAWINGS ARE BASED ON A DIGITAL SURVEY, ANY DESCREPANCIES IDENTIED ON SITE TO BE REPORTED TO THE ARCHITECT.

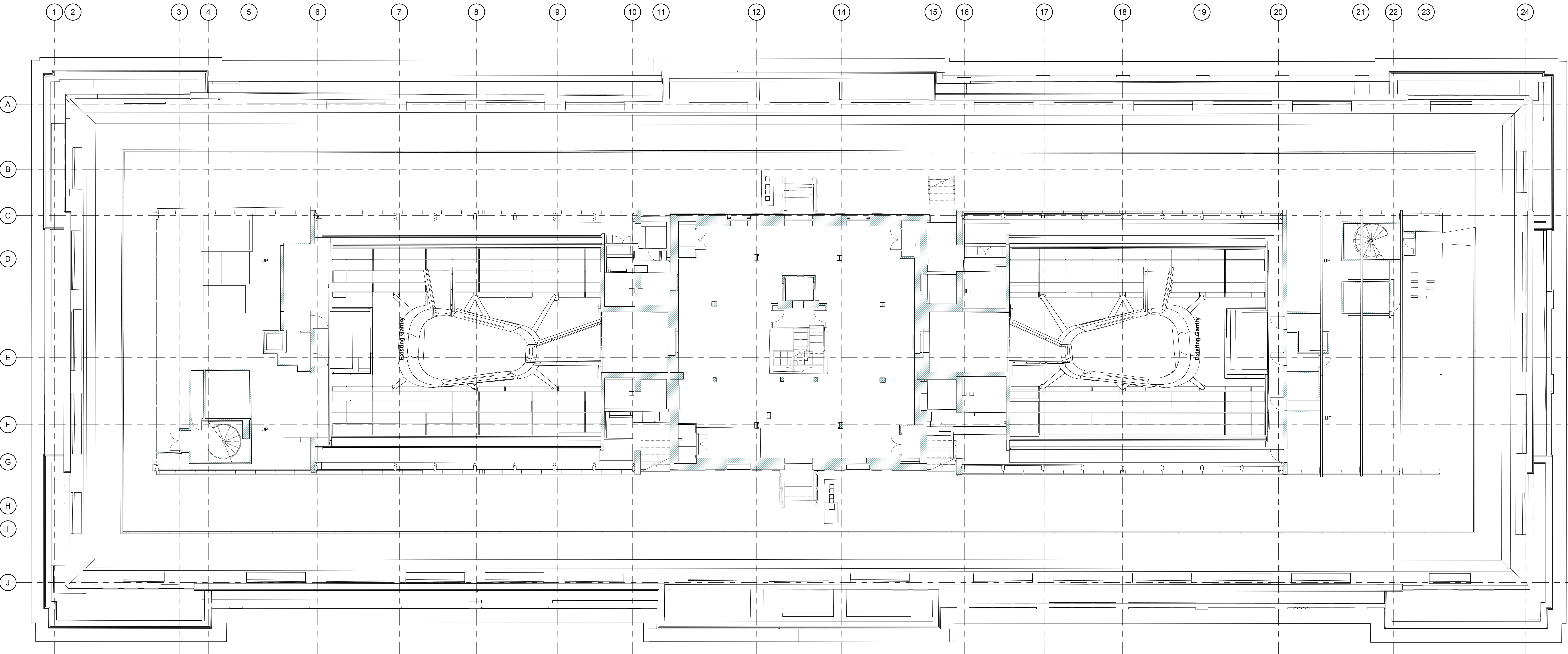

1 Existing Plan - Eighth Floor

1 : 100

SYMBOLS & HATCHES LEGEND

- Existing Building
- Drainage Positions
- Ramps
- New disabled refuge with wireless call points

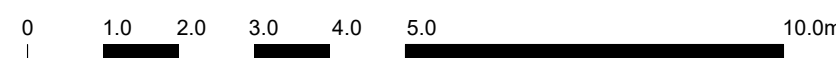
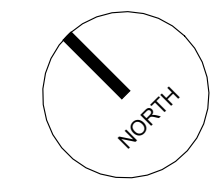

The copyright of this drawing is vested with Corstorphine & Wright Ltd and must not be copied or reproduced without the consent of the company.

T-02 STAGE 4A INFORMATION ISSUE
T-01 UPDATE SCALE BAR
T-00 TENDER ISSUE

16.06.2023 DL ML
21.12.2022 DL ML
21.10.2022 EM RW
Date Drawn/Check

DRAWING PACKAGE REFERENCES

0200 Series - Existing Plans, Sections & Elevations
1100 Series - Demolition
2000 Series - Proposed Plans, Sections & Elevations
2200 Series - Fire Strategy
2400 Series - Wall Types
2500 Series - Floor Finishes

2600 Series - Ceiling Finishes
2700 Series - Setting Out
3000 Series - External Details
4000 Series - Internal Details
5000 Series - Schedules

Client:
Oxford Victoria House Ltd.

Project:
21593 - Victoria House

Drawing Title:
Plan - GA Existing - Eighth Floor

Drawing Status:
INFORMATION

Corstorphine & Wright

London Studio
21-27 Leman's Conduit Street, Holborn, London, WC1N 3NL
020 7465 0600

corstorphine-wright.com

Drawing No.
21593-CWA-VH-08-DR-A-0234

Drawn: DL
Checked: ML
Paper Size: A0
Scale: As indicated

Revision
T-02
Date
21/12/2022