

This drawing is the copyright of Axiom Architects. It is for planning application purposes only and may not be reproduced in whole or in part without permission. Drawings lodged for planning approval may be reproduced by the Planning Authority in accordance with the 'Copyright (Material Open to Public Inspection) (Marking of Copies of Plans and Drawings) Order 1990' and must carry the relevant copyright restriction note. Scaling from this drawing should only be carried out from a print at the scale and size specified within the title block. Responsibility for ensuring correct size reproduction remains with the reader.

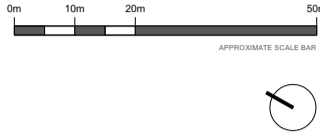

Key
 Site Boundary

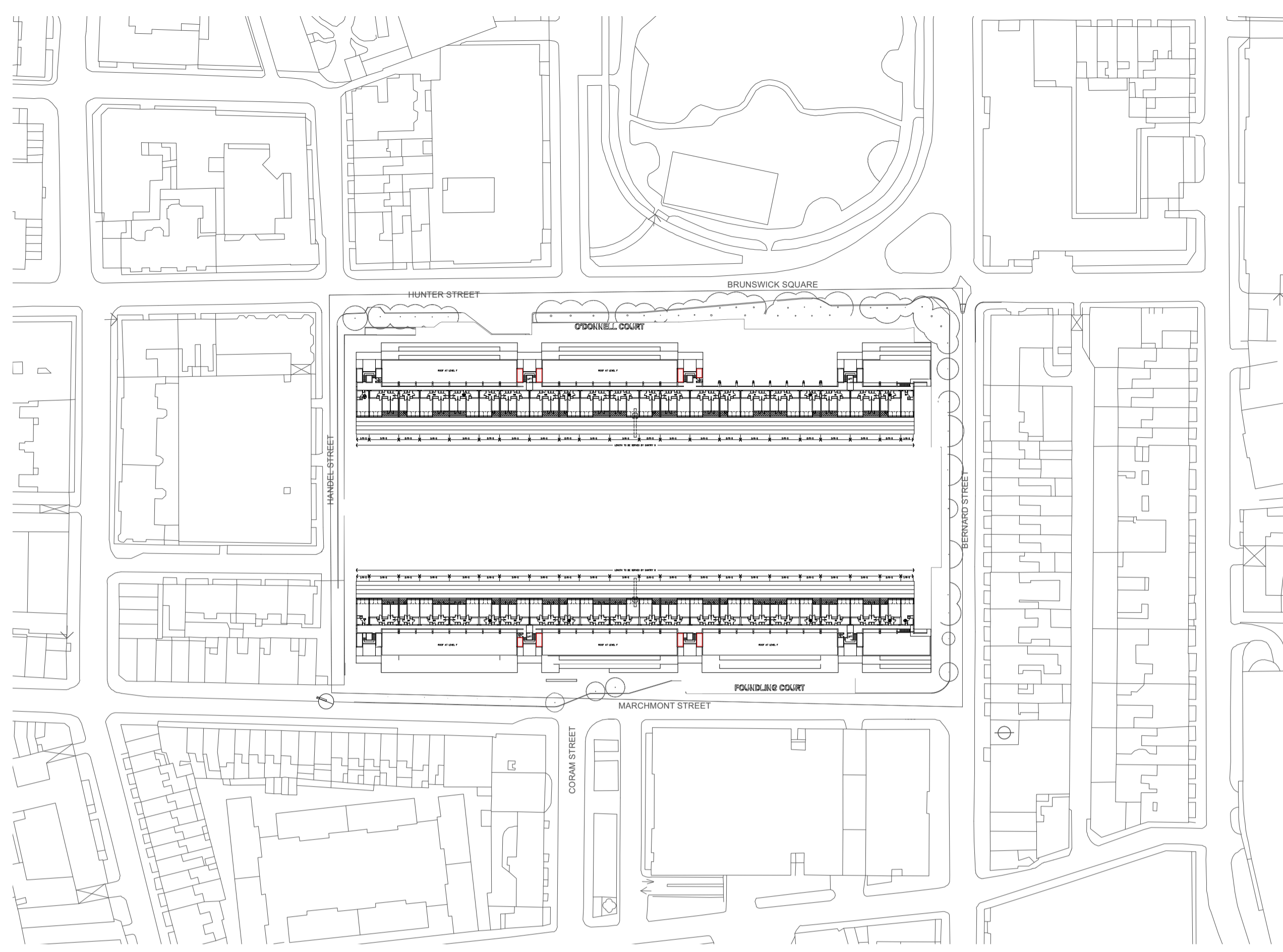

9 **Red Line Sixth Floor**
 Scale: 1:1250

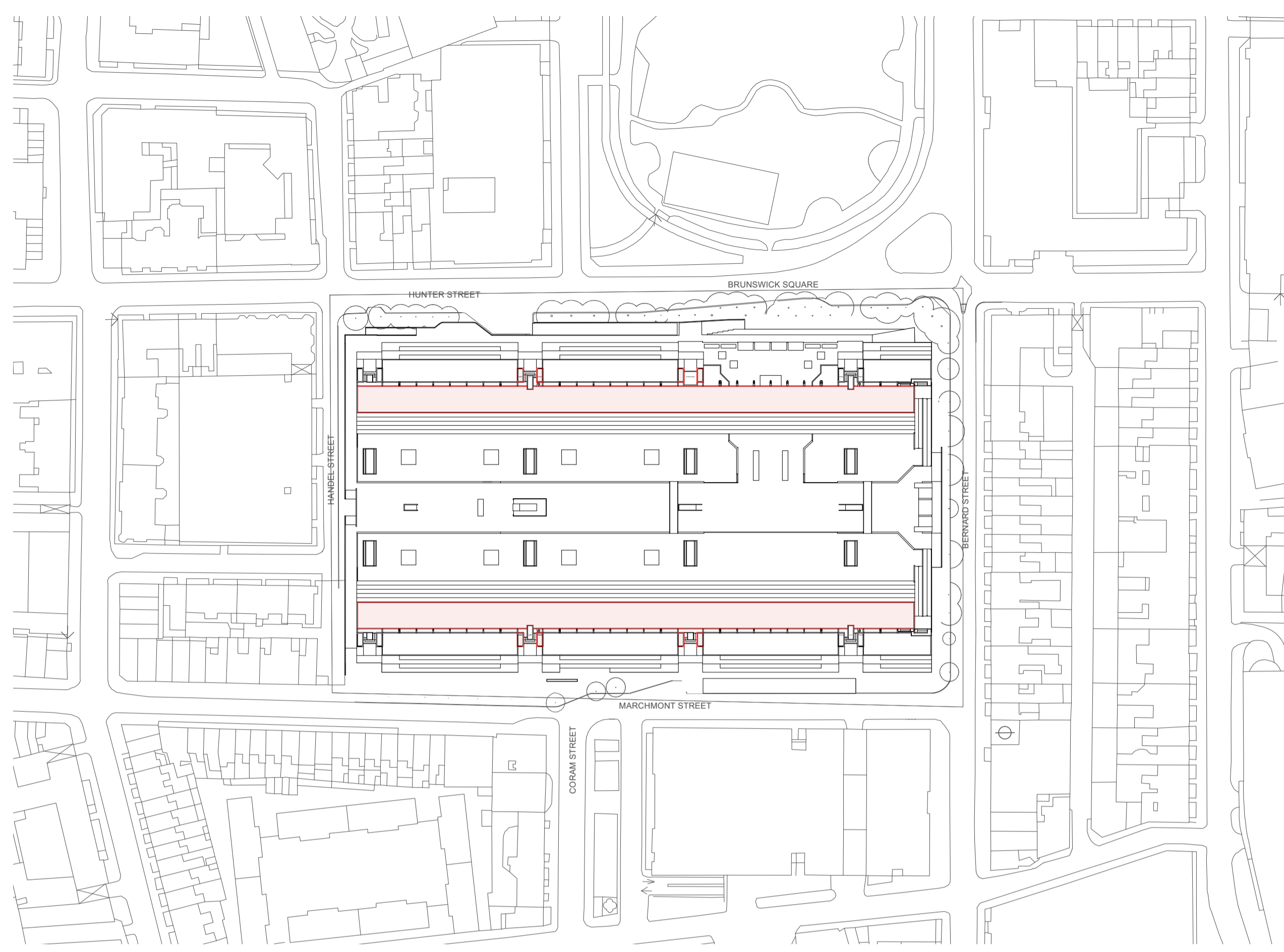

10 **Red Line Roof Plan**
 Scale: 1:1250

Rev	Date	Description	By	Chk
C	24/07/23	For planning Rev1	FP	JM
B	06/07/23	For planning	FP	JM
A	06/07/23	For Information	FP	JM

AXIOM ARCHITECTS
 Morelands 5-27 Old Street London EC1V 9HL
 Tel. 0207 421 8866 www.axiomarchitects.co.uk

Client
LAZARI INVESTMENTS LTD

Project
BRUNSWICK CENTRE
BLOOMSBURY
LONDON, WC1N 1BS

Drawing
Red Line Plans

Scale	Date	Drawn	Checked
1:1250 @ A3	15/11/2022	FP	JM

Drawing No. **4742-PA1-005** **C**

Status
PLANNING