

HEADINGS & ABBREVIATIONS

TREE NO.	REFERENCE NUMBER. REFER TO PLAN OR NUMBERED TAGS WHERE APPLICABLE
SPECIES:	COMMON NAME (LATIN NAMES AVAILABLE ON REQUEST)
AGE RANGE/LIFE STAGE:	Y = YOUNG, SM = SEMI MATURE, EM = EARLY MATURE, M = MATURE, PM = POST MATURE
HEIGHT:	ESTIMATED AND RECORDED IN METRES. APPROXIMATELY 1 IN 10 TREES ARE MEASURED USING A CLINOMETER AND THE REMAINDER ESTIMATED AGAINST THE MEASURED TREES
CROWN SPREAD:	MAXIMUM CROWN RADIUS MEASURED TO THE FOUR CARDINAL COMPASS POINTS FOR SINGLE SPECIMENS ONLY (MEASUREMENT FOR TREE GROUPS - MAXIMUM RADIUS OF THE GROUP)
CROWN CLEARANCE &DIRECTION OF GROWTH:	HEIGHT IN METERS OF CROWN CLEARANCE ABOVE ADJACENT GROUND LEVEL (TO INFORM ON GROUND CLEARANCE, CROWN/STEM RATIO AND SHADING)
STEM DIA/MULTI-STEM DIA:	STEM DIAMETER - MEASURED AT APPROXIMATELY 1.5 METRES ABOVE GROUND LEVEL OR A COMBINATION OF STEMS FOR MULTI-STEMMED TREES
VITALITY:	A MEASURE OF PHYSIOLOGICAL CONDITION. D = DEAD, MD = MORIBUND, P = POOR, M = MODERATE, N = NORMAL
ESTIMATED REMAINING CONTRIBUTION:	RELATIVE USEFUL LIFE EXPECTANCY (YEARS)
BS 5837CATEGORY & SUB-CATEGORY GRADING:	A = HIGH QUALITY AND VALUE, B = MODERATE QUALITY AND VALUE, C = LOW QUALITY AND VALUE, U = UNSUITABLE FOR RETENTION: SUB-CATEGORY REFERS TO ARBORICULTURAL (1), LANDSCAPE (2) & CULTURAL/CONSERVATION VALUES (3).
BS 5837 RPA:	ROOT PROTECTION AREA - BS 5837 (2012) ANNEX D (THE RECOMMENDATIONS STATE THAT THE RPA SHOULD BE CAPPED AT 707 M ²)
BS 5837 RADIUS:	PROTECTIVE DISTANCE - RADIUS FROM THE CENTRE OF THE STEM TO THE LINE OF TREE PROTECTION (CONSTRUCTION EXCLUSION ZONE - CEZ) AND PROTECTIVE BARRIER

SITE: 100 Haverstock Hill, London NW3 2BD										SURVEYOR: R. BALL ASSESSMENT DATE: 28/01/2020 VIEWING CONDITIONS: SUNNY - CLEAR JOB REFERENCE: 101 844		PAGE: 1 of 3			
CLIENT: PROGRESSIVE DESIGN TEAM															
BRIEF: CARRY OUT A PHASE I ARBORICULTURAL IMPACT (<i>TREE CONSTRAINT</i>) ASSESSMENT ON THE PROPOSED REAR LANDSCAPING AT THE ABOVE SITE.															
TREE HEDGE GROUP NO.	SPECIES (COMMON NAME)	AGE RANGE/ LIFE STAGE	HEIGHT (m)	RADIAL CROWN SPREAD (m)				CROWN CLEARANCE & DIRECTION OF GROWTH (m)	STEM/ MULTI- STEM* DIA. (mm)	VITALITY	COMMENTS/STRUCTURAL MORPHOLOGY	PRELIMINARY MANAGEMENT	CATEGORY & SUB- CATEGORY GRADING BS 5837	BS 5837 RPA RADIUS (m)	BS 5837 RPA (m²)
				N	E	S	W								
S1	Hazel	M	12	5	5	3	3	1.9	* 120; 45; 75; 35; 80; 110; 120; 100; 150; 72; 110; 70; 60; 120	N	Significant large shrub that provides some useful boundary screening. Crown unbalanced due to we suspect a large competing tree that was removed on the western side of this tree <i>Stem dia. math: 14 stems with average stem dia. of 90mm. Therefore RPA = 12 x 90mm</i> 14th September 2023 update: Camden Council consent was given to remove S1.	None at time of survey (NATS)	B2	5.6	53.0
T1	Walnut	D	14	-	-	-	-	-	-	D	Dead tree leaning over the neighbouring property 14th September 2023 update: Camden Council consent was given to remove T1.	Remove (high-risk) tree within 1-2 months <i>NB Tree in a Conservation Area so LPA consent required</i>	U	-	-
T2	Common Pear	M	14	4	3.5	4	3.5	4.0	300	M	Suspected old bonfire trunk damage resulting in a considerable vertical scar (from ground up to approx. 3m) with exposed dead heartwood and limited flanking wound-wood. Significant hollowing detected with the Sounding Hammer. See appended photo no. 1 14th September 2023 update: Camden Council consent was given to remove T2.	Remove (medium-risk) tree within 12 months <i>NB Tree in a Conservation Area so LPA consent required</i>	U	-	-

TREE SURVEY SCHEDULE
2014 © ARBOL EURO CONSULTING LTD.

SITE: 100 Haverstock Hill, London NW3 2BD										SURVEYOR: R. BALL ASSESSMENT DATE: 28/01/2020 VIEWING CONDITIONS: SUNNY - CLEAR JOB REFERENCE: 101 844		PAGE: 2 of 3			
CLIENT: PROGRESSIVE DESIGN TEAM															
BRIEF: CARRY OUT A PHASE I ARBORICULTURAL IMPACT (<i>TREE CONSTRAINT</i>) ASSESSMENT ON THE PROPOSED REAR LANDSCAPING AT THE ABOVE SITE.															
TREE HEDGE GROUP NO.	SPECIES (COMMON NAME)	AGE RANGE/ LIFE STAGE	HEIGHT (m)	RADIAL CROWN SPREAD (m)				CROWN CLEARANCE & DIRECTION OF GROWTH (m)	STEM/ MULTI- STEM* DIA. (mm)	VITALITY	COMMENTS/STRUCTURAL MORPHOLOGY	PRELIMINARY MANAGEMENT	CATEGORY & SUB- CATEGORY GRADING BS 5837	BS 5837 RPA RADIUS (m)	BS 5837 RPA (m²)
				N	E	S	W								
T3	Goat Willow	M	17	4	3.5	4	2.5	2.0	* 140; 127; 40; 20	N	Good crown form and provides useful screening	NATS	B2	2.3	17.1
T4	Holm Oak	EM	15	1.9	3.5	3.5	2.5	1.4	265	N	Trunk lean to the south but not significant at this time. Provides useful evergreen screening	NATS	B2	3.1	31.7
T5	Holm Oak	EM	18	2.5	2	3	4	4.0	295	N	Good form	NATS	B2	3.5	39.3
T6	Yew	EM	6	3.2	3	3.5	3	2.5	238	N	Suppressed by T12 an average tree	NATS	C1	2.8	25.6
T7	Sweet Gum	SM	11	1.5	1.5	1.5	0.5	1.8	95	N	Etiolated suppressed crown form	NATS	C1	1.1	4.1
T8	Holly	EM	14	1.8	1.8	1.8	1.8	4.0	220	N	Close up against an outbuilding and as such will outgrow its position. Also suppressed by T9	NATS	C1	2.6	21.9
T9	Common Lime <i>Off-site tree with no access to fully survey</i>	EM	21+	4	4	4	4	? See access	Est. 450	N	Good crown form	? See access	B2(?) See access	5.4	91.6
T10	Lawson Cypress <i>Off-site tree with no access to fully survey</i>	SM	13	1.9	1.9	1.9	1.9	1.9	Est. 180	N	Suppressed by T9 an average tree	? See access	C1(?) See access	2.1	14.6
T11	Plum <i>Off-site tree with no access to fully survey</i>	EM	12	3	3	3	1.5	1.8	Est. 190	M	Suppressed by T5 an average tree	? See access	C1(?) See access	2.2	16.3

TREE SURVEY SCHEDULE
2014 © ARBOL EURO CONSULTING LTD.

SITE: 100 Haverstock Hill, London NW3 2BD											SURVEYOR: R. BALL		PAGE: 3 of 3		
CLIENT: PROGRESSIVE DESIGN TEAM											ASSESSMENT DATE: 28/01/2020				
BRIEF: CARRY OUT A PHASE I ARBORICULTURAL IMPACT (<i>TREE CONSTRAINT</i>) ASSESSMENT ON THE PROPOSED REAR LANDSCAPING AT THE ABOVE SITE.											VIEWING CONDITIONS: SUNNY - CLEAR				
											JOB REFERENCE: 101 844				
TREE HEDGE GROUP NO.	SPECIES (COMMON NAME)	AGE RANGE/ LIFE STAGE	HEIGHT (m)	RADIAL CROWN SPREAD (m)				CROWN CLEARANCE & DIRECTION OF GROWTH (m)	STEM/ MULTI- STEM* DIA. (mm)	VITALITY	COMMENTS/STRUCTURAL MORPHOLOGY	PRELIMINARY MANAGEMENT	CATEGORY & SUB- CATEGORY GRADING BS 5837	BS 5837 RPA RADIUS (m)	BS 5837 RPA (m ²)
				N	E	S	W								
T12	Sycamore <i>Off-site tree with no access to fully survey</i>	EM	22+	5	5	5	5	4.0	460	N	Good dominate crown form	? See access	B2(?) See access	5.5	95.7

Photo no. 1 to show the old suspected bonfire scar on the common pear T2
Sounding Hammer included for scale
Please note the dead walnut T1 behind T2



Application ref: 2023/3146/T
Contact: Liam Vincent
Tel: 020 7974 8677
Email: Liam.Vincent@camden.gov.uk
Date: 8 September 2023

Development Management
Regeneration and Planning
London Borough of Camden
Town Hall
Judd Street
London
WC1H 9JE

Phone: 020 7974 4444

planning@camden.gov.uk
www.camden.gov.uk/planning

Town & Country Planning Limited
13 Evelyn Road
Cockfosters
Herts
Barnet
EN4 9JT

Dear Sir/Madam

DECISION

Town and Country Planning Acts 1990 (as amended)

NO OBJECTION TO SECTION 211 NOTICE OF WORKS TO TREE/S IN A CONSERVATION AREA

Address:

**100 Haverstock Hill
London
NW3 2BD**

Proposed Work:

REAR GARDEN: 1 x Hazel tree (S1B) - Fell to ground level.
1 x Walnut (T1) - Fell to ground level.
1 x Common Pear (T2) - Fell to ground level.

The Council has considered your notification of intended works to trees dated 02 August 2023 and does not wish to object.

Informative(s):

- 1 This notice is valid for 2 years from the date of this letter or until the work is completed, whichever is the sooner.
- 2 You are advised that the appropriate standards for tree work are set out in BS 3998: 2010. Failure to ensure that the proposed works are carried out to these standards may result in damage to the tree(s) and may result in legal action by the Council.
- 3 Please note that any approval given by the Council does not give an exemption from the requirements to comply with the Wildlife and Countryside Act 1981 (as amended), or any other Acts offering protection to wildlife. Of particular note is

the protection offered to bats, birds and their nests from construction works. For further information contact Natural England on 0300 060 3900 or www.naturalengland.org.uk.

Yours faithfully

A handwritten signature in black ink, appearing to read 'DPope', is positioned above the printed name and title.

Daniel Pope
Chief Planning Officer

It is important to us to find out what our customers think about the service we provide. To help us in this respect, we would be very grateful if you could take a few moments to complete our online survey at the following website address: www.camden.gov.uk/dmfeedback. We will use the information you give us to help improve our services.

Arbol EuroConsulting

1 Landford Close Rickmansworth WD3 1NG

100 Haverstock Hill London NW3 2BD

Tree Constraints Plan (1)

Landscaping

SCALE :
1 : 200 @ A3

DATE :
14/09/2023

MAP FILENAME :
101 844

N

Map data shown may contain Ordnance Survey © products supplied by
Pear Technology Services Ltd. Email: info@peartechnology.co.uk
© Crown Copyright and database rights from data shown above
Ordnance Survey © licence number 100023148

The original of this drawing was produced in colour - a monochrome copy should not be relied upon

The main site plan illustrates the proposed landscaping for the property at 100 Haverstock Hill. It features a central building footprint labeled 'No 100 Haverstock Hill'. Surrounding the building are various trees, each identified by a label and a circular outline representing its crown spread. The trees are labeled as follows: T1 (U), T2 (U), T3 (B), T4 (B), T5 (B), T6 (C), T7 (C), T8 (C), T9 (B), T10 (C), T11 (C), and T12 (B). A specific area is labeled 'S1 B'. The plan also shows a 'Shrub Palm' area. Red 'x' marks indicate the locations of trees or shrubs. A yellow line outlines the boundary of the site. A north arrow is located in the top right corner of the plan area. The plan is oriented with the building at the bottom and the road at the top.

KEY

Root Protection Area

Crown Spread

BS: 5837 Retention Grade

5m
10m
SCALE BAR

Arbol EuroConsulting

1 Landford Close Rickmansworth WD3 1NG

100 Haverstock Hill London NW3 2BD

Tree Constraints Plan (2)

Landscaping

SCALE :
1 : 200 @ A3

DATE :
14/09/2023

MAP FILENAME :
101 866

N

Map data shown may contain Ordnance Survey © products supplied by
Pear Technology Services Ltd. Email: info@peartechnology.co.uk
© Crown Copyright and database rights from data shown above
Ordnance Survey © licence number 100023148

The original of this drawing was produced in colour - a monochrome copy should not be relied upon

NOTES.
1. In September 2023, Camden Council Consent was given to remove S1, T1 & T2 (Application ref: 2023/3146/T) and consequently these have been removed off plan.

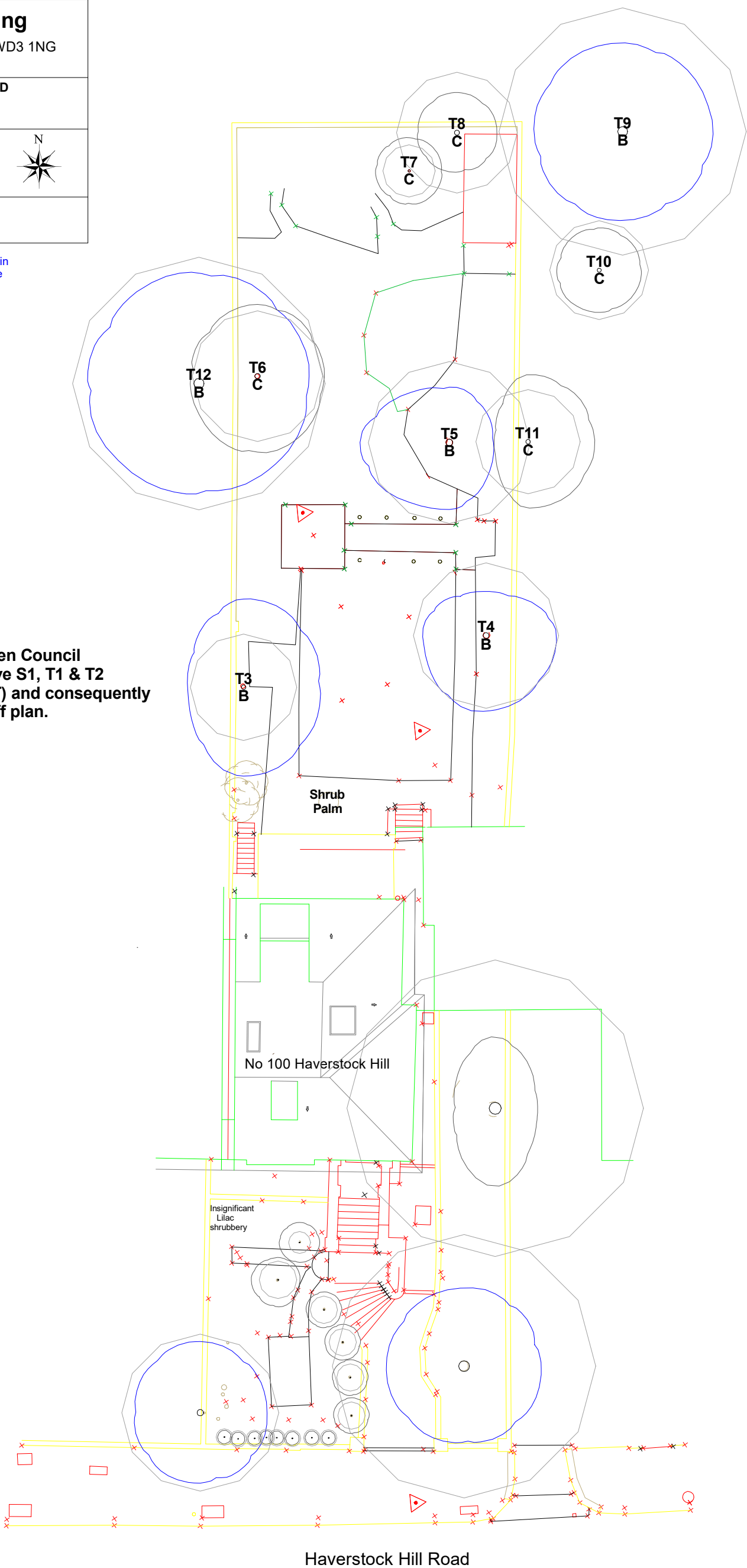

KEY

Root Protection Area

Crown Spread

BS: 5837 Retention Grade

