



KEY/LEGEND:

-  EXISTING BUILDING
-  NEW CONSTRUCTION
-  BOUNDARY LINE



1 EXISTING ROOF PLAN  
Scale: 1:50

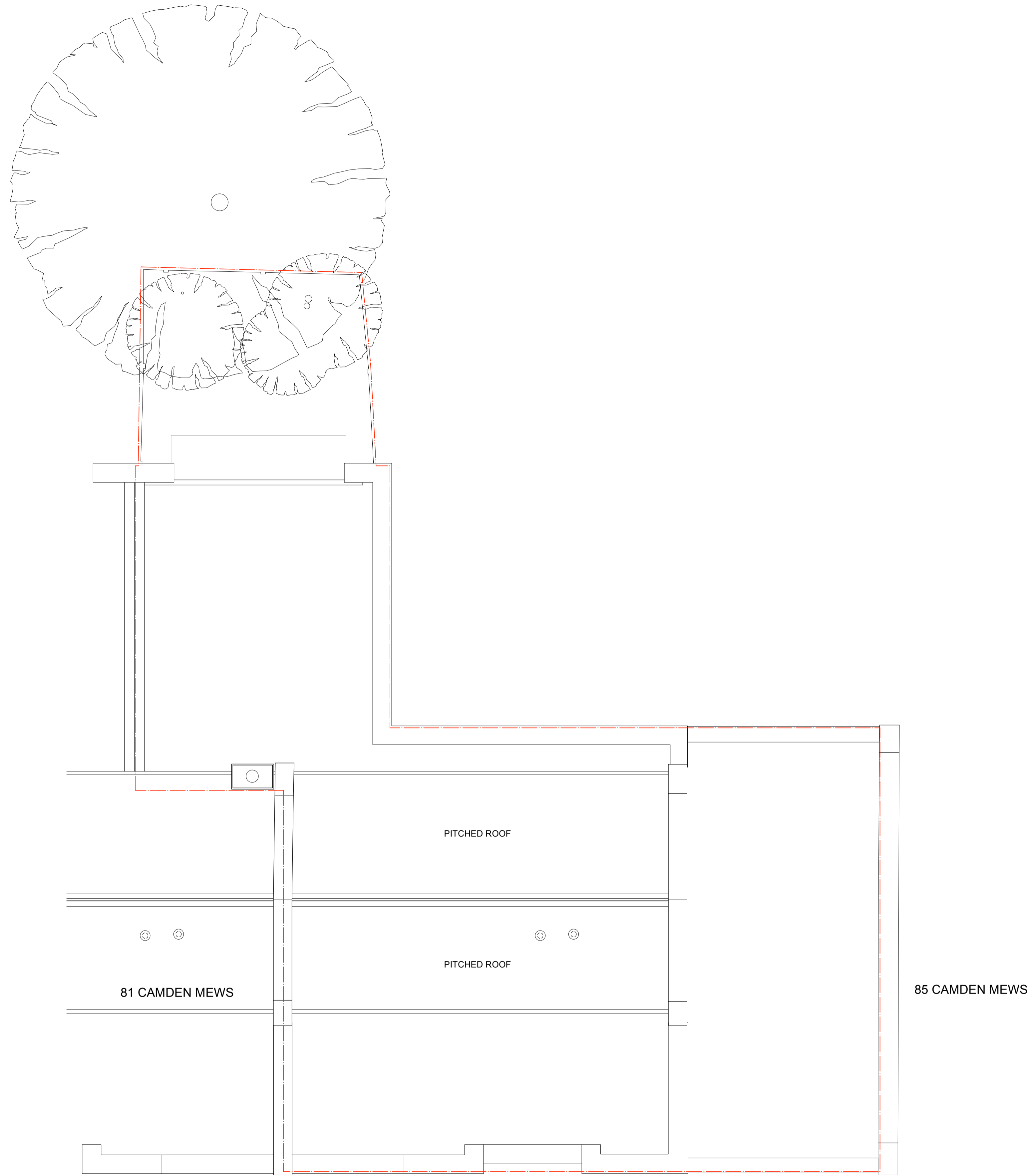

REV	DATE	ISSUER	COMMENTS
-	25/08/2023	JBB	FIRST ISSUE

CLIENT:  
**CELINE ASSIMON**  
PROJECT ADDRESS:  
**83 CAMDEN MEWS, NW1 9UB**  
PROJECT CODE:  
**A101**  
DRAWING NAME:  
**EXISTING ROOF PLAN**

DRAWING NO.:	REVISION:	DATE:	DRAWN:	CHECKED:
PA3-A2-013	-	AUG 2023	JBB	JBB

SCALE:  
**1:50 @ A1**

**StateStudio**

statestudiold.com  
0203 637 2922  
architecture@statestudiold.com  
12 Crown Works  
Temple Street  
London E2 6QQ

DIMENSIONS:  
Do not scale from these drawings. For accuracy, all dimensions and specifications must be confirmed at the site and with all relevant technical & manufacturer information.  
Any discrepancy between drawings and dimensions on site are to be brought to the attention of StateStudio Ltd prior to any works being undertaken.  
© STATESTUDIO LIMITED 2023  
The design and drawings remain the property of StateStudio Ltd. The client for the project will be licensed to use the design and documents on this site only upon full payment of architectural fees. This license is non-transferable. The design and drawings shall not be reproduced, uploaded to the internet or passed without the permission of StateStudio Ltd.

CAMDEN MEWS