

NOTES:

Check all dimensions on site.  
Inform architect of any discrepancies  
Cross-refer to all related documents

Survey made for planning purposes.  
Check survey required prior  
to detailed design.

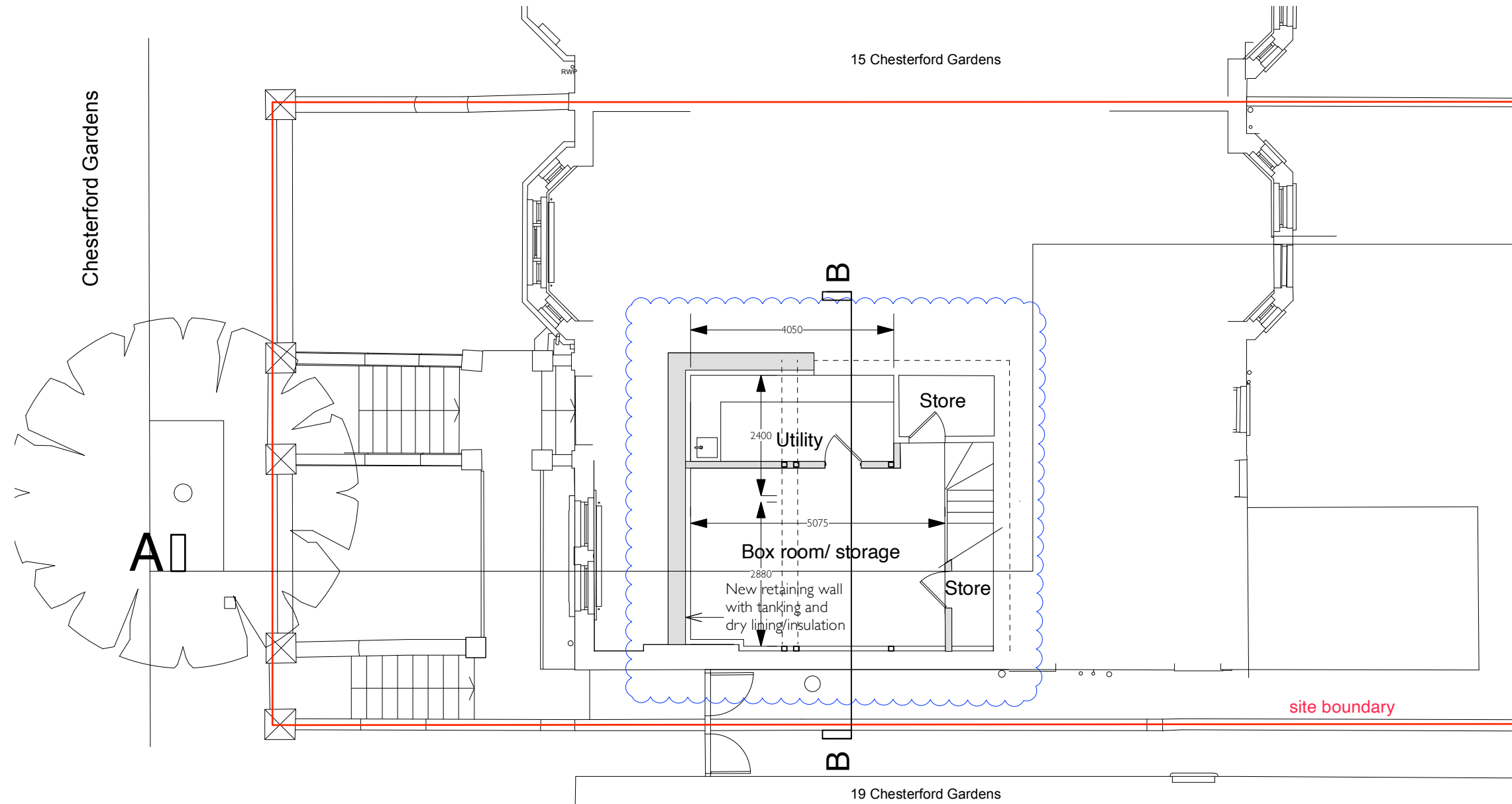

1 Basement Floor Plan As Proposed  
Scale 1:100



A 01 09 2023 Amended where clouded;  
Issued for planning  
(-) 10 10 2022 Issued for planning

Revision

Project

17A Chesterford Gardens  
London NW3 7DD

Title

Basement Floor Plan  
As Proposed

No.

CFG/PL/90 Rev: A

Status

For Information

Scale

1:100 @ A3

Date

3/2022

**Edward  
Rutherford  
Architect**

mail@edwardrutherford.co.uk  
www.edwardrutherford.co.uk