

© Architon LLP 2014

This drawing is the property of Architon LLP and must not be divulged to anyone, copied or reproduced, or used for marketing, advertising or promotional purposes without the express written permission of Architon LLP.

All dimensions are to be checked on site and not scaled from this drawing. Contractors must verify all dimensions on site before setting out, commencing work or preparing shop drawings. Any discrepancies on this drawing with other contract documentation to be reported immediately for clarification.



EXISTING INFILLED DOOR (ROOM SIDE)    EXISTING INFILLED DOOR AT LOW LEVEL (ROOM SIDE)    EXISTING INFILLED DOOR (ROOM SIDE)    INFILLED DOOR - DECORATED IN (CORRIDOR SIDE)

P1 PHOTOS OF EXISTING DOOR



4 PANEL, SOLID DOOR    4 PANEL DOOR WITH ONE VISION PANEL    4 PANEL DOOR WITH TWO VISION PANEL    BLANK SOLID DOOR    BLANK SOLID DOOR WITH SQUARE VISION PANEL    BLANK SOLID DOOR WITH LINEAR VISION PANEL

P1 PHOTOS OF EXISTING DOORSETS

Notes

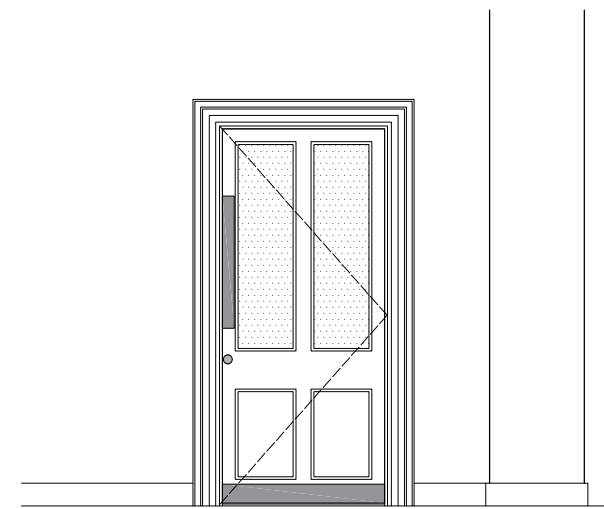
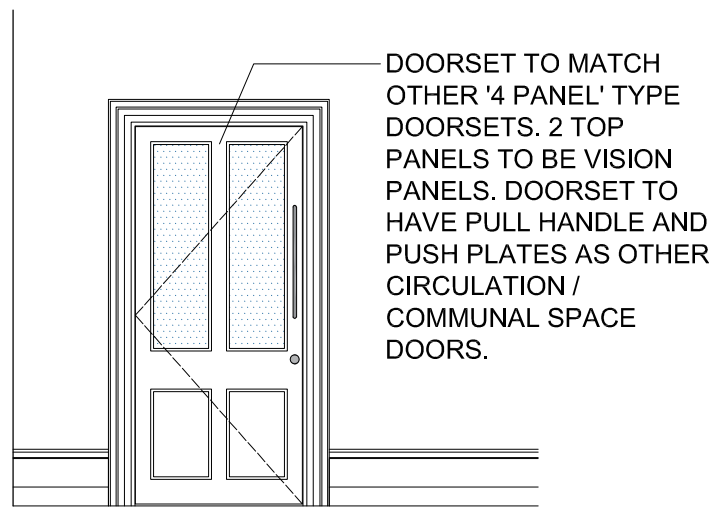
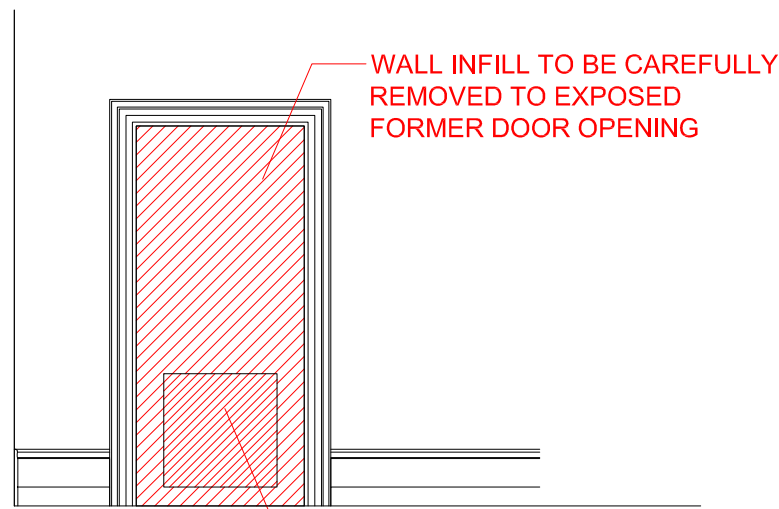

PLANNING ISSUE

P1	PLANNING ISSUE - drawing renumbered	14.08.2023
Rev	Description	Date

Client

Job title  
University College London  
55-59 Gordon Square  
London, WC1H 0NU

Drawing title  
Ground Floor  
Proposed Door and Associated Works  
Planning Application GSP

Scale	Date	Drawn
1:20 @A1	Aug 2023	MJR

ARCHITON LLP

CHARTERED ARCHITECTS . DESIGN . PLANNING CONSULTANTS . DEVELOPMENT . BUILDING COST MANAGEMENT

UPPER DECK    TEL:01372 745600  
17A WEST STREET    FAX:01372 745016  
EPSOM KT18 7RL    Email:info@architon.com

Drawing No	ARCHITON LLP certified to: BS EN ISO 9001 BS EN ISO 14001 IIP Accreditation
3147-GSP-1013 - P1	

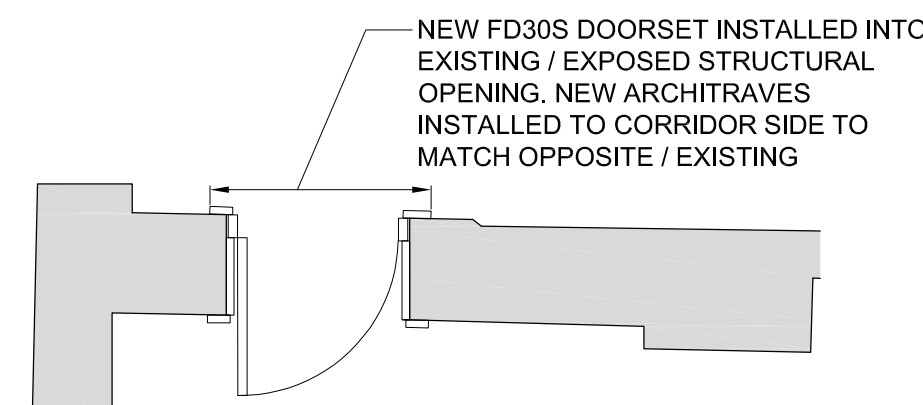
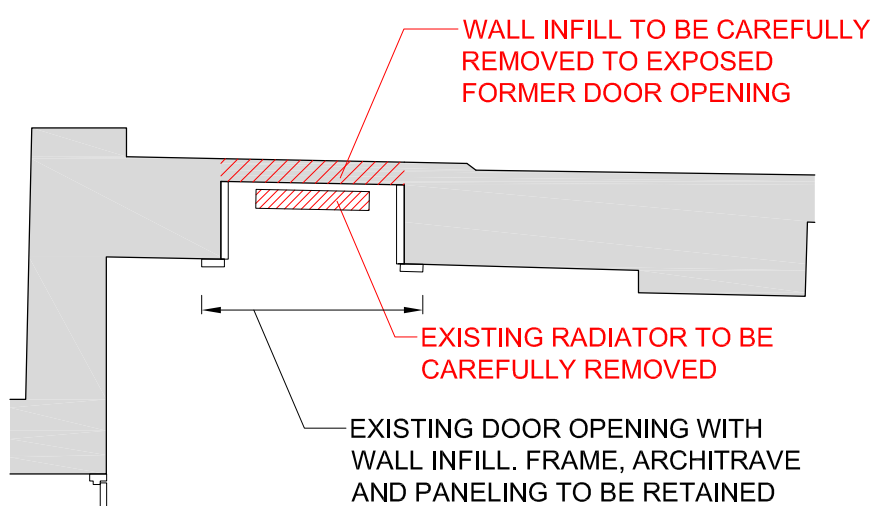

1 GROUND FLOOR - AS EXISTING & DEMOLITIONS  
55-59 GORDON SQUARE    1:20 @ A1

2 GROUND FLOOR - AS PROPOSED  
55-59 GORDON SQUARE    1:20 @ A1

