

Construction (Design and Management) Regulations
 Design risk assessments are carried out throughout the design stage of this project in accordance with company procedures and manuals. Where reasonably possible all areas of risk applicable to design and end use of the construction have been identified and then eliminated, mitigated or reduced to a residual risk. Note the general risk of which a competent designer or contractor should be aware are not included. This drawing is to be used in conjunction with the Pre-construction Information and all related documents prepared in accordance with the current Construction (Design and Management) Regulations 2015 and all applicable Health and Safety legislation as currently amended.

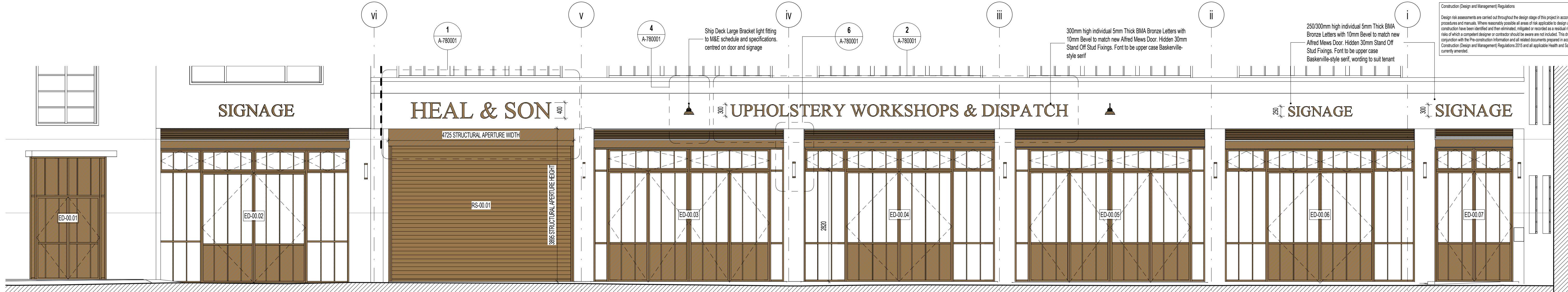

Proposed External Doors Elevation Along Alfred Mews
 1 : 50

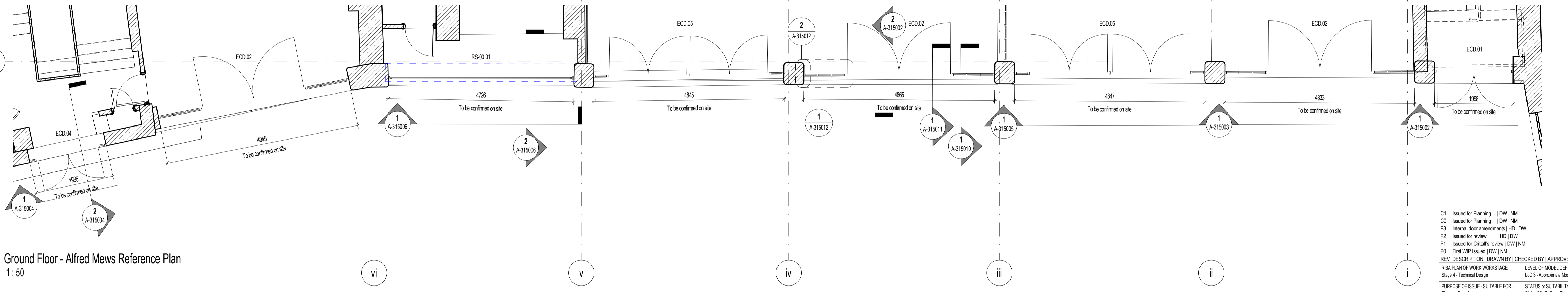

Ground Floor - Alfred Mews Reference Plan
 1 : 50

PPC IGP Golden Brown
 Deep Matt Finish (HWF)

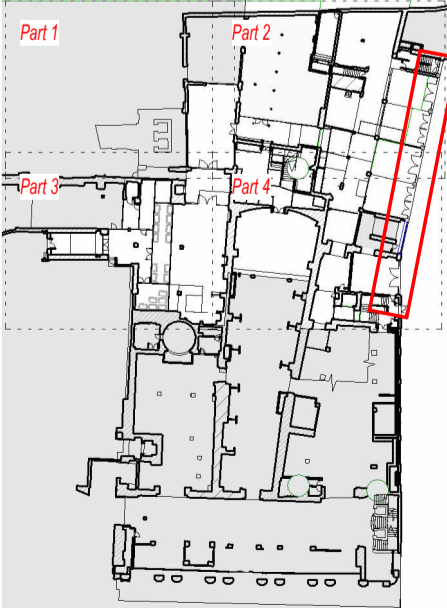

Key Plan

GENERAL NOTES
 ALL DIMENSIONS TO BE CHECKED ON SITE BY SUPPLIERS, PRIOR TO FABRICATING ENTRANCE PRODUCTS/ ELEMENTS. ALL ENTRANCE SCREENS AND DOORSETS TO FIT INTO ALLOWED APERTURES, FOLLOWING DESIGN AND DETAIL OF STRUCTURAL SUPPORT STEELS. FINAL DESIGN OF SCREENS, DOORS & WINDOWS BY SUPPLIER. DRAWINGS TO BE SUBMITTED FOR APPROVAL.

ALL EXTERNAL DOOR FRAMES TO INCLUDE THERMAL BREAK

ALL EXTERNAL DOORSETS TO RECEIVE CONTRASTING IRONMONGERY. REFER TO NBS CLAUSE FOR FURTHER INFORMATION & DETAILS.

COLOUR MATCHED SILICON SEALANT TO FILL PERIMETER INTERNALLY AND EXTERNALLY.

FINAL DESIGNS OF ENTRANCE SCREENS, INCLUDING DOORSETS AND WINDOWS, TO BE SUBMITTED FOR REVIEW AND APPROVAL, PRIOR TO FABRICATION.

SECURITY
 FINAL LEVEL OF SECURITY AND LOCKING IRONMONGERY TO BE CONFIRMED WITH STAKEHOLDERS/ CLIENT

FINAL ACCESS CONTROL DOOR DESIGNATIONS TO BE AGREED WITH END USER, AND SPECIFICATION TO BE TO M&E ENGINEERS DESIGN & SPEC.

DDA & PART M COMPLIANCE (NOT INCLUDING PLANT ROOM DOORS)
 ALL MANUAL ACCESS DOORS TO COMPLY WITH THE REQUIREMENTS AS DETAILED IN AD PART M 2.17 & 3.10, WHICH INCLUDES:
 • AN OPENING FORCE, AT THE LEADING EDGE OF THE DOOR, THAT IS NO MORE THAN 30N FROM 0° (DOOR IN CLOSED POSITION) TO 30° OPEN AND NOT MORE THAN 22.5N FROM 30° TO 60° OF THE OPENING CYCLE.

ANY POWERED ACCESSIBLE DOOR ENTRY SYSTEMS ARE TO BE ACCESSIBLE TO DEAF AND HARD OF HEARING PEOPLE, AND PEOPLE WHO CANNOT SPEAK

PART B COMPLIANCE
 ANY FIRE DOORS TO BE TESTED AND CERTIFIED TO BS 476 OR BS EN 1634-1:2014, AND BE INSTALLED BY A COMPETENT PERSON. CERTIFICATION TO INCLUDE GLAZING WHERE VISION PANELS ARE SPECIFIED. ALL FIRE DOORS TO INCLUDE INTUMESCENT STRIPS TO FRAMES. ANY DOORS WITH 'S' SUFFIX TO FIRE RATING TO INCLUDE SMOKE SEALS.

ALL DOORS WITH ACCESS CONTROLS TO COMPLY WITH REQUIREMENTS DETAILED IN AD PART B 5.7 & 5.8 WHICH INCLUDES:
 • ELECTRICALLY POWERED LOCKS WHICH SHOULD RETURN TO THE UNLOCKED POSITION IN ALL OF THE FOLLOWING SITUATIONS:
 A. IF THE FIRE DETECTION AND ALARM SYSTEM OPERATES
 B. IF THERE IS LOSS OF POWER OR SYSTEM ERROR
 C. IF THE SECURITY MECHANISM OVERRIDE IS ACTIVATED.

SECURITY MECHANISM OVERRIDES FOR ELECTRICALLY POWERED LOCKS SHOULD BE A TYPE 'A' CALL POINT AS DESCRIBED IN BS7273-4. THE CALL POINT SHOULD BE POSITIONED ON THE SIDE APPROACHED BY PEOPLE ESCAPING.

THERMAL PART L COMPLIANCE
 U-VALUE - TBC FOLLOWING BRUKL/ SBEM CALCULATIONS AND ENERGY PERFORMANCE MODELING. MINIMUM 1.5W/m²K

SIGNAGE
 FIRE EXIT SIGNS TO COMPLY WITH EC COUNCIL DIRECTIVE 92/58/EEC AND TO BS EN 5499 (2013).

SAFETY AND SECURITY SIGNS TO COMPLY WITH EC COUNCIL DIRECTIVE 92/58/EEC AND RELEVANT SECTION OF BS EN 5499 (2013)

NBS SPECIFICATIONS
CRITICAL ENTRANCE SCREENS, DOORS, WINDOWS & IRONMONGERY
 NBS REF - Ss_25_30_95_96 WINDOW WALLING SYSTEMS / Pr_30_59_99_83 STEEL WINDOW WALLS

LOUVER VENTS
 NBS REF - Ss_25_30_95_96 WINDOW WALLING SYSTEMS / Pr_30_59_48_13 METAL LOUVER PANEL UNITS

AWNING COVER
 NBS REF - Ss_25_30_95_96 WINDOW WALLING SYSTEMS / Pr_30_59_07_05 AWNINGS

FLASHINGS/ FASCIAS
 NBS REF - Ss_25_30_95_96 WINDOW WALLING SYSTEMS / Pr_35_90_01 ALUMINIUM FLASHINGS

ROLLERSHUTTER GOODS DOOR (RS-00.01)
 NBS REF - Ss_25_30_20_40 INDUSTRIAL DOORSET SYSTEMS / Pr_30_59_84_73 ROLLER SHUTTERS

C1	Issued for Planning	DW NM	24/05/2023
C0	Issued for Planning	DW NM	23/05/2023
P3	Internal door amendments HD DW		19/05/2023
P2	Issued for review	HD DW	17/05/2023
P1	Issued for Critical's review	DW NM	27/04/2023
P0	First WIP Issued	DW NM	10/02/2023
REV.	DESCRIPTION DRAWN BY CHECKED BY APPROVED BY	DATE	
	RBA PLAN OF WORK WORKSTAGE	LEVEL OF MODEL DEFINITION (LOD)	
	Stage 4 - Technical Design	LOD 3 - Approximate Model	
	PURPOSE OF ISSUE - SUITABLE FOR...	STATUS OF SUITABILITY	
	Planning Submission	Status S3 - Delivery Team Review & Comment	



CARDIFF 029 2052 8140
 LONDON 0207 138 3560
 WREXHAM 01978 357 887
 www.lawray.co.uk
 CLIENT
 Conamar

PROJECT TITLE
 Heals Building

DRAWING TITLE
 Proposed External Critical Screens, Doors & Windows
 - Alfred Mews

PROJECT No 19756 SCALE @ A1 1 : 50

DRAWING No	1192	Project	Originator	Volume	Level	Type	Revision
18/12/2022	1803	Project	Originator	Functional	Scale	Form	Discipline
42/2018	18/12/2022	18/12/2022	18/12/2022	18/12/2022	18/12/2022	18/12/2022	18/12/2022
HBL-LAW-X-00-DR-A-315001 C1							

DO NOT SCALE Any discrepancy or query concerning this drawing should be referred to the Architect. Copyright © LAWRAY LIMITED Registered Office: Greenmoor Springs, 1, Cae Gwynedd, Tonypandy, CARDIFF CF15 7AB Reg. Co. No. 272417E. VAT Reg No. 134 2148 06

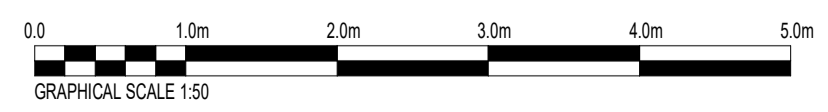

File Name: Autodesk Docs://19756_196TottenhamCourtRd/HBL-LAW-XX-XX-M3-A-000001 - MAIN MODEL.rvt