

IF10a Between dwellings

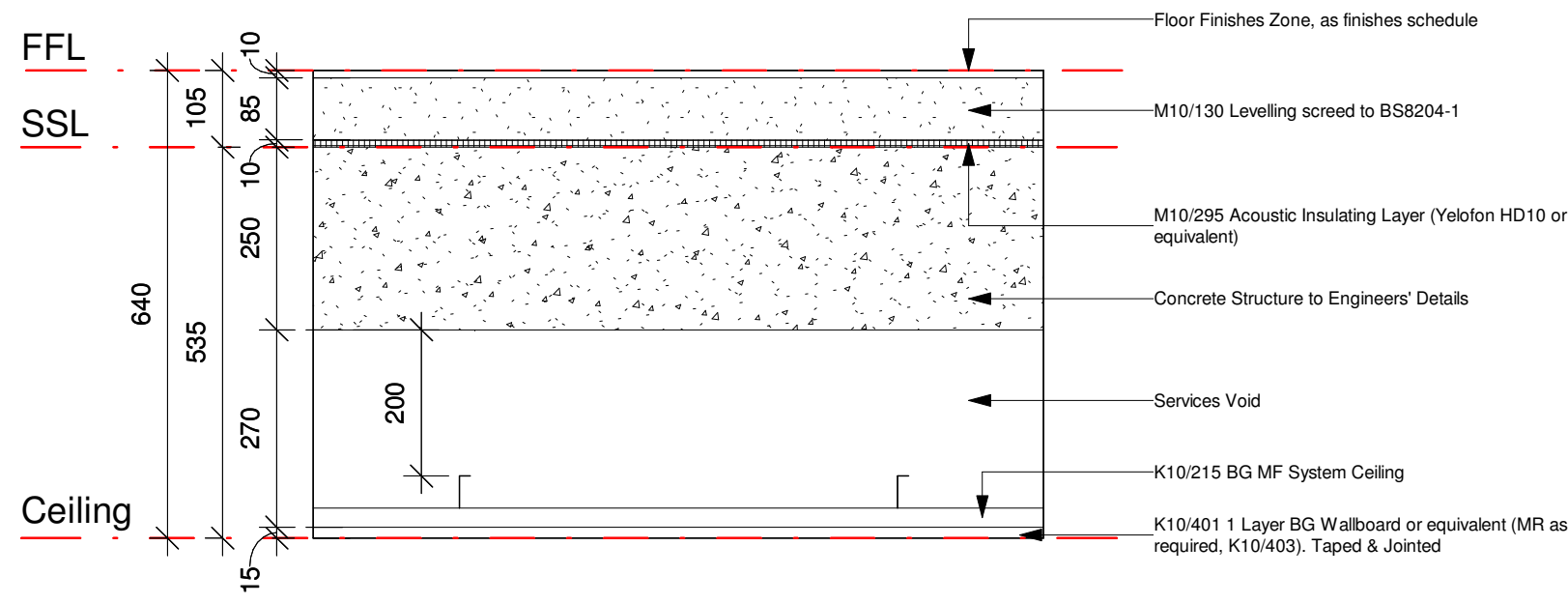

Thickness 640mm

U Value
- Dwelling / Dwelling 0.00 W/m2K
- Dwelling / Common Areas N/A

Resistance to fire REI 120
Acoustic Rating
- Airborne Sound 53dB (Dnt,w+Ctr)
- Impact Sound 54dB (L'nt,w)
Robust Detail E-FC-18

IF10b Between dwellings
Additional service zone*

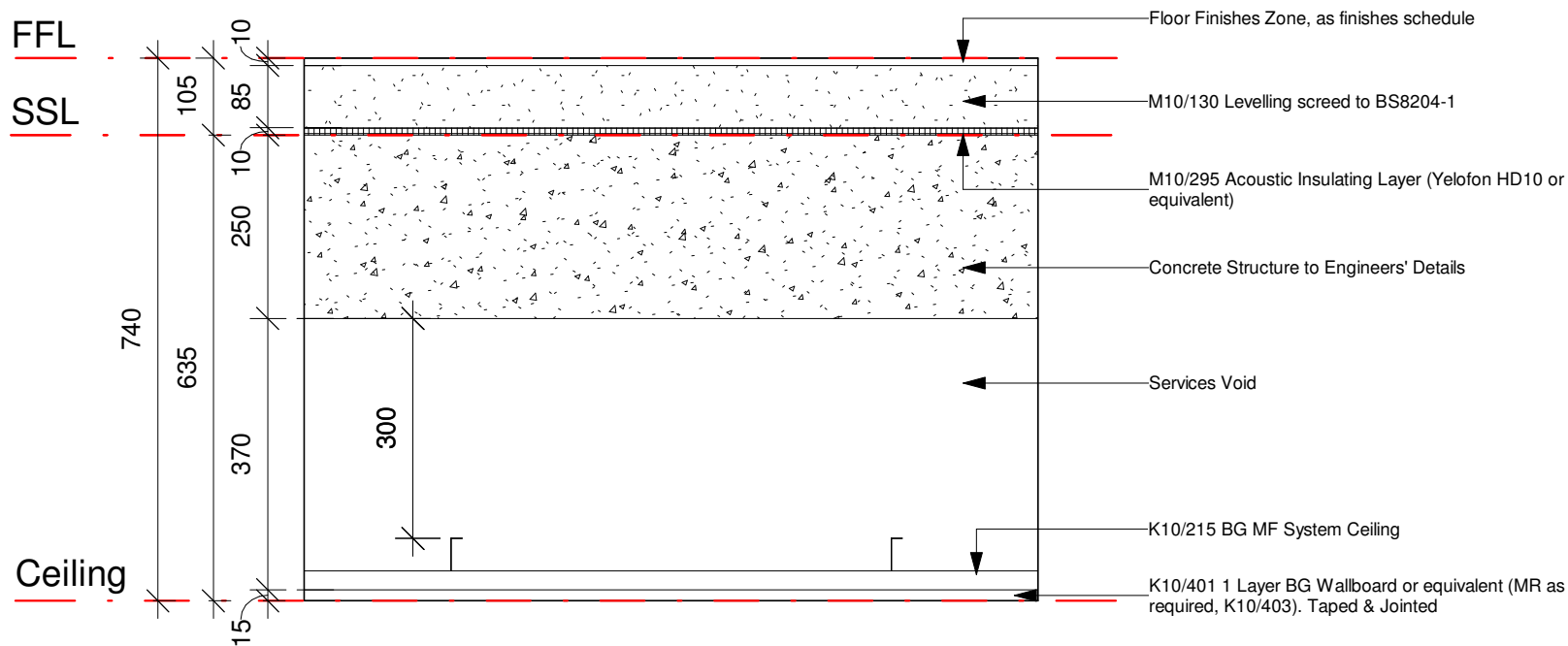

Thickness 740mm

U Value
- Dwelling / Dwelling 0.00 W/m2K
- Dwelling / Common Areas N/A

Resistance to fire REI 120
Acoustic Rating
- Airborne Sound 53dB (Dnt,w+Ctr)
- Impact Sound 54dB (L'nt,w)
Robust Detail E-FC-18

* Additional service zone depths are required in some areas to allow for service cross-overs. See MEP drawings

IF15 Plot 5 Entrance

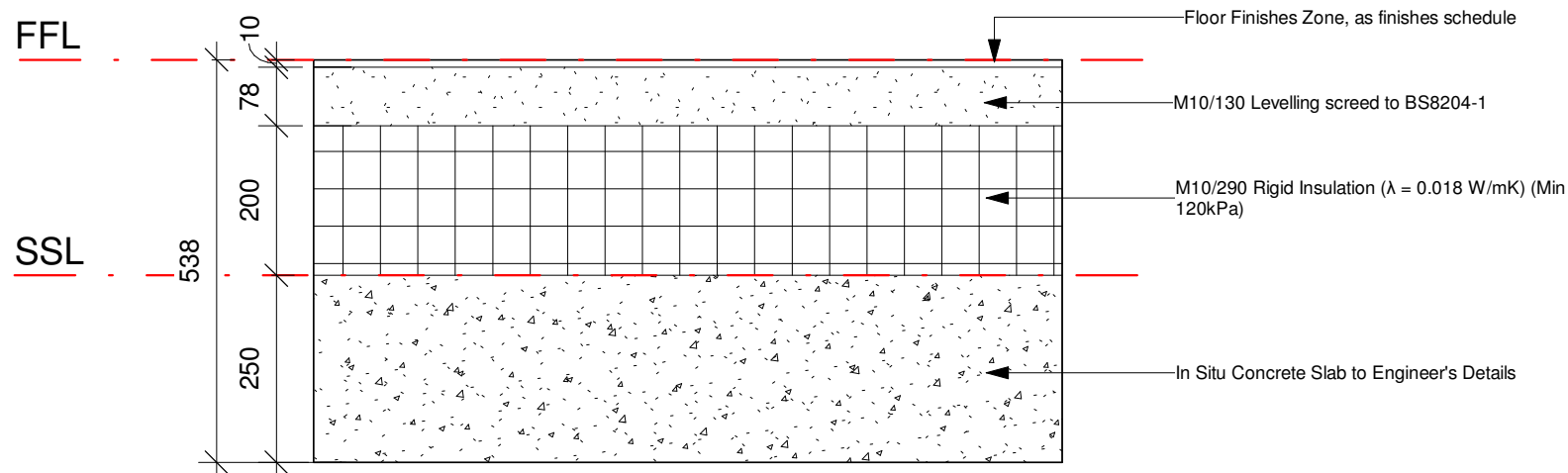

Thickness 540mm

U Value
-Plant room/ Common AreasN/A

Resistance to fire REI 120
Acoustic Rating
- Airborne Sound 53dB (Dnt,w+Ctr)
- Impact Sound 54dB (L'nt,w)
Robust Detail E-FC-18

IF20 Dwellings above internal unheated communal space

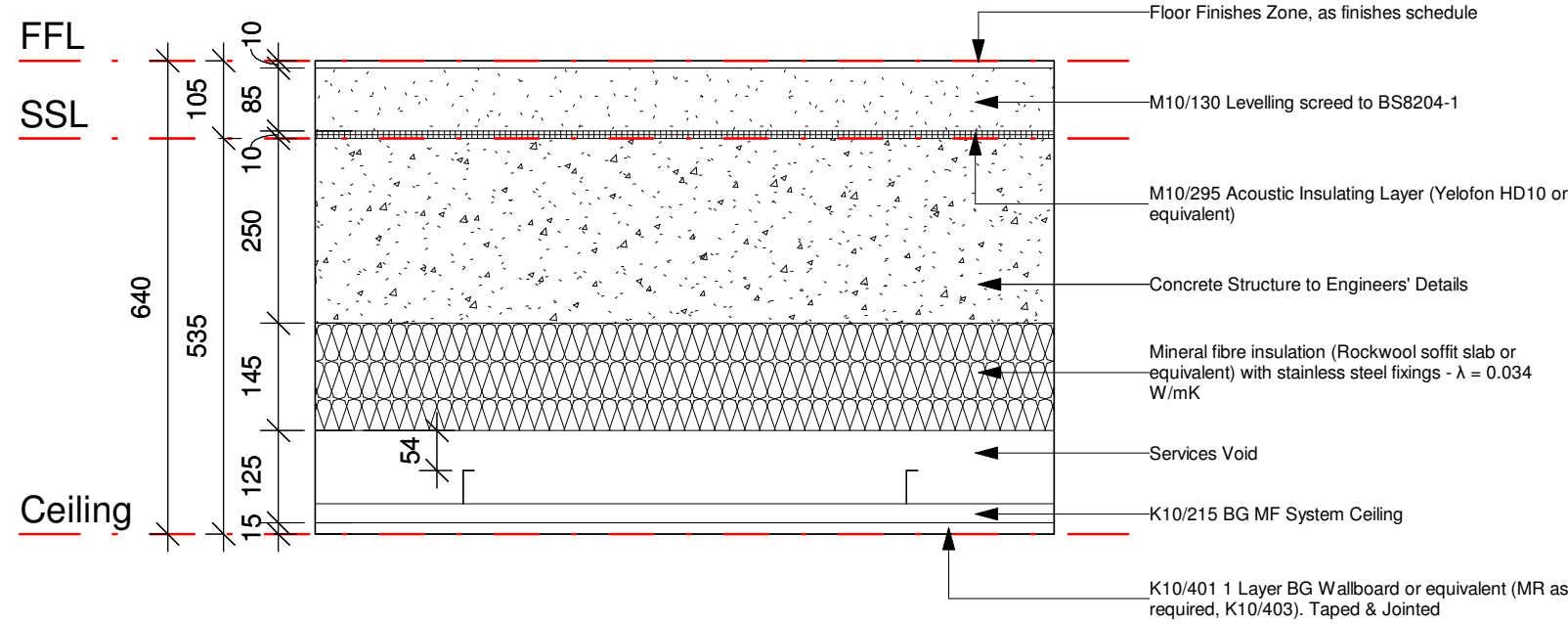

Thickness 640mm

U Value
- Dwelling / Dwelling N/A
- Dwelling / Common Areas 0.19 W/m2K

Resistance to fire REI 120
Acoustic Rating
- Airborne Sound 53 dB (Dnt,w+Ctr)
- Impact Sound 54 dB (L'nt,w)
Robust Detail E-FC-18

IF21 Dwellings above Community Hall*

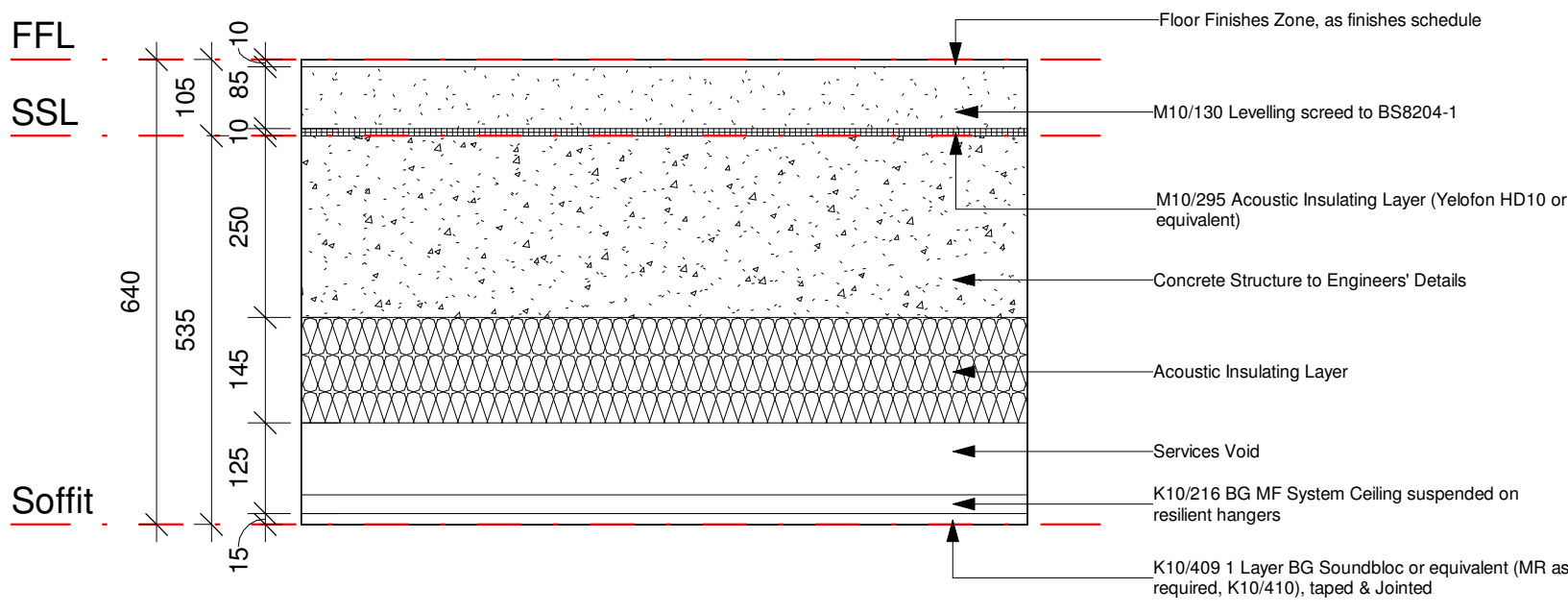

Thickness 640mm

U Value
- Dwelling / Community Hall N/A

Resistance to fire REI 120
Acoustic Rating
- Airborne Sound TBC by acoustician
- Impact Sound TBC by acoustician

*Level of acoustic attenuation dependent on proposed activities in Community Hall and level of acoustic attenuation required. To be agreed with LB Camden

IF30 Dwellings above external or ancilliary space

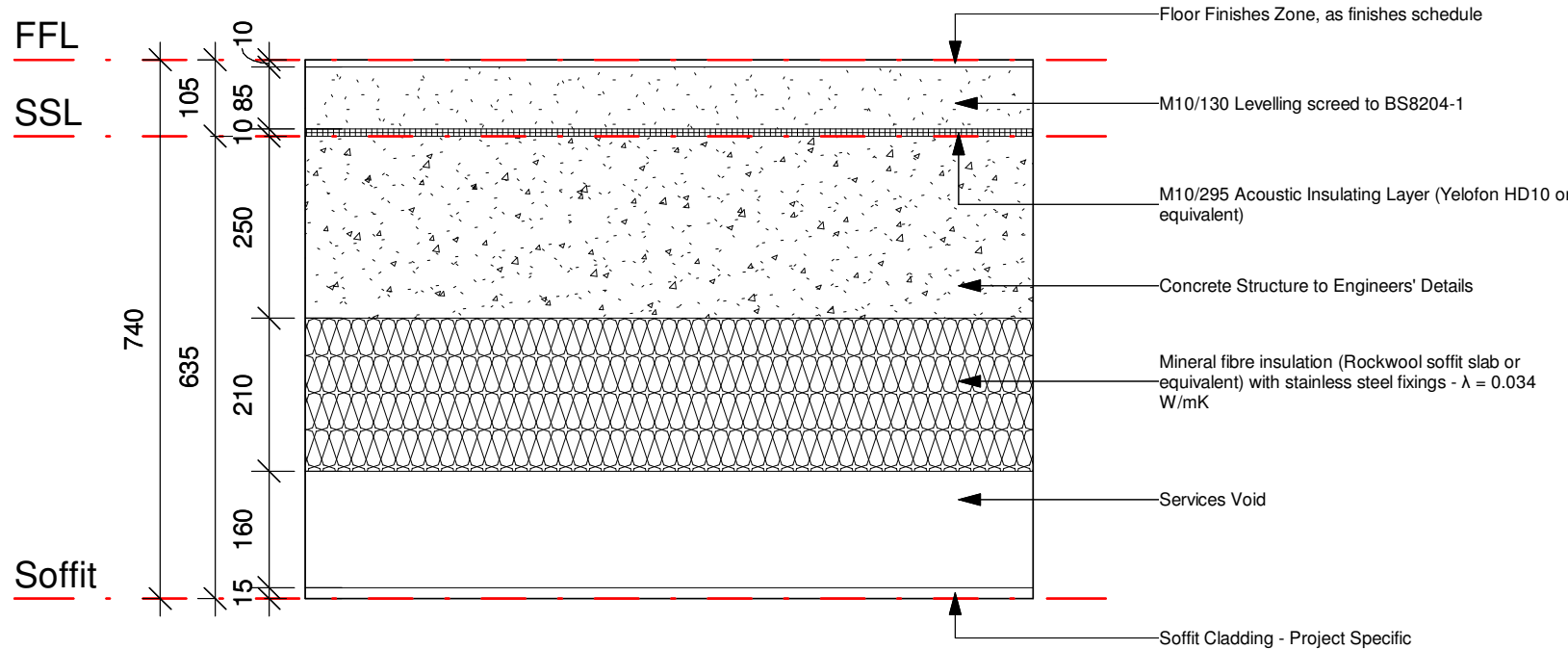

Thickness 740mm

U Value
- Dwelling / Dwelling N/A
- Dwelling / Common Areas 0.14 W/m2K

Resistance to fire REI 120
Acoustic Rating
- Airborne Sound 53 dB (Dnt,w+Ctr)
- Impact Sound 54 dB (L'nt,w)
Robust Detail E-FC-18

Notes

1. Do not scale this drawing.
2. All dimensions must be checked on site and any discrepancies verified with the architect.
3. Unless shown otherwise, all dimensions are to structural surfaces.
4. Drawing to be read with all other issued information. Any discrepancies to be brought to the attention of the architect.
5. This drawing is the copyright of Levitt Bernstein and may not be copied, altered or reproduced in any form, or passed to a third party without license or written consent.
6. This document is prepared for the sole use of London Borough of Camden and no liability to any other persons is accepted by Levitt Bernstein. Levitt Bernstein accepts no liability for use of this drawing by parties other than the party for whom it was prepared or for purposes other than those for which it was prepared.

This is not a construction drawing, it is unsuitable for the purpose of construction and must on no account be used as such.



C02	2023/03/13	Stage 4 Issue	DF/SH
P03	2023/02/10	Stage 4 - Interim issue	DF
P02	2022/12/20	Stage 4 - Interim issue	DF/SH/LS/GC
C01	2022/10/28	Stage 3 Issue	DF
P01	2022/04/19	Initial Draft Issue	SH/RP
Rev	Date	Description	Drawn / Checked

Project name

Central Somers Town, plot 5&6
Camden Residential Development

Drawing number Rev

3873 - LBA - ZZ - ZZ - DR - A - 452005 C02

Drawing

Floor Types - Internal

Purpose of issue
Tender

Scale First issue date
1 : 10 @ A1 08/06/20

Client
London Borough of Camden

London
Thane Studios
2-4 Thane Villas
London N7 7PA
+44 (0)20 7275 7676
Manchester
Bonded Warehouse
18 Lower Byron Street
Manchester M3 4AP
+44 (0)161 669 6740
Levitt Bernstein
levittbernstein.co.uk