

PROPOSED
BASEMENT
FLOOR PLAN - NO CHANGE
1:100

Metal framed glazing to new openings within existing.
Ground floor interior layout updated to re-use more of the existing.

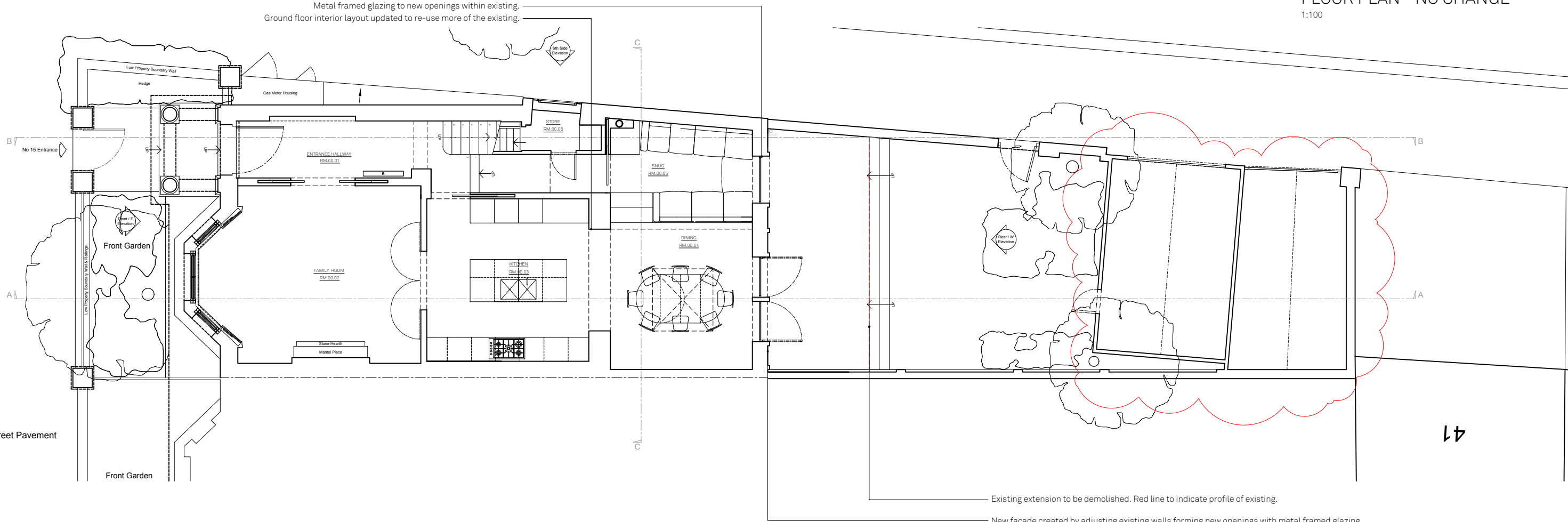

Existing extension to be demolished. Red line to indicate profile of existing.
New facade created by adjusting existing walls forming new openings with metal framed glazing
New facade in brick and stone.

PROPOSED
GROUND
FLOOR PLAN
1:100

REV	DATE	DRAWN/CHK	DESCRIPTION
A	08/08/23	KB/AM	REVISION
-	28/06/23	SC/AM	PLANNING



Scale 1:100 @ A3



North

Do not scale for construction. Use figured dimensions only. All discrepancies to be verified with architect prior to ordering or construction/execution. Confirm all setting out with architect prior to construction. Drawing to be read in conjunction with all other documents. Copyright Architecture for London.

Architecture for London
3-5 Bleeding Heart Yard
London EC1N 8SJ
020 3637 4236
architectureforlondon.com