

Notes

Do not scale, use figured dimensions only.

All dimensions to be verified on site prior to the commencement of any work or the production of any shop drawing. All discrepancies to be reported to the Architect.

This drawing is to be read in conjunction with all related Architect's and Engineer's drawings and any other relevant information.

This drawing is copyright © of TDC Architects Ltd.

| REV | DATE | REVISION | INITIALS | CHECK |
|-----|----------|--|----------|-------|
| A | 04.07.23 | PLANNING ISSUE Addition of tree information following Arboricultural Survey at request of LPA | NS | SEL |
| B | 18.08.23 | PLANNING ISSUE Minor amendments in accordance with LPA: triangular entrance planter omitted; material of planters amended, as clouded | NS | SEL |

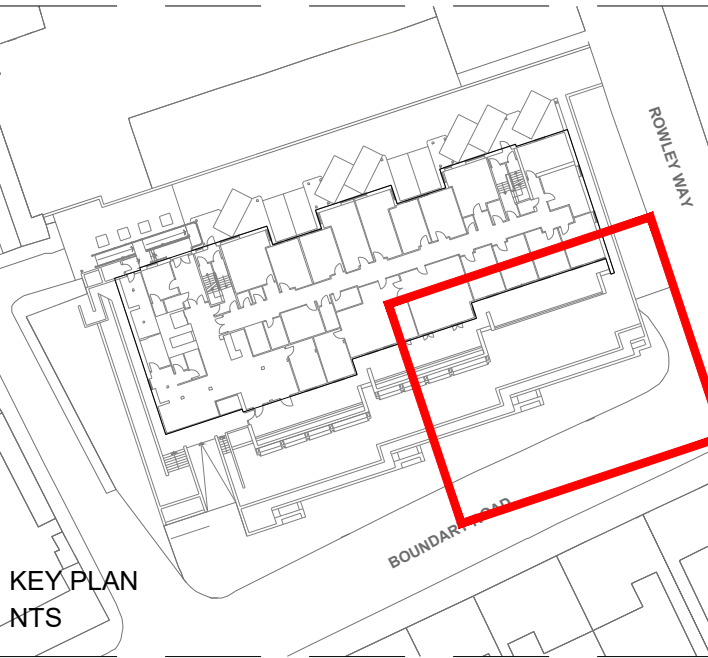

- TREE KEY**
- ROOT PROTECTION AREA
 - CROWN SPREAD
 - CATEGORY A
 - CATEGORY B
 - CATEGORY C

| DRAWING STATUS |
|------------------|
| AS-RECORDED |
| AS-BUILT |
| FOR PLANNING |
| FOR CONSTRUCTION |
| FOR DISCUSSION |
| FOR COORDINATION |
| FOR TENDER |

TDC ARCH DESIGN
The Design Collective Architects

2nd Fl. | 13 Museum St.
York | YO1 7DT
info@tdc-arch.design



Project
**Proposed External Works Development
Hampstead Court Care Home,
St Johns Wood, NW8 0HJ**

Drawing Title
**Proposed Site Plan 2 of 3
Ground Floor Level**

Scale 1:50 @ A1 Date January 2023

Drawn by NS Checked by SEL

Job No. A202038 Drawing No. AL(1)110_2 Rev. B

