

Notes

**Key**

Application site  
GIA - 892m<sup>2</sup>

Applicant's land ownership  
GIA - 706m<sup>2</sup>

Proposed building Total GIA - 1311m<sup>2</sup>

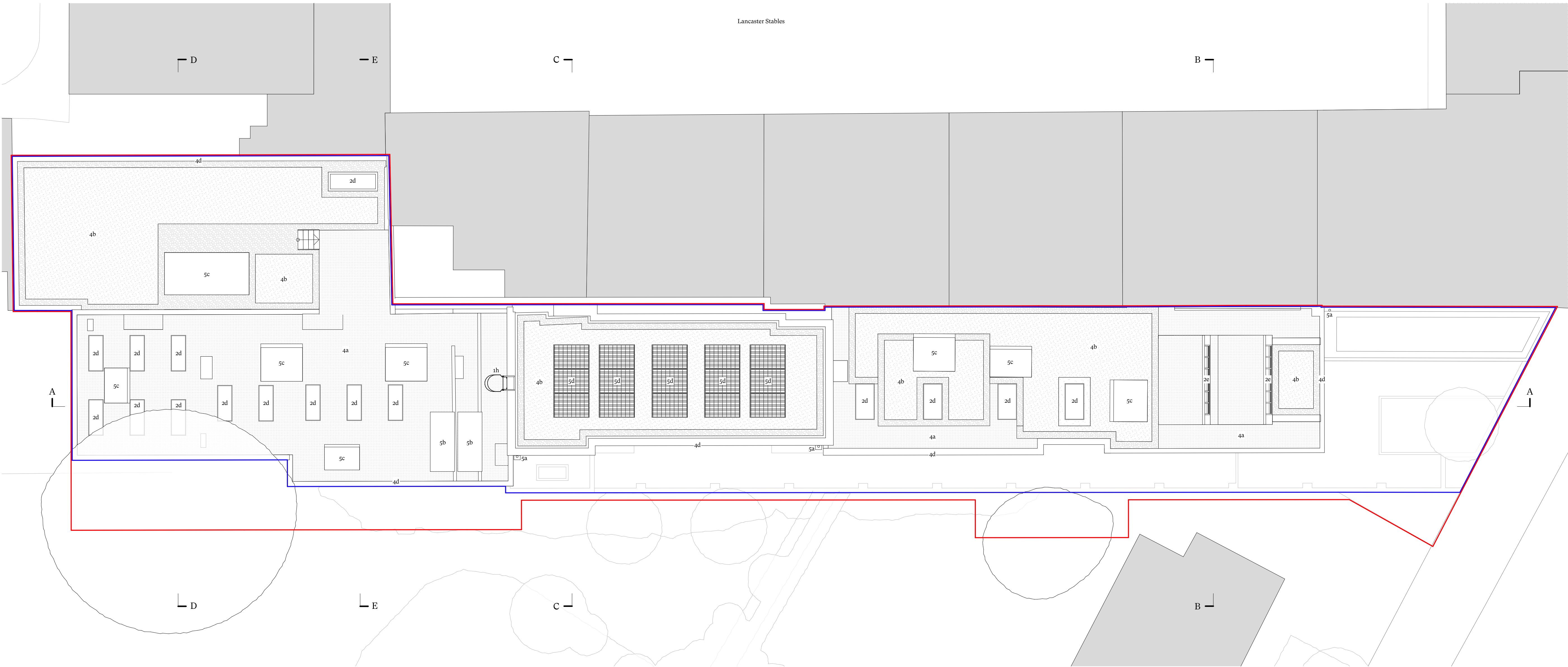

**A** Roof Plan  
Scale 1:100

KEY

- 1 Access**
- 1a Main college entrance
  - 1b Cafe/gallery entrance
  - 1c Fire escape door
  - 1d New code-operated gate
  - 1e New Sheffield cycle stand for 2no. visitor cycles
  - 1f New cycle racks for 30no. student/staff cycles
  - 1g New foldable accessible stairlift
  - 1h New roof access ladder
- 2 Glazing**
- 2a New double-glazed light-coloured powdercoated aluminium framed window
  - 2b New full height double-glazed light-coloured powdercoated aluminium picture window
  - 2c New glazed blocks
  - 2d New flat fixed rooflight
  - 2e New pitched rooflight within sawtooth roof
  - 2f New double-glazed light-coloured powdercoated aluminium framed door
- 3 Walls**
- 3a New acoustic lining to party wall
  - 3b New thermal lining to external wall
  - 3c New red brickwork boundary wall
  - 3d New half height red brickwork boundary wall with dark metal railings above
  - 3e New grey fibre cement clad refuse/cycle store wall
- 4 Roofs**
- 4a New grey flat roof membrane
  - 4b New intensive green roof with gravel border
  - 4c New biosolar roof (intensive green roof with PVs)
  - 4d New light-coloured powdercoated aluminium coping
- 5 Services**
- 5a New dark-coloured powdercoated aluminium rainwater goods to replace existing throughout
  - 5b New air source heat pump
  - 5c New MVHR unit
  - 5d New photovoltaic panels
- 6 Landscaping**
- 6a New permeable dark-coloured brick paving
  - 6b New planted bed with brickwork border
  - 6c New tree within planted bed
  - 6d New low level planter for climbing plants
  - 6e New gravel infill to neighbouring driveway
  - 6f Neighbouring garden made good after works

I	14/08/2023	Planning	SC	RD
H	09/08/2023	Issued to Contributors for Coordination	SC	RD
G	31/07/2023	Stage 1 Cost Issue	SC	RD
F	17/07/2024	Design Process for Coordination	CW	SC
E	14/07/2023	Issued to Client for comment	SC	RD
D	19/06/2023	Issued to Contributors for Coordination	SC	RD

Rev	Date	Issue	Drawn	Check
-----	------	-------	-------	-------

## CDC Studio

Studio, 17 Cornberton Rd, Cambridge CB23 7BA  
5-7 Tanner St, London, SE1 3LE  
info@cdcstudio.co.uk T. 01223 262413

**Project :**  
81 Belsize Park Gardens

**Client :**  
Fine Arts College Ltd

**Address :**  
81 Belsize Park Gardens, Belsize Park,  
London NW3 4NJ

**Date :** 24/02/2023  
**Scale @ A1 :** 1:100

**Drawing Title :**  
Proposed Roof Plan

**Drawing No. :** 4279 CDC XX RL DR A (GA) 140  
**Rev. :** 1