

Notes

Key

- Application site
GIA = 89m²
- Applicant's land ownership
GIA = 729m²
- Proposed building Total GIA = 131m²

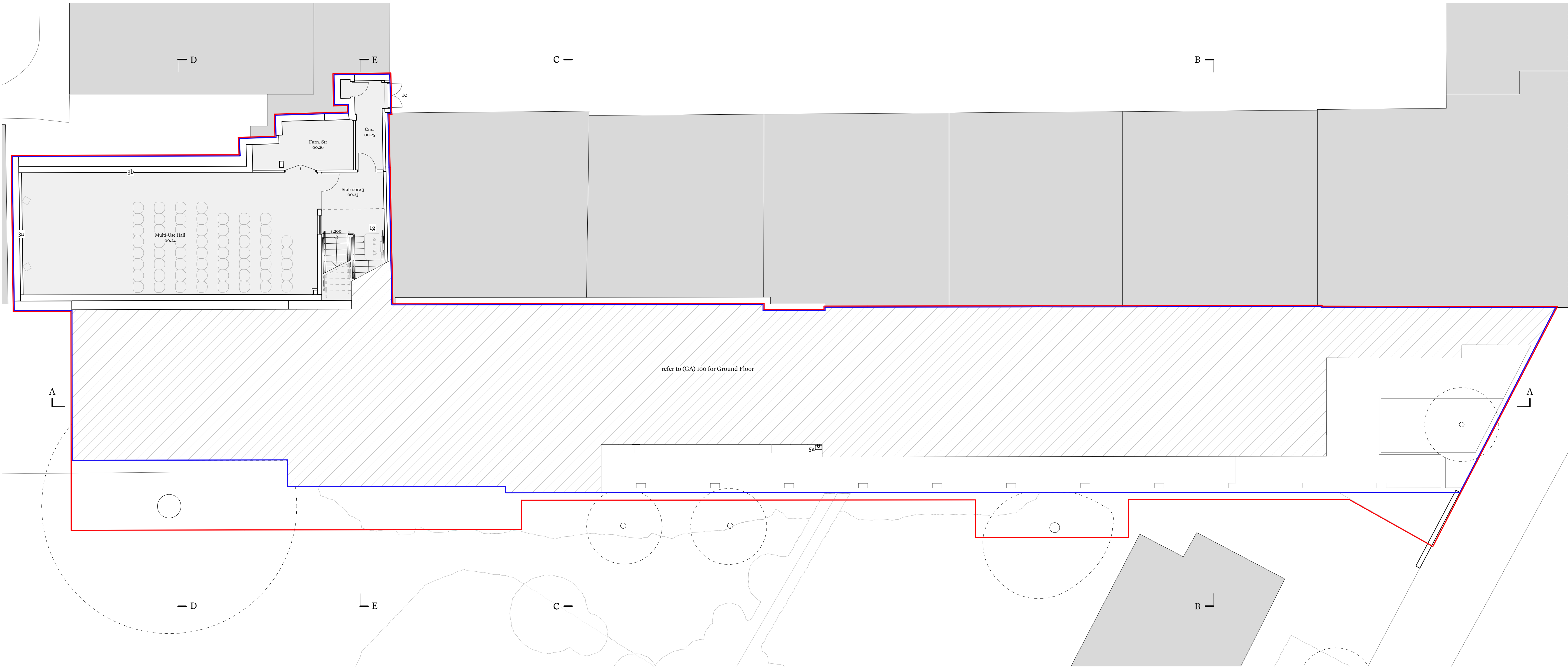

A Upper Ground Floor Plan
Scale 1:100

KEY

- 1 Access**
 - 1a Main college entrance
 - 1b Cafe/gallery entrance
 - 1c Fire escape door
 - 1d New code-operated gate
 - 1e New Sheffield cycle stand for 2no. visitor cycles
 - 1f New cycle racks for 30no. student/staff cycles
 - 1g New foldable accessible stairlift
 - 1h New roof access ladder
- 2 Glazing**
 - 2a New double-glazed light-coloured powdercoated aluminium framed window
 - 2b New full height double-glazed light-coloured powdercoated aluminium picture window
 - 2c New glazed blocks
 - 2d New flat fixed rooflight
 - 2e New pitched rooflight within sawtooth roof
 - 2f New double-glazed light-coloured powdercoated aluminium framed door
- 3 Walls**
 - 3a New acoustic lining to party wall
 - 3b New thermal lining to external wall
 - 3c New red brickwork boundary wall
 - 3d New half height red brickwork boundary wall with dark metal railings above
 - 3e New grey fibre cement clad refuse/cycle store wall
- 4 Roofs**
 - 4a New grey flat roof membrane
 - 4b New intensive green roof with gravel border
 - 4c New biosolar roof (intensive green roof with PVs)
 - 4d New light-coloured powdercoated aluminium coping
- 5 Services**
 - 5a New dark-coloured powdercoated aluminium rainwater goods to replace existing throughout
 - 5b New air source heat pump
 - 5c New MVHR unit
 - 5d New photovoltaic panels
- 6 Landscaping**
 - 6a New permeable dark-coloured brick paving
 - 6b New planted bed with brickwork border
 - 6c New tree within planted bed
 - 6d New low level planter for climbing plants
 - 6e New gravel infill to neighbouring driveway
 - 6f Neighbouring garden made good after works

| | | | | |
|---|------------|---|----|----|
| F | 14/08/2023 | Planning | SC | RD |
| E | 09/08/2023 | Issued to Contributors for Coordination | SC | RD |
| D | 31/07/2023 | Stage 1 Cost Issue | SC | RD |
| C | 17/07/2024 | Design Process for Coordination | CW | SC |
| B | 14/07/2023 | Issued to Client for comment | SC | RD |
| A | 19/06/2023 | Issued to Contributors for Coordination | SC | RD |

| Rev | Date | Issue | Drawn | Check |
|-----|------|-------|-------|-------|
|-----|------|-------|-------|-------|

CDC Studio

Studio, 17 Cornberton Rd, Cambridge CB23 7BA
5-7 Tanner St, London, SE1 3LE
info@cdcstudio.co.uk T. 01223 262413

Project :
81 Belsize Park Gardens

Client :
Fine Arts College Ltd

Address :
81 Belsize Park Gardens, Belsize Park,
London NW3 4NJ

Date : 02/06/2023
Scale @ A1 : 1:100

Drawing Title :
Proposed Upper Ground Floor Plan

Drawing No. : 4279 CDC XX GR DR A (GA) 105
Rev. : F