

Notes

- Key**
- Application site
GIA = 829m²
 - Applicant's land ownership
GIA = 723m²
- Proposed building Total GIA = 1311m²

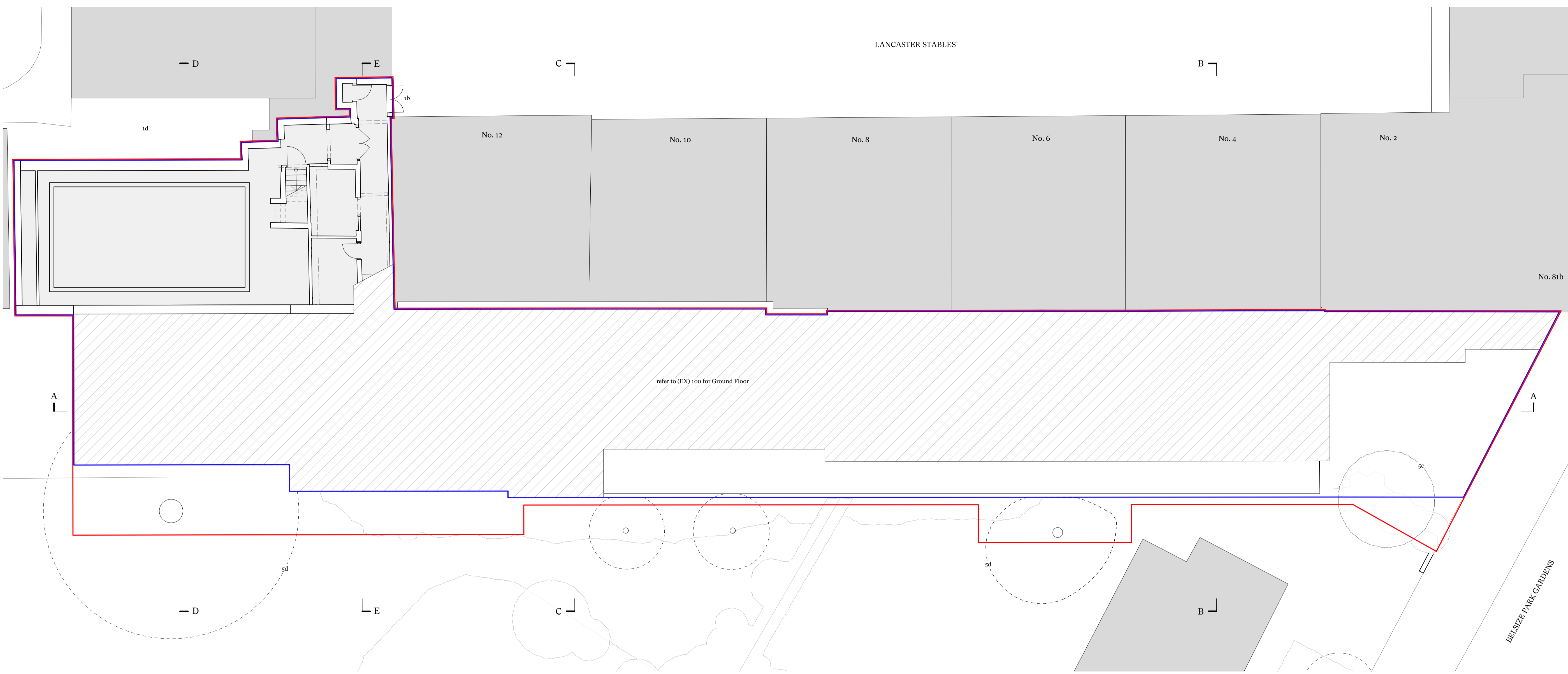

A Existing Upper Ground Floor Plan
Scale 1:100

- KEY**
- 1 Access + Context**
 - 1a Primary entrance
 - 1b Fire escape door
 - 1c Neighbouring fencing
 - 1d Neighbouring garden
 - 1e Neighbouring roof terrace
 - 1f Neighbouring roof lantern
 - 1g Neighbour's plant equipment
 - 2 Glazing**
 - 2a Metal framed window
 - 2b Rooflight
 - 4 Roofs**
 - 4a Flat roof
 - 4b Pitched roof
 - 4c Roof access stair
 - 4d Rooftop enclosure for plant equipment
 - 4e Roof edge protection railing
 - 4f Parapet with stone coping
 - 4g Rooftop plant equipment
 - 5 Landscaping**
 - 5a Concrete paving
 - 5b Low level planter
 - 5c Tree (in poor condition)
 - 5d Neighbour's tree overhanging the application site

14/08/2023	Planning	SC	RD	
15/07/2023	Stage 1a Client Issue	SC	RD	
Rev	Date	Issue	Drawn	Check

CDC Studio
 Studio, 17 Cornberton Rd, Cambridge CB23 7BA
 5-7 Tanner St, London, SE1 3LE
 info@cdcstudio.co.uk T: 01223 262413

Project:
81 Belsize Park Gardens

Client:
Fine Arts College Ltd

Address:
81 Belsize Park Gardens, Belsize Park,
London NW3 4NJ

Date: 09/12/2022
Scale @ A1: 1:100

Drawing Title:
Existing Upper Ground Floor Plan

Drawing No.: 4279 CDC XX UG DR A (EX) 105
Rev.:

