

Notes

**Key**

Application site  
GIA = 89m<sup>2</sup>

Applicant's land ownership  
GIA = 729m<sup>2</sup>

Proposed building Total GIA = 131m<sup>2</sup>

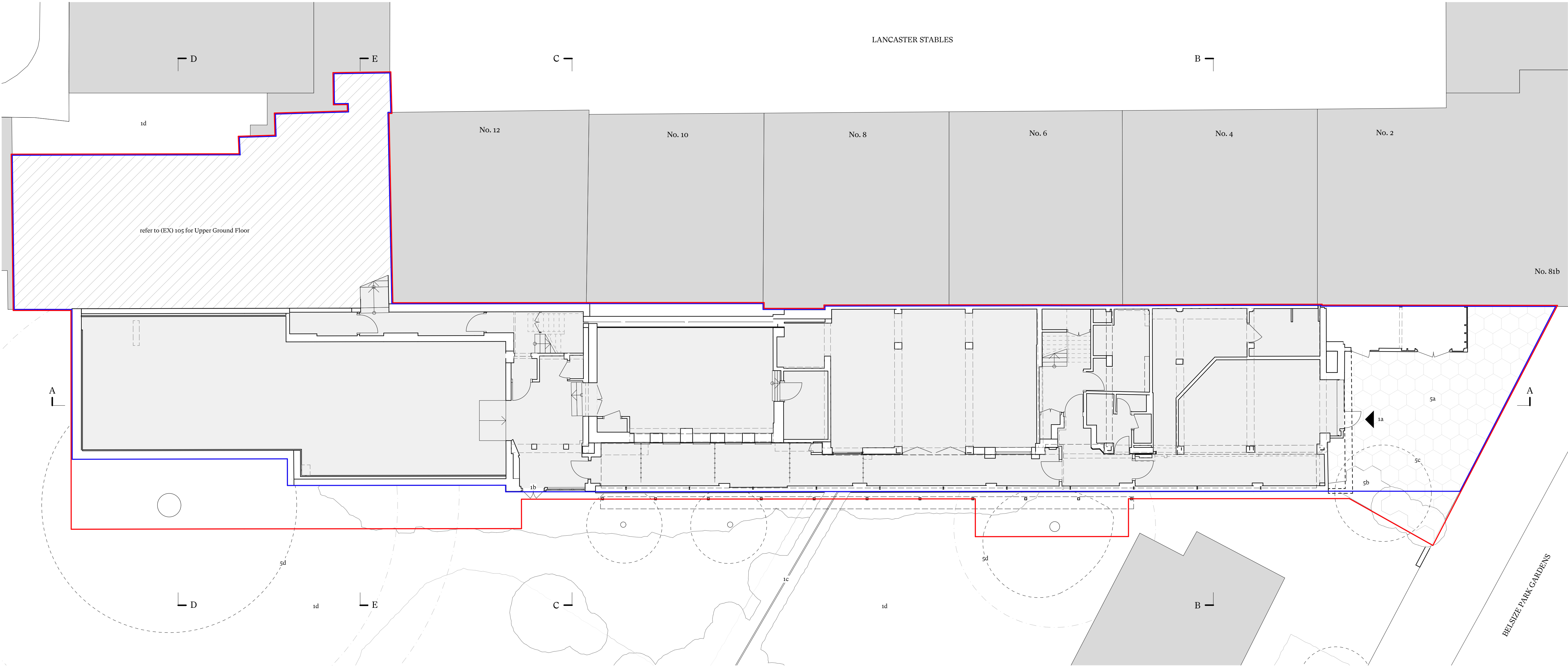

**A** Existing Ground Floor Plan  
Scale 1:100

KEY

- 1 Access + Context**
- 1a Primary entrance
  - 1b Fire escape door
  - 1c Neighbouring fencing
  - 1d Neighbouring garden
  - 1e Neighbouring roof terrace
  - 1f Neighbouring roof lantern
  - 1g Neighbour's plant equipment
- 2 Glazing**
- 2a Metal framed window
  - 2b Rooflight
- 4 Roofs**
- 4a Flat roof
  - 4b Pitched roof
  - 4c Roof access stair
  - 4d Rooftop enclosure for plant equipment
  - 4e Roof edge protection railing
  - 4f Parapet with stone coping
  - 4g Rooftop plant equipment
- 5 Landscaping**
- 5a Concrete paving
  - 5b Low level planter
  - 5c Tree (in poor condition)
  - 5d Neighbour's tree overhanging the application site

E	14/08/2023	Planning	SC	RD
D	31/07/2023	Stage 1 Cost Issue	SC	RD
C	03/02/2023	Issue to Design Team	CW	ES
B	21/12/2022	Stage 2 Issue	CW	ES
A	15/12/2022	Stage 2 Draft Issue	CW	ES
-	09/12/2022	Preliminary Issue	CW	JH

**CDC Studio**

Studio, 17 Cornberton Rd, Cambridge CB23 7BA  
5-7 Tanner St, London, SE1 3LE  
info@cdcstudio.co.uk T. 01223 262413

**Project :**  
81 Belsize Park Gardens

**Client :**  
Fine Arts College Ltd

**Address :**  
81 Belsize Park Gardens, Belsize Park,  
London NW3 4NJ

**Date :** 09/12/2022  
**Scale @ A1 :** 1:100

**Drawing Title :**  
Existing Ground Floor Plan

**Drawing No. :** 4279 CDC XX GR DR A (EX) 100  
**Rev. :** E

