

Notes:

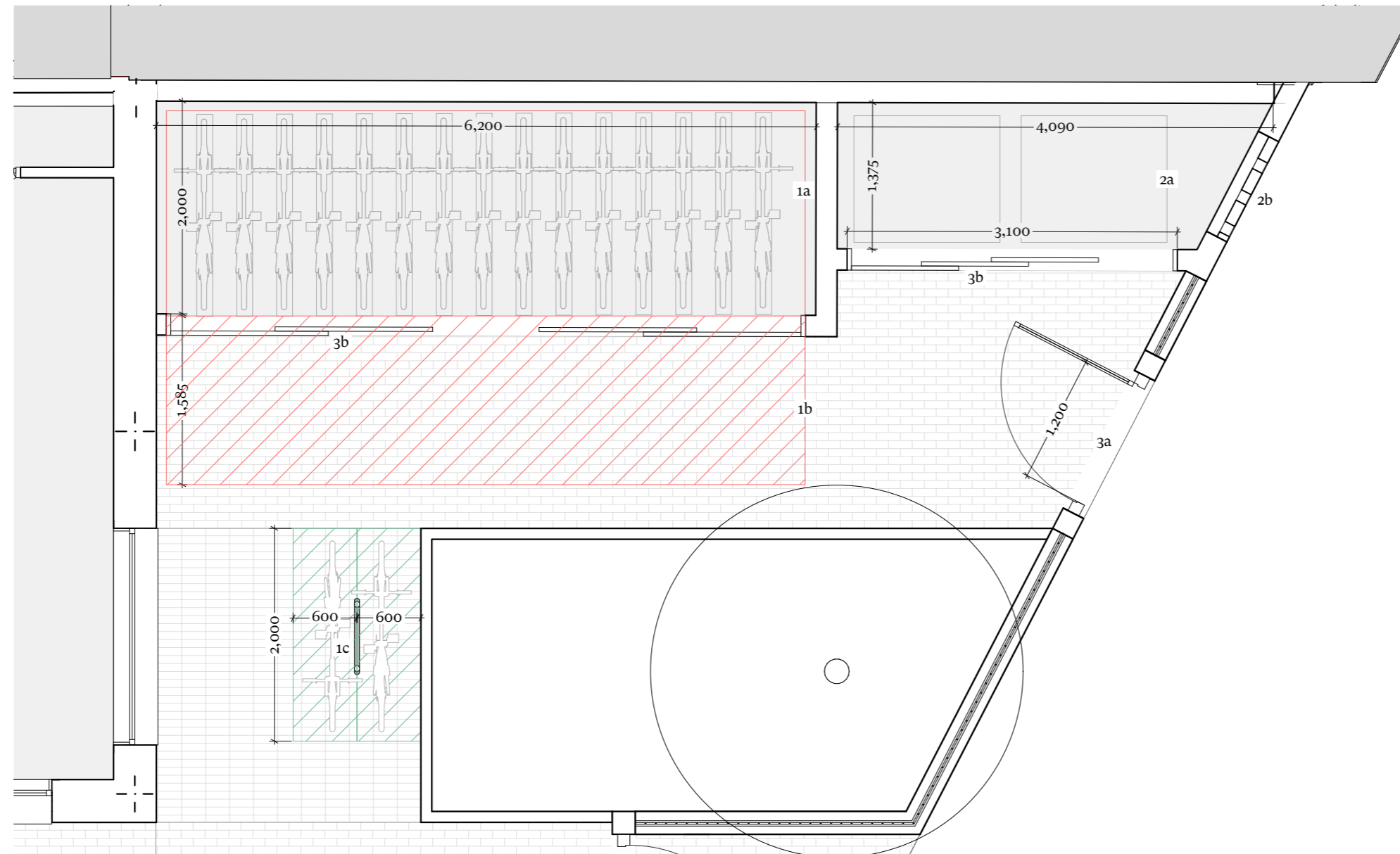

**A** Cycle Refuse Store Ground Floor Plan  
 (81) 100 Scale 1:50

**KEY**

- 1 Proposed cycle provision**
  - 1a Two-tier cycle rack for 30no. standard cycles
  - 1b Clearance zone for cycle rack extension
  - 1c Sheffield-type stand for 2no. visitor cycles
- 2 Proposed refuse store**
  - 2a Space for 2no. 1100 litre Euro-type bins (allowance for general waste and recycling)
  - 2b Perforated brickwork wall for ventilation
- 3 Access + materiality**
  - 3a Dark metal gate with 1200mm clear opening
  - 3b Lockable grey fibre cement clad telescopic sliding doors
  - 3c Grey fibre cement cladding
  - 3d Light-coloured roof trim
  - 3e Intensive green roof with gravel border



Rev	Date	Issue	Drawn	Check
C	16/08/2023	Updated Planning Drawings	SC	RD
B	14/08/2023	Planning	SC	RD
A	31/07/2023	Stage 3 Cost Issue	SC	RD
-	07/07/2023	DRAFT Issue to Planning	CW	SC

# CDC Studio

Studio, 17 Comberton Rd, Cambridge CB23 7BA  
 5-7 Tanner St, London, SE1 3LE  
 info@cdcstudio.co.uk T. 01223 262413

**Project :**  
 81 Belsize Park Gardens

**Client :**  
 Fine Arts College Ltd

**Address :**  
 81 Belsize Park Gardens, Belsize Park,  
 London NW3 4NJ

**Date :** 07/07/2023 **Scale @ A3 :** 1:50

**Drawing Title :**  
 Cycle and Refuse Store Plans

**Drawing No. :** 4279 CDC XX ZZ DR A (81) 100 **Rev. :** C