

Mix %	Title	Quantity	Centres	Height	Root Condition
50%	Hebe sutherlandii	53	6/m2	20-30cm	Container: 2-3L
50%	Hebe 'Red Edge'	53	6/m2	20-30cm	Container: 2-3L

To be planted in groups of 3-5 in random setting out

- Notes**
1. Do not scale this drawing.
 2. All dimensions must be checked on site and any discrepancies verified with the architect.
 3. Unless shown otherwise, all dimensions are to structural surfaces.
 4. Drawing to be read with all other issued information. Any discrepancies to be brought to the attention of the architect.
 5. This drawing is the copyright of Levitt Bernstein and may not be copied, altered or reproduced in any form, or passed to a third party without license or written consent.
 6. This document is prepared for the sole use of GM London and no liability to any other persons is accepted by Levitt Bernstein. Levitt Bernstein accepts no liability for use of this drawing by parties other than the party for whom it was prepared or for purposes other than those for which it was prepared.

Rev	Date	Description	Drawn / Checked
P03	04/08/23	Planting amended	SA
C01	21/04/23	For Construction	SA
P02	18/10/22	Planting Updated	SA
P01	29/09/22	Planning Condition Submission	SA

Project name
19-37 Highgate Road
 Landscape Model

Drawing number
 3888 - LB - ZZ - 00 - DP - L - 200102 **P03**

Drawing
 Planting Proposals - Level 00

TOPSOIL VOLUME MARK_UP

Scale
 1 : 100 @ A1

Date
 01/07/22

Client
 GM London

London
 Thane Studios
 2-4 Thane Villas
 London N7 7PA
 +44 (0)20 7275 7676

Manchester
 Bonded Warehouse
 18 Lower Byron Street
 Manchester M3 4AP
 +44 (0)161 699 8740

Levitt Bernstein
 levittbernstein.co.uk

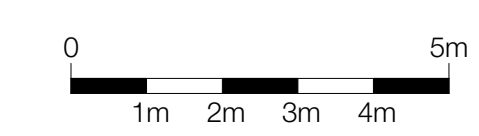

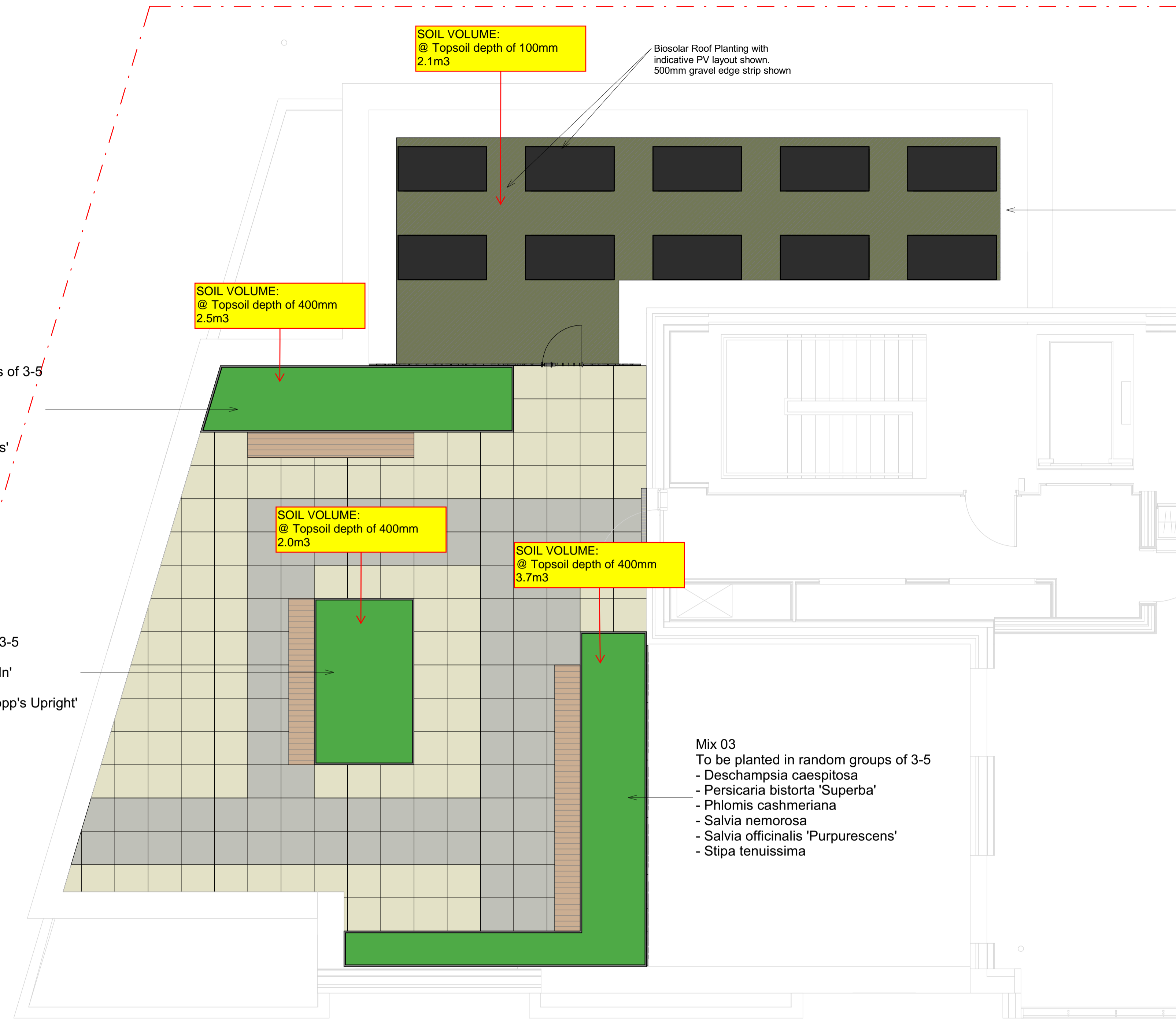

SOIL VOLUME:
@ Topsoil depth of 100mm
2.1m³

SOIL VOLUME:
@ Topsoil depth of 400mm
2.5m³

SOIL VOLUME:
@ Topsoil depth of 400mm
2.0m³

SOIL VOLUME:
@ Topsoil depth of 400mm
3.7m³

Biosolar Roof Planting with
indicative PV layout shown.
500mm gravel edge strip shown

Mix 03
To be planted in random groups of 3-5
- Deschampsia caespitosa
- Persicaria bistorta 'Superba'
- Phlomis cashmeriana
- Salvia nemorosa
- Salvia officinalis 'Purpurescens'
- Stipa tenuissima

Mix 02
To be planted in random groups of 3-5
- Deschampsia caespitosa
- Pennisetum alopecuroides 'Hameln'
- Perovskia atriplicifolia 'Blue Spire'
- Rosmarinus officinalis 'Miss Jessopp's Upright'
- Stachys byzantina 'Silver Carpet'

Mix 03
To be planted in random groups of 3-5
- Deschampsia caespitosa
- Persicaria bistorta 'Superba'
- Phlomis cashmeriana
- Salvia nemorosa
- Salvia officinalis 'Purpurescens'
- Stipa tenuissima

Biosolar species

Wildflower Species

- Yarrow
- Clustered bellflower
- Harebell
- Cornflower
- Greater knapweed
- Wild basil
- Viper's bugloss
- Autumn hawkbit
- Common toadflax
- Bird's foot trefoil
- Wild marjoram
- Fox and cubs
- Field scabious
- Bladder campion
- Red campion
- Wild thyme

Plug Planting

- Dog Violet
- Selfheal
- Yarrow
- Bugle

Requirements for green roof and PV mix areas

- Sedum sprouts only to be sown beneath PV panels.
- Wildflower seeds and plug-plants are not to be sown within 500mm of the PV panels.

Notes

1. Do not scale this drawing.
2. All dimensions must be checked on site and any discrepancies verified with the architect.
3. Unless shown otherwise, all dimensions are to structural surfaces.
4. Drawing to be read with all other issued information. Any discrepancies to be brought to the attention of the architect.
5. This drawing is the copyright of Levitt Bernstein and may not be copied, altered or reproduced in any form, or passed to a third party without license or written consent.
6. This document is prepared for the sole use of GM London and no liability to any other persons is accepted by Levitt Bernstein. Levitt Bernstein accepts no liability for use of this drawing by parties other than the party for whom it was prepared or for purposes other than those for which it was prepared.

This is not a construction drawing, it is unsuitable for the purpose of construction and must on no account be used as such.

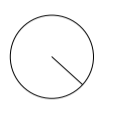

Class	Title	Mix %	Centres	Form	Age	Height	Root Cond	Container	Min Brks	Min Buds	Prop Method	Habit
Roof areas - Mix 02	Deschampsia caespitosa [Tufted hairgrass or fairy wand]	20.00%	0.4m				C	1-2L			V	
Roof areas - Mix 02	Pennisetum alopecuroides 'Hameln' [Fountain grass]	20.00%	0.4m				C	1-2L			S or V	
Roof areas - Mix 02	Perovskia atriplicifolia 'Blue Spire'	20.00%	0.4m			25-30cm	C	2L	3			Bushy
Roof areas - Mix 02	Rosmarinus officinalis 'Miss Jessopp's Upright' [Rosemary]	20.00%	0.4m			30-40cm	C	3L	4			Bushy
Roof areas - Mix 02	Stachys byzantina 'Silver Carpet' [Lamb's ear]	20.00%	0.4m				C	1-2L			V	
Roof areas - Mix 03	Deschampsia caespitosa [Tufted hairgrass or fairy wand]	20.00%	0.4m				C	1-2L			V	
Roof areas - Mix 03	Persicaria bistorta 'Superba' [Knotweed 'Superba']	15.00%	0.4m				C	1-2L			V	
Roof areas - Mix 03	Phlomis cashmeriana [Jerusalem sage]	15.00%	0.4m				C	1-2L			V	
Roof areas - Mix 03	Salvia nemorosa [Balkan clary]	15.00%	0.4m				C	1-2L			V	
Roof areas - Mix 03	Salvia officinalis 'Purpurescens' [Purple sage]	15.00%	0.4m				C	1-2L			V	
Roof areas - Mix 03	Stipa tenuissima [Feather grass]	20.00%	0.4m				C	1-2L			S or V	

P02	18/10/22	B04 now 1800mm, Gravel Strip now 500mm	SA
P01	29/09/22	Planning Condition Submission	SA
Rev	Date	Description	Drawn / Checked

Project name

19-37 Highgate Road
Landscape Model

Drawing number

3888 - LB - ZZ - 05 - DP - L - 200112 **P02**

Drawing

Planting Proposals - Level 05

TOPSOIL VOLUME MARK_UP

Scale 1 : 50 @ A1 Date 01/07/22

Client GM London

Levitt Bernstein
levittbernstein.co.uk

London
Thane Studios
2-4 Thane Villas
London N7 7PA
+44 (0)20 7275 7676

Manchester
Bonded Warehouse
18 Lower Byron Street
Manchester M3 4AP
+44 (0)161 699 8740

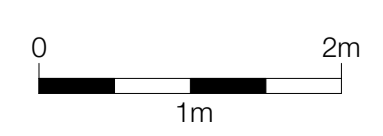

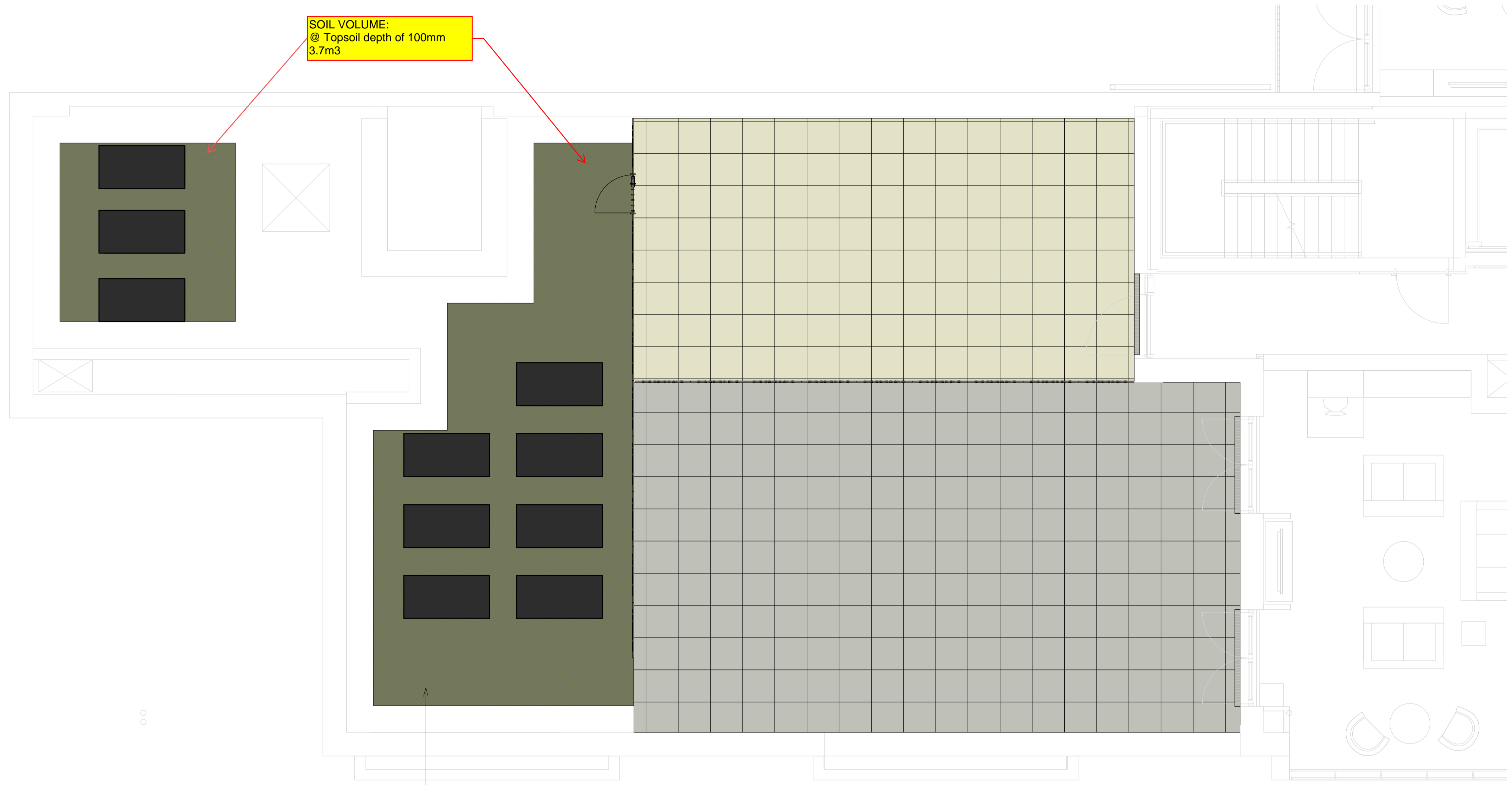

SOIL VOLUME:
@ Topsoil depth of 100mm
3.7m³

Biosolar species

Wildflower Species

- Yarrow
- Clustered bellflower
- Harobell
- Cornflower
- Greater knapweed
- Wild basil
- Viper's bugloss
- Autumn hawkbit
- Common toadflax
- Bird's foot trefoil
- Wild marjoram
- Fox and cubs
- Field scabious
- Bladder campion
- Red campion
- Wild thyme

Plug Planting

- Dog Violet
- Selfheal
- Yarrow
- Bugle

Requirements for green roof and PV mix areas

- Sedum sprouts only to be sown beneath PV panels.
- Wildflower seeds and plug-plants are not to be sown within 500mm of the PV panels.

Notes

1. Do not scale this drawing.
2. All dimensions must be checked on site and any discrepancies verified with the architect.
3. Unless shown otherwise, all dimensions are to structural surfaces.
4. Drawing to be read with all other issued information. Any discrepancies to be brought to the attention of the architect.
5. This drawing is the copyright of Levitt Bernstein and may not be copied, altered or reproduced in any form, or passed to a third party without license or written consent.
6. This document is prepared for the sole use of GM London and no liability to any other persons is accepted by Levitt Bernstein. Levitt Bernstein accepts no liability for use of this drawing by parties other than the party for whom it was prepared or for purposes other than those for which it was prepared.

This is not a construction drawing, it is unsuitable for the purpose of construction and must on no account be used as such.

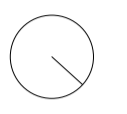

P02	18/10/22	Gravel strips to be 500mm	SA
P01	29/09/22	Planning Condition Submission	SA
Rev	Date	Description	Drawn / Checked

Project name

19-37 Highgate Road
Landscape Model

Drawing number

3888 - LB - ZZ - 06 - DP - L - 200122 **P02**

Drawing

Planting Proposals - Level 06

TOPSOIL VOLUME MARK_UP

Scale: 1 : 50 @ A1 Date: 01/07/22

Client: GM London

Levitt Bernstein
levittbernstein.co.uk

London
Thane Studios
2-4 Thane Villas
London N7 7PA
+44 (0)20 7275 7676

Manchester
Bonded Warehouse
18 Lower Byron Street
Manchester M3 4AP
+44 (0)161 659 8740

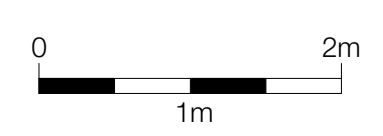

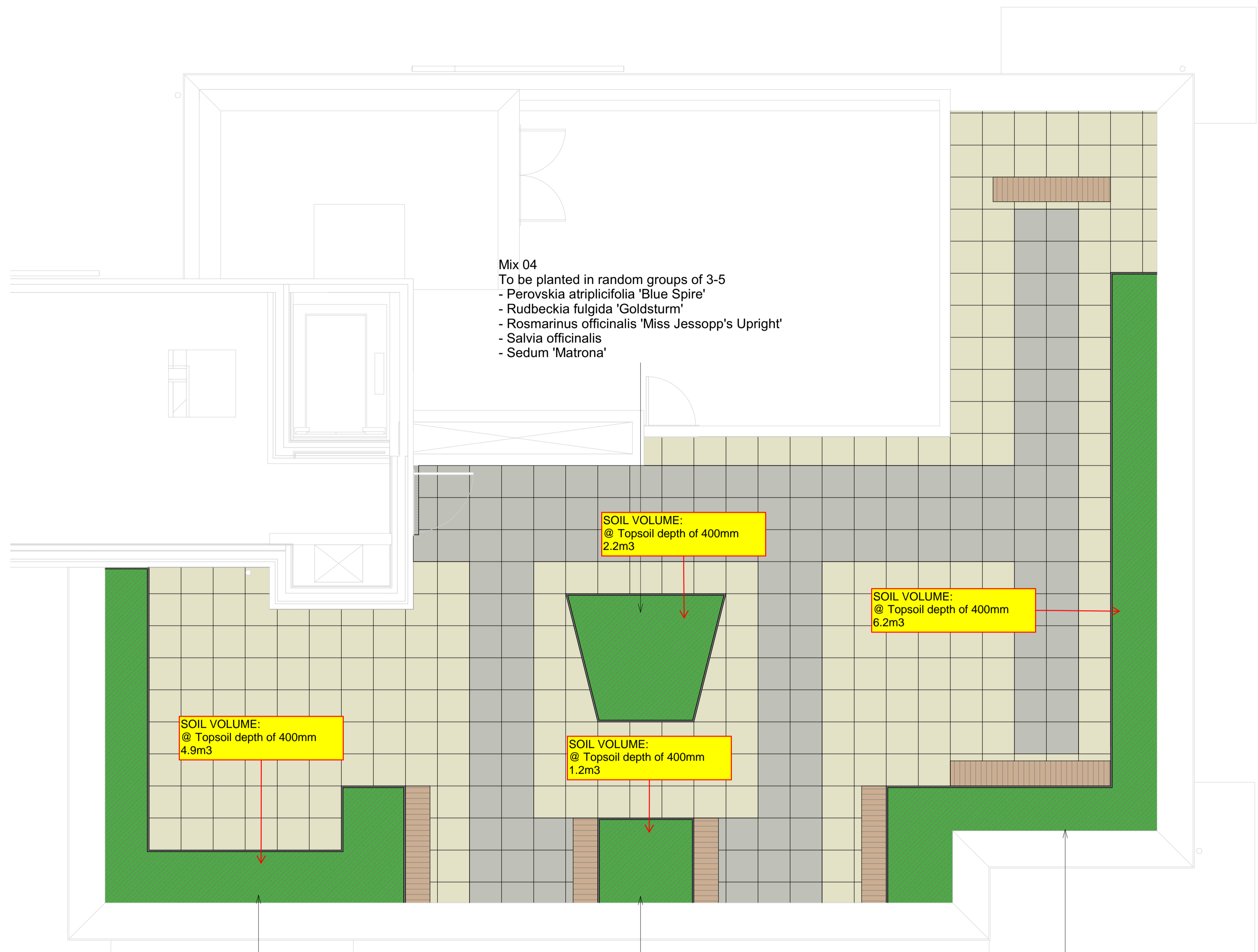

Mix 04
To be planted in random groups of 3-5
- Perovskia atriplicifolia 'Blue Spire'
- Rudbeckia fulgida 'Goldsturm'
- Rosmarinus officinalis 'Miss Jessopp's Upright'
- Salvia officinalis
- Sedum 'Matrona'

Mix 02
To be planted in random groups of 3-5
- Deschampsia caespitosa
- Pennisetum alopecuroides 'Hameln'
- Perovskia atriplicifolia 'Blue Spire'
- Rosmarinus officinalis 'Miss Jessopp's Upright'
- Stachys byzantina 'Silver Carpet'

Mix 04
To be planted in random groups of 3-5
- Perovskia atriplicifolia 'Blue Spire'
- Rudbeckia fulgida 'Goldsturm'
- Rosmarinus officinalis 'Miss Jessopp's Upright'
- Salvia officinalis
- Sedum 'Matrona'

Mix 03
To be planted in random groups of 3-5
- Deschampsia caespitosa
- Persicaria bistorta 'Superba'
- Phlomis cashmeriana
- Salvia nemorosa
- Salvia officinalis 'Purpurescens'
- Stipa tenuissima

Class	Title	Mix %	Centres	Form	Age	Height	Root Cond	Container	Min Brks	Min Buds	Prop Method	Habit
Roof areas - Mix 02	Deschampsia caespitosa [Tufted hairgrass or fairy wand]	20.00%	0.4m				C	1-2L			V	
Roof areas - Mix 02	Pennisetum alopecuroides 'Hameln' [Fountain grass]	20.00%	0.4m				C	1-2L			S or V	
Roof areas - Mix 02	Perovskia atriplicifolia 'Blue Spire'	20.00%	0.4m			25-30cm	C	2L	3			Bushy
Roof areas - Mix 02	Rosmarinus officinalis 'Miss Jessopp's Upright' [Rosemary]	20.00%	0.4m			30-40cm	C	3L	4			Bushy
Roof areas - Mix 02	Stachys byzantina 'Silver Carpet' [Lamb's ear]	20.00%	0.4m				C	1-2L			V	
Roof areas - Mix 03	Deschampsia caespitosa [Tufted hairgrass or fairy wand]	20.00%	0.4m				C	1-2L			V	
Roof areas - Mix 03	Persicaria bistorta 'Superba' [Knotweed 'Superba']	15.00%	0.4m				C	1-2L			V	
Roof areas - Mix 03	Phlomis cashmeriana [Jerusalem sage]	15.00%	0.4m				C	1-2L			V	
Roof areas - Mix 03	Salvia nemorosa [Balkan clary]	15.00%	0.4m				C	1-2L			V	
Roof areas - Mix 03	Salvia officinalis 'Purpurescens' [Purple sage]	15.00%	0.4m				C	1-2L			V	
Roof areas - Mix 03	Stipa tenuissima [Feather grass]	20.00%	0.4m				C	1-2L			S or V	
Roof areas - Mix 04	Perovskia atriplicifolia 'Blue Spire'	20.00%	0.4m			25-30cm	C	2L	3			Bushy
Roof areas - Mix 04	Rudbeckia fulgida 'Goldsturm' [Coneflower, Black-eyed Susan]	20.00%	0.4m				C	1-2L			V	
Roof areas - Mix 04	Rosmarinus officinalis 'Miss Jessopp's Upright' [Rosemary]	20.00%	0.4m			25-30cm	C	2L	3			Bushy
Roof areas - Mix 04	Salvia officinalis [Sage]	20.00%	0.4m			25-30cm	C	2L	3			Branched
Roof areas - Mix 04	Sedum 'Matrona' [Stonecrop]	20.00%	0.4m				C	1-2L				

Notes

1. Do not scale this drawing.
2. All dimensions must be checked on site and any discrepancies verified with the architect.
3. Unless shown otherwise, all dimensions are to structural surfaces.
4. Drawing to be read with all other issued information. Any discrepancies to be brought to the attention of the architect.
5. This drawing is the copyright of Levitt Bernstein and may not be copied, altered or reproduced in any form, or passed to a third party without license or written consent.
6. This document is prepared for the sole use of GM London and no liability to any other persons is accepted by Levitt Bernstein. Levitt Bernstein accepts no liability for use of this drawing by parties other than the party for whom it was prepared or for purposes other than those for which it was prepared.

This is not a construction drawing, it is unsuitable for the purpose of construction and must on no account be used as such.

P01 29/09/22 Planning Condition Submission SA
Rev Date Description Drawn / Checked

Project name

19-37 Highgate Road
Landscape Model

Drawing number

3888 - LB - ZZ - 07 - DP - L - 200132 **P01**

Drawing

Planting Proposals - Level 07

TOPSOIL VOLUME MARK_UP

Scale 1: 50 @ A1 Date 01/07/22

Client GM London

Levitt Bernstein
levittbernstein.co.uk

London
Thane Studios
2-4 Thane Villas
London N7 7PA
+44 (0)20 7275 7676

Manchester
Bonded Warehouse
18 Lower Byron Street
Manchester M3 4AP
+44 (0)161 659 8740

