

BUILDING DESIGN PARTNERSHIP SHALL HAVE NO RESPONSIBILITY FOR ANY USE MADE OF THIS DOCUMENT OTHER THAN FOR THAT WHICH IT WAS PREPARED AND ISSUED.

ALL DIMENSIONS SHOULD BE CHECKED ON SITE.

DO NOT SCALE FROM THIS DRAWING

ANY DRAWING ERRORS OR DIVERGENCIES SHOULD BE BROUGHT TO THE ATTENTION OF BUILDING DESIGN PARTNERSHIP AT THE ADDRESS SHOWN BELOW.

DRAWINGS SHALL BE READ IN CONJUNCTION WITH THE FOLLOWING BEFORE WORK COMMENCES:

- THE CDM DESIGN ISSUES REGISTER
- THE BDP RISK SERIES OF DRAWINGS
- THE PROJECT CDM RISK REGISTER

NOTES

REVISION DESCRIPTION

NO.	DESCRIPTION	DATE
P02	S73 Application Issue	28/07/2023
P01	For Planning	20/05/2022

KN MB 28/07/2023
KD MB 20/05/2022

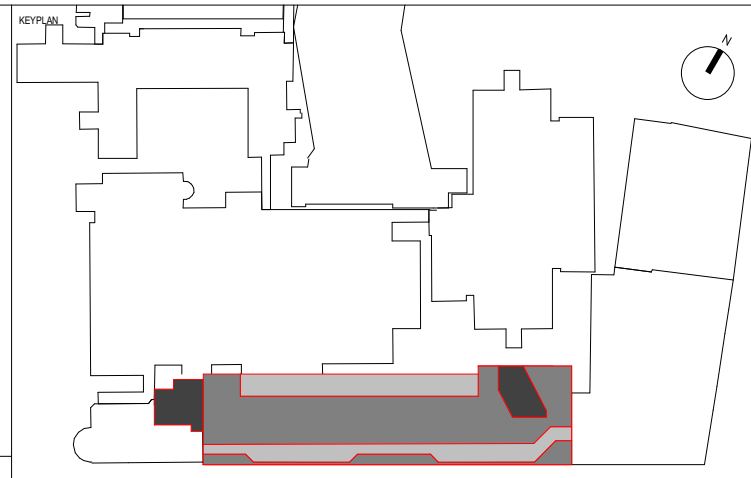

CONTRACTOR
WILKINS SISK
CONTRACTORS
Established 1999

John Sisk & Son Ltd
2410 Regents Court
The Crescent
Birmingham Business Park
Birmingham
B37 7YE

DESIGN LEAD
BDP.

16 Brewhouse Yard
Clerkenwell
London
EC1V 4LJ
United Kingdom

T +44 (0)20 7812 8000
www.bdp.com

PROJECT TITLE
GOSH Children's Cancer Centre

PROJECT NUMBER
P2007598

PROJECT TYPE
Planning - Level 03 plan as Proposed

REVISIONS

NO.	DESCRIPTION	DATE	BY	APP'D BY
GOSHCCC-BDP-ZZ-03-DR-A-2000-2063				
S2 - For Information		1 : 200	@ A1	28/07/2023

REVISION

NO.	DESCRIPTION	DATE
KN	MB	BZ

Planning

P02