

Section B-B - Main Entrance as Proposed
1:100



BUILDING DESIGN PARTNERSHIP SHALL HAVE NO RESPONSIBILITY FOR ANY USE MADE OF THIS DOCUMENT OTHER THAN FOR THAT WHICH IT WAS PREPARED AND ISSUED.
ALL DIMENSIONS SHOULD BE CHECKED ON SITE.
DO NOT SCALE FROM THIS DRAWING
ANY DRAWING ERRORS OR DIVERGENCIES SHOULD BE BROUGHT TO THE ATTENTION OF BUILDING DESIGN PARTNERSHIP AT THE ADDRESS SHOWN BELOW.
DRAWINGS SHALL BE READ IN CONJUNCTION WITH THE FOLLOWING BEFORE WORK COMMENCES:
• THE CDM DESIGN ISSUES REGISTER
• THE BDP RISK SERIES OF DRAWINGS
• THE PROJECT CDM RISK REGISTER
CLEAR PLANT ROOM HEIGHTS AT LEVELS 0 AND 9 TO BE CONFIRMED AS PART OF ONGOING STAGE 3 COORDINATION.

NOTES

| | | | | |
|-----|-----------------------|----|----|------------|
| P02 | S73 Application Issue | KN | MB | 28/07/2023 |
| P01 | For Planning | KD | MB | 20/05/2022 |

| REVISION | DESCRIPTION | DRAWN | CHECKED | DATE |
|----------|-------------|-------|---------|------|
|----------|-------------|-------|---------|------|

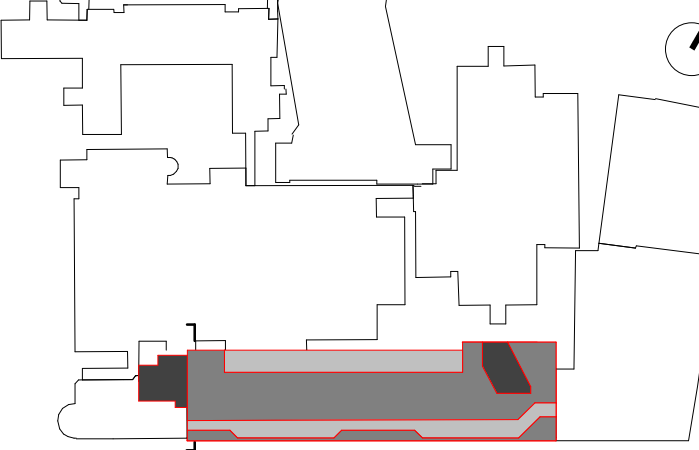

CLIENT



| | |
|---|---|
| CONTRACTOR John Sisk & Son Ltd 2410 Regents Court The Crescent Birmingham Business Park Birmingham B37 7YE | DESIGN LEAD BDP. 16 Brewhouse Yard Clerkenwell London EC1V 4LJ United Kingdom T +44 (0)20 7812 8000 www.bdp.com |
|---|---|

PROJECT TITLE
GOSH Children's Cancer Centre

PROJECT NUMBER
P2007598

SECTION TITLE
Section B-B (cross section through main entrance)

REVISION NO.
GOSHCCC-BDP-ZZ-ZZ-DR-A-2000-2075

REVISION
S2 - For Information

SCALE
1 : 100

DATE
28/07/2023

| DESIGNED BY | CHECKED BY | APPROVED BY | DATE OF ISSUE | REVISION |
|-------------|------------|-------------|---------------|----------|
| KN | MB | BZ | Planning | P02 |