





DEMOLITION WORKS

Foundation works and structural alterations to be carried out in accordance with Structural Engineer's design and specification.

- 1 Flat roofed rear extensions demolished

KEY:

-  Elements to be demolished
-  Elements to be retained
-  Elements to be replaced
-  Elements to be blocked up
-  Excavation

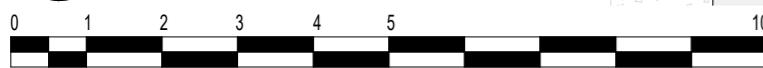
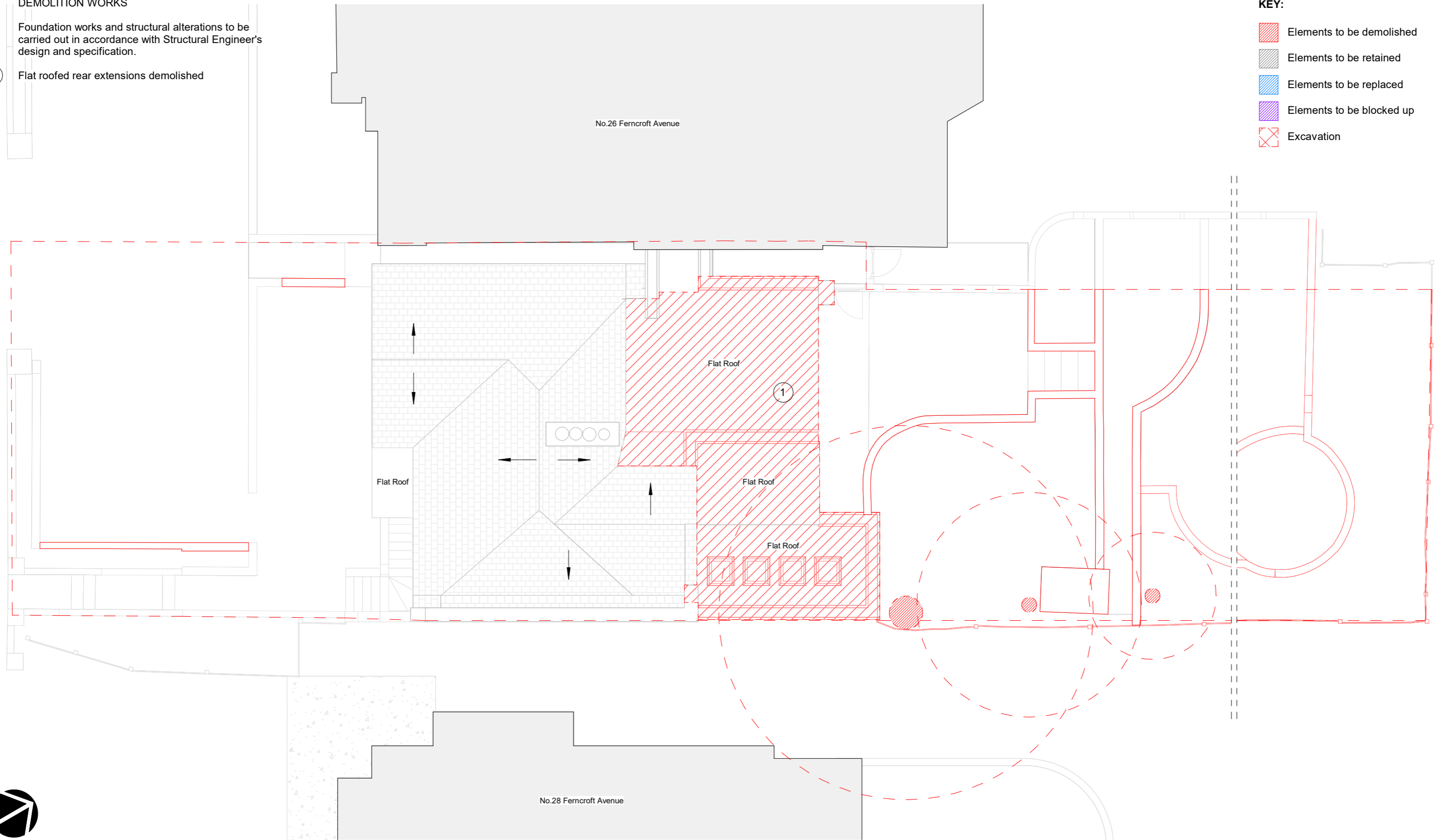

GRAPHIC SCALE: 1:100

1. Use figured dimensions only
2. Do not scale from this drawing
3. All dimensions to be checked on site and the Architect to be informed of any discrepancies before construction commences
4. All references to drawings refer to current revision of that drawing.
5. Structural and services information shown is indicative only. Refer to consultants' drawings for details and setting out.
6. All work and materials to be in accordance with current applicable statutory legislation and to comply with all relevant codes of practice and British and European standards

Rev	Description	Date	Author	Checker
A	First Issue	17/11/22	EC	
B	Issued for information	16/03/23	AG	
C	Issued to clients	31/03/23	AG	
D	Entrance Update	06/06/23	AG	
E	Issued For Planning Application	06/07/23	AG	

Project: 26A Ferncroft Avenue, NW3 7PH
Subject: Proposed Roof Demolitions (Option 1)
Scale: 1 : 100
Creation Date: 17/11/22

bere:architects

54a Newington Green, London, N169PX
 T +44 (0)20 7241 1064 bere@bere.co.uk www.bere.co.uk

© Bere Architects 2023

Project	Disc. Package. Drawing	REV
494	B3.G11.P02	E

07/07/2023 10:37:06