

Dimensions are not to be scaled from this drawing. This drawing is based on current available information and should not be relied on as accurate measurements of usable space. This drawing is the property of the Colman Partnership Ltd, and Copyright is reserved by them. The drawing is issued on condition that it is not copied or disclosed by or to any unauthorised persons without the prior consent in writing of the Colman Partnership Ltd.			
Rev	Notes	By	Date
P1	Issued for Planning	SRH	18/07/23

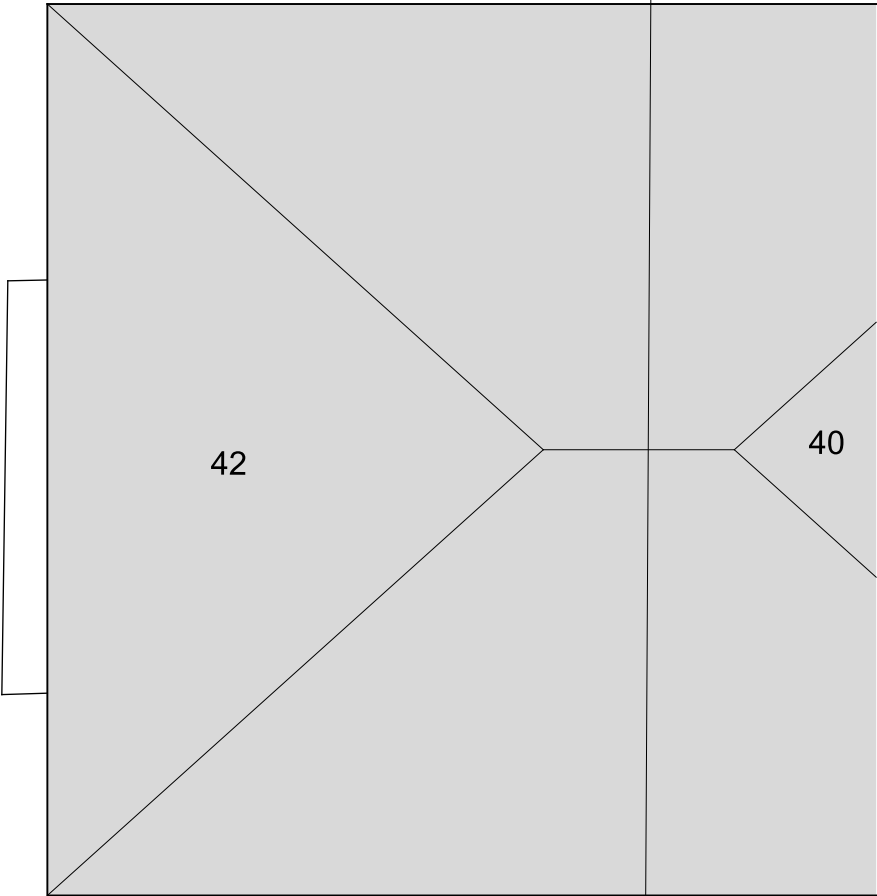

King Henry's Road

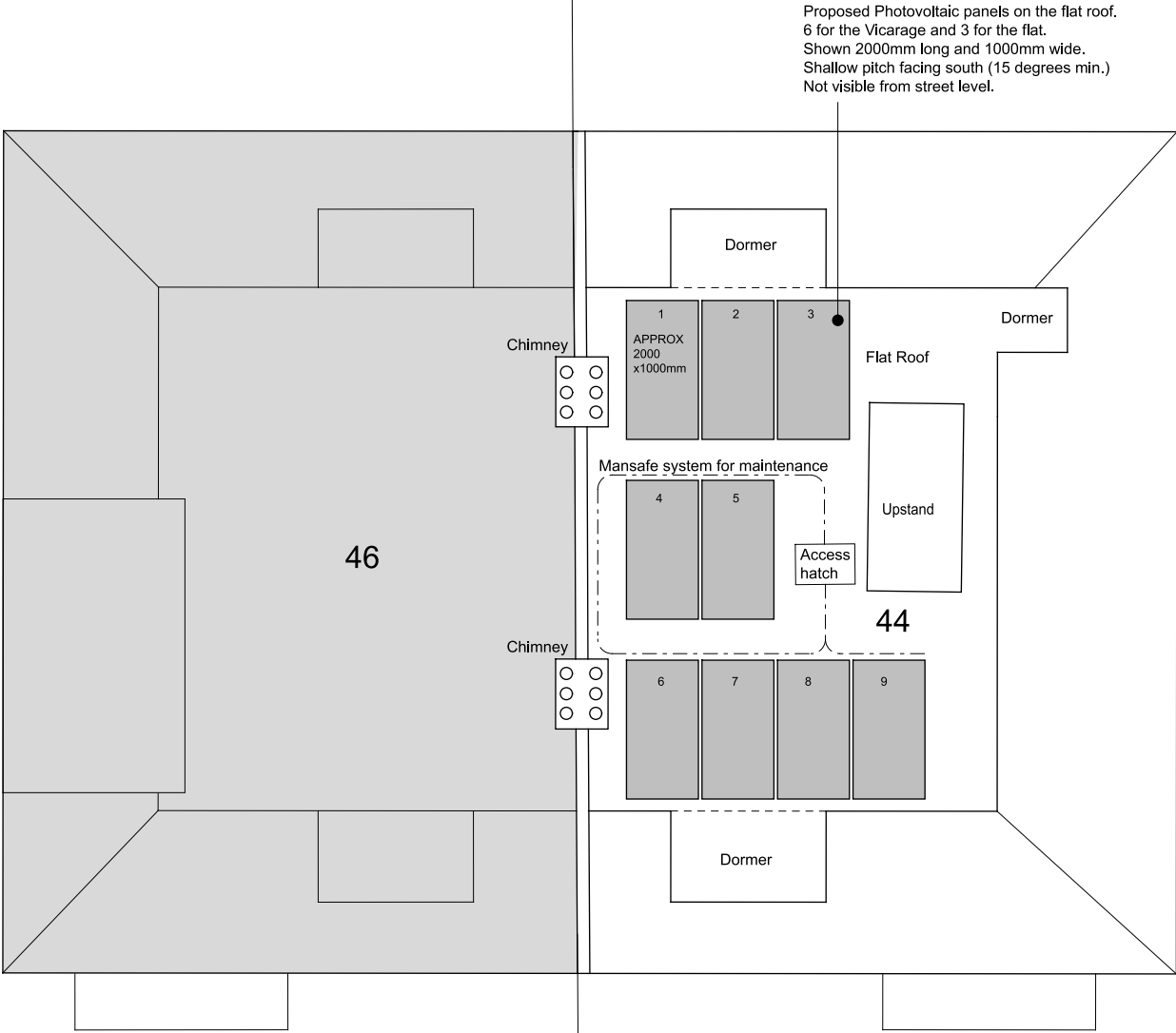
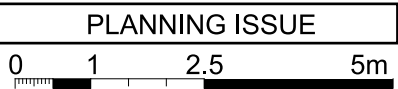

Project

44/44A King Henry's Road  
London,NW3 3RP

Title

Proposed Roof Plan

Scale	1:100 @ A3	1:50 @ A1	Date	18/07/2022
Drawn by	SRH	Checked by Proj. Arch.	Checked By Manager	
Drawing No.	22027/P(--)-113	Revision	P1	

The Colman Partnership Limited  
27 Harcourt Street  
London  
W1H 4HP

Telephone : 020 7535 2040  
Facsimile : 020 7535 2041  
email: projects@colmanarchitects.co.uk

[www.colmanarchitects.co.uk](http://www.colmanarchitects.co.uk)

CAD Filename: SPILES  
S04TES