

Proposed Lower Ground Floor Plan

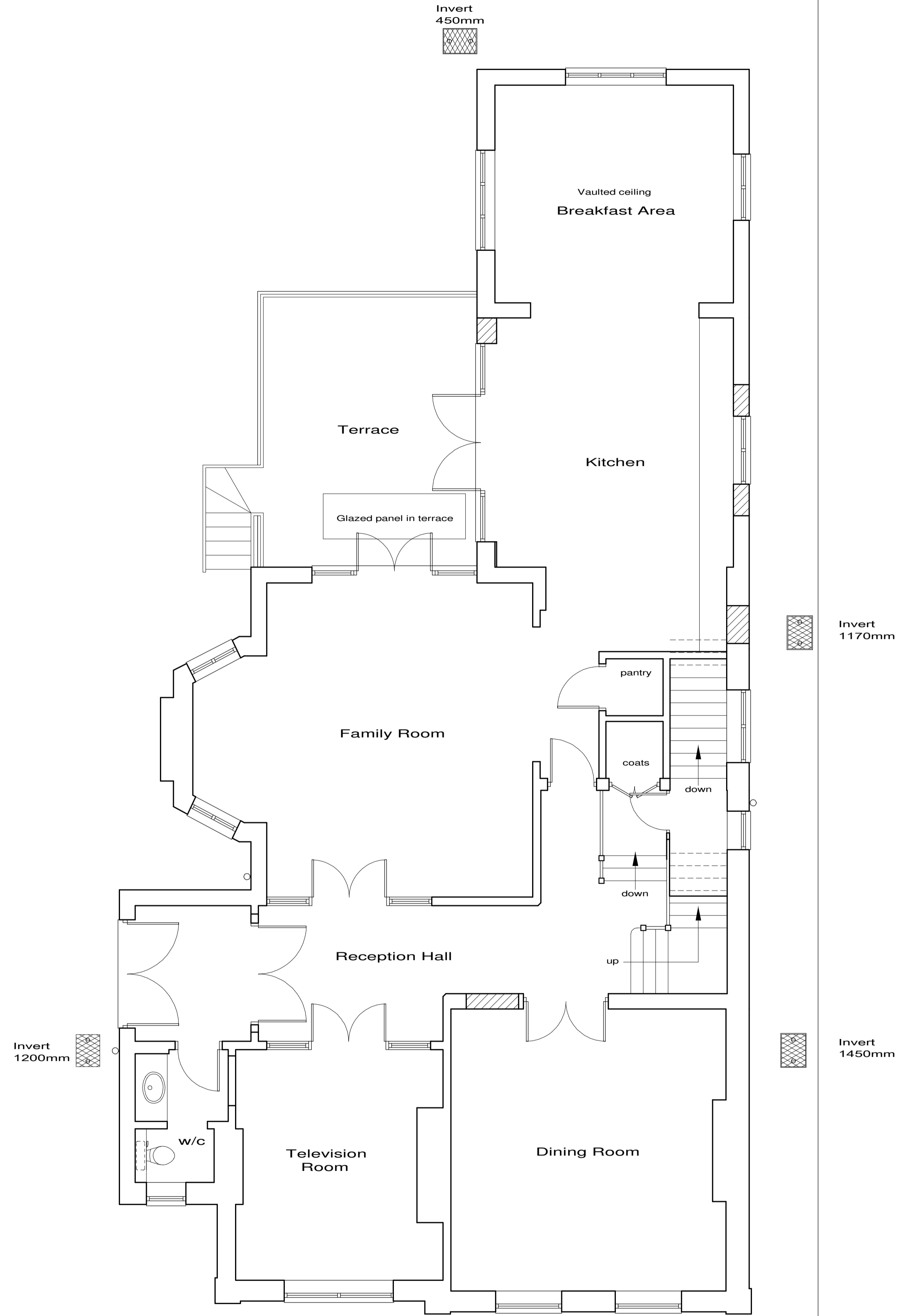

Proposed Ground Floor Plan

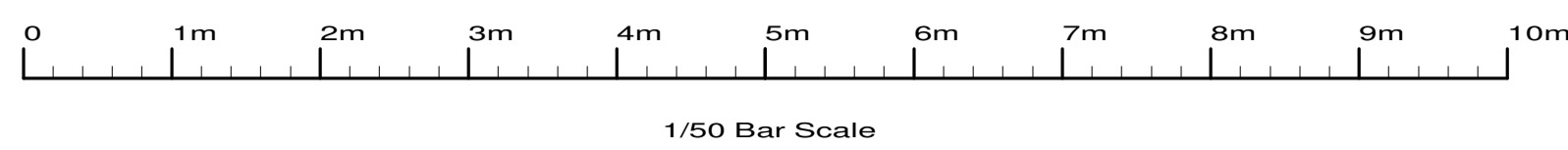

These plans have been produced to a recognized scale and a standard paper size, both shown in the title block. If you have received this drawing as a pdf or similar file type, please check when printing that you have an accurately sized drawing using the scale bar provided.

Revisions :		B. Door change	Jul 2023
		A. Design changes	Jul 2023
Site			
15 Oakhill Avenue, Camden Town, London, NW3 7RD.			
Client			
Mr A Sasson			
Detail			
Proposed Plans			
Scale	1/50	Drawing Number	
Date	06/07/23	5011/ 4B	
Drawn by	JAS	Size	A1
F.J. Thompson & Co			
RICS		Unit 4, 80 High Street, Egham, Surrey, TW20 9HE.	
Tel 01923 720277		www.fjthompson.co.uk	
email: surveys@fjthompson.co.uk			