

- 22 No. Epimedium perralchicum 'frohleiter' 3L
- 12 No. Epimedium perralchicum 'frohleiter' 3L
- 11 No. Heuchera 'Key Lime Pie' 3L
- 21 No. Helleborus foetidus 3L
- 24 No. epimedium pubigerum 3L
- 22 No. Asplenium scolopendrium 3L
- 45 No. Astilbe Red 3L
- 8 No. Heuchera 'Key Lime Pie' 3L
- 37 No. Geranium phaeum 'Album' 3L
- 30 No. Helleborus foetidus 3L
- 34 No. Blechnum penna marina 3L
- 48 No. Heuchera 'Key Lime Pie' 3L
- 12 No. epimedium pubigerum 3L
- 17 No. Asplenium scolopendrium 3L
- 12 No. Blechnum penna marina 3L
- 24 No. Epimedium perralchicum 'frohleiter' 3L
- 75 No. Ilex crenata 3L
- 13 No. Heuchera 'Key Lime Pie' 3L
- 18 No. Epimedium perralchicum 'frohleiter' 3L
- 5 No. Blechnum penna marina 3L
- 4 No. Anemone nemorosa 3L
- 16 No. Heuchera 'Key Lime Pie' 3L
- 3 No. Ajuga reptans 'Braunherz' 3L
- 13 No. Ajuga reptans 'Braunherz' 3L
- 1 No. Prunus avium RB
- 9 No. Heuchera 'Key Lime Pie' 3L
- 1 No. Prunus avium RB
- 9 No. Heuchera 'Key Lime Pie' 3L
- 13 No. Asplenium scolopendrium 3L
- 16 No. Astilbe Red 3L
- 20 No. Geranium phaeum 'Album' 3L
- 1 No. Prunus avium RB
- 66 No. Ilex crenata RB
- 1 No. Prunus avium RB
- 24 No. Geranium phaeum 'Album' 3L
- 15 No. Helleborus foetidus 3L
- 12 No. epimedium pubigerum 3L
- 28 No. Astilbe Red 3L
- 27 No. Ilex crenata RB

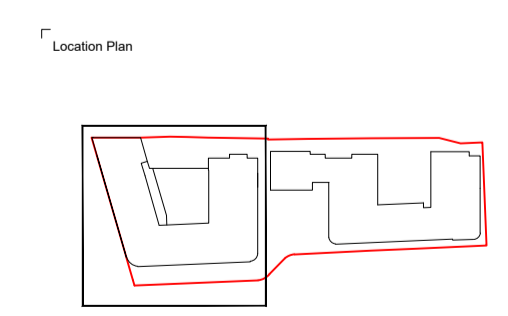

Project: West End Lane, London		Client: Astir	
Drawing Title: Planting Plan Level 1 West Block			
Project of Issue: STAGE 4			
Drawn By: KBP	Checked By: PDC	Drawn Date: 1:100 @ A1	Date of First Issue: NOV   2021
Project Number: 0001	Role: L	Originator: FAB	Type: DRG
Series: XX	Level: 01	Number: 3004	Revision: T05

Date	By	Description	Drawn	Checked
21.06.2023	PDC	Updates per species comments and updated Layout		
08.02.2022	PDC	Stage 4 - Layout update		
17.12.2021	PDC	Stage 4		
12.11.2021	PDC	Challenge of conditions		
04.11.2021	PDC	Tender #1 of conditions		

Disclaimer:  
 1. This drawing is copyright of Fabrik Ltd. It must not be copied or reproduced without written consent from the owner.  
 2. Do not scale from this drawing. Only figured dimensions are to be taken from this drawing.  
 3. All contractors must read and be responsible for taking and checking all dimensions related to the works shown on the drawing prior to fabrication or setting out.  
 4. This drawing uses coloured lines. Please do not rely on a monochrome copy.

External References: