

Please check the design carefully. Bespoke commission orders cannot be cancelled once production has started.  
 Finished products are non-returnable and non-exchangeable.

1.1 South Elevation  
 Scale 1:200

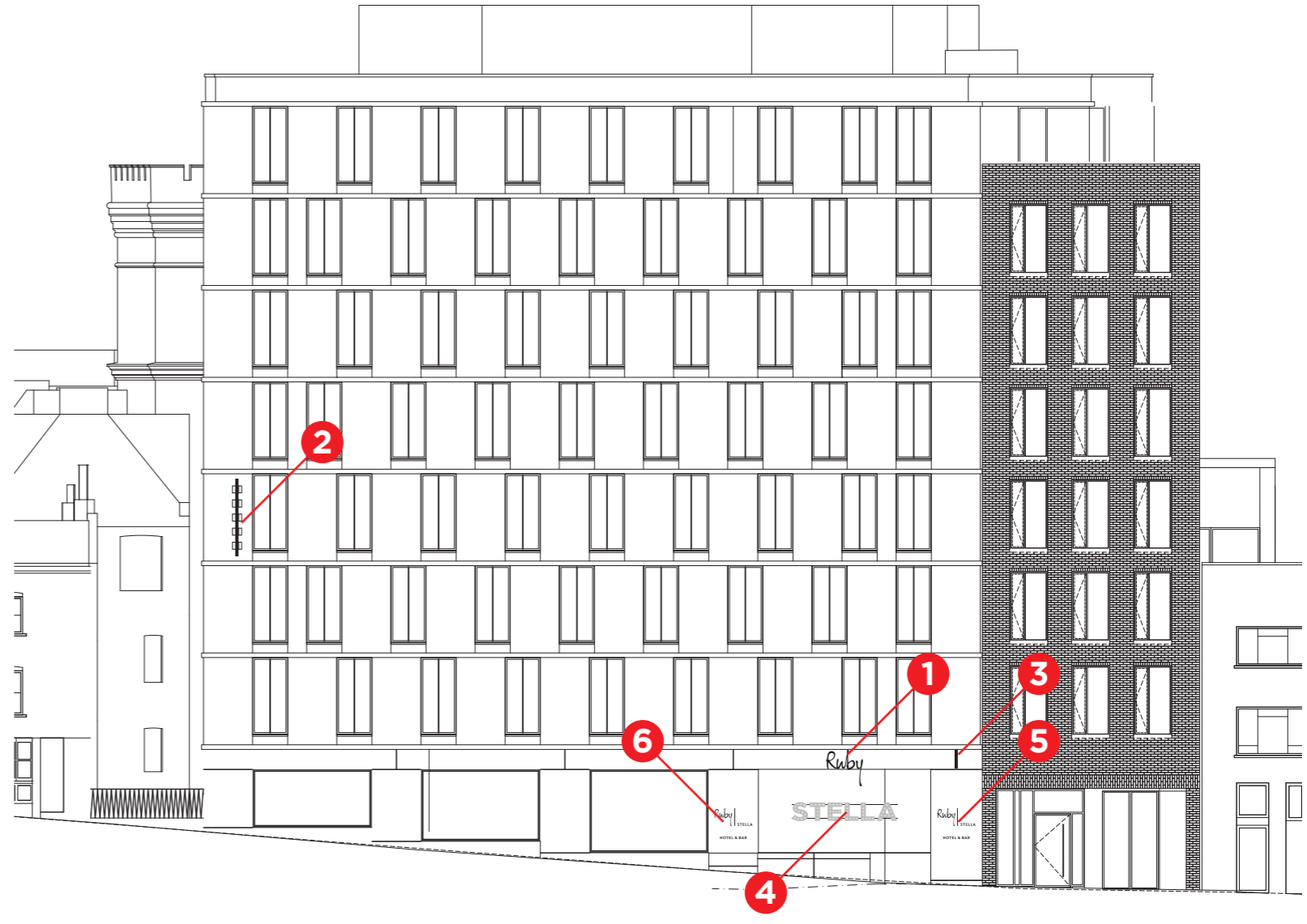

1.2 East Elevation  
 Scale 1:200



SCALE 1:200



#6331 BT	Rev: 10/3	Page: 1	30/06/2023	SCALE AS SPECIFIED @ A3
External	Signage Positions			<b>GOODWIN &amp; GOODWIN</b> 'SIGNS WITH SOUL'
Drawn by JL	Ruby Hospitality UK LTD			

Please check the design carefully. Bespoke commission orders cannot be cancelled once production has started.  
 Finished products are non-returnable and non-exchangeable.

2.1 East Elevation  
 Scale 1:50

2.2 Front  
 Scale 1:10

2.3 Right  
 Scale 1:10

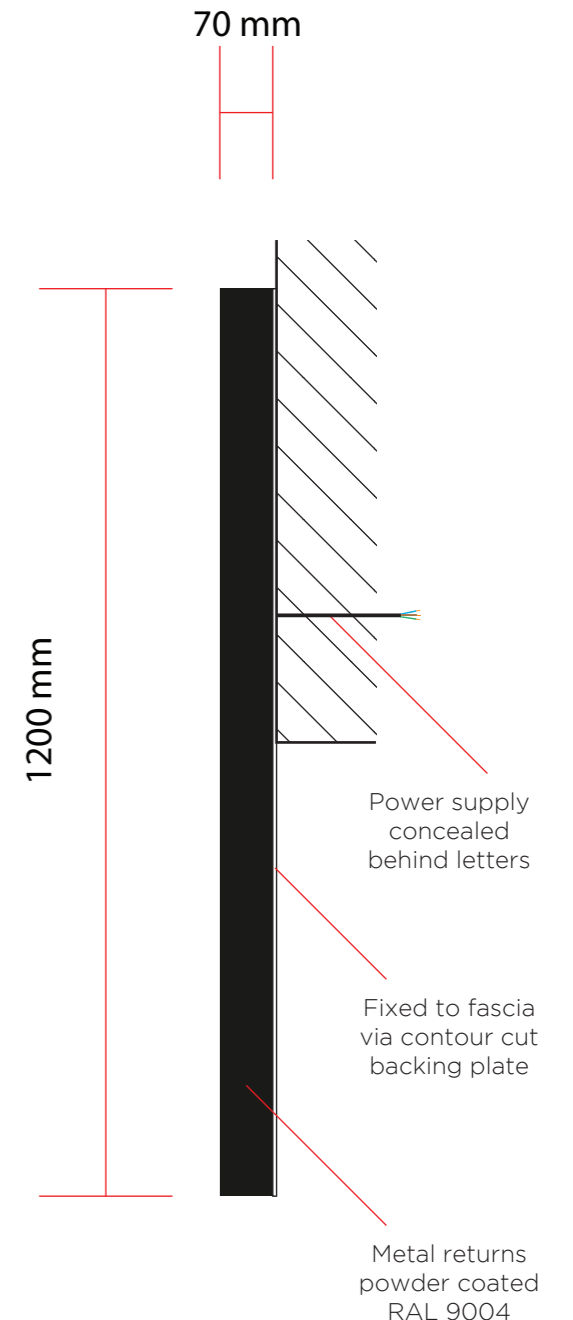
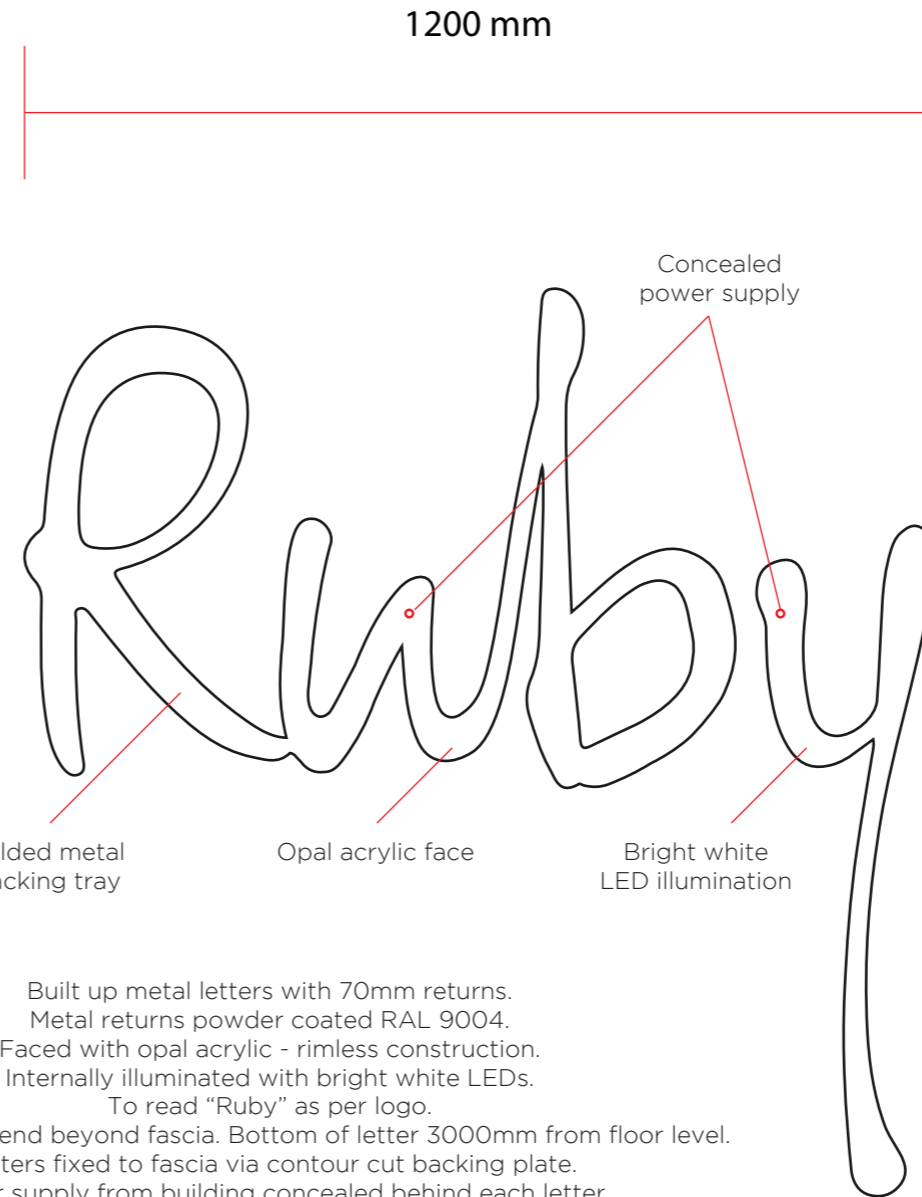
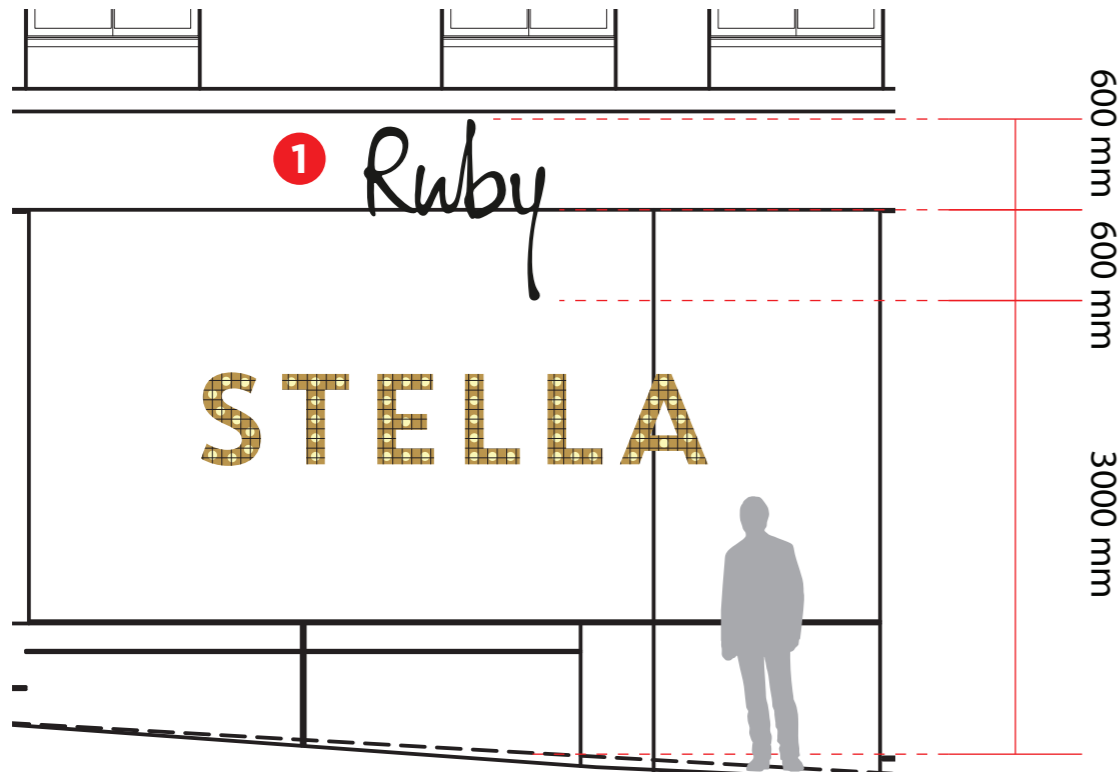

Built up metal letters with 70mm returns.  
 Metal returns powder coated RAL 9004.  
 Faced with opal acrylic - rimless construction.  
 Internally illuminated with bright white LEDs.  
 To read "Ruby" as per logo.  
 Letter "y" to extend beyond fascia. Bottom of letter 3000mm from floor level.  
 Letters fixed to fascia via contour cut backing plate.  
 Power supply from building concealed behind each letter.

Quantity x 1

Weight: 15kg max

Max. Luminance: 400mm cd/m2



SCALE 1:50

Colour swatch

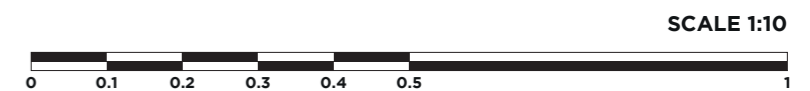
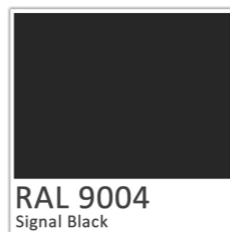

SCALE 1:10

#6331 BT	Rev: 10/3	Page: 2	30/06/2023	SCALE AS SPECIFIED @ A3
External	Position 1: Illuminated Letters			<b>GOODWIN &amp; GOODWIN</b> 'SIGNS WITH SOUL'
Drawn by JL	Ruby Hospitality UK LTD			

Please check the design carefully. Bespoke commission orders cannot be cancelled once production has started.  
 Finished products are non-returnable and non-exchangeable.

**2.4** Fixing detail  
 Scale 1:10

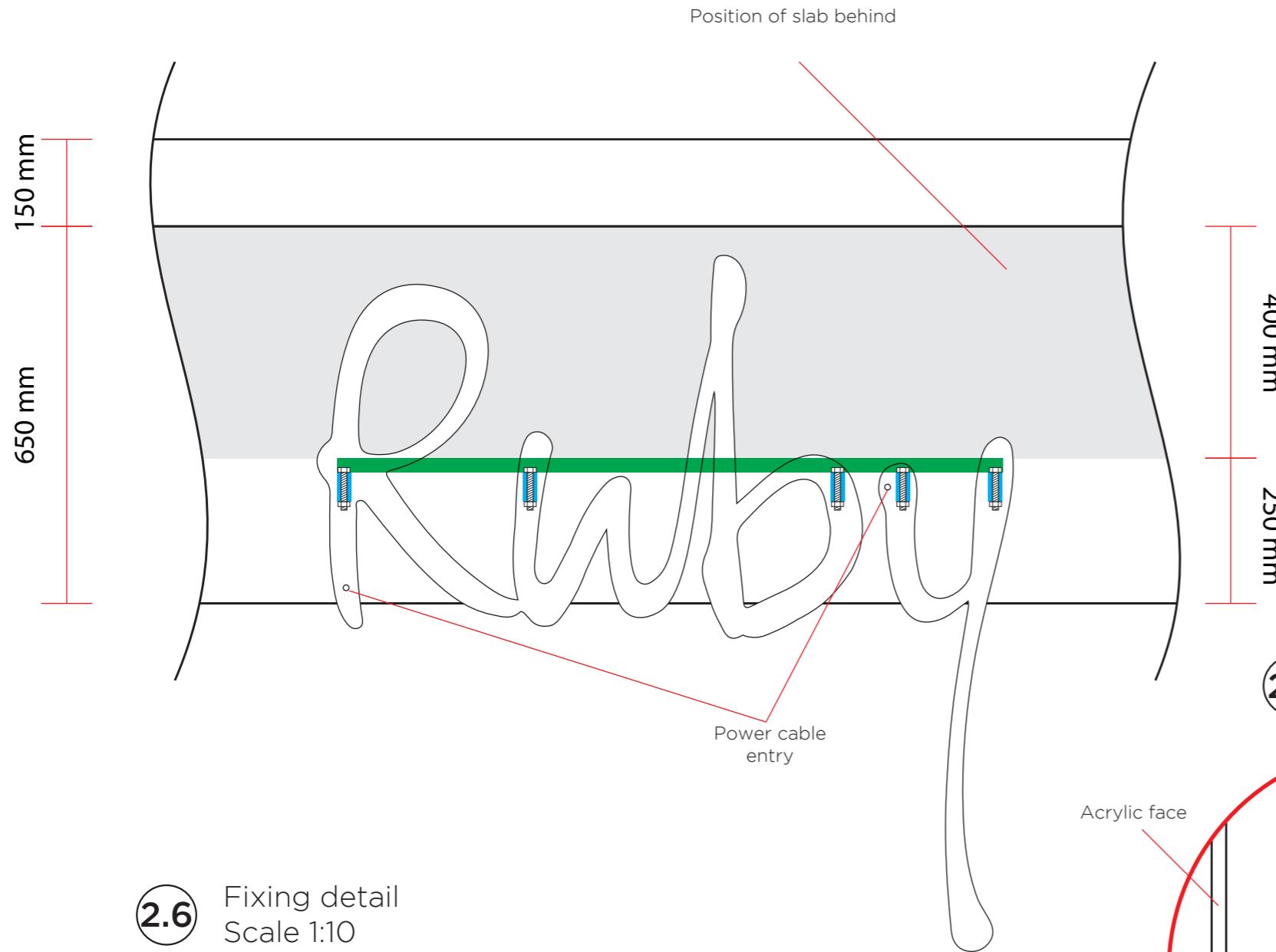

**2.5** Right section  
 Scale 1:10

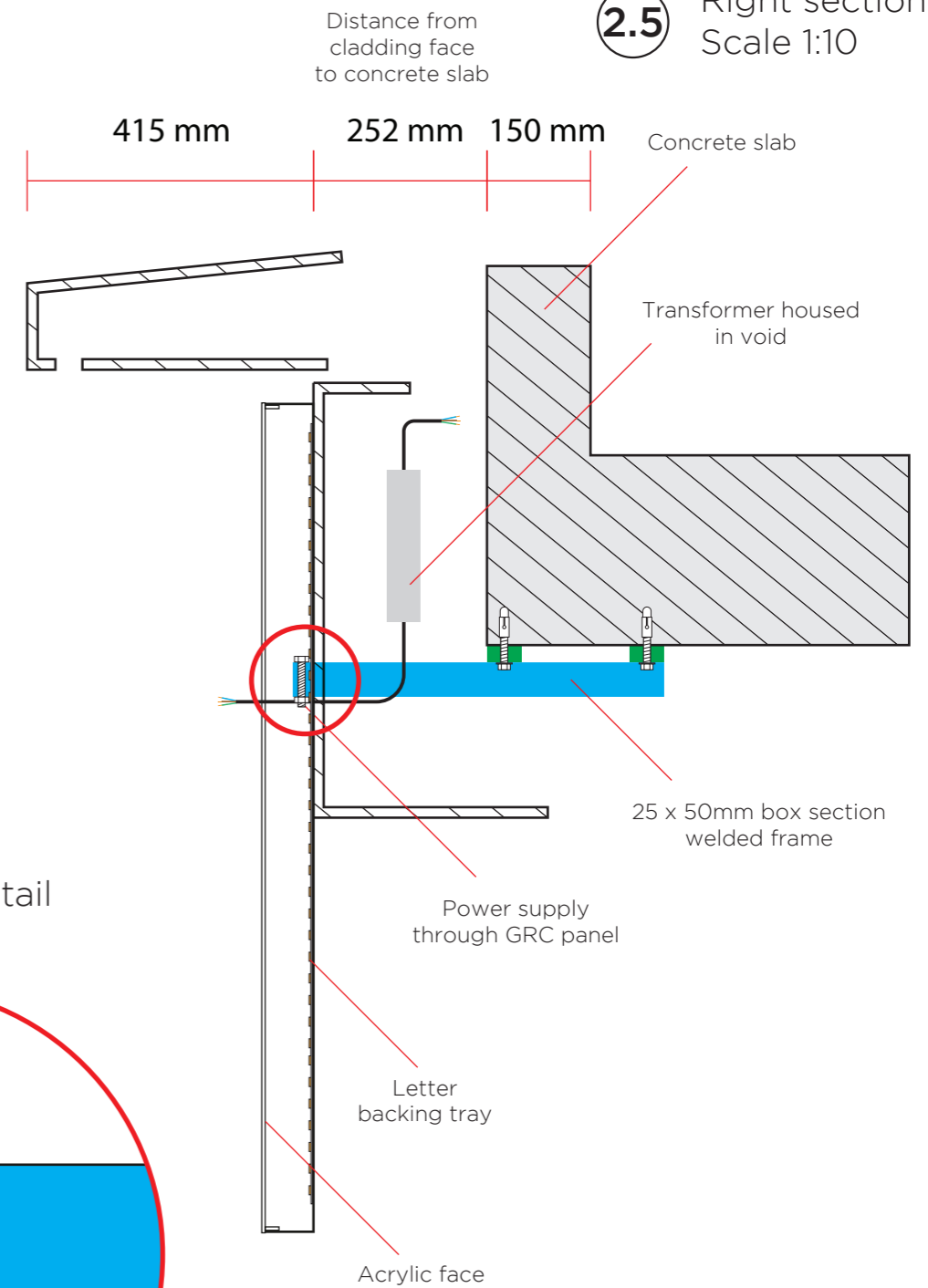

**2.7** Fixing detail  
 Scale 1:10

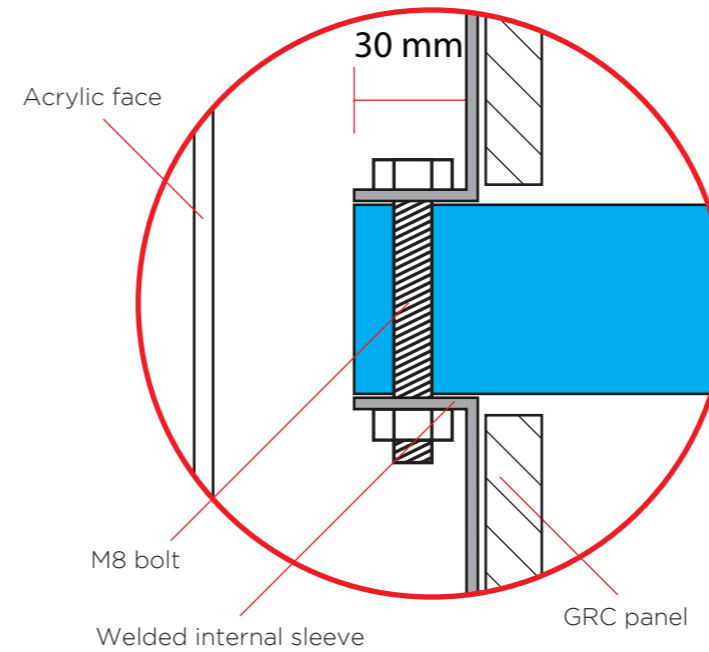

**2.6** Fixing detail  
 Scale 1:10

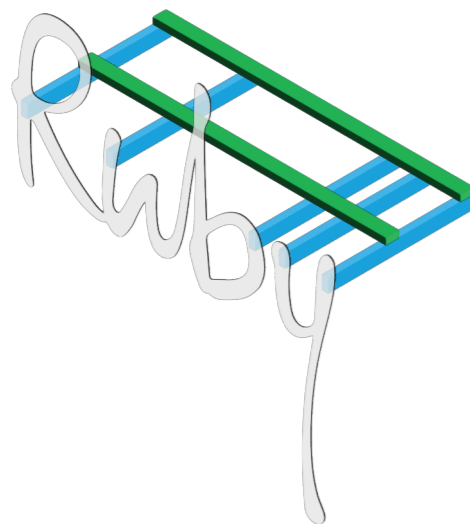

**First fix bracket**

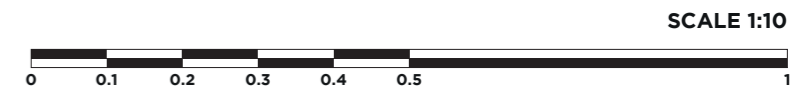

#6331 BT	Rev: 10/3	Page: 3	30/06/2023	SCALE AS SPECIFIED @ A3
External	<b>Position 1:</b> Illuminated Letters			<b>GOODWIN &amp; GOODWIN</b> 'SIGNS WITH SOUL'
Drawn by JL	Ruby Hospitality UK LTD			

Please check the design carefully. Bespoke commission orders cannot be cancelled once production has started.  
 Finished products are non-returnable and non-exchangeable.

**2.8** Bracket top  
 Scale 1:10

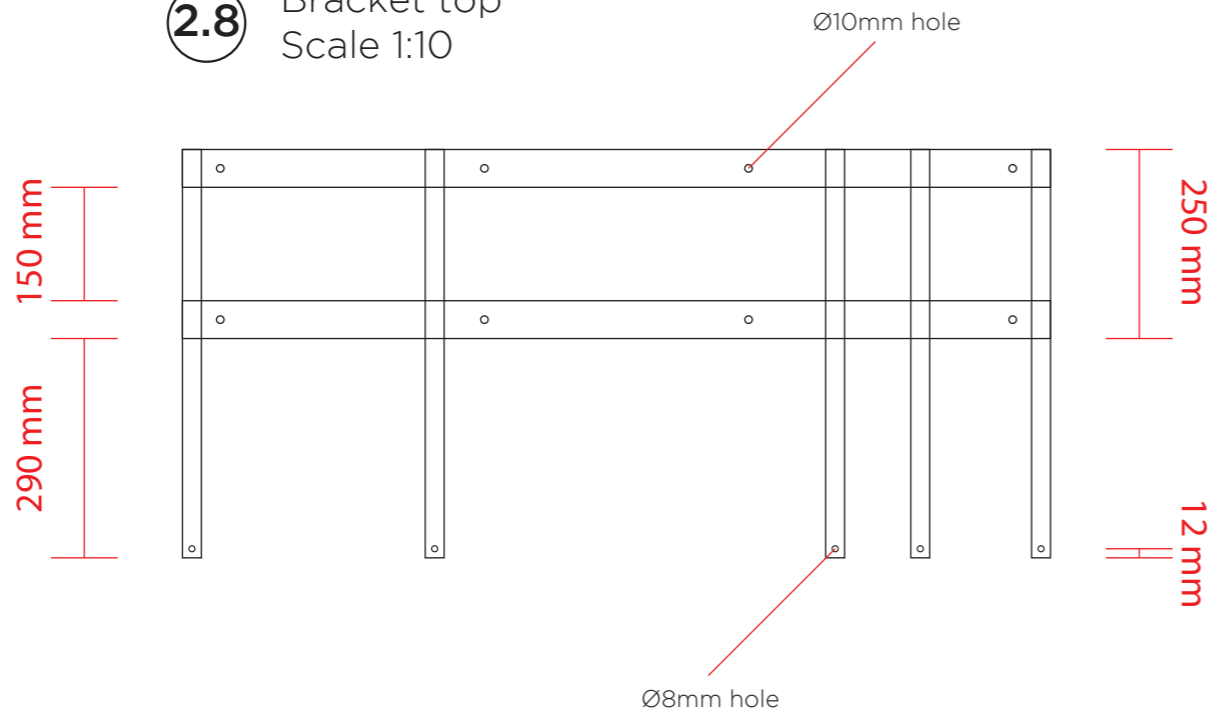

**First fix bracket**

**2.9** Bracket front  
 Scale 1:10

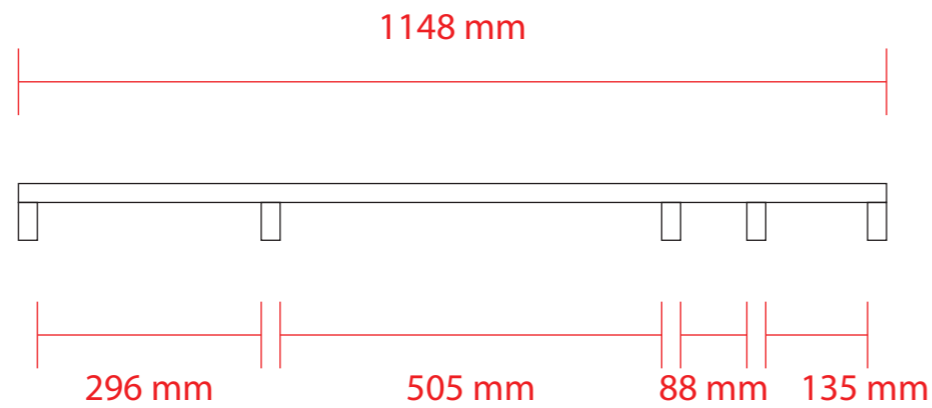

**2.10** Bracket right  
 Scale 1:10

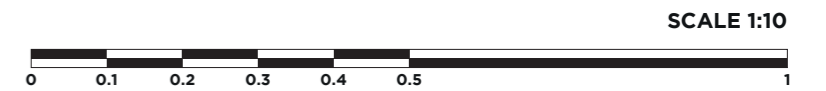
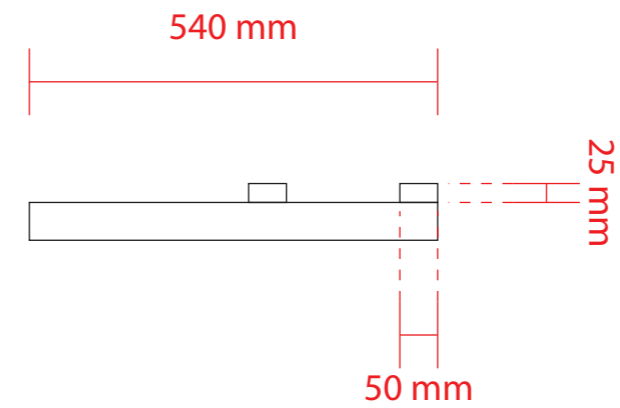

#6331 BT	Rev: 10/3	Page: 4	30/06/2023	SCALE AS SPECIFIED @ A3
External	<b>Position 1:</b> Illuminated Letters			<b>GOODWIN &amp; GOODWIN</b> 'SIGNS WITH SOUL'
Drawn by JL	Ruby Hospitality UK LTD			

Please check the design carefully. Bespoke commission orders cannot be cancelled once production has started.  
 Finished products are non-returnable and non-exchangeable.

**3.1** South Elevation  
 Scale 1:100

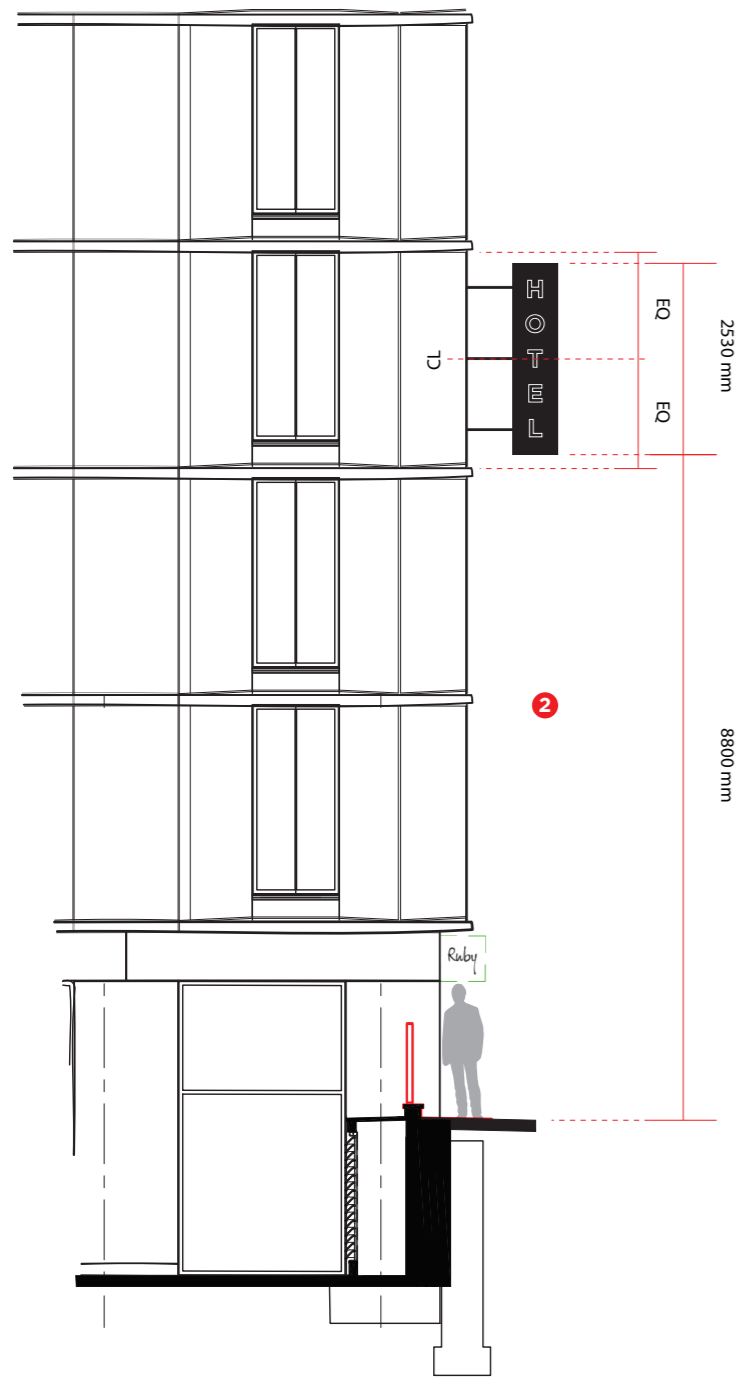

**3.2** Left  
 Scale 1:20

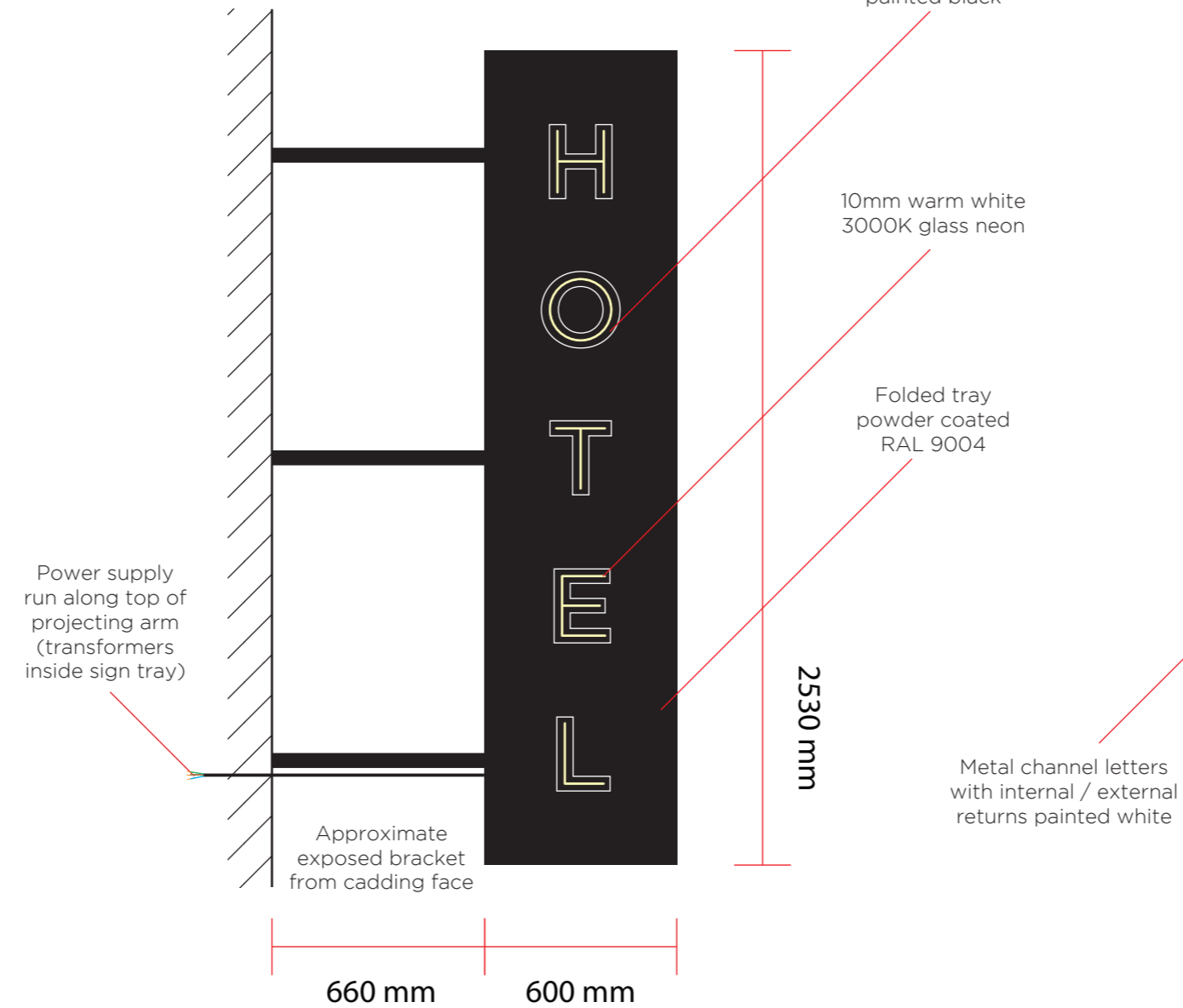

**3.3** Front  
 Scale 1:20

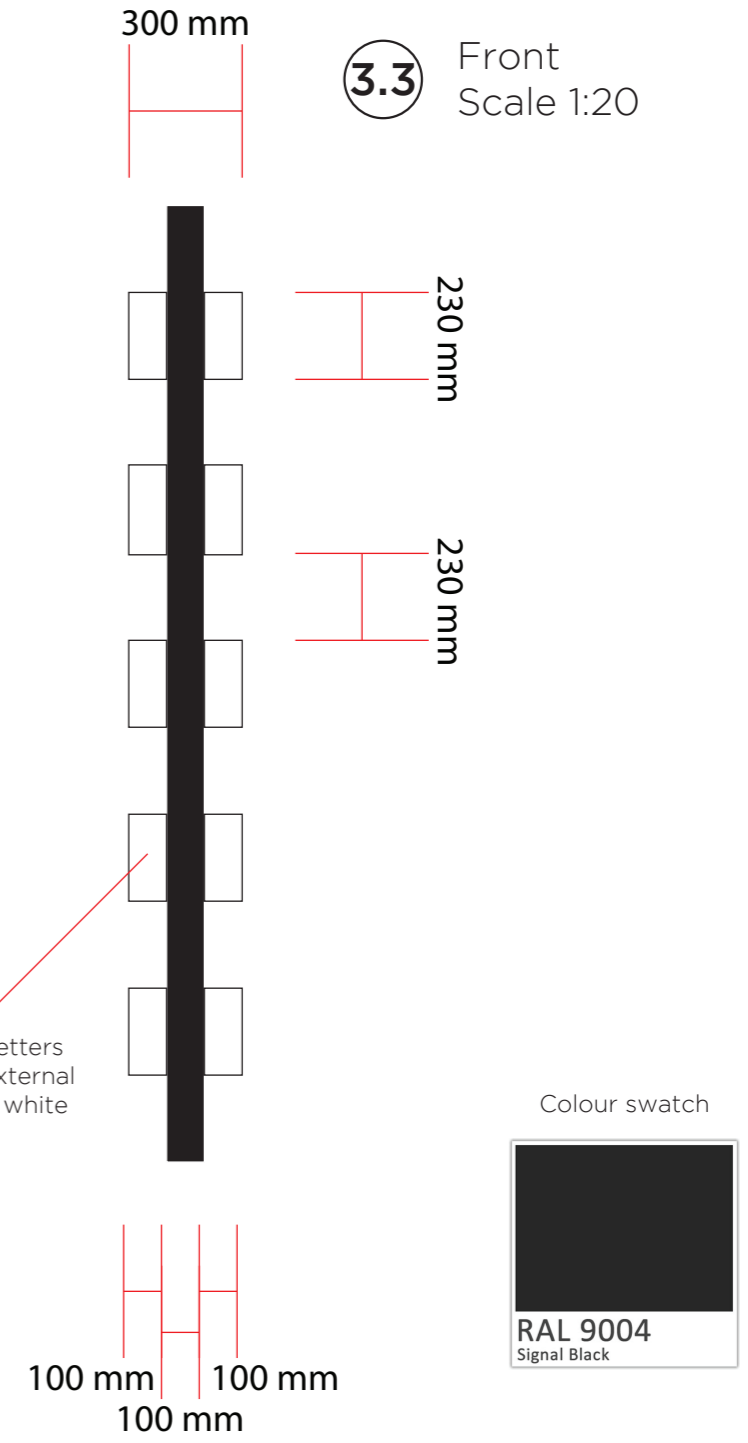

Built up metal tray, double sided, with 100mm returns, powder coated RAL 9004.  
 Faced to both sides with channel letters, powder coated white.  
 Inlaid with 10mm glass neon, warm white (3000K). To read "HOTEL".  
 Sign tray fixed to SFS with 50mm box steel and 10mm welded base plate.  
 Bracket as a single piece, to be fixed prior to cladding installation. To project 1780mm (W).  
 To create 600mm projection from side of building. Signage to sit central to wall area.  
 To be fixed at 3rd floor. Bottom of sign to be 8800mm from ground level.  
 Neon transformers, cabling and power supply concealed within tray.  
 Double sided tray to fix over bracket using concealed angle fixings (see pg4).

**Weight: 100kg max**  
**Max. Luminance: 400mm cd/m2**



Quantity x 1

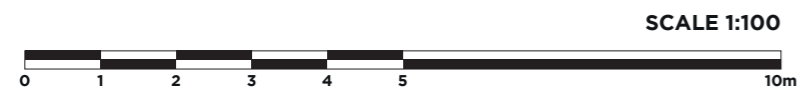

#6331 BT	Rev: 10/3	Page: 5	30/06/2023	SCALE AS SPECIFIED @ A3
External	<b>Position 2:</b> Projecting Neon Sign			<b>GOODWIN &amp; GOODWIN</b> 'SIGNS WITH SOUL'
Drawn by JL	Ruby Hospitality UK LTD			

Please check the design carefully. Bespoke commission orders cannot be cancelled once production has started.  
 Finished products are non-returnable and non-exchangeable.

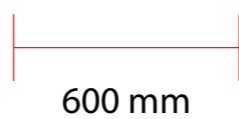
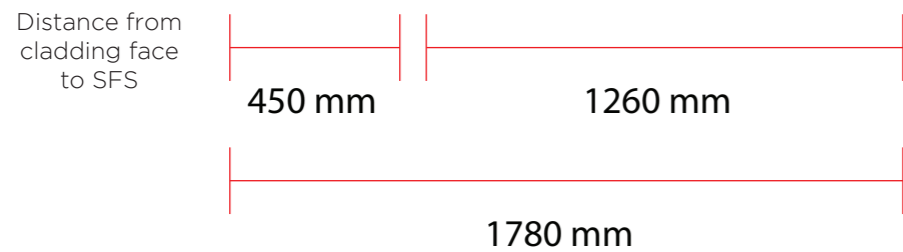
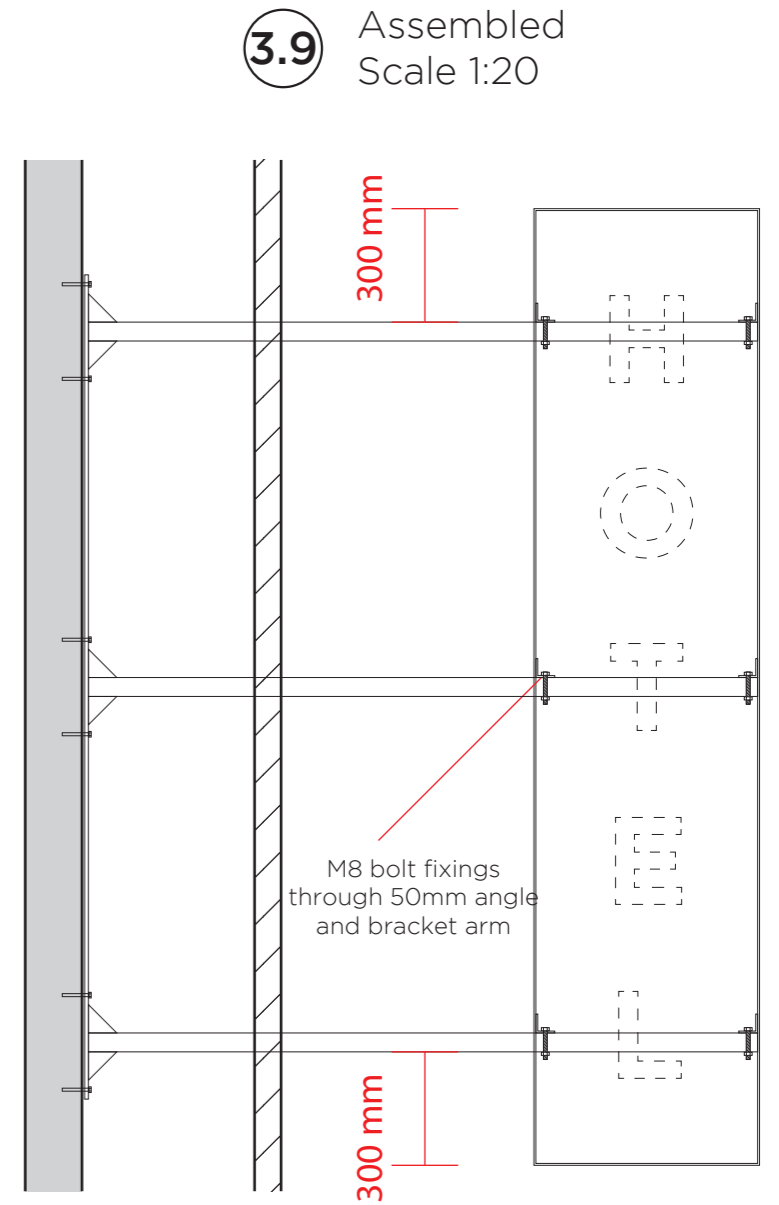
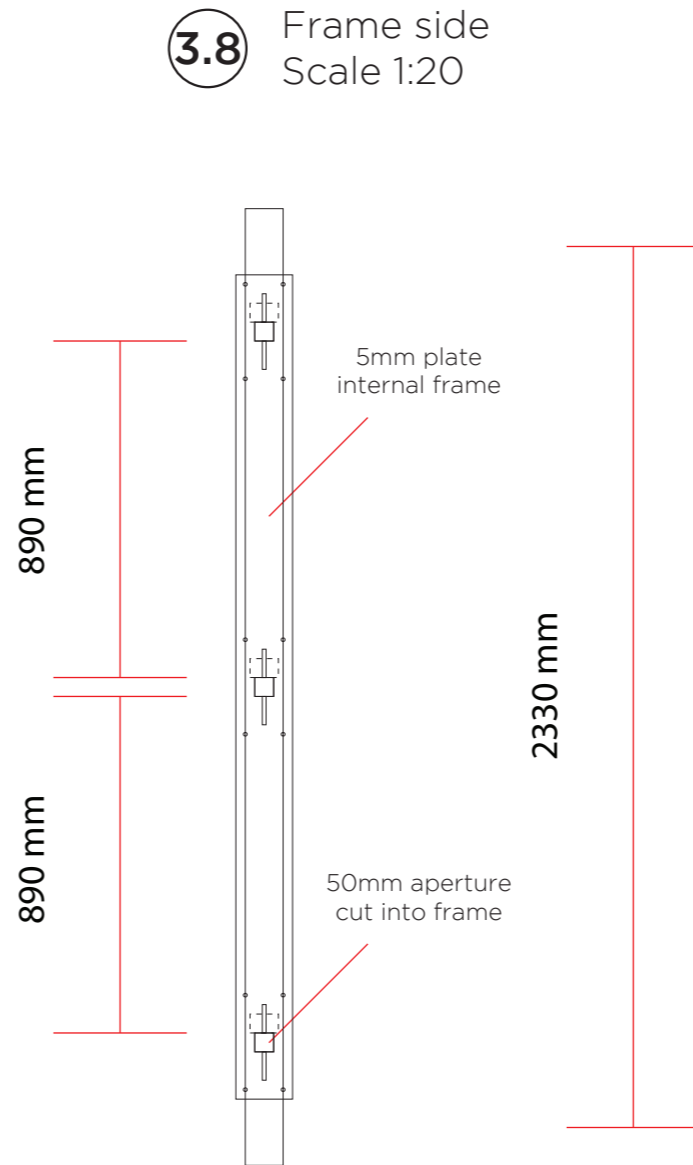
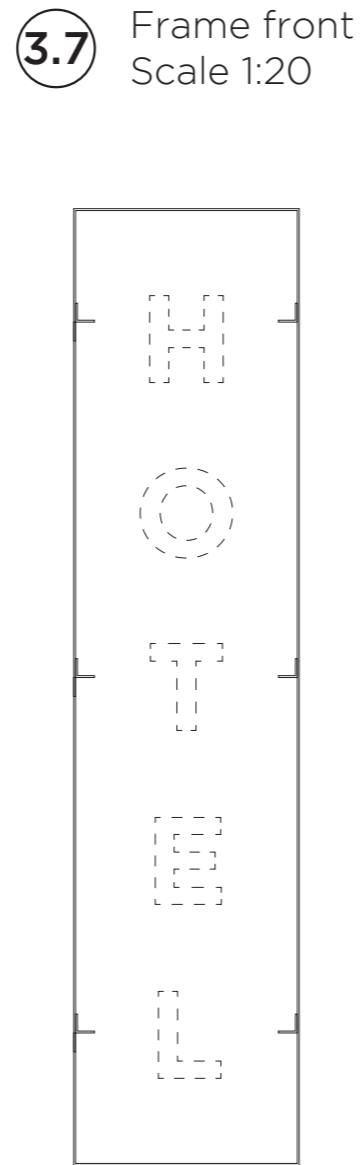
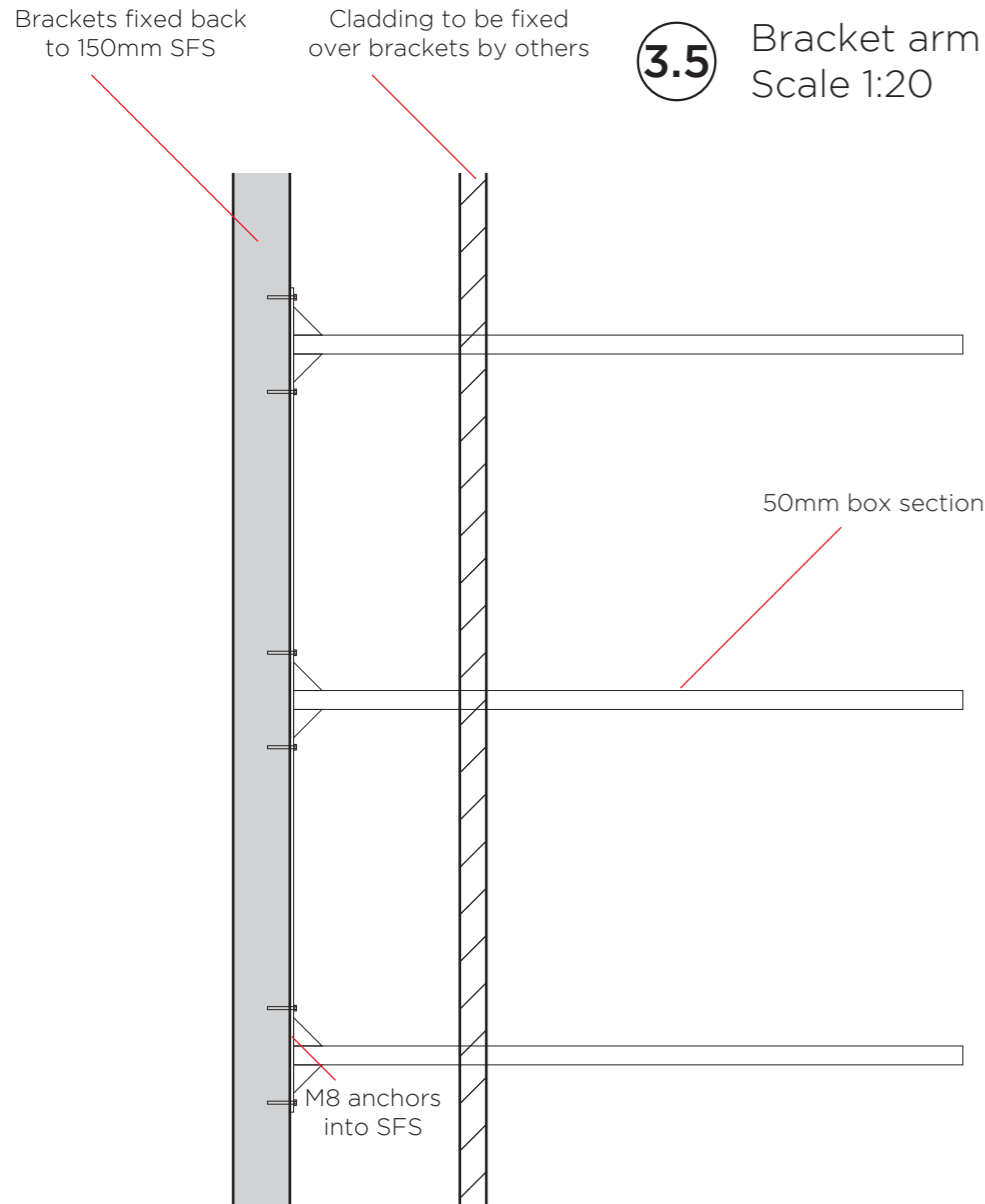

**First fix bracket**

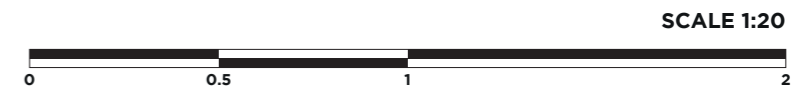

#6331 BT	Rev: 10/3	Page: 6	30/06/2023	SCALE AS SPECIFIED @ A3
External	<b>Position 2:</b> Projecting Neon Sign			<b>GOODWIN &amp; GOODWIN</b> 'SIGNS WITH SOUL'
Drawn by JL	Ruby Hospitality UK LTD			

**3.10** Bracket front  
 Scale 1:10

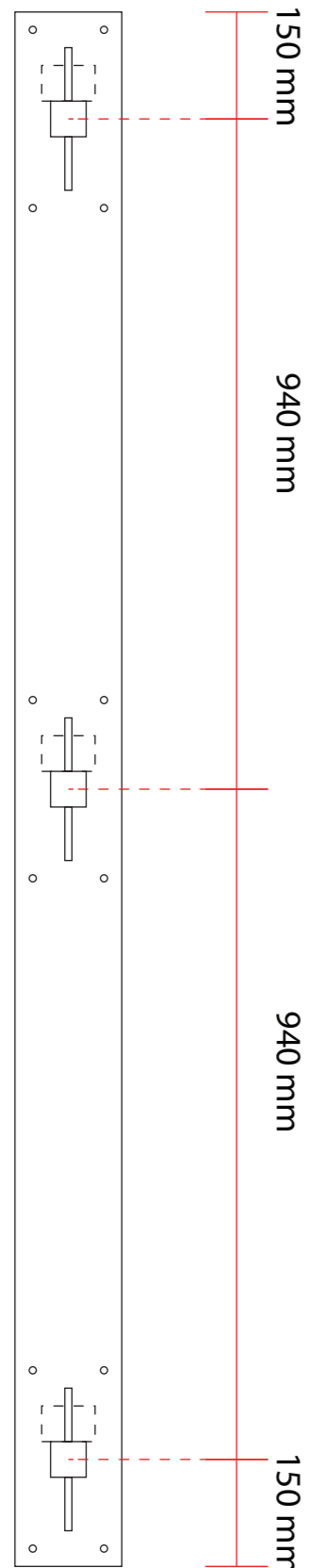

**First fix bracket**

**3.11** Bracket top  
 Scale 1:5

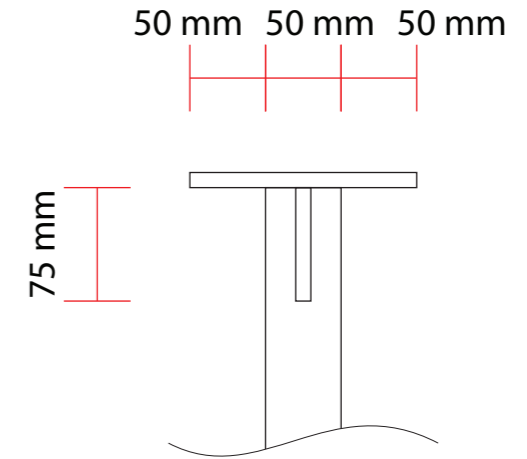

**3.12** Bracket left  
 Scale 1:5

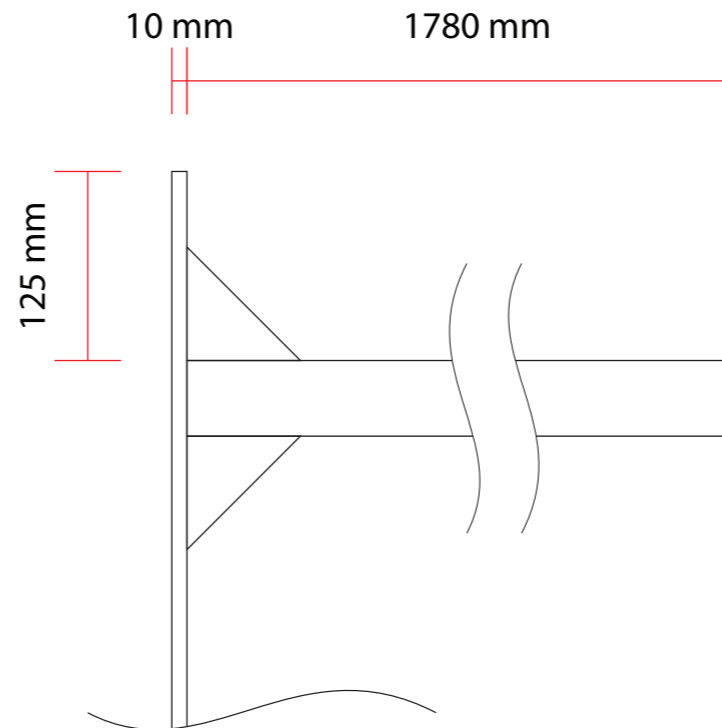

**3.13** Bracket front  
 Scale 1:5

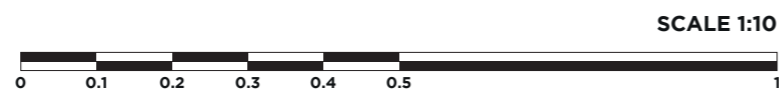
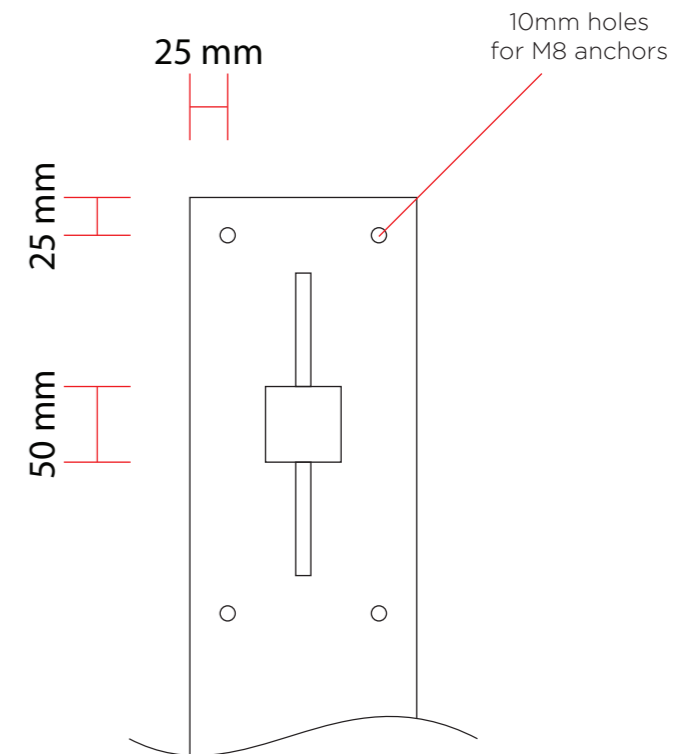

#6331 BT	Rev: 10/3	Page: 7	30/06/2023	SCALE AS SPECIFIED @ A3
External	<b>Position 2:</b> Projecting Neon Sign			<b>GOODWIN &amp; GOODWIN</b> 'SIGNS WITH SOUL'
Drawn by JL	Ruby Hospitality UK LTD			

Please check the design carefully. Bespoke commission orders cannot be cancelled once production has started.  
 Finished products are non-returnable and non-exchangeable.

**4.1** South Elevation  
 Scale 1:50

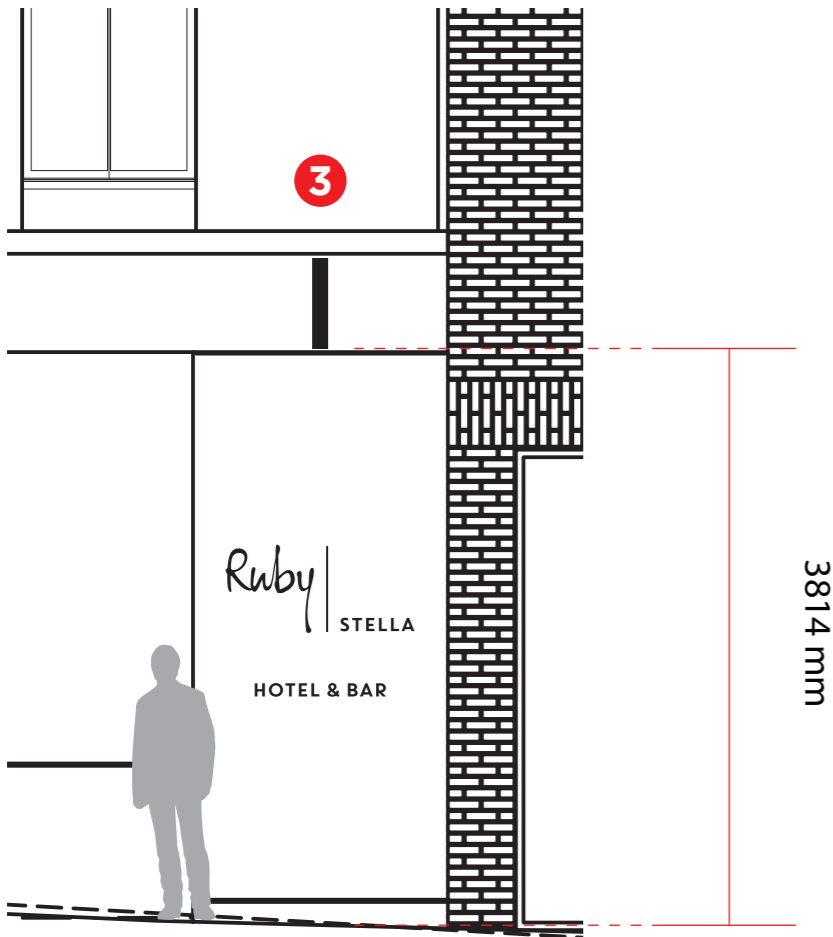

**4.2** Left  
 Scale 1:10

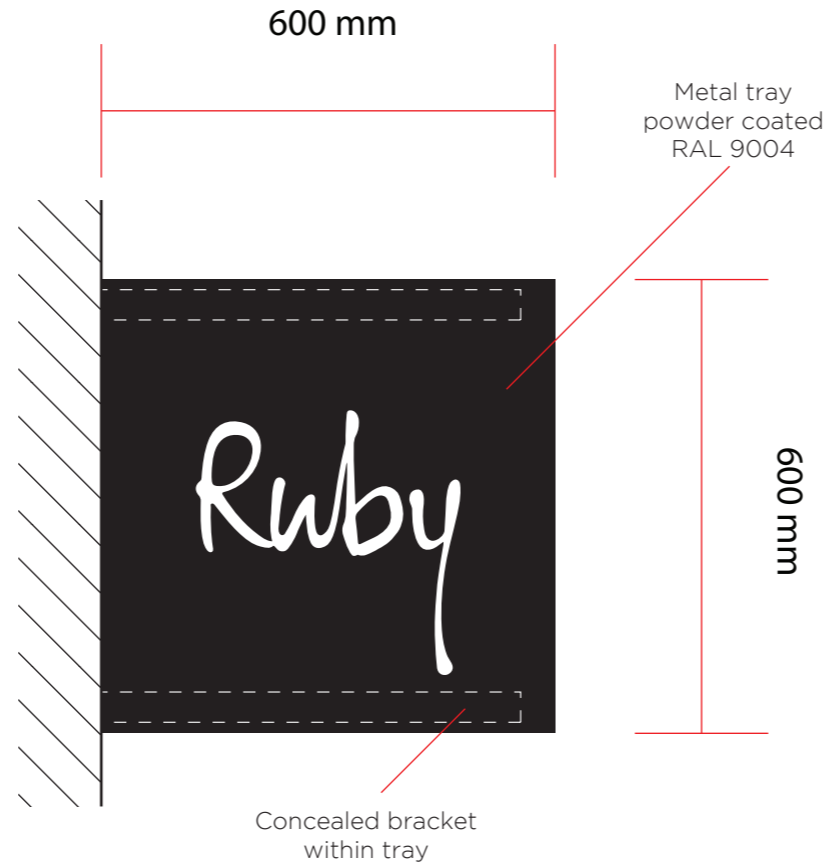

**4.3** Front  
 Scale 1:10

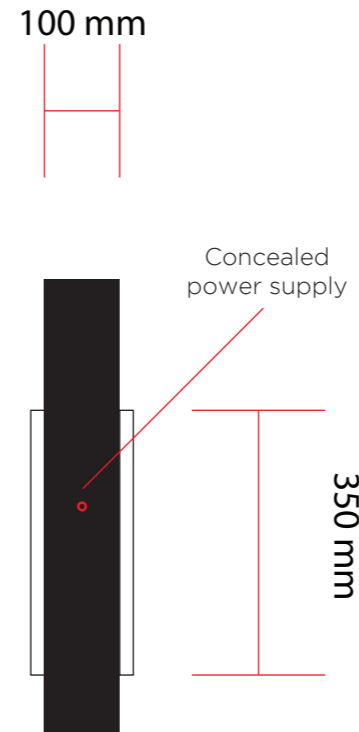

**4.4** Right  
 Scale 1:10



Built up metal tray, double sided, with 100mm returns.  
 Metal tray powder coated RAL 9004.  
 Fret cut detail to both sides, with 18mm opal acrylic push-through letters.  
 To read "RUBY" as per logo.  
 Metal tray to be fixed flush to building fascia, central to wall area.  
 Bottom of sign to be 3814mm from ground level.  
 Cabling and power supply concealed within tray.  
 Fixed to GRC cladding with internal brackets and concealed fixings.

**Weight: 25kg max**

**Max. Luminance: 400mm cd/m2**

**Quantity x 1**



SCALE 1:50

Colour swatch

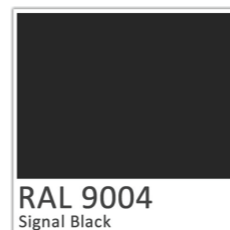

RAL 9004  
 Signal Black

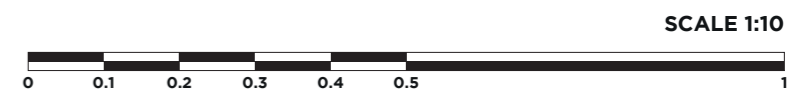

SCALE 1:10

#6331 BT	Rev: 10/3	Page: 8	30/06/2023	SCALE AS SPECIFIED @ A3
External	<b>Position 3:</b> Projecting Blade Sign			<b>GOODWIN &amp; GOODWIN</b> 'SIGNS WITH SOUL'
Drawn by JL	Ruby Hospitality UK LTD			



Please check the design carefully. Bespoke commission orders cannot be cancelled once production has started.  
 Finished products are non-returnable and non-exchangeable.

**4.5** Front  
 Scale 1:10

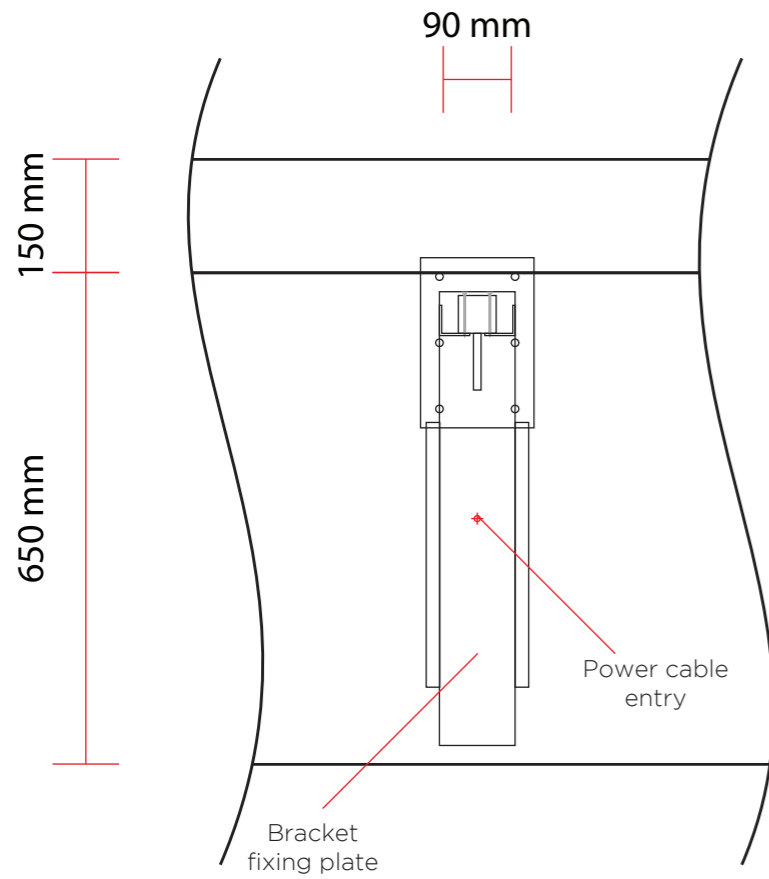

**4.6** Bracket arm position  
 Scale 1:10

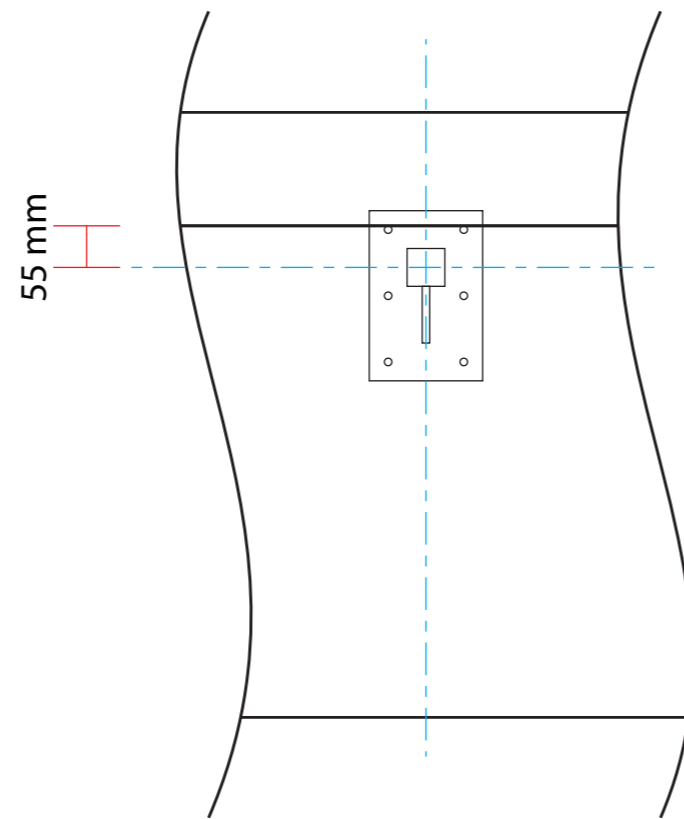

**4.7** Assembled  
 Scale 1:10

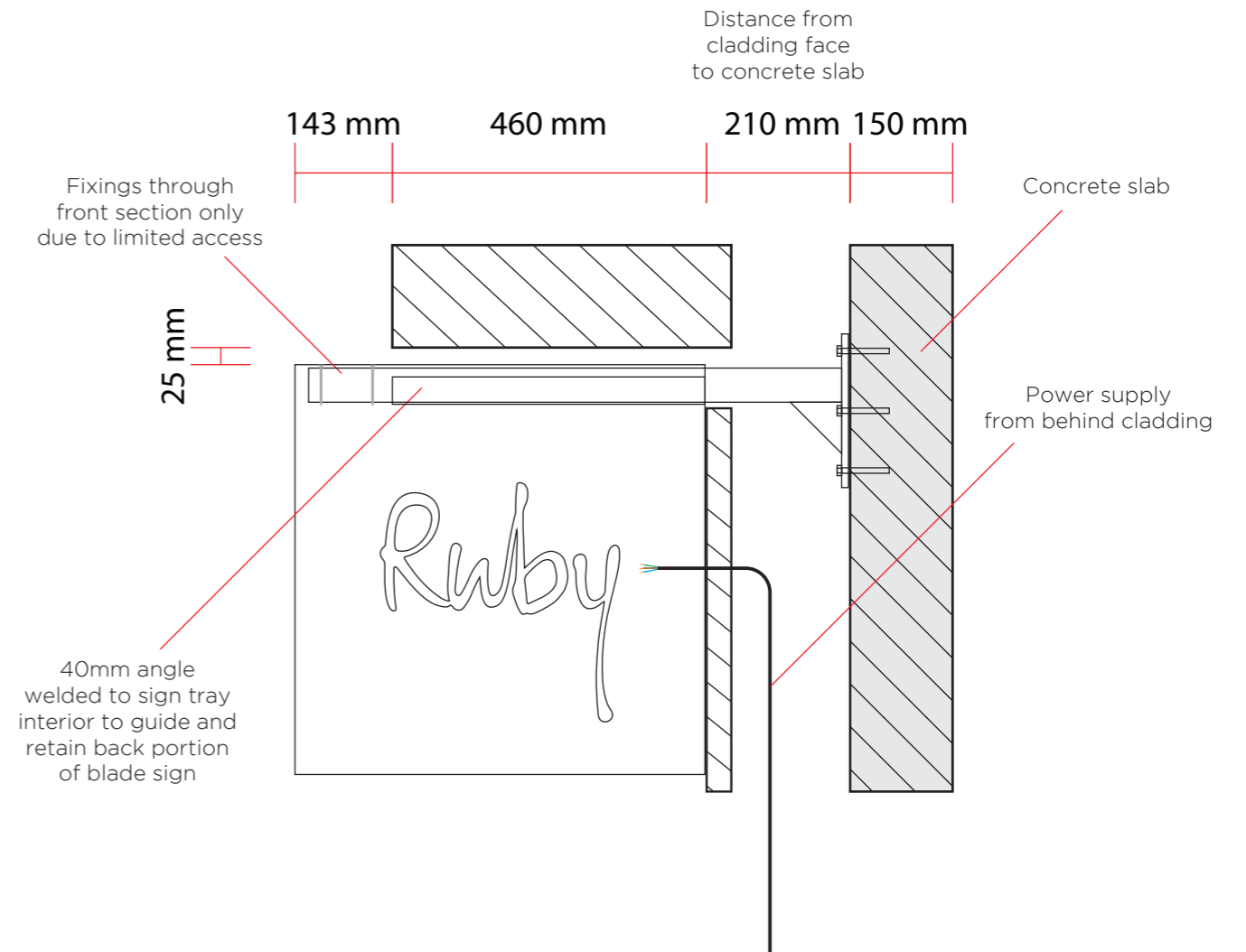

**First fix bracket**

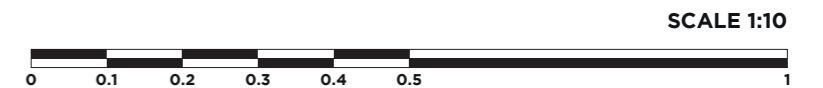

#6331 BT	Rev: 10/3	Page: 9	30/06/2023	SCALE AS SPECIFIED @ A3
External	<b>Position 3:</b> Projecting Blade Sign			<b>GOODWIN &amp; GOODWIN</b> 'SIGNS WITH SOUL'
Drawn by JL	Ruby Hospitality UK LTD			

Please check the design carefully. Bespoke commission orders cannot be cancelled once production has started.  
 Finished products are non-returnable and non-exchangeable.

**First fix bracket**

**4.8** Bracket top  
 Scale 1:10

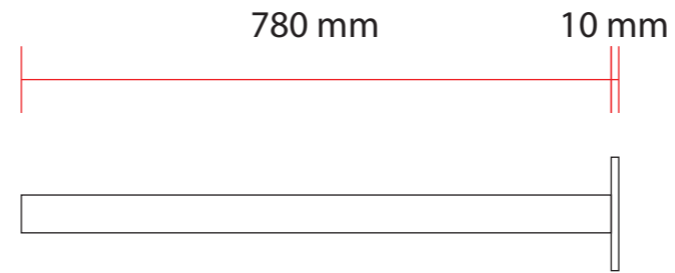

**4.9** Bracket front  
 Scale 1:10

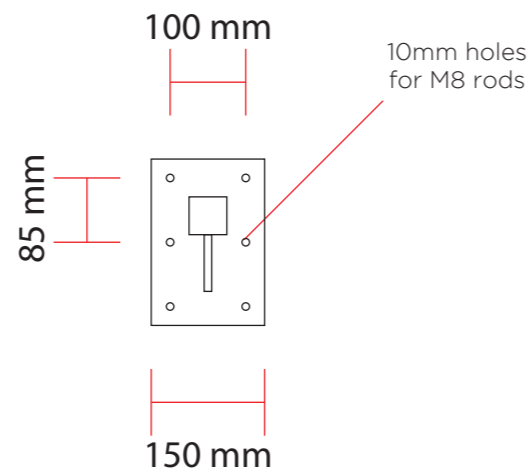

**4.10** Bracket right  
 Scale 1:10

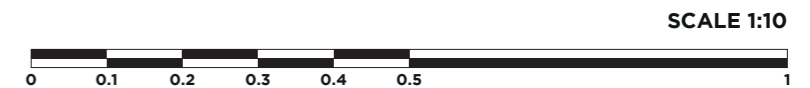

#6331 BT	Rev: 10/3	Page: 10	30/06/2023	SCALE AS SPECIFIED @ A3
External	<b>Position 3:</b> Projecting Blade Sign			<b>GOODWIN &amp; GOODWIN</b> 'SIGNS WITH SOUL'
Drawn by JL	Ruby Hospitality UK LTD			

Please check the design carefully. Bespoke commission orders cannot be cancelled once production has started.  
Finished products are non-returnable and non-exchangeable.

5.2 Front Scale 1:20

5.3 Right Scale 1:20

5.1 South Elevation Scale 1:50

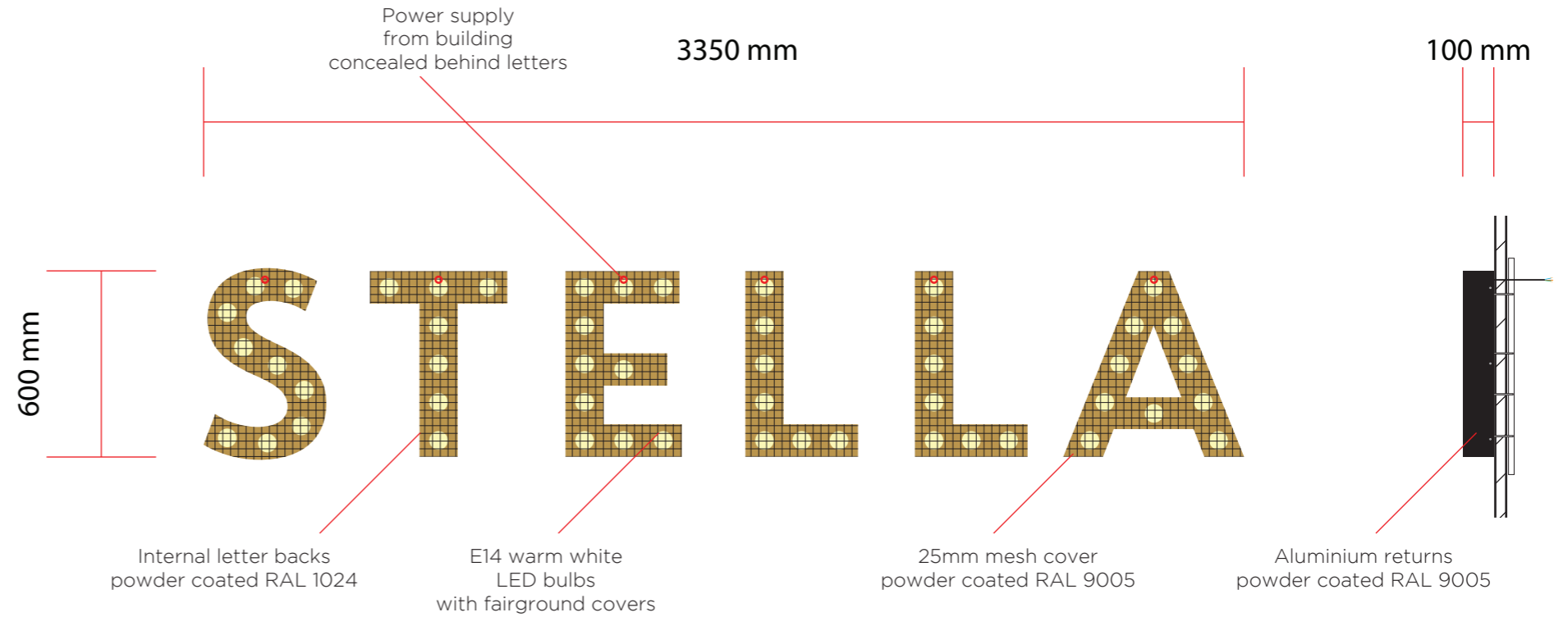
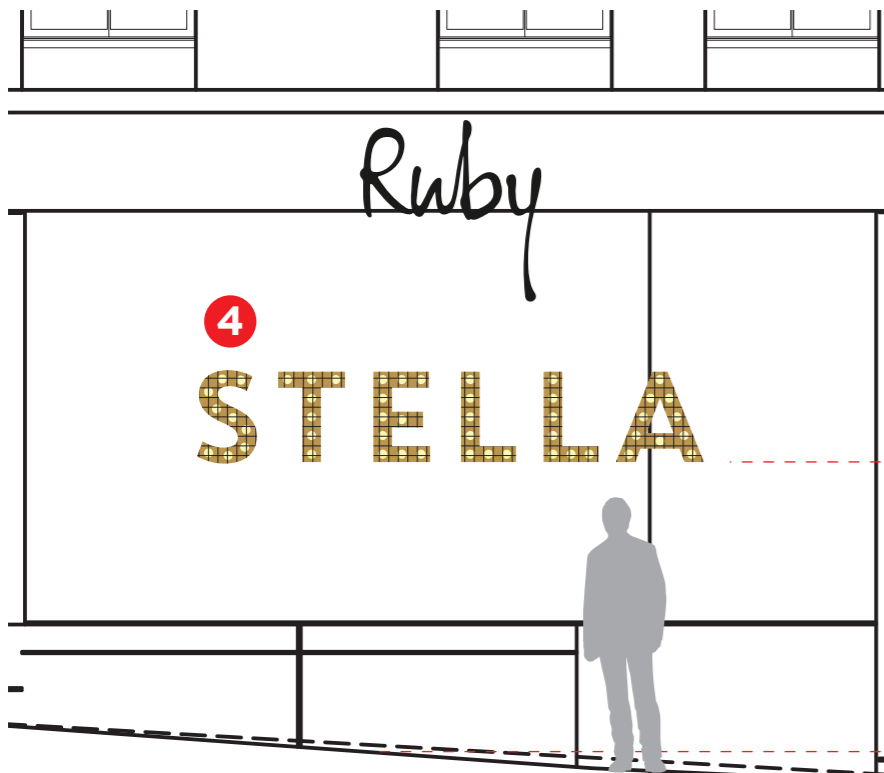

1920 mm

Built up aluminium channel letters, with 100mm returns.  
Letters faced with 25mm mesh covers to hinder pedestrian bulb access.  
External returns and mesh powder coated RAL 9005 (black).  
Internal metal backs powder coated RAL 1024 (Ochre Yellow).  
Inlaid with warm white E14 LED bulbs.  
To read "STELLA" in Core Circus font.  
Fitted directly to GRC cladding with rods and adhesive.  
Cladding behind signage to be thickened/backed by supplier.  
Bottom of sign to be 1920mm from ground level.  
Power supply to each individual letter from rear-top, concealed behind.

**Weight: 36kg max**

**Max. Luminance: 400mm cd/m2**

**Quantity x 1**

SCALE 1:50



Colour swatch



SCALE 1:20



#6331 BT	Rev: 10/3	Page: 11	30/06/2023	SCALE AS SPECIFIED @ A3
External	<b>Position 4: Bulb Letters</b>			<b>GOODWIN &amp; GOODWIN</b> 'SIGNS WITH SOUL'
Drawn by JL	Ruby Hospitality UK LTD			

Please check the design carefully. Bespoke commission orders cannot be cancelled once production has started.  
 Finished products are non-returnable and non-exchangeable.

**5.4** Fixing detail  
 Scale 1:20

**5.5** Right  
 Scale 1:10

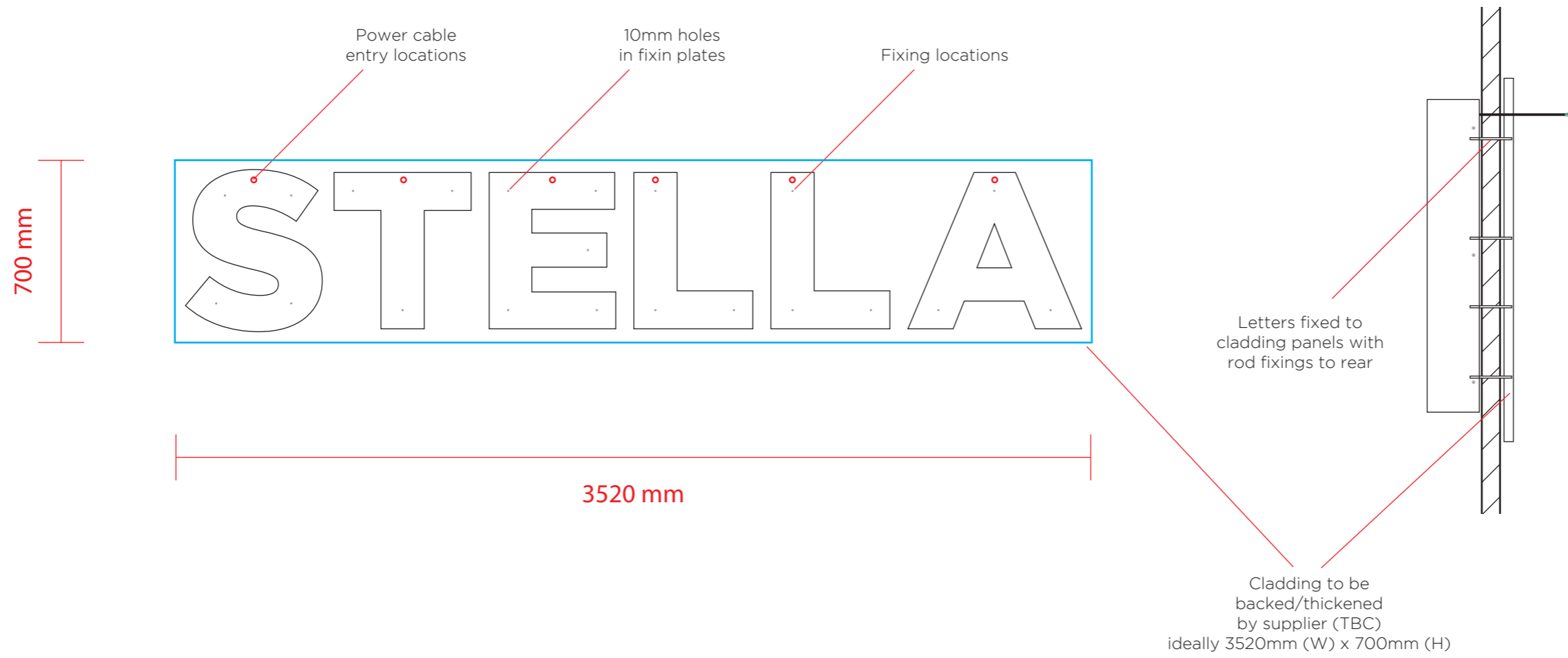

#6331 BT	Rev: 10/3	Page: 12	30/06/2023	SCALE AS SPECIFIED @ A3
External	<b>Position 4: Bulb Letters</b>			<b>GOODWIN &amp; GOODWIN</b> 'SIGNS WITH SOUL'
Drawn by JL	Ruby Hospitality UK LTD			

Please check the design carefully. Bespoke commission orders cannot be cancelled once production has started.  
 Finished products are non-returnable and non-exchangeable.

**6.1** South Elevation  
 Scale 1:50



**6.2** Front  
 Scale 1:20

**6.3** Right  
 Scale 1:20

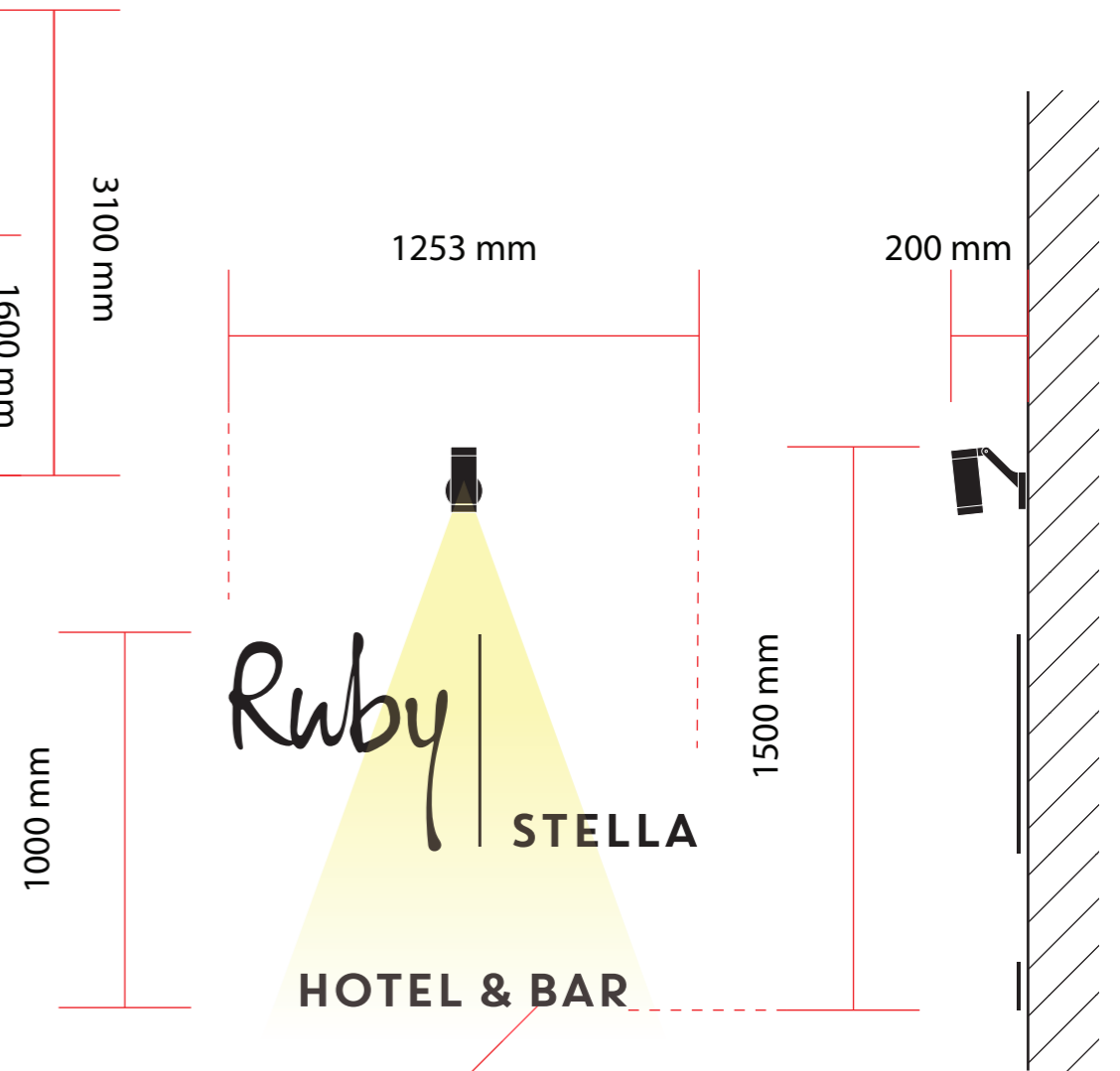

Flat cut 5mm mild steel letters, blackened finish.  
 Fitted directly to GRC cladding with rods and adhesive.  
 Cladding behind signage to be thickened/backed by supplier.  
 With 20mm standoff from building.  
 Illuminated with Artemide Obice wall 34° 605lm, 3000K LED, tilting angle +35°/-125°  
 Matt black finish, with wall bracket.  
 Lighting bracket fitted directly to GRC cladding with screws and adhesive.  
 Power supply from building directly behind fixture.

**Quantity x 2**

**'STELLA' and 'HOTEL & BAR' text produced  
 in Core Circus font, -100 tracking**

**Weight: 5kg max**

**Max. Luminance: 400mm cd/m2**

Colour swatch

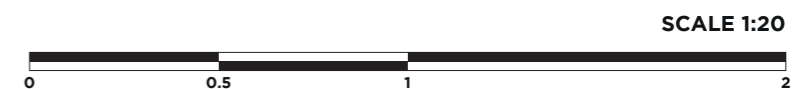

#6331 BT	Rev: 10/3	Page: 13	30/06/2023	SCALE AS SPECIFIED @ A3
External	<b>Position 5 &amp; 6: Silhouette Lettering</b>			<b>GOODWIN &amp; GOODWIN</b> 'SIGNS WITH SOUL'
Drawn by JL	Ruby Hospitality UK LTD			

Please check the design carefully. Bespoke commission orders cannot be cancelled once production has started.  
 Finished products are non-returnable and non-exchangeable.

**6.4** Front  
 Scale 1:10

**6.5** Right  
 Scale 1:10

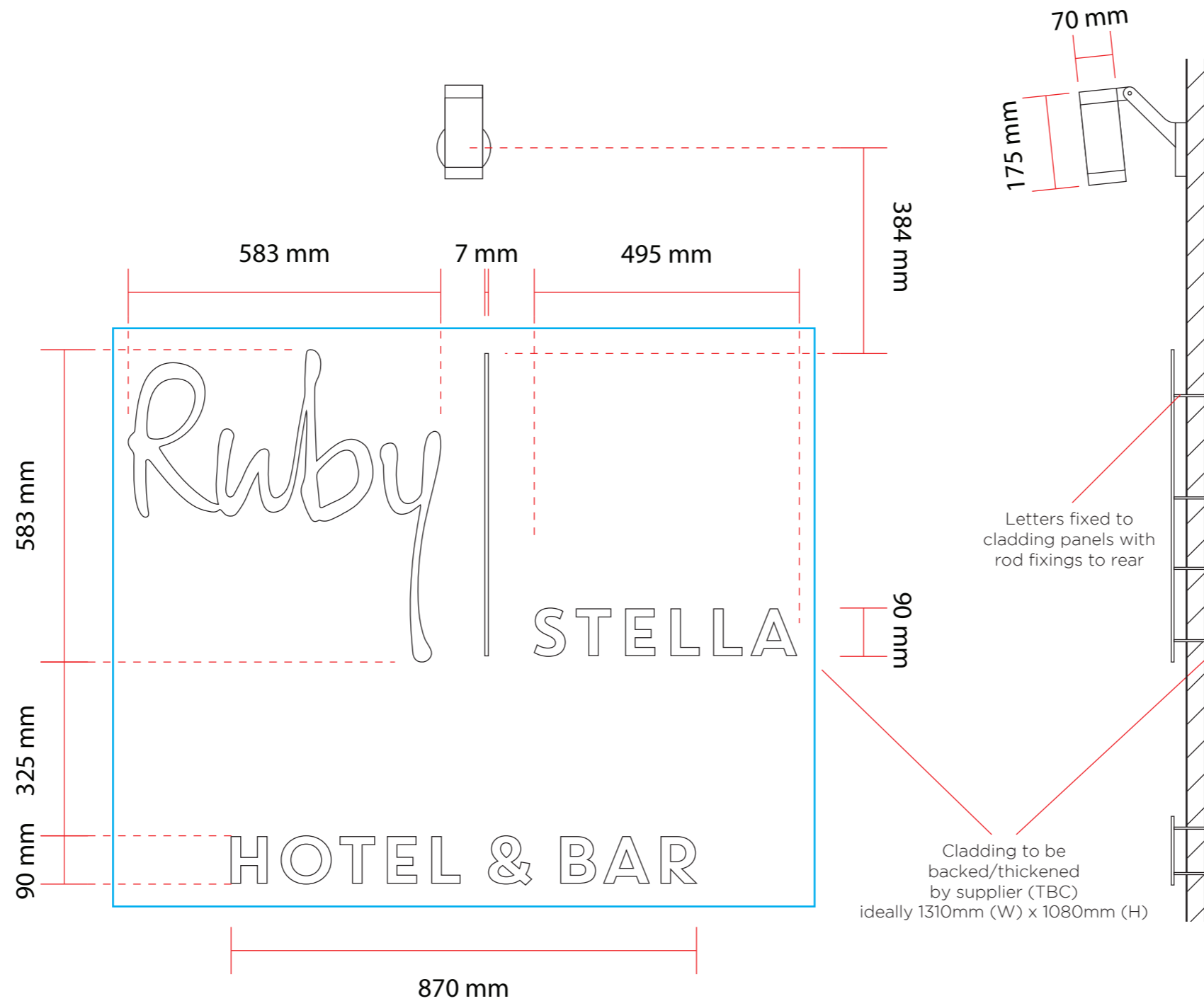

#6331 BT	Rev: 10/3	Page: 14	30/06/2023	SCALE AS SPECIFIED @ A3
External	<b>Position 5 &amp; 6:</b> Silhouette Lettering			<b>GOODWIN &amp; GOODWIN</b> 'SIGNS WITH SOUL'
Drawn by JL	Ruby Hospitality UK LTD			