

EXISTING MANHOLE 3 (RETAINED) SIZE AND DEPTH OF CHAMBER UNKNOWN. EXISTING COVER TO BE REPLACED WITH NEW DOUBLE SEALED COVER AND FRAME (INFILL TYPE) FOR INFILL OF STONE SLABS.

50ø WASTE PIPE @ L/L TO DROP INTO FLOOR BUILD UP & CONNECT TO EXISTING MANHOLE 3.

40ø TRAPPED STANDPIPE & WASTE PIPE FOR CONNECTION OF WASHING MACHINE TO 50ø WASTE PIPE @ L/L.

TUNDISH & P TRAP & WASTE TO PIPE FOR BOILER CONDENSATE DROPS TO L/L.

EXISTING RWP FROM RWO ABOVE DROPS & CONNECT TO NEW BACK-INLET GULLY.

OUTDOOR COOKING AREA.
SINK - 40ø P TRAP & WASTE PIPE CONNECTS TO EXISTING 100ø CI SVP.

UTILITY ROOM
WASHING MACHINE - FLEXIBLE DRAIN HOSE TO DISCHARGE TO 40ø TRAPPED STANDING PIPE.
SINK - 40ø 'P' TRAP & WASTE PIPE CONNECT TO 50ø STUB WASTE PIPE.

EXISTING RAIN WATER HOPPER & UPVC RWP TO DRAIN TO BE RETAINED.

NEW ACO BRICKSLOT DRAINAGE SUMP (TRAPPED) CONNECTS TO EXISTING DRAIN TO MH2 (ACO-47004).

EXISTING MH2 (RETAINED)
600 X 450 mm
DEPTH 630mm

EXISTING MH1 (RETAINED)
600 X 450 mm
DEPTH 630mm

EXISTING OPEN TOP GULLY TO MH1 TO BE RETAINED.

NEW 110ø CI RWP F/A CONNECTS TO NEW BACK INLET GULLY (BIG).

NEW ACO BRICKSLOT DRAINAGE SUMP (TRAPPED) CONNECTS TO EXISTING DRAIN TO MH1 (ACO-47004).

EXISTING OPEN TOP GULLY UNDER EXISTING DECKING TO BE REMOVED/GROUTED SOLID.

NEW ACO BRICKSLOT RAIN DRAIN SLOT DRAINAGE CHANNEL (ACO-47002) WITH ACO BRICKSLOT RAINRAIN CORNER UNIT (ACO-7351).
(IN ABEYANCE SUBJECT TO LANDSCAPE DESIGN).

BATHROOM RM.00.06
WC - PTRAP WC PAN TO CONNECT TO NEW 110ø STUB STACK.
BATH - 40ø P TRAP & WASTE PIPE TO NEW 50ø WASTE PIPE AT L/L (FLOAT) & CONNECTS TO NEW 110ø STUB STACK.
WHB - 32ø P TRAP & WASTE PIPE CONNECTS TO 40ø STUB STACK WHICH CONNECTS TO 40ø FLOAT.

EXISTING 100ø UPVC SOIL PIPE F/A TO BE STRIPPED OUT & REPLACED WITH NEW 110ø SVP.

BATHROOM RM.00.06
DOUBLE BOWL SINK - 2 No 40ø P TRAPS & WASTE PIPES CONNECTING TO 50ø HORIZONTAL WASTE PIPE WITH RODDING ACCESS ON END.
50ø HORIZONTAL WASTE PIPE CONNECTS TO 110ø STUB STACK IN BATHROOM.
DISHWASHER - FLEXIBLE DRAIN HOSE TO 40ø TRAPPED STANDING PIPE & WASTE CONNECTING TO 50ø WASTE FLOAT IN BATHROOM.

NOTES

- DO NOT SCALE FROM THIS DRAWING.
- THIS DRAWING IS TO BE READ IN CONJUNCTION WITH THE SPECIFICATION AND ALL RELEVANT ARCHITECTURAL, ELECTRICAL, MECHANICAL AND STRUCTURAL DRAWINGS.
- THIS DRAWING SHOWS INDICATIVE ROUTES OF THE PIPEWORK AND LOCATION OF PLANT, FITTINGS AND EQUIPMENT AND IT IS THE CONTRACTORS RESPONSIBILITY TO CO-ORDINATE THE INSTALLATION OF ALL SERVICES WITHIN ALL DISCIPLINES.
- THE CONTRACTOR SHALL FULLY CO-ORDINATE ALL SERVICES ACCESS POSITIONS WITH OTHER TRADES AS REQUIRED.
- THE CONTRACTOR SHALL FULLY CO-ORDINATE ALL SANITARY DRAINAGE SERVICES PIPEWORK AND EQUIPMENT WITH EXISTING SERVICES ALLOWING FOR ADEQUATE ACCESS FOR MAINTENANCE AND/OR REPLACEMENT.
- ACCESS SHALL BE PROVIDED AT THE END OF EACH HORIZONTAL RUN AND EVERY CHANGE OF DIRECTION.
- ACCESS DOOR SHALL BE PROVIDED TO ALL VERTICAL STACKS ON EACH FLOOR 1.2m ABOVE FINISHED FLOOR LEVEL WHERE STUB STACKS ARE USED THEY SHALL BE PROVIDED WITH FULL BORE TOP ACCESS LOCATED ABOVE THE SPILL OVER LEVEL OF THE TOP MOST FITTING.
- FALLS ON SOIL AND WASTE PIPE AND VENT PIPES SHALL NOT FALL BELOW THE MINIMUM STATED IN BS EN 12056 - 2 GRAVITY DRAINAGE INSIDE BUILDINGS.
- WHERE CONDENSATE WASTE PIPEWORK CONNECTS TO SOIL STACKS THE USE OF WATERLESS TRAPS SUCH AS HEPWORTHS 'HEPVO' SHALL BE USED.
- SWEPT LONG OR MEDIUM RADIUS 90° OR 45° BENDS SHALL BE USED. WHENEVER POSSIBLE. ALL JUNCTIONS SHALL BE 45°. THE USE OF KNUCKLE BENDS WILL NOT BE PERMITTED.
- THE PUBLIC HEALTH SERVICES SANITARY DRAINAGE DESIGN AND INSTALLATION SHALL BE IN STRICT ACCORDANCE WITH BS. EN. 12056-2 AND BUILDING REGULATIONS APPROVED DOCUMENT H.
- INTERNAL VERTICAL AND HORIZONTAL SOIL & WASTE STACKS AND STUB STACKS SHALL BE LIGHT WEIGHT CAST IRON WITH MECHANICAL JOINTS TO BS EN 877 AND BRANCH WASTE PIPEWORK SHALL BE UPVC AND MUPVC.
- ALL CONCEALED RAINWATER AND SOIL AND VENT PIPEWORK THAT ARE INSTALLED HORIZONTALLY AND VERTICALLY WITHIN DUCTS, CEILING AND FLOOR VOIDS SHALL BE ACOUSTICALLY INSULATED WITH 1 LAYER OF LAGGING AS MANUFACTURED BY MUFILAG TYPE SP29 & 58/10 OR EQUAL AND APPROVED. THE PIPEWORK SHALL THEN BE PROVIDED WITH A INSULATION WRAP WITH VAPOUR SEAL.

LEGEND

SVP	- SOIL VENT PIPE.
VP	- VENT PIPE.
G	- GULLY.
SHG	- SHOWER FLOOR GULLY.
RWP	- RAINWATER PIPE.
RWO	- RAINWATER OUTLET.
F/A	- FROM ABOVE.
T/B	- TO BELOW.
AAV	- AIR ADMITTANCE VALVE.
H/L	- HIGH LEVEL.
M/L	- MEDIUM LEVEL.
L/L	- LOW LEVEL.
SS	- STUB STACK/STUB WASTE PIPE.
CTD	- CONNECT TO UNDERGROUND DRAIN.
CI	- CAST IRON.
WC	- WATER CLOSET.
---	PIPEWORK AT L/L & M/L.
----	PIPEWORK AT H/L.
-----	PIPEWORK IN FLOOR VOIDS.

TENDER ISSUE

Revisions				Revisions				Revisions				Project Consultants		CAD Ref.		Originator	
Rev.	Date	Description	CDM Chk'd	Chk'd	Rev.	Date	Description	CDM Chk'd	Chk'd	Rev.	Date	Description	CDM Chk'd	Chk'd			
P1	MAR.23	ISSUED FOR COMMENTS.	J.B	P.B								Architect	Quantity Surveyor	3206		Slender Winter Partnership Limited	
T1	APR.23	ISSUED FOR TENDER.	J.B	P.B								ARCHITECTURE FOR LONDON		Checked J.B	Date FEB.23	Client	
												Structural Engineer	Project Manager	Drawn G.H	Date FEB.23	Project 3 GAINSBOROUGH GARDENS	
														Scale 1:50@A1		Drawing Title GROUND FLOOR ABOVE GROUND DRAINAGE SERVICES LAYOUT	
														Revision T1		Drawing Number 3206-PH100	
This drawing is the copyright of slender winter partnership limited and shall not be copied or reproduced in whole or in part in any manner whatsoever without the prior written consent of slender winter partnership limited.												THE COPYRIGHT DESIGN & PATENTS ACT 1988. DO NOT SCALE. ALL DIMENSIONS TO BE CHECKED ON SITE.					

swp ltd

consulting engineers

Head Office: 2 Kings Hill Avenue, Kings Hill, West Malling, Kent, ME19 4AQ.
T: 01959 564777 E: swp@swpltd.co.uk

SWP Limited. Registered Office: 2 Kings Hill Avenue, West Malling, Kent, ME19 4AQ. Registered in England No 3732641

ISO 14001

REGISTERED FIRM

ace

excellence engineering business environment

UKAS

MANUFACTURING

117

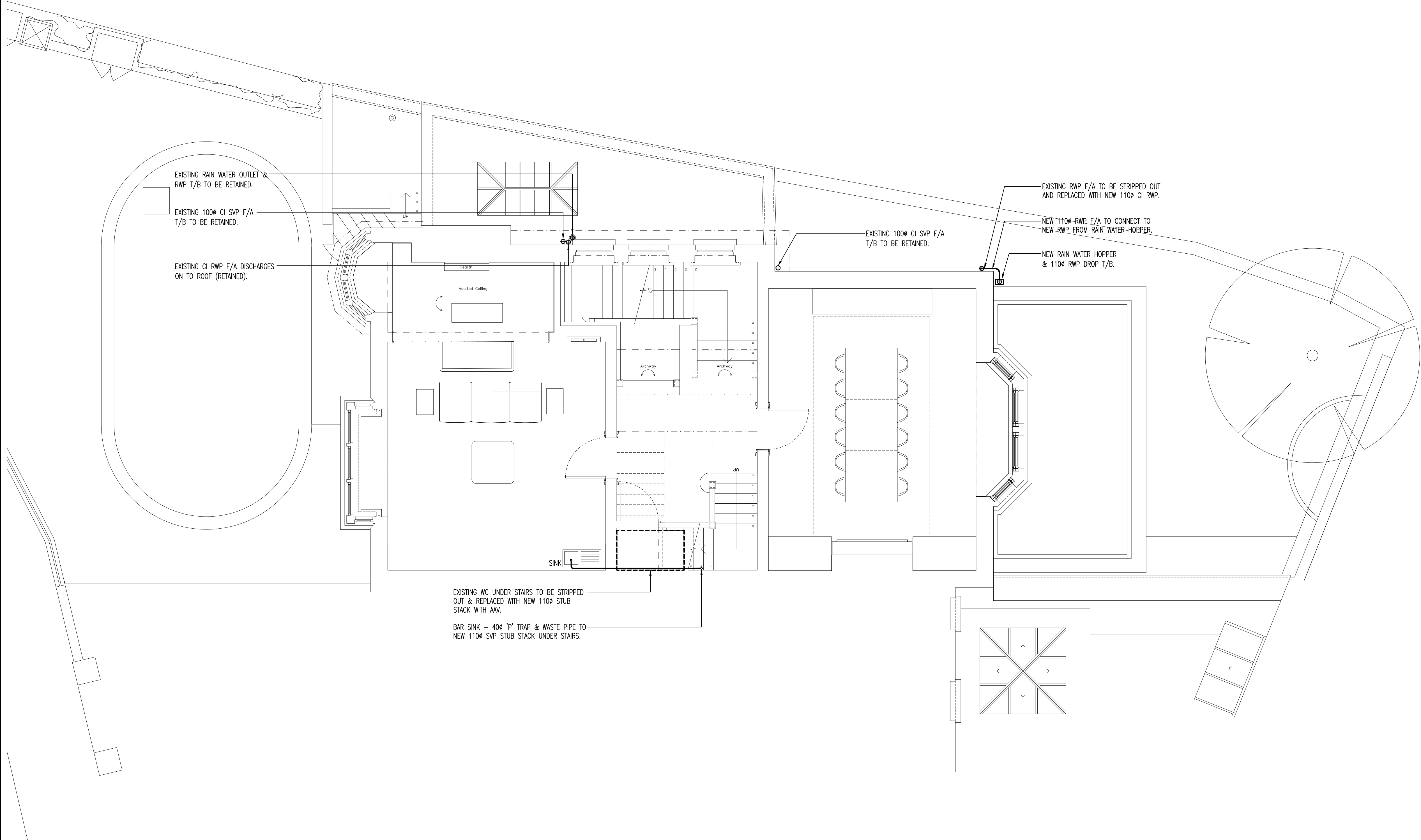

- NOTES
- DO NOT SCALE FROM THIS DRAWING.
 - THIS DRAWING IS TO BE READ IN CONJUNCTION WITH THE SPECIFICATION AND ALL RELEVANT ARCHITECTURAL, ELECTRICAL, MECHANICAL AND STRUCTURAL DRAWINGS.
 - THIS DRAWING SHOWS INDICATIVE ROUTES OF THE PIPEWORK AND LOCATION OF PLANT, FITTINGS AND EQUIPMENT AND IT IS THE CONTRACTORS RESPONSIBILITY TO CO-ORDINATE THE INSTALLATION OF ALL SERVICES WITHIN ALL DISCIPLINES.
 - THE CONTRACTOR SHALL FULLY CO-ORDINATE ALL SERVICES ACCESS POSITIONS WITH OTHER TRADES AS REQUIRED.
 - THE CONTRACTOR SHALL FULLY CO-ORDINATE ALL SANITARY DRAINAGE SERVICES PIPEWORK AND EQUIPMENT WITH EXISTING SERVICES ALLOWING FOR ADEQUATE ACCESS FOR MAINTENANCE AND/OR REPLACEMENT.
 - ACCESS SHALL BE PROVIDED AT THE END OF EACH HORIZONTAL RUN AND EVERY CHANGE OF DIRECTION.
 - ACCESS DOOR SHALL BE PROVIDED TO ALL VERTICAL STACKS ON EACH FLOOR 1.2m ABOVE FINISHED FLOOR LEVEL. WHERE STUB STACKS ARE USED THEY SHALL BE PROVIDED WITH FULL BORE TOP ACCESS LOCATED ABOVE THE SPILL OVER LEVEL OF THE TOP MOST FITTING.
 - FALLS ON SOIL AND WASTE PIPE AND VENT PIPES SHALL NOT FALL BELOW THE MINIMUM STATED IN BS EN 12056 - 2 GRAVITY DRAINAGE INSIDE BUILDINGS.
 - WHERE CONDENSATE WASTE PIPEWORK CONNECTS TO SOIL STACKS THE USE OF WATERLESS TRAPS SUCH AS HEPWORTH'S "HEPVO" SHALL BE USED.
 - SWEPT LONG OR MEDIUM RADIUS 90° OR 45° BENDS SHALL BE USED WHENEVER POSSIBLE. ALL JUNCTIONS SHALL BE 45°. THE USE OF KNUCKLE BENDS WILL NOT BE PERMITTED.
 - THE PUBLIC HEALTH SERVICES SANITARY DRAINAGE DESIGN AND INSTALLATION SHALL BE IN STRICT ACCORDANCE WITH BS. EN. 12056-2 AND BUILDING REGULATIONS APPROVED DOCUMENT H.
 - INTERNAL VERTICAL AND HORIZONTAL SOIL & WASTE STACKS AND STUB STACKS SHALL BE LIGHT WEIGHT CAST IRON WITH MECHANICAL JOINTS TO BS EN 877 AND BRANCH WASTE PIPEWORK SHALL BE UPVC AND MUPVC.
 - ALL CONCEALED RAINWATER AND SOIL AND VENT PIPEWORK THAT ARE INSTALLED HORIZONTALLY AND VERTICALLY WITHIN DUCTS, CEILING AND FLOOR VOIDS SHALL BE ACOUSTICALLY INSULATED WITH 1 LAYER OF LAGGING AS MANUFACTURED BY MUFTILAG TYPE SP29 & 5B/10 OR EQUAL AND APPROVED. THE PIPEWORK SHALL THEN BE PROVIDED WITH A INSULATION WRAP WITH VAPOUR SEAL.

- LEGEND
- SVP - SOIL VENT PIPE.
 - VP - VENT PIPE.
 - G - GULLY.
 - SHG - SHOWER FLOOR GULLY.
 - RWP - RAINWATER PIPE.
 - RWO - RAINWATER OUTLET.
 - F/A - FROM ABOVE.
 - T/B - TO BELOW.
 - AAV - AIR ADMITTANCE VALVE.
 - H/L - HIGH LEVEL.
 - M/L - MEDIUM LEVEL.
 - L/L - LOW LEVEL.
 - SS - STUB STACK/STUB WASTE PIPE.
 - CTD - CONNECT TO UNDERGROUND DRAIN.
 - CI - CAST IRON.
 - WC - WATER CLOSET.
 - PIPEWORK AT L/L & M/L.
 - PIPEWORK AT H/L.
 - PIPEWORK IN FLOOR VOIDS.

TENDER ISSUE

Revisions					Revisions					Revisions					Project Consultants		CAD Ref.	Originator	
Rev.	Date	Description	CDM Chk'd	Chk'd	Rev.	Date	Description	CDM Chk'd	Chk'd	Rev.	Date	Description	CDM Chk'd	Chk'd	Architect	Quantity Surveyor	3206	SLENDER WINTER PARTNERSHIP LIMITED	
P1	MAR.23	ISSUE FOR COMMENT.	J.B	P.B														Client	
T1	APR.23	ISSUED FOR TENDER.	J.B	P.B														3 GAINSBOROUGH GARDENS	
																		Drawing Title	
																		FIRST FLOOR	
																		ABOVE GROUND DRAINAGE SERVICES LAYOUT	
																		Drawing Number	
																		3206-PH101	

THIS DRAWING IS THE COPYRIGHT OF SLENDER WINTER PARTNERSHIP LIMITED AND MUST NOT BE COPIED OR REPRODUCED IN ANY FORM OR BY ANY MEANS WITHOUT THE WRITTEN PERMISSION OF SLENDER WINTER PARTNERSHIP LIMITED.

THE COPYRIGHT DESIGN & PATENTS ACT 1988.

DO NOT SCALE. ALL DIMENSIONS TO BE CHECKED ON SITE.

CAD Ref. 3206

Checked J.B Date FEB.23

Drawn G.H Date FEB.23

Scale 1:50@A1

Revision T1

Originator SLENDER WINTER PARTNERSHIP LIMITED

Client

Project 3 GAINSBOROUGH GARDENS

Drawing Title FIRST FLOOR ABOVE GROUND DRAINAGE SERVICES LAYOUT

Drawing Number 3206-PH101

Head Office: 2 Kings Hill Avenue, Kings Hill, West Malling, Kent, ME19 4AQ.

T: 01959 564777 E: swp@swpltd.co.uk

SWP Limited. Registered Office: 2 Kings Hill Avenue, West Malling, Kent, ME19 4AQ. Registered in England No 372641

ISO 14001 REGISTERED FIRM

ace consulting engineers

UKAS

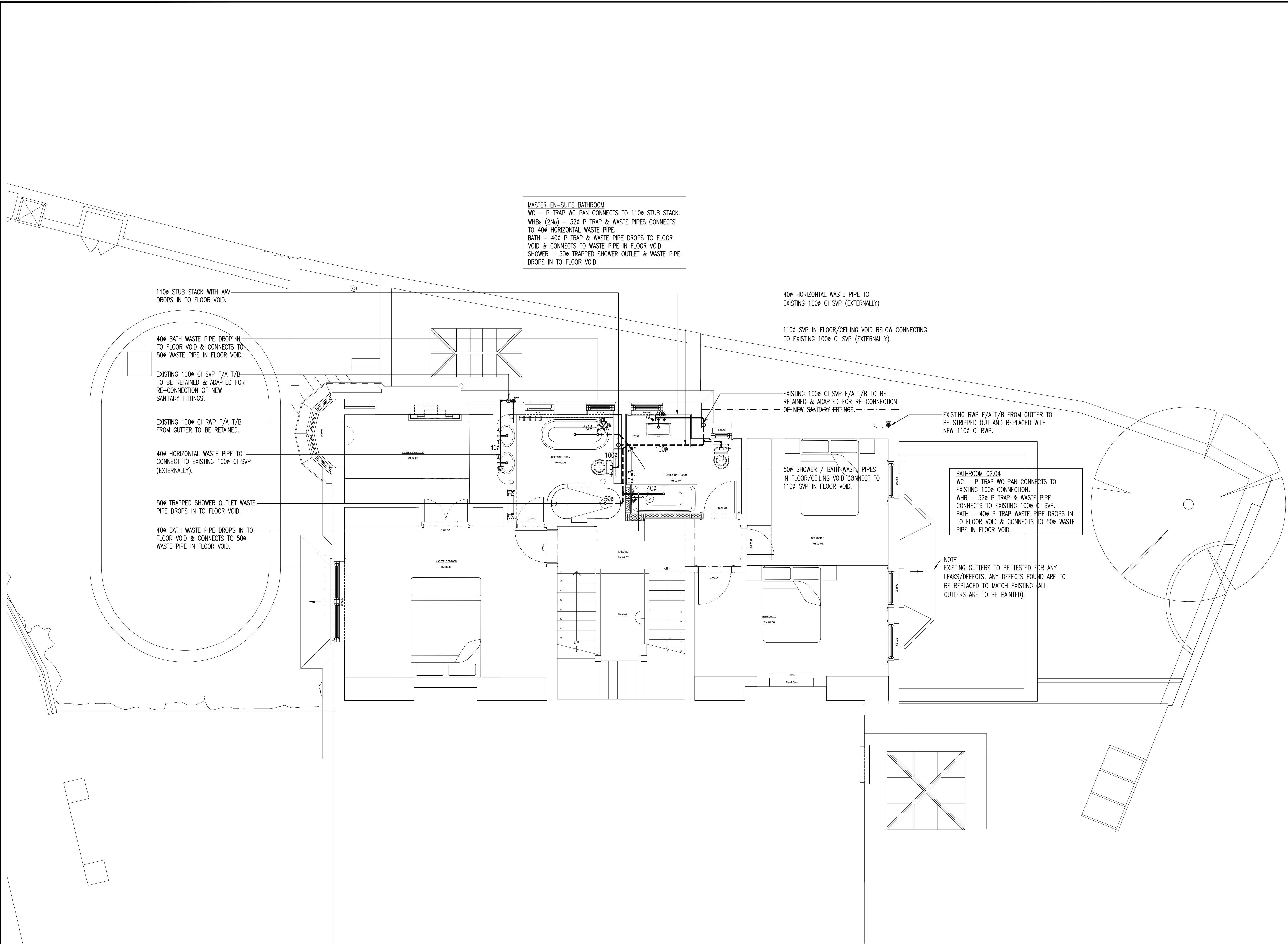

- NOTES
- DO NOT SCALE FROM THIS DRAWING.
 - THIS DRAWING IS TO BE READ IN CONJUNCTION WITH THE SPECIFICATION AND ALL RELEVANT ARCHITECTURAL, ELECTRICAL, MECHANICAL AND STRUCTURAL DRAWINGS.
 - THIS DRAWING SHOWS INDICATIVE ROUTES OF THE PIPEWORK AND LOCATION OF PLANT, FITTINGS AND EQUIPMENT AND IT IS THE CONTRACTORS RESPONSIBILITY TO CO-ORDINATE THE INSTALLATION OF ALL SERVICES WITHIN ALL DISCIPLINES.
 - THE CONTRACTOR SHALL FULLY CO-ORDINATE ALL SERVICES ACCESS POSITIONS WITH OTHER TRADES AS REQUIRED.
 - THE CONTRACTOR SHALL FULLY CO-ORDINATE ALL SANITARY DRAINAGE SERVICES PIPEWORK AND EQUIPMENT WITH EXISTING SERVICES ALLOWING FOR ADEQUATE ACCESS FOR MAINTENANCE AND/OR REPLACEMENT.
 - ACCESS SHALL BE PROVIDED AT THE END OF EACH HORIZONTAL RUN AND EVERY CHANGE OF DIRECTION.
 - ACCESS DOOR SHALL BE PROVIDED TO ALL VERTICAL STACKS ON EACH FLOOR 1.2m ABOVE FINISHED FLOOR LEVEL. WHERE STUB STACKS ARE USED THEY SHALL BE PROVIDED WITH FULL BORE TOP ACCESS LOCATED ABOVE THE SPILL OVER LEVEL OF THE TOP MOST FITTING.
 - FALLS ON SOIL AND WASTE PIPE AND VENT PIPES SHALL NOT FALL BELOW THE MINIMUM STATED IN BS EN 12056 - 2 GRAVITY DRAINAGE INSIDE BUILDINGS.
 - WHERE CONDENSATE WASTE PIPEWORK CONNECTS TO SOIL STACKS THE USE OF WATERLESS TRAPS SUCH AS HEPWORTH'S "HEPVO" SHALL BE USED.
 - SWEPT LONG OR MEDIUM RADIUS 90° OR 45° BENDS SHALL BE USED. WHENEVER POSSIBLE. ALL JUNCTIONS SHALL BE 45°. THE USE OF KNUCKLE BENDS WILL NOT BE PERMITTED.
 - THE PUBLIC HEALTH SERVICES SANITARY DRAINAGE DESIGN AND INSTALLATION SHALL BE IN STRICT ACCORDANCE WITH BS. EN. 12056-2 AND BUILDING REGULATIONS APPROVED DOCUMENT H.
 - INTERNAL VERTICAL AND HORIZONTAL SOIL & WASTE STACKS AND STUB STACKS SHALL BE LIGHT WEIGHT CAST IRON WITH MECHANICAL JOINTS TO BS EN 877 AND BRANCH WASTE PIPEWORK SHALL BE UPVC AND MUPVC.
 - ALL CONCEALED RAINWATER AND SOIL AND VENT PIPEWORK THAT ARE INSTALLED HORIZONTALLY AND VERTICALLY WITHIN DUCTS, CEILING AND FLOOR VOIDS SHALL BE ACOUSTICALLY INSULATED WITH 1 LAYER OF LAGGING AS MANUFACTURED BY MUFILAG TYPE SP29 & 58/10 OR EQUAL AND APPROVED. THE PIPEWORK SHALL THEN BE PROVIDED WITH A INSULATION WRAP WITH VAPOUR SEAL.

- LEGEND
- SVP - SOIL VENT PIPE.
 - VP - VENT PIPE.
 - G - GULLY.
 - SHG - SHOWER FLOOR GULLY.
 - RWP - RAINWATER PIPE.
 - RWO - RAINWATER OUTLET.
 - F/A - FROM ABOVE.
 - T/B - TO BELOW.
 - AAV - AIR ADMITTANCE VALVE.
 - H/L - HIGH LEVEL.
 - M/L - MEDIUM LEVEL.
 - L/L - LOW LEVEL.
 - SS - STUB STACK/STUB WASTE PIPE.
 - CTD - CONNECT TO UNDERGROUND DRAIN.
 - CI - CAST IRON.
 - WC - WATER CLOSET.
 - PIPEWORK AT L/L & M/L.
 - - - PIPEWORK AT H/L.
 - PIPEWORK IN FLOOR VOIDS.

TENDER ISSUE

Revisions					Revisions					Revisions				
Rev.	Date	Description	CDM Chk'd	Chk'd	Rev.	Date	Description	CDM Chk'd	Chk'd	Rev.	Date	Description	CDM Chk'd	Chk'd
P1	MAR.23	ISSUED FOR COMMENT.	J.B	P.B										
T1	APR.23	ISSUED FOR TENDER.	J.B	P.B										

Project Consultants	
Architect	Quantity Surveyor
ARCHITECTURE FOR LONDON	
Structural Engineer	Project Manager

CAD Ref.	Originator
3206	SLENDER WINTER PARTNERSHIP LIMITED
Checked	Date
J.B	FEB.23
Drawn	Date
G.H	FEB.23
Scale	Project
1:50@A1	3 GAINSBOROUGH GARDENS
Revision	Drawing Title
T1	SECOND FLOOR ABOVE GROUND DRAINAGE SERVICES LAYOUT
	Drawing Number
	3206-PH102

THIS DRAWING IS THE COPYRIGHT OF SLENDER WINTER PARTNERSHIP LIMITED AND MUST NOT BE COPIED OR REPRODUCED IN ANY MANNER WITHOUT THE WRITTEN PERMISSION OF SLENDER WINTER PARTNERSHIP LIMITED.

THE COPYRIGHT DESIGN & PATENTS ACT 1988.
DO NOT SCALE. ALL DIMENSIONS TO BE CHECKED ON SITE.

swp
consulting engineers

Head Office: 2 Kings Hill Avenue, Kings Hill, West
Malling, Kent, ME19 4AQ.
T: 01959 564777 E: swp@swpltd.co.uk

SWP Limited. Registered Office: 2 Kings Hill Avenue, West
Malling, Kent, ME19 4AQ. Registered in England No 372841



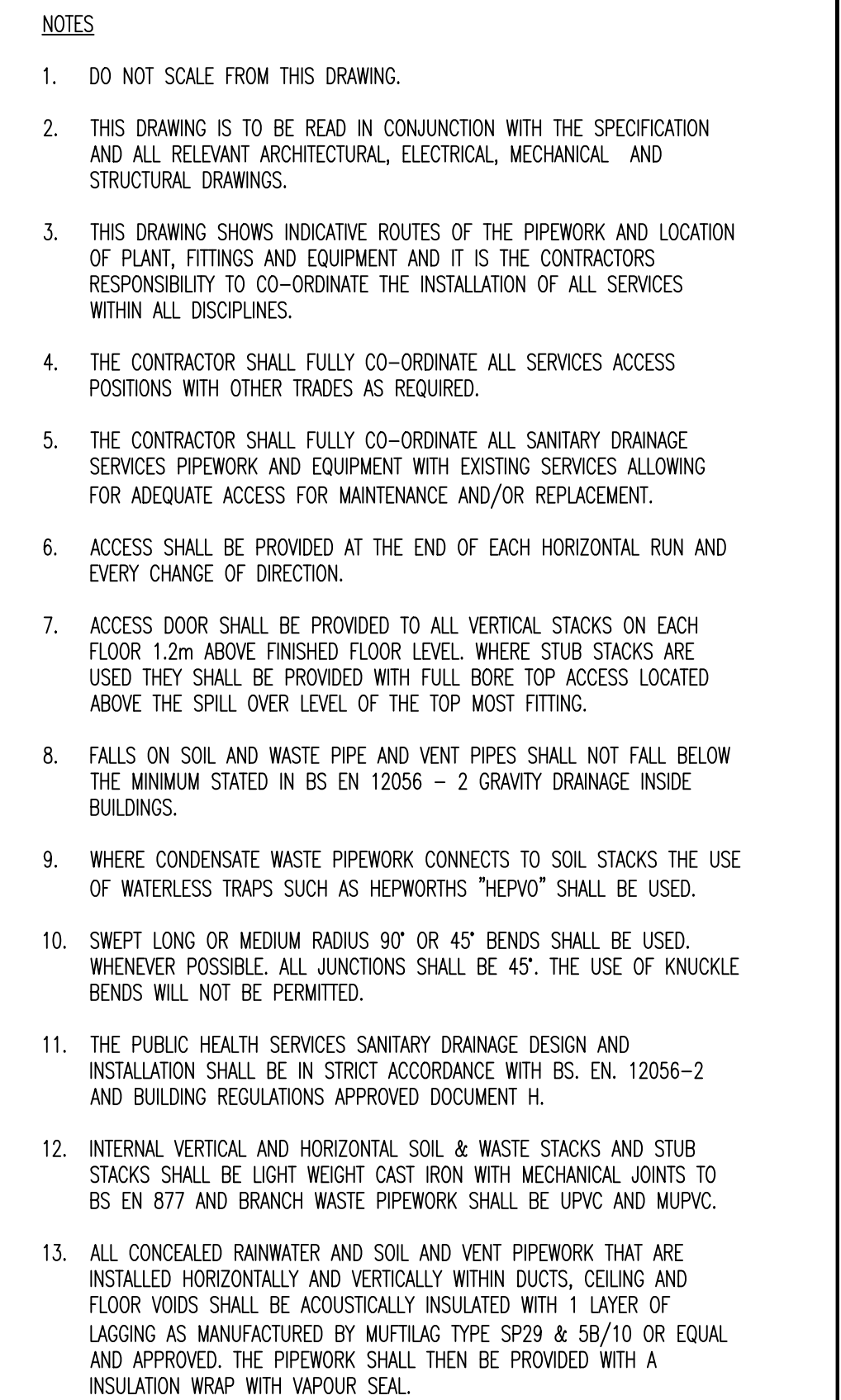

LEGEND

SVP — SOIL VENT PIPE.
VP — VENT PIPE.
G — GULLY.
SHG — SHOWER FLOOR GULLY.
RWP — RAINWATER PIPE.
RWO — RAINWATER OUTLET.
F/A — FROM ABOVE.
T/B — TO BELOW.
AAV — AIR ADMITTANCE VALVE.
H/L — HIGH LEVEL.
M/L — MEDIUM LEVEL.
L/L — LOW LEVEL.
SS — STUB STACK/STUB WASTE PIPE.
CTD — CONNECT TO UNDERGROUND DRAIN.
CI — CAST IRON.
WC — WATER CLOSET.
——— PIPEWORK AT L/L & M/L.
----- PIPEWORK AT H/L.
----- PIPEWORK IN FLOOR VOIDS.

TENDER ISSUE

Revisions					Revisions					Revisions					Project Consultants		CAD Ref.		Originator				
Rev.	Date	Description	CDM Chk'd	Chk'd	Rev.	Date	Description	CDM Chk'd	Chk'd	Rev.	Date	Description	CDM Chk'd	Chk'd									
P1	MAR.23	ISSUED FOR COMMENT.	J.B	P.B											Architect	Quantity Surveyor	3206	SLENDER WINTER PARTNERSHIP LIMITED					
T1	APR.23	ISSUED FOR TENDER.	J.B	P.B											ARCHITECTURE FOR LONDON		Checked J.B	Date FEB.23	Client				
															Structural Engineer	Project Manager	Drawn G.H	Date FEB.23	Project 3 GAINSBOROUGH GARDENS				
																	Scale 1:50@A1		Drawing Title THIRD FLOOR ABOVE GROUND DRAINAGE SERVICES LAYOUT				
																	Revision T1	Drawing Number 3206-PH103					
THE DRAWING IS THE COPYRIGHT OF SLENDER WINTER PARTNERSHIP LIMITED AND NOT BE COPIED OR REPRODUCED, IN WHOLE OR IN PART, BY ANY METHOD WHATSOEVER, WITHOUT PERMISSION OF THE FIRM WINTER ASSOCIATIONS OF SLENDER WINTER PARTNERSHIP LIMITED.										THE COPYRIGHT DESIGN & PATENTS ACT 1988 DO NOT SCALE. ALL DIMENSIONS TO BE CHECKED ON SITE.													

swpltd

consulting engineers

Head Office: 2 Kings Hill Avenue, Kings Hill, West
Malling, Kent, ME19 4AG
T: 01959 564777 E: swp@swpltd.co.uk

ISO 14001

REGISTERED FIRM

ace

Engineering & Building Services

UKAS

18001

2015

UKAS

27001

2017

SMP Limited, Registered Office: 2 Kings Hill Avenue, West
Malling, Kent, ME19 4AG, Registered in England No 3735841