

**Simon Pryce Arboriculture**

30 Woodfield Road,  
 Radlett,  
 Herts,  
 WD7 8JD  
 01923 467600  
 07710 224906  
[info@simonpryce.co.uk](mailto:info@simonpryce.co.uk)  
[www.simonpryce.co.uk](http://www.simonpryce.co.uk)

Client:  
 Mr Carlo Pirri

Site:  
 14 Oakeshott Avenue, London,  
 N6 6NS

Title:  
 Tree survey, existing site

Date:  
 13 June 2023

Ref:  
 23/034

Scale:  
 1:200 at A3

Original drawing:  
 Emily Greeves Architects

Rev:

Root protection areas [RPAs] are colour coded according to retention category from BS5837:2012. Trees in relation to design, demolition and construction:

- A = green
- B = blue
- C = grey
- U = red - dashed - also used to denote dead trees with no RPA
- Tree protection = mid blue
- Crown spreads = mid green

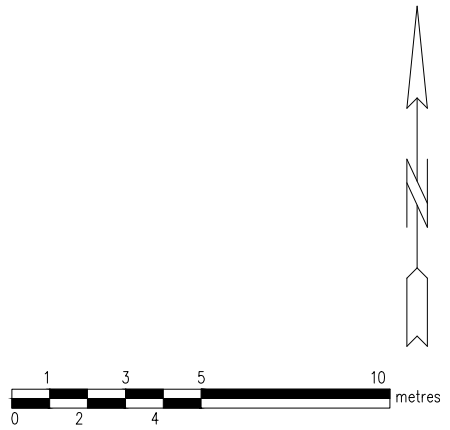

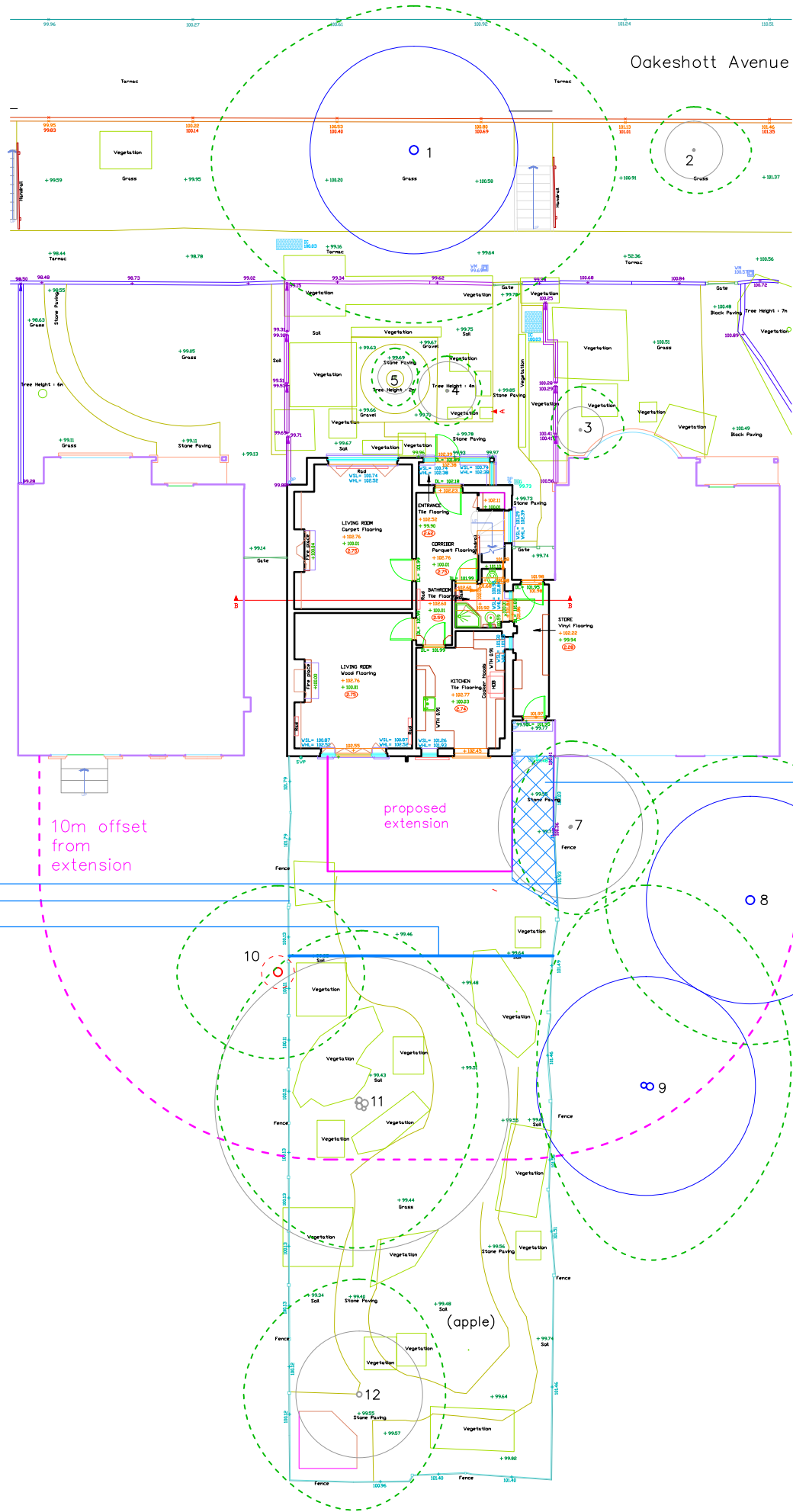

boundary fences protect trees in adjacent gardens  
tree protection fence across garden

retain stone paving to protect roots beneath during the work

10m offset from extension

proposed extension

**Simon Pryce Arboriculture**

30 Woodfield Road,  
Radlett,  
Herts,  
WD7 8JD  
01923 467600  
07710 224906  
info@simonpryce.co.uk  
www.simonpryce.co.uk

Client:  
Mr Carlo Pirri

Site:  
14 Oakeshott Avenue, London,  
N6 6NS

Title:  
Proposed extension - tree protection  
plan (TPP)

Date:  
13 June 2023

Ref:  
23/034

Rev:

Scale:  
1:200 at A3

Original drawing:  
Emily Greeves Architects

Root protection areas [RPAs] are colour coded according to retention category from BS5837:2012. Trees in relation to design, demolition and construction:

- A = green
- B = blue
- C = grey
- U = red - dashed - also used to denote dead trees with no RPA
- Tree protection = mid blue
- Crown spreads = mid green

