

Notes:

Window references identify windows to be replaced as proposed.

North West and North East Elevations

Existing timber windows will be replaced with timber windows like for like but double-glazed.

The design of the new windows matches in all details the existing windows; in size, materials, positions, colour, opening arrangements and mouldings.

The windows will be an exact replica of the existing windows externally so there will be no difference to the elevation.

Internal courtyard elevations

As above all windows will be replaced with timber windows like for like but double-glazed.

In additions:

Existing glazing mounted ventilation fans will be removed.

Lower sash of SW05 will change from textured to obscured glazing.

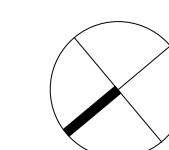
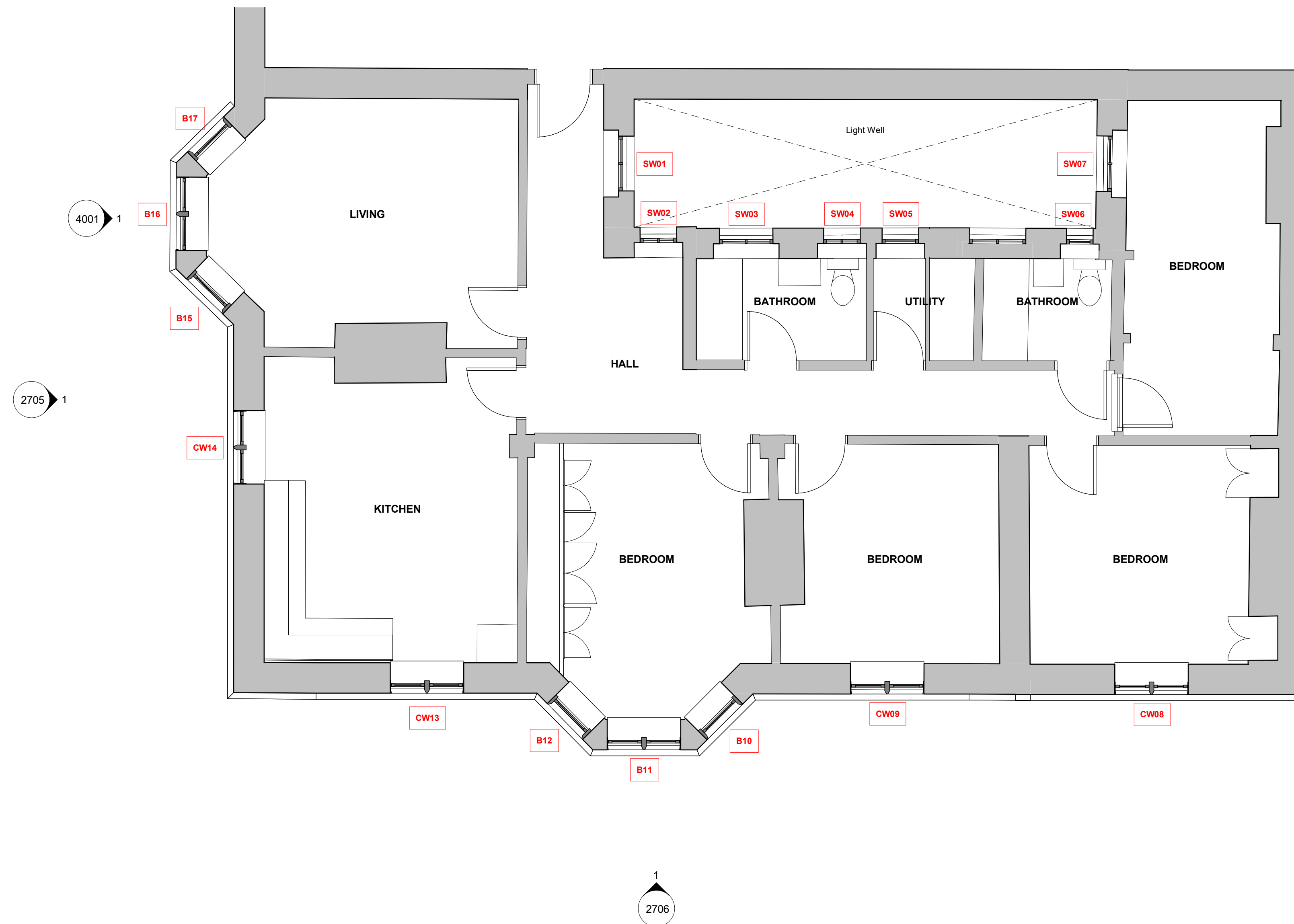

VISUAL SCALE 1:50

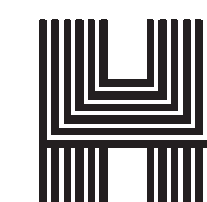

Haverstock LLP tel+44 (0)20 7267 7676
 Studio 10, Cliff Road Studios info@haverstock.com
 Cliff Road, London NW1 9AN www.haverstock.com

Client:
Mr and Mrs Walters

Job Title:
The Pryors Flat 7

Drawing Title:
Existing Floor Plan

Job/ Dwg No/ Rev:
1267 -HAV -01 -01 -D -A - 1002 P.1

Drawn:	Checked:	Appr:	Date:
Author	Checker	Approver	28/06/23

Drawing Status:
 Do not scale from this drawing. Check all dimensions on site before ordering. Scale(s):
 As indicated @ A1