

Proposed location of 2 storey Portakabin Building.

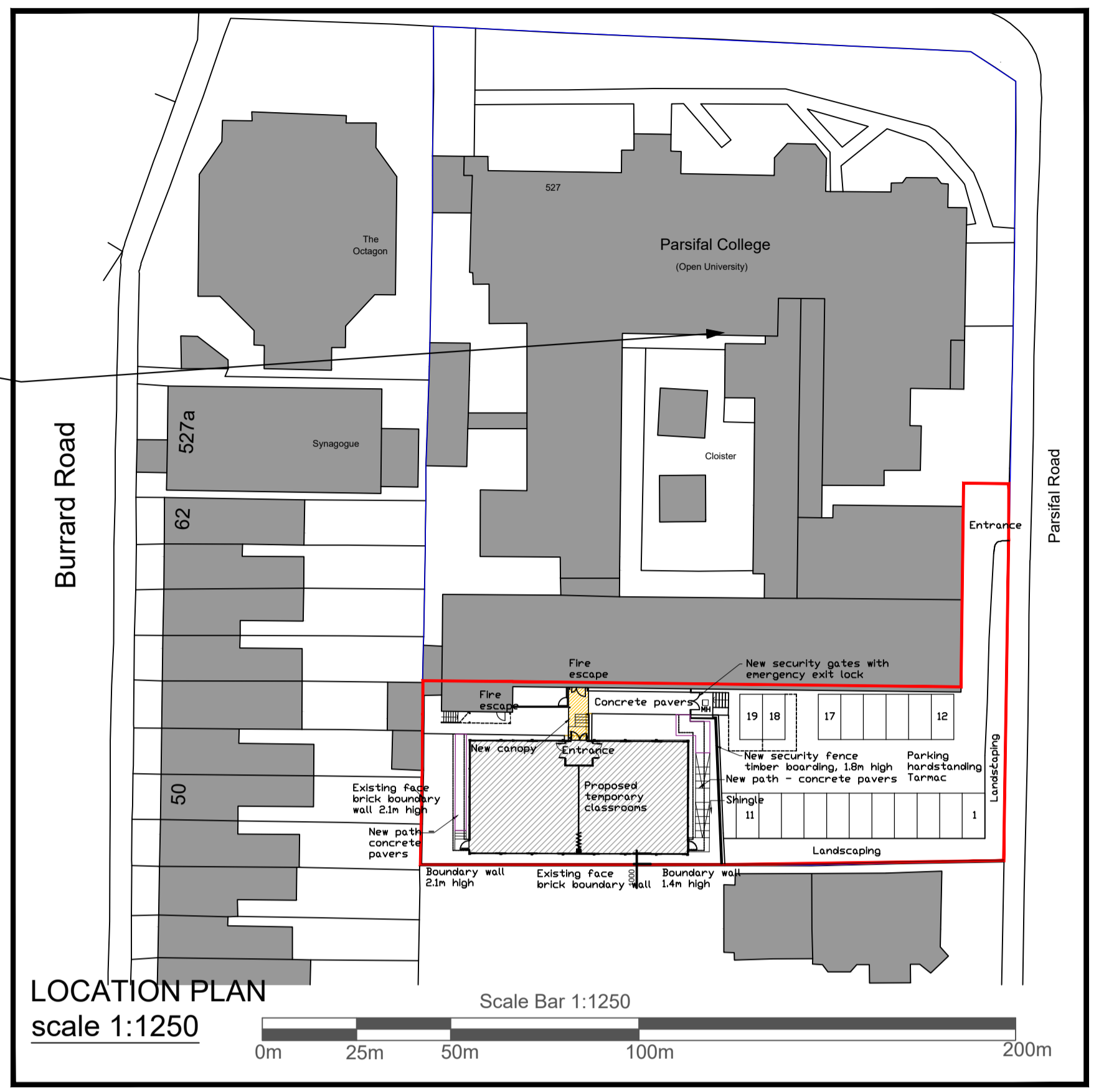

LOCATION PLAN scale 1:1250

Scale Bar 1:1250

© Crown Copyright 2006
 Reproduction in whole or in part is prohibited without the prior permission of Ordnance Survey.



BLOCK PLAN scale 1:200

Scale Bar (1:200)



Title
Proposed Site Plan

Proposed Temporary Classrooms for ESCP Europe Business School at 527 Finchley Road, London NW3 7BG Existing Site Plan

Date: 26th June 2023
 Scale : 1:200 @ A1
 Drawing Number TSLPP235-PL02 Rev B

NOTES:
 - Site plan is based on existing Ordnance Survey information
 - Responsibility is not accepted for errors made by others in scaling from this drawing. Contractors must check all dimensions on site. Discrepancies must be reported to the drawing owner before proceeding.

KEY:
 - Application Boundary
 - Area owned by client but not in application
 - Previous pathway annotation
 - Proposed pathway annotation

| Rev. | Date | Notes |
|------|------|-------|
| | | |
| | | |
| | | |
| | | |

Portakabin Limited 2000
 This drawing is the property of Portakabin Limited, it must not be copied or reproduced or divulged to anyone without written permission.