

BILLY FURY WAY

11 BLACKBURN ROAD

STUDENT LIVING

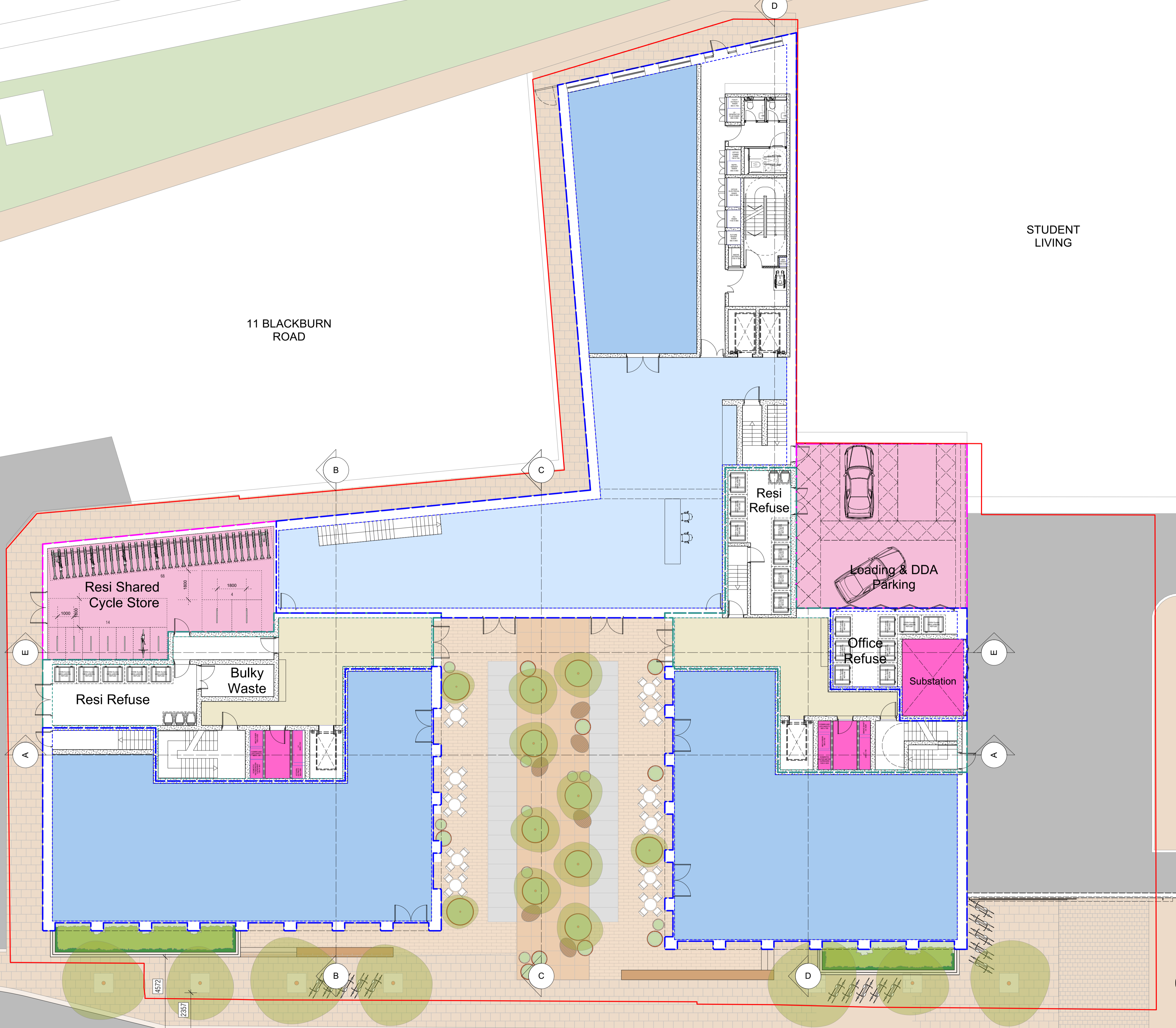

1 GROUND FLOOR – PROPOSED
Scale: 1:125

GENERAL NOTES:
Do not scale from this drawing.
Check drawing on receipt and immediately report any discrepancies to the Architect.
Verify all dimensions and levels on site prior to construction.
The contents of this drawing are Stiff + Trevillion Architects Ltd copyright and shall not be re-used without their written permission.

Revisions		
Rev	Date	Note
2C	17/05/2023	Windows and gate added to Building C North elevation

Approved

Key Plan

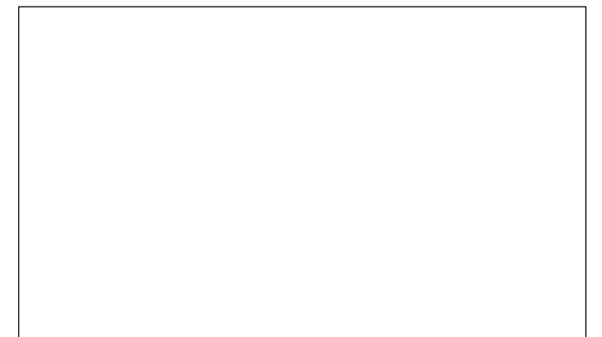

Stiff + Trevillion

Stiff + Trevillion Architects Ltd
16 Woodfield Road
London W9 2BE

T +44(0)20 8960 5550
mail@stiffandtrevillion.com
www.stiffandtrevillion.com

Client GP

Project No. 4153
Project BLACKBURN ROAD NW6 1RZ

Drawing Title
GROUND FLOOR PLAN PROPOSED

Drawing Status STAGE 2

Date JUNE 2020
Scale @ A1 1:125
Scale @ A3 1:250

Drawing No.
ST-PR-02-100

Revision 2C

