

S1113-J1-R-1

# REPORT

regarding the impact on trees of proposals for development at  
99 King Henry's Road, London, NW3 3QX

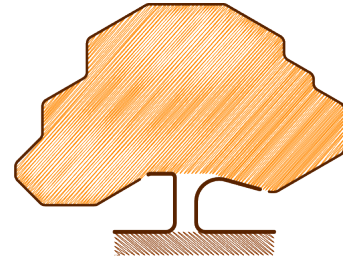

JOHN CROMAR'S  
ARBORICULTURAL  
COMPANY LTD

[www.treescan.co.uk](http://www.treescan.co.uk)  
[admin@treescan.co.uk](mailto:admin@treescan.co.uk)

01582 808020  
07860453072



*View of rear of site; from the north north-west*

John Cromar, Dip. Arb. (RFS), F. Arbor A.



## Contents

1	Instructions.....	1
2	Executive summary.....	1
3	Introduction.....	1
4	Observations.....	3
5	Arboricultural impact assessment (AIA).....	6
6	Conclusion .....	8
7	Sources and relevant documents used.....	8
8	Copyright .....	9
9	Arboricultural method statement (AMS) .....	9
10	Plans .....	19

# 1 Instructions

I am instructed Jeremy Wight of Brod Wight Architects on behalf of clients to make an assessment of tree amenity value and condition of trees at 99 King Henry's Road, London, NW3 3QX and of the impact of a proposal for development (a garden studio) on such trees, and to supply an arboricultural methods statement and tree protection plan for use in supporting an application for local planning authority (LPA below) consent. The design and access statement / design summary submitted by Brod Wight Architects describes the scheme.

## 2 Executive summary

The impact on public amenity connected to how trees will be affected by the scheme is found to be negligible.

The scheme will require one tree to be removed. Tree planting (proposed indicatively) will mitigate its loss.

All retained trees will be easily protected from harm during the project.

## 3 Introduction

### 3.1 The environmental role of Local Planning Authorities

LPAs play an important part in the almost continual balancing act that is part and parcel of contemporary democratic government. They regulate development in the interests of the community. Increasingly, the environment plays a role in our lives, and strongly affects our health, both mental and physical. This is typically recognised in planning policy determined by LPAs, and the formal planning guidance published by them. LPAs process planning applications in line with this policy and guidance.

### 3.2 British Standards

These continue to play a significant role in the quality of our lives in the UK, by defining minimum standards for many products, and making recommendations where precise, exhaustive specifications are not absolutely possible, for example with services.

### 3.3 British Standard 5837:2012 'Trees in relation to design, demolition and construction - Recommendations'

BS 5837:2012 (the Standard, below) is the fourth version in a series, the first being in 1980. This Standard provides a framework for the valuation, in ornamental terms, of trees, and gives recommendations for their protection on building sites.

### 3.4 How the Standard is used by an arboriculturist

It is used as a tool by an arboriculturist, who for the purposes of this type of professional activity, is someone who has, through relevant education, training and experience, gained expertise in the field of trees in relation to construction. This is the profession which is concerned, in a wider sense, with the care and cultivation of trees for amenity (all the benefits). An arboriculturist, then, uses the Standard:

- a) to assess the value, in terms of amenity, of the trees on and adjoining a particular site, whether such trees are formally protected or not, for example by reason of being in a

Conservation Area or because they are scheduled within a Tree Preservation Order. (Both of these provisions are part of the Town and Country Planning Act 1990, part VIII.);

- b) secondly, to help assess the impact upon the trees of the proposal for development;
- c) lastly, to give ways of protecting retained trees during construction, should the proposal receive planning consent.

### 3.5 How the arboriculturist prepares tree protection methods

In practice, as advances in materials and techniques are rapid, the arboriculturist does not necessarily specify a precise commercial product, but defines the essential components of methods of demolition and construction which often make use of specialized materials. These may be termed 'tree-friendly' methods, meaning that they have as their focus the well-being of the tree. These appear on the tree protection plan(s) appended, typically titled: 'Tree Retention and Tree Protection Measures', and within the text below.

### 3.6 Classification of trees

The Standard recommends a way of classifying trees when assessing their potential value in relation to proposed development. Value means (mainly) *visual* value to the general public. It also allows for other values to be considered such as historic or conservation value. Some surveys may not find any trees of one or more categories.

Table 1 describes, as: 'U', a low-value tree; denoted by a **dark red** outline on plans, the shape of the edge of the tree's crown typically more or less concentric to the trunk position.

It also shows 'A', 'B' and 'C', in descending merit:

- 'A' category, **green** crown outline, are trees of high vitality or good form, or of particular visual importance.
- 'B' category, **blue** crown outline, are good trees but may be of slightly poorer form or be not sited as importantly as 'A' category trees.
- 'C' category, **grey** crown outline are trees of no particular merit, but in adequate condition for retention.

A minimum expected safe useful life is also assessed. Please note that a low value tree may have a very long life expectancy. The two factors are only linked in that, for example, a very high value tree cannot also have a very low life expectancy.

### 3.7 Root protection area

'RPA' below. The RPA is a zone around the trunk of the tree, in which protective measures must be used in order to prevent significant damage to trees.

### 3.8 Use of appended plans

The appended plans have different applications:

- Plan reference no. S1113-J1-P1, shows the spread of the crowns (the upper, leaf-bearing part of trees), and is intended to indicate the relationship of any neighbouring trees to each other. This plan gives a quick reference assessment of value as per section 4, table 1, page 9 of the Standard.
- S1113-J1-P2 is the 'tree protection plan' (TPP) referred to in the Standard (section 3.11). It is colour-coded to indicate where tree-friendly methods are proposed during the overall construction process, which may involve demolition, main construction and landscaping phases.

## 4 Observations

### 4.1 Site visit

I visited the property on 18th May 2023 in order to carry out an inspection. Weather conditions were good; they permitted adequate inspection.

### 4.2 Survey method

I used a tree mallet, spade, diameter tape, laser rangefinder, pocket retractable tape, binoculars, scaling pole, tree data recording software, pen, pencil and paper. No trees were climbed: inspection was from ground level.

### 4.3 Appraisal identification

My appraisals of observations, discussions and other data are italicised below, in each relevant section and paragraph. This emphasises the clear separation between data and opinion to assist the end-users: client, architect and LPA case and tree officers.

### 4.4 Amenity / Screening by trees and shrubs

The trees in the cohort are not readily visible from any truly public viewpoint, by reason of the massing of built form. One or two are partially visible as glimpse features between nos. 97 and 99 King Henry's Road.

*Certain trees are of considerable strictly local amenity value to owners / users of the site, and to those of adjoining properties. (See cover photo / photos below).*

### 4.5 Statutory constraints

The site is in the administrative area of London Borough of Camden.

The site stands within the Elsworthy Conservation Area.

No information on TPOs is available on the local authority website.

### 4.6 Soil assessment

The British Geological Survey (BGS) information for the area indicates that the underlying sub-soil is London Clay Formation - Clay, silt and sand.

*Topsoil within the site appears to derive from the underlying subsoil. I saw no evidence of soil-stripping, trenching, or level-alteration in the recent past, nor did I observe any apparent compaction or drainage problems.*

### 4.7 Measurements on site

Tree heights estimated by scaling pole.

Tree diameters measured as per the Standard, Annex C.

Tree spreads on the plans below are approximately to scale, determined on site, typically by laser rangefinder, direct measurement, pacing, sighting in relation to site features and architect-supplied plan data.

### 4.8 Tree data table

This is the core of the report in terms of site observations. In all cases, in the absence of negative comment below on health/vitality and structure of trees, normal physiological condition (health) and structural condition applies. Unless stated otherwise, 'tap tests' on the

trunk-bases, etc., for the sonority typically associated with decay in trees were found to be normal. Unless stated otherwise, no signs of protected species were noted; for example, potential bat roost features (PRFs below). Where no height to lowest branch figure is given, the information appears completely irrelevant to planning determination. The matter of clearance above ground level is discussed under the individual tree entries if this is relevant to planning determination. (For information on other data in the columns, see section 3 above.)

Tree number	Tree type	Height (m)	Stem diameters (mm)	Radius of RPA if circle (mm)	RPA (m <sup>2</sup> )	Comments	Life expectancy (years)	Assessed BS5837 value category
1	sycamore	16	825*	9900	307.9	Outside the site. <i>Ganoderma</i> spp. noted at base. This genera of decay fungi typically cause significant decay in the <i>Acer</i> genera of tree. Notify owners. *Estimated. <b>Cannot reasonably be considered a significant constraint on development near it.</b>	10+	C1
2	common holly	6	100	1200	4.5	Very little contribution to the screen, dominated by 3	40+	C1
3	English yew	9	265	3180	31.8	Important low level contribution to screen between site and adjoining properties to the rear.	40+	B1
4	common lime	16	550	6600	136.8	Outside the site. Rather poor form but makes some contribution to general screen; rather sparse in the crown	20+	C1
5	common holly	10	250	3000	28.3	Outside the site; thin in the crown	10+	C1
6	English yew	3	<70, <70, <70, <70	1680	8.9	Shrubby	40+	C1

## 4.9 Photos

Note on photo labelling- the colour of the numeral identifying trees matches that used for the four BS 5837:2012 tree value categories (see 3.6 above)



## 5 Arboricultural impact assessment (AIA)

### 5.1 RPAs – modifications to shape

I carried out an assessment as per the Standard (section 4.6.2) in connection with the plotting of the RPAs of all trees. This section requires that site conditions such as the locations of various structures, the internal support mechanisms of various trees, etc., are taken into account in determining the likely position of roots. Adjoining structures and features have been noted in this respect. Where applicable, the modified-shape RPA, of equivalent area, has been plotted on the plans appended (shown as shapes bounded by an orange line). The subsoil is likely to be clay, a shrinkable medium.

*This factor is of little overall relevance in connection with this site. Adjoining structures have likely affected the RPAs, as indicated on plans. The shapes of the root systems of trees have probably not been unusually affected by subsoil type. The factors above have some significance in connection with proposed tree protection, and are reflected in the TPP provided.*

### 5.2 Roots and the design

It is usual for discussions between the arboriculturist and architect to take place at an early stage following the arboriculturist's site survey. Modifications, minor or major, to the proposals as first received are typically discussed, with a view to promoting tree retention and health. I discussed with the architect certain features of the scheme in this case. The outcome of these discussions (final positioning of the proposed building) is incorporated in the proposal considered here.

### 5.3 The static root plate (SRP) compared with RPA

SRP is an abbreviation for static root plate, (Mattheck, 1991, etc.) and means the structurally significant roots nearest the trunk: the principal roots that hold the tree upright. This is derived from a radial dimension based on trunk diameter near ground level. The RPA is a guide to where physiologically significant roots, those necessary for, primarily, water uptake, are likely to be located.

### 5.4 Assessment of SRP/RPA encroachment by dwelling/structure footprint

Some encroachment on the SRP of one retained tree (1) is entailed. Minor encroachment on the RPA of three retained trees is entailed, as analysed in the table below:

Tree no.	Tree	RPA area (m <sup>2</sup> )	Area affected (m <sup>2</sup> )	% affected	Notes
1	sycamore	307.91	21.00	6.82%	proposed structure
1	sycamore (SRP)	30.19	1.29	4.27%	SRP proposed structure
3	English yew	31.77	2.35	7.40%	proposed structure
6	English yew	8.87	0.70	7.89%	proposed drainage channel + paving

*In view of the above I conclude that special footings are needed from the arboricultural perspective. In this case all trees to be retained can be adequately protected by exclusion fencing and tree-friendly methods as proposed below to reduce impacts on root systems of retained trees.*

### 5.5 Assessment of suspended encroachment

Some superficial change to the RPA around various trees is proposed. The matter of above-surface-only installation in RPAs requires careful consideration. The Standard currently (in



section 7.4.2.3) restricts permanent hard surfacing of any existing unsurfaced ground within the RPA of trees to be retained to 20% of the unsurfaced portion of the RPA. This would be somewhat obviously a far greater intervention than here proposed. This percentage stipulation is, in any case, unfortunately, quite arbitrary, and is not supported by any published research. It is necessary to draw on the now-considerable body of professional experience in this matter. The proposals (see Methods below) entail a suspended structure only.

*As the changes do not involve root cutting, and materials and methods promoting root retention and respiration are specified below, I see no basis to conclude that the trees will suffer harm, if these methods are followed carefully.*

## **5.6 Perception of trees by building users**

The proposed garden building / structure is not continuously habited.

*In view of the above I conclude that shading by and perception of trees have been considered (as the Standard (sections 5.3.4 and 5.6.2.6) recommends) and appear not to be negative factors.*

## **5.7 Superstructure and tree appraisal – tree pruning**

In accordance with the Standard, section 4.4.2.5 (f), I note from the drawings supplied that no significant encroachment by the superstructure on the crowns of retained trees will occur. I noted that the form of tree 3 is such that only minor branches require pruning. If this is in accordance with the schedule, it will have no significant effect on the form or public amenity value of the tree. No alteration in plan of the tree's spread is entailed.

*It is in my view not of significant general amenity value, although it is locally ornamental and functions to provide some softening of the structure. It will in my view continued to do so after the proposed pruning. The species involved responds well to pruning. The pruning required can easily be addressed by tree surgery in accordance with the Standard (section 5.3.4 (c) NOTE 2, section 7.7.3, etc.), and is within the bounds of good arboricultural practice.*

(See British Standard 3998:2010 'Tree work – Recommendations'.) A schedule for the use of a contractor appears within the AMS below.

## **5.8 Access clearance**

*I note from my site visit and the plans received that no retained tree conflicts with pedestrians, construction traffic, nor end-user vehicles.*

## **5.9 Tree removal considerations in the Standard**

In conserving trees on development sites, expected best practice is as in the Standard (section 5.1.1):

*“Certain trees are of such importance and sensitivity as to be major constraints on development or to justify its substantial modification: attempts to retain too many or unsuitable trees on a site can result in excessive pressure on the trees during demolition or construction work, or post-completion demands for their removal.”*

Thus, implicit in the process are decisions about tree removal. This is often perfectly reasonable and provides space for new trees. One tree is proposed removed.

*The above advice appears to have been considered in formulating proposals for development in this case.*

## 5.10 Replacement planting – mitigation for proposed tree loss

Please see tree data table above for comments on the single tree proposed for removal.

See plan S1113-J1-P2 for the location of proposed planting:

A = Mediterranean crab apple (*Malus trilobata*) 10-12cm girth 35L pot.

*The soil type indicated by BGS data and soil condition as appraised places no significant constraint on species selection for tree and other planting. Overall, appropriate replacement tree planting will play a minor role in providing for future local amenity.*

## 5.11 Policy compliance

The LPA website was searched for relevant policy documents and supplementary planning documents (SPDs). I am aware of

Camden Local Plan 2017

Camden Planning Guidance (Trees)

Conservation Areas

It is of course ultimately for planners to determine compliance with planning policy.

*I submit that the proposals in this report, encompassing tree protection methods in accordance with the principles of British Standard 5837:2012, and new planting, will, if implemented, facilitate fair compliance with relevant policies relating to trees.*

# 6 Conclusion

## 6.1 Summary

I conclude that the impact by the scheme proposed on the amenity provided by trees, subject to implementation of the arboricultural method statement's contents, will, overall be negligible.

## 6.2 Note to LPA

I invite the LPA to consider, if it is minded to grant consent, the incorporation of the specific *order of implementation* of the **Arboricultural method statement** below into any Conditions applied. Such measures are likely to maximise tree protection. Finalised details of tree-handling on site during construction is typically a matter requiring the input of a main contractor within CDM regulations, and these matters in practice almost always follow planning consent, as it is typical for no contractor to have been appointed prior. The writer is willing to prepare a Construction Issue version of the AMS in due course.

# 7 Sources and relevant documents used

- Ground-level inspection
- Supplied plans:
  - Twickenham Surveys Ltd. drg. no.: 1133-S01
  - Brod Wight Architects drg. no.: 1133-AP01

## 8 Copyright

Copyright of the report above is retained by the writer. It is a report for the sole use of the client(s) named above. It and associated plans may be copied and used by the client and the LPA in connection with the above instruction only. Its reproduction or use in whole or in part by anyone else without the written consent of the writer is expressly forbidden. The AMS below, including schedule of tree work and the plan or plans, may be reproduced to contractors for the purpose of tendering, and for setting out and maintaining tree protection measures on site.

## 9 Arboricultural method statement (AMS)

### 9.1 Overview

The methods required involve not only physical arrangements on site but effective administration prior to implementation. Trees that have been the recipients of careful handling during construction add considerably to the appeal and value of the finished development. If conflicts between any part of a tree and the building(s) arise in the course of building works these can often be resolved quickly and at little cost if an arboriculturist is consulted promptly. Lack of such care is often apparent quickly and decline and death of such trees can wreck design aims. It can of course also affect saleability, and reflects poorly on the construction and design personnel involved.

I propose that arboricultural administration takes place as outlined below. Needless to state the MC must fully comply with these proposals for them to be effective. This involves proper initial contact with the retained arboricultural consultant, followed by persisting contact, throughout the contract, until at least late landscaping stage.

### 9.2 Administration

#### A. Identification of key personnel in order of responsibility for tree protection on site

Role	Name	Company	E-mail	Mobile	Landline
site manager	TBC	TBC	TBC	TBC	TBC
main contractor	TBC	TBC	TBC	TBC	TBC
architect	Brod Wight Architects	Jeremy Wight	office@brodwight.co.uk	020 7722 0810	07973 324534
arboriculturist	John Cromar	John Cromar's Arboricultural Co. Ltd.	johncromar@treescan.co.uk	07860 453072	01582 808020

#### B. Induction and personnel awareness of arboricultural matters

Prior to commencement a meeting will be held on site between the arboriculturist and the site manager (who will be required to sign the awareness document 9.4 below) and during which meeting all the tree protection methods, materials, order and integration with the build programme will be considered. This document, confirming awareness on the part of personnel of the various items, will be retained for the LPA.

C. Inspection of and supervision schedule for tree protection measures, frequency and methods of site visiting and record keeping

At site possession, the tree protection measures applicable to the works, as detailed in this report will be inspected by the arboriculturist and signed off if compliant. An initial inspection will take place; a monthly inspection will take place routinely; unannounced site inspections may also be carried out. Additionally, the arboriculturist shall attend site as required by architect, or site agent, or the LPA. *All reports on site visits to be copied to the LPA within 5 days of site visit.* These reports to be compiled, and an end of project summary produced, together with any recommendations for future action.

D. Procedures for dealing with variations and incidents

As C above. Additionally, the architect shall inform the arboriculturist of any design variations or variation intention of tree protection; also, the site manager shall inform the arboriculturist if he intends to vary or deviate from the agreed tree protection methods or timing. Action in response to incidents will be commensurate with and appropriate to the nature of any such incident.

E. The order of work on the site, including demolition, clearance and building

As per tree protection methods below.

F. How problems will be reported and solved

Any breaches of tree protection measures shall constitute a Tree-Related Incident ('TRI'), a report on which will be copied to architect, client and LPA. A remedial action notice will be served by the arboriculturist and copied to all parties. Timescales for remediation completion shall be monitored. *All reports on site visits will be copied to the LPA within 5 days of site visit.* Action in response to incidents will be commensurate with and appropriate to the nature of any such incident. Any breach of the stipulated timescale for remediation will trigger a further TRI report.

G. How accidents and emergencies involving trees will be dealt with

Dependent on nature of incident; as above; an e-mail with photographic inclusion will be sent by the site agent. The arboriculturist or staff will attend site to appraise the situation and determine remedial action. A TRI report will be issued, as above.

### 9.3 Implementation on site

It is proposed that the methods specified below are followed in their entirety. Please note that the methods are referenced by various colours, lines and hatches on the tree protection plans appended. The scale of the plans is dependent on the paper size on which any hardcopy is produced.

It is highly important to tree health and vitality that construction activities are carried out strictly in accordance with the tree-friendly construction methods below. It is widely not understood outside the arboricultural profession, for example, that a single traverse of a root protection area by a mechanical excavator can cause significant and permanent damage to trees, even if this is not visible immediately afterward.

N.b. The methods below are intended to be read not only by the instructing client, but also by all others concerned with processing and determining of the application. Following planning

approval, the methods are finally intended for full implementation on site by the main contractor or in some cases by a DIY builder. A degree of familiarity with the language of basic building techniques is assumed. I will of course explain any unfamiliar term – see contact details on cover page, and at the end of the report.

## 9.4 Tree-friendly construction methods and awareness document

Section 9.4 including all the methods below should be printed out; the plans to full scale, and kept readily to hand on site. (To be read and duly completed:) I the undersigned builder / site agent / main contractor have been given a copy of the tree protection measures reproduced below and the plans S1113-J1-P1 v1 and S1113-J1-P2 v1, with which they are to be read. I have studied these tree protection measures on site with the arboriculturist. I have asked questions if I have been unsure about the practicability or safety of any measure. Any queries arising have been resolved. I see no reason why the tree protection measures should not be implemented as outlined below and undertake to take all reasonable steps within my remit to promote their installation and retention for the duration required, as outlined below.

There are 11no. methods in this set, to be implemented in the order given unless stated otherwise.

### PREPARATION / DEMOLITION

Please read with tree protection plan, S1113-J1 P2, appended.

**Method 1: SCHEDULE OF TREE WORK (Aim of method: to ensure only appropriate tree work is carried out)** Tree work shall be in accordance with the schedule below, and to BS 3998:2010 'Tree Work - Recommendations'. Heights are in metres; diameters are in millimetres.

Tree number	Tree type	Height (m)	Stem diameters (mm)	Comments
2	common holly	6	100	Remove; grub out.
3	English yew	9	265	Prune to clear 3m above ground level in the zone indicated by pale blue outline only.

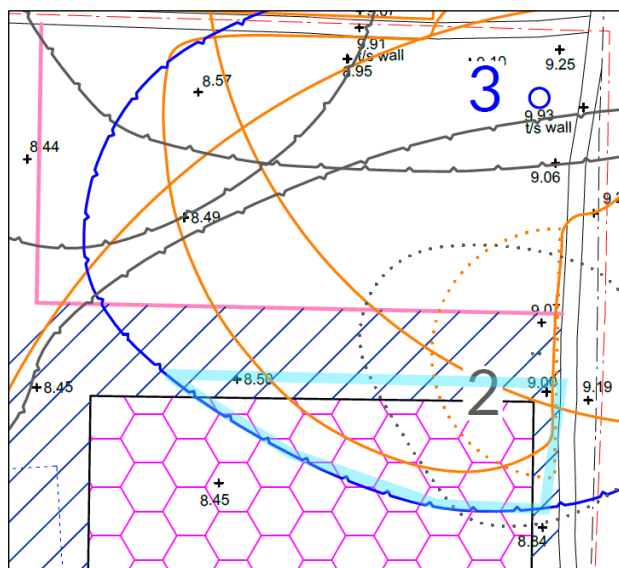

#### NOTES:

- In Conservation Areas, in accordance with TCP Act 1990 Section 211, a formal notification to the LPA is required of intention to prune or remove any trees, the removal of which is not strictly required for the construction proposed to take place. 42 days after formal notification should be allowed before proceeding with the notified work, during which time (and after) the LPA may place a Tree Preservation Order (TPO) on the tree, thus requiring a formal application for any works to living wood.

- If a tree is the subject of a TPO a formal application must be made to the LPA for consent for any work to the living wood of trees, if that work is not strictly required for the construction proposed to take place.
- All tree work should be carried out to BS 3998:2010 'Tree Work - Recommendations'.
- The Wildlife and Countryside Act 1981 protects with certain exceptions all birds and their nests. It is an offence to destroy such nests or take or injure such birds in the course of tree works operations.
- If a tree is a bat-roost, a licence to work on the tree must first be obtained from the relevant Statutory Nature Conservation Organization (in England: Natural England 0845 601 4523.) Acting without a licence is likely to be justifiable only in acute emergencies threatening human life and where all other legally available option such as footpath diversion, fencing and warning signs cannot be applied.

Arisings shall be chipped and removed from site, or stockpiled outside RPAs for possible later use as mulch at landscape phase. No vehicles shall stand or operate in any of the RPAs of retained trees. Any traversing of RPAs shall be preceded by laying of temporary trackway, such as TuffTrak® Euromat ground guards or similar appropriate temporary trackway sections. The temporary trackways shall be fixed together with manufacturers' approved fixings. This protective layer shall stay in place throughout arboricultural site preparation phase.

**Method 2: TREE PROTECTION FENCING (Aim of method: to provide protection for trunks, branches and roots during demolition operations and construction)**

Tree protection fencing shall be erected, consisting of 'Heras' type fencing (weld-mesh panels), each section securely attached to uprights driven at least 0.6m into ground, as per the layout as shown on the plan (pink lines). No ground levels reduction or excavation shall take place within (=the tree side of) the fence lines. The standard rubber supports ('elephant's feet') shall if used, be as per BS 5837:2012 section 6.2.2, figure 3, below; that is, pinned to the substrate with re-bar.

Below the crowns of trees with branches extending to less than 2m above ground level, in order to avoid unnecessary pruning, it is permissible to replace sections with manufactured boards at least 11mm thick (hoarding), attached securely to timber uprights driven at least 0.6m into the ground, providing the finished fence stands at least 1.5m above ground level.

Where required to infill odd sections, tree protection fencing may be varied to >1.8m high hoarding of >11mm thick manufactured board and timber uprights >50mm x 100mm, no part of any of which is to be attached to any tree.

No fires shall be made on any part of the site, or within 20m of any tree to be retained. No storage of materials shall be made within the protective fences. No

Figure 3 Examples of above-ground stabilizing systems

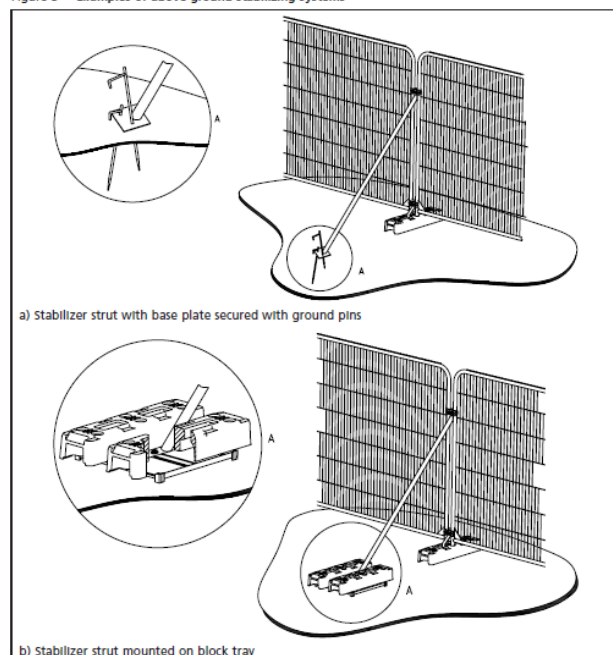

Figure 1 BS 5837:2012 section 6, figure 3

breaching or moving of the protective fences shall take place without the approval of an arboriculturist.

**Method 3: GROUND SURFACE HANDLING and PROTECTION (Aim of method: to provide protection for roots during demolition operations and construction)**

This method shall apply in the zones hatched blue on plan. NO levels reduction shall take place. This includes no 'scraping up' with a mechanical excavator or otherwise. Any existing hard surfacing, any existing surface debris, light vegetation, etc., that lies within the zone shall be removed using hand tools only. A 2D geotextile membrane, such as 'Ekotex' shall be laid; 100mm of green-source woodchip; continuously abutted scaffold boards or manufactured boards so as to completely cover this area. This area shall be used for pedestrian access only.

OR

To handle loads imposed by pedestrian-operated plant up to 1 tonne gross weight, a 2D geotextile membrane, such as 'Ekotex' shall be laid, and in sequence; 100mm of green-source woodchip; continuously abutted scaffold boards and a layer of manufactured board at least 25mm thick screwed to the underlying scaffold boards.

## CONSTRUCTION

**Method 4: SERVICE TRENCHES (Aim of method: to limit and control root damage during services installation close to tree roots)**

N.b. This applies to ALL services: Electricity, gas, water, etc. Existing services shall be utilised wherever possible.

These methods shall apply generally within any RPA (orange shapes/circles).

- 1) The trench shall be opened with an air-spade to required depth. Roots 20mm or more in diameter unearthed shall be temporarily protected with bubble-wrap and insulating or gaffer tape while rest of trench is dug. Services shall be worked under/over/around/between roots so as not to cut or damage any larger than 20mm diameter.  
OR
- 2) The trench shall be dug with hand tools only. Probes such as screwdrivers or steel rod <10mm diameter to determine root presence ahead of digging shall be used. The work shall proceed cautiously. No roots over 20mm diameter shall be cut. Roots 20mm or more in diameter unearthed shall be temporarily protected with bubble-wrap and insulating or gaffer tape while rest of trench is dug. Services shall be worked under/over/around/between roots so as not to cut or damage any larger than 20mm diameter.  
OR
- 3) Services shall be thrust-bored using trenchless techniques (compressed air-driven 'mole') at a depth of 700mm or more below ground level, entailing no surface excavation. Starter pits for rams shall be outside any RPA, or reception/starter pits shall be opened according to 1) or 2) above.

**Method 5: ROOT PRUNING (Aim of method: to limit and control root cutting during below-ground installation/construction)**

This method shall apply within only the RPA (orange shape) around tree no. 6. The excavation shall be made with hand tools only. Any roots encountered shall be trimmed to the edge of



excavation using a sharp edge tool such as handsaw or secateurs; the cuts shall be made at right angles to the long axis of the root, and in accordance with BS3998:2010, 8.6. An HDPE membrane shall be placed between any root-bearing soil (i.e., within the RPA) and any wet concrete to be poured. Impermeable sheeting (to exclude wet concrete) shall be laid and secured locally by temporary weighting / taping as required. Concrete casting shall take place without disturbing this protective layer.



#### **Method 6: *SUSPENDED TIMBER SUPERSTRUCTURE***

This method shall apply in the zone of **magenta honeycomb** on plan. No reduction whatever in existing ground levels shall take place. The floor and superstructure supporting frame shall be supported by micro-piles such as StopDigging / Great British Screw Pile Company proprietary type (see left) or similar micro-piles inserted with hand tools only. Trial pits to determine micro-pile locations shall be dug with hand tools only. N.B. The precise location of piles is flexible. Probes such as screwdrivers or steel rod <10mm diameter to determine root presence ahead of digging shall be used. The work shall proceed cautiously. No roots over 20mm diameter shall be cut. The micro-piles shall be inserted; the superstructure shall be erected by use of hand tools only, on the pile heads, in accordance with manufacturer's instructions.

## **LATE CONSTRUCTION and LANDSCAPING PHASE**

#### **Method 7: *PATIO (various finishes possible)***

This method shall apply in RPA of tree 6 (**orange** shape). No 'scraping up' with a mechanical excavator shall take place. No wheeled or tracked machinery shall be used: construction shall be by means of hand tools/hand-held power tools. No reduction of levels shall take place, except to remove any wearing surface where a competent sub-base is to be retained and utilized. Edge restraint shall be formed from tanalised timber pinned to substrate with tanalised timber pegs or similar.

#### **'NIDAGRAVEL'**

Levels can be corrected by use of granite chippings NO FINES. A 3D pocket geotextile system, such as the 'Nidagravel' tray system 40mm deep backfilled with 40mm+, clean stone or gravel – NO FINES can be laid directly over the level correction layer. This system provides a wheelchair-friendly finish.

OR

#### **SLABS**

A fine-mesh geogrid such as Tensar 'TriAx' shall be laid. The grid size shall be sufficiently small to retain the level correction/bedding layer stone to be laid: granite chippings, NO FINES. Paving shall be laid open-jointed and the joints rammed with granite chippings.

#### **Method 8: *TREE PLANTING AREA (Aim of method: to ensure thrift of new planting)***

This method shall apply after completion of main build only. Ground preparation for tree planting areas shall entail removal of hard surfacing using hand tools or hand-held power tools only, the removal of degraded or compacted or contaminated soil to a depth of at least

0.45m below finished surrounding ground level. The base and sides of the pit shall be forked over to at least one hand fork's spit in depth. Screened topsoil (to BS3882: 2015 topsoil) with biochar (such as <https://www.soilfixer.co.uk/biochar-article>) - 5% of the topsoil volume shall be used as planting medium. This equates to about 20 kgs of product per cubic metre of topsoil (to BS3882: 2015 topsoil) to a maximum depth of 0.45m within 1.3m of the trunk location of each tree to be planted. Soil handling of any kind shall take place only after a minimum of 3 days after heavy rain, and shall where possible be carried out 7 days or more after such rainfall. Tree planting shall be in accordance with British Standard 8545:2014 'Trees: from nursery to independence in the landscape - Recommendations'. This enshrines good arboricultural practice: the tree shall be planted so that the root collar lies at finished ground level, shall be short-staked and tied with proprietary tree tie. The ground surface shall be mulched within 0.75m of the trunk location to a depth of 100mm with composted organic material or proprietary mulch mat.

**Method 9: LANDSCAPING PREPARATION IN ROOT PROTECTION AREAS (Aim of method: to ensure thrift of topsoil)**

This method shall apply after completion of main build only. Operations shall take place only after a minimum of 3 days after heavy rain, and shall where possible be carried out 7 days or more after such rainfall. Ground preparation within root protection areas shall entail use of hand tools only. The ground surface shall be thoroughly hand-forked over in vertical mode only to one spit's depth (250mm). Care shall be taken not to damage tree roots greater than 20mm diameter. Weed treatment if required shall be via BASIS qualified operatives. Surface debris shall be removed by hand to barrow and disposed of off-site. No wheeled or tracked plant shall be used: hand-held power tools may be used. (Outside root protection areas, mechanical cultivation shall be permitted.) The finishing soil horizon where additional planting medium is required shall be composed of biochar (see: <https://www.soilfixer.co.uk/biochar-article>) mixed with topsoil (to BS3882:2015 topsoil) - 5% by volume (equating to 20 kgs of product per cubic metre of topsoil), which shall be laid by hand-barrow: no mechanical plant shall over-run the loose-tipped material. All handling of soils/soil-mix shall take place only after a minimum of 3 days after heavy rain, and shall where possible be carried out 7 days or more after such rainfall. The mix shall be laid to finish to required levels and allowed to settle via mist irrigation / watering-in / natural rainfall. The ground surface shall be worked to a fine tilth with hand tools prior to planting. No mechanical compaction whatever shall be used. Levelling and minimal consolidation shall be by hand tools / foot and board only, or naturally. Earthworm Inoculation Units (see: <https://www.wormsdirectuk.co.uk/product/worm-colonies-lawn-areas/>) shall be placed with their tops 150mm below ground level at 5m intervals in all soil build-up areas. The units, which are typically cardboard, shall be earthed in and irrigated.

**Method 10: MAINTENANCE (Aim of method: to prevent expensive losses soon after planting)**

Maintenance shall consist of the regular moderate watering of any plant the subject of the planting proposal during the first season (April 15 to October 15) after planting and thereafter in the following four years if drought conditions occur. Hedges shall be trimmed twice yearly to a height of no less than 1.3m and no less than 0.5m thickness (cross sectional). Mulch shall be kept topped up to a maximum depth of 100mm. Grassed areas shall be cut weekly (April 15 to October 15).

**Method 11: REPLACEMENT (Aim of method: to maintain treescape as planned and consented)**

If within five years of issue of certificate of completion any plant the subject of the planting proposal dies or in the opinion of the LPA becomes seriously damaged or diseased, the same shall be replaced according to the above methods.

(All design subject to engineering approval, but used on other sites and known to be practicable and reliable).

Name [print]:

For construction company:

Date:

Signature.....

S1113-J1-R-1

End of section 9.4 document

End of main body of report – plans appended.

Dated: 13th June 2023

Signature (for John Cromar's Arboricultural Co. Ltd.)

A handwritten signature in black ink that reads "John Cromar". The signature is fluid and cursive, with a long horizontal flourish extending to the right.

John Cromar

Dip. Arb. (RFS), FArborA

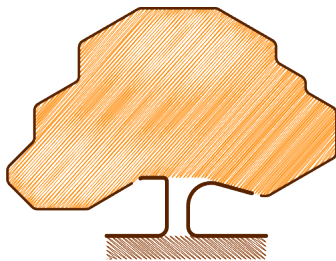

JOHN CROMAR'S  
ARBORICULTURAL  
COMPANY LTD

[www.treescan.co.uk](http://www.treescan.co.uk)  
[admin@treescan.co.uk](mailto:admin@treescan.co.uk)

01582 808020  
07860453072

## 10 Plans

N.b. The scale of the plans is dependent on the paper size on which any hard copy is produced.

S1113-J1-P1 v1

S1113-J1-P2 v1

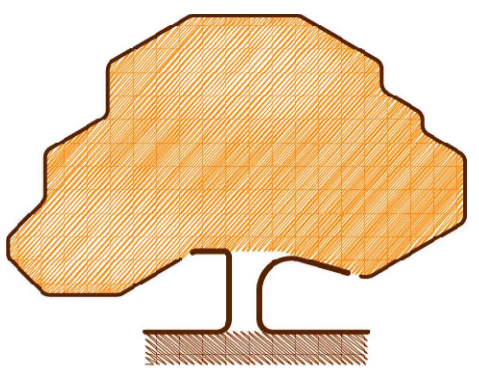

**JOHN CROMAR'S  
ARBORICULTURAL  
COMPANY  
LIMITED**

THE OLD SCHOOL,  
TITLEY, KINGTON,  
HR5 3RN.  
at Wheatley, Oxford  
& Harpenden, Herts.

TEL 01582 808020  
FAX 01544 231006  
MOB 07860 453072  
admin@treescan.co.uk  
www.treescan.co.uk



**KEY TO COLOURS /  
LINETYPES USED IN  
RELATION TO TREES**

- GREEN - High Value (A)
- BLUE - Moderate Value (B)
- BLACK - Low Value (C)
- RED - Very short life expectancy (U)
- ORANGE SHAPES: Root Protection Areas

**Spread and trunk colours correspond directly to those used in British Standard 5837:2012, Table 2.**

TOOTHED LINE: Tree spread line

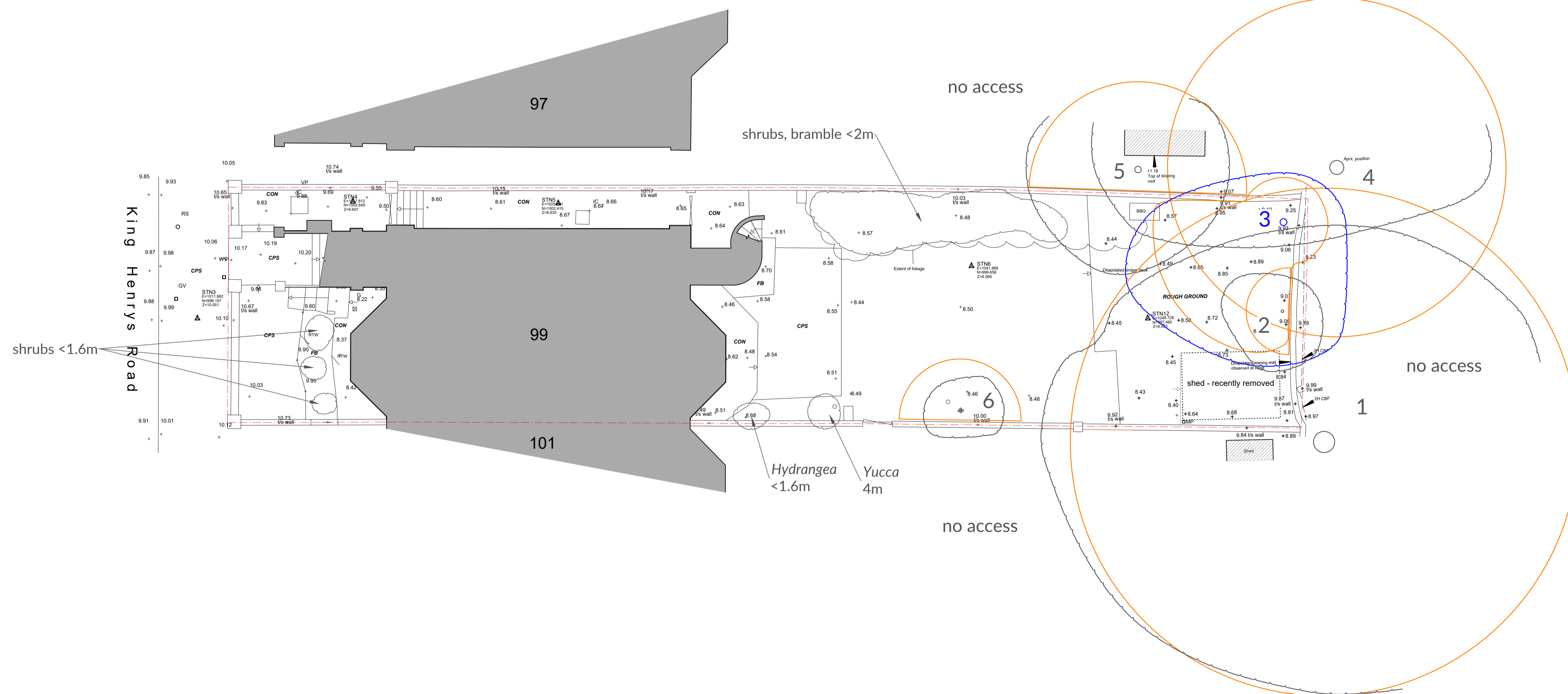

**DRG. NAME  
TREE VALUE  
ASSESSMENT  
(AS PER BS  
5837:2012) &  
ROOT  
PROTECTION  
AREAS**

**NOTES**

Do not use for setting out purposes.  
All dimensions to be checked on site.

Any scale referenced below applies ONLY when plan printed at ISO A1 size.

The original of this drawing was produced in colour - a monochrome copy should not be relied upon.

**TEXT**

FOR FULL DETAILS OF TREE VALUE  
PLEASE SEE REPORT

BASED ON  
TWICKENHAM SURVEYS LTD. DRG.  
NO.: 1133-S01 SUPPLIED

SITE ADDRESS  
99 King Henry's Road, London,  
NW3 3QX

DRG. REF.	REV. NO.
S1113-J1-P1	v1
SCALE & SIZE	DATE
1:100 @ A1	12-Jun-23
0	5

The methods below typically each have a unique colour code and hatch or other reference to the plan, for example, pink lines indicate where fences to protect trees should be positioned.

**PREPARATION / DEMOLITION**

**Method 1: SCHEDULE OF TREE WORK**  
Tree work shall be in accordance with the schedule within report and to BS 3998:2010 'Tree Work - Recommendations', and in accord with spread line(s) marked on plan.

**Method 2: TREE PROTECTION FENCING (Aim of method: to provide protection for trunks, branches and roots during demolition operations and construction)**  
Tree protection fencing shall be erected, consisting of 'Heras' type fencing (weld-mesh panels), each section securely attached to uprights driven at least 0.6m into ground, as per the layout as shown on the plan (pink lines). No ground levels reduction or excavation shall take place within (=the tree side of) the fence lines. The standard rubber supports ('elephant's feet') shall if used, be as per BS 5837:2012 section 6.2.2, figure 3; that is, pinned to the substrate with re-bar.

Below the crowns of trees with branches extending to less than 2m above ground level, in order to avoid unnecessary pruning, it is permissible to replace sections with manufactured boards at least 11mm thick (hoarding), attached securely to timber uprights driven at least 1.5m above ground level.

Where required to infill odd sections, tree protection fencing may be varied to >1.8m high hoarding of >11mm thick manufactured board and timber uprights >50mm x 100mm, no part of any of which is to be attached to any tree.

No fires shall be made on any part of the site, or within 20m of any tree to be retained. No storage of materials shall be made within the protective fences. No breaching or moving of the protective fences shall take place without the approval of an arboriculturist.

**Method 3: GROUND SURFACE HANDLING and PROTECTION (Aim of method: to provide protection for roots during demolition operations and construction)**  
This method shall apply in the zones hatched blue on plan. NO levels reduction shall take place. This includes no 'scraping up' with a mechanical excavator or otherwise. Any existing hard surfacing, any existing surface debris, light vegetation, etc., that lies within the zone shall be removed using hand tools only. A 2D geotextile membrane, such as 'Ekotex' shall be laid; 100mm of green-source woodchip; continuously abutted scaffold boards or manufactured boards so as to completely cover this area. This area shall be used for pedestrian access only.

OR  
To handle loads imposed by pedestrian-operated plant up to 1 tonne gross weight, a 2D geotextile membrane, such as 'Ekotex' shall be laid, and in sequence; 100mm of green-source woodchip; continuously abutted scaffold boards and a layer of manufactured board at least 25mm thick screwed to the underlying scaffold boards.

**CONSTRUCTION**

**Method 4: SERVICE TRENCHES (Aim of method: to limit and control root damage during services installation close to tree roots)**  
N.b. This applies to ALL services: Electricity, gas, water, etc. Existing services shall be utilised wherever possible.

These methods shall apply generally within any RPA (orange shapes/circles).

1) The trench shall be opened with an air-spade to required depth. Roots 20mm or more in diameter unearthed shall be temporarily protected with bubble-wrap and insulating or gaffer tape while rest of trench is dug. Services shall be worked under/over/around/between roots so as not to cut or damage any larger than 20mm diameter.

OR

2) The trench shall be dug with hand tools only. Probes such as screwdrivers or steel rod <10mm diameter to determine root presence ahead of digging shall be used. The work shall proceed cautiously. No roots over 20mm diameter shall be cut. Roots 20mm or more in diameter unearthed shall be temporarily protected with bubble-wrap and insulating or gaffer tape while rest of trench is dug. Services shall be worked under/over/around/between roots so as not to cut or damage any larger than 20mm diameter.

OR

3) Services shall be thrust-bored using trenchless techniques (compressed air-driven 'mole') at a depth of 700mm or more below ground level, entailing no surface excavation. Starter pits for rams shall be outside any RPA, or reception/starter pits shall be opened according to 1) or 2) above.

**Method 5: ROOT PRUNING (Aim of method: to limit and control root cutting during below-ground installation/construction)**

This method shall apply within only the RPA (orange shape) around tree no. 6. The excavation shall be made with hand tools only. Any roots encountered shall be trimmed to the edge of excavation using a sharp edge tool such as handsaw or secateurs; the cuts shall be made at right angles to the long axis of the root, and in accordance with BS3998:2010, 8.6. An HDPE membrane shall be placed between any root-bearing soil (i.e., within the RPA) and any wet concrete to be poured. Impermeable sheeting (to exclude wet concrete) shall be laid and secured locally by temporary weighting / taping as required. Concrete casting shall take place without disturbing this protective layer.

**Method 6: SUSPENDED TIMBER SUPERSTRUCTURE**

This method shall apply in the zone of magenta honeycomb on plan. No reduction whatever in existing ground levels shall take place. The floor and superstructure supporting frame shall be supported by micro-piles such as StopDigging / Great British Screw Pile Company proprietary type or similar micro-piles inserted with hand tools only. Trial pits to determine micro-pile locations shall be dug with hand tools only. N.B. The precise location of piles is flexible. Probes such as screwdrivers or steel rod <10mm diameter to determine root presence ahead of digging shall be used. The work shall proceed cautiously. No roots over 20mm diameter shall be cut. The micro-piles shall be inserted; the superstructure shall be erected by use of hand tools only, on the pile heads, in accordance with manufacturer's instructions.

**LATE CONSTRUCTION and LANDSCAPING PHASE**

**Method 7: PATIO (various finishes possible)**

This method shall apply in RPA of tree 6 (orange shape). No 'scraping up' with a mechanical excavator shall take place. No wheeled or tracked machinery shall be used: construction shall be by means of hand tools/hand-held power tools. No reduction of levels shall take place, except to remove any wearing surface where a competent sub-base is to be retained and utilized. Edge restraint shall be formed from tanalised timber pinned to substrate with tanalised timber pegs or similar.

'NIDAGRAVEL'

Levels can be corrected by use of granite chippings NO FINES. A 3D pocket geotextile system, such as the 'Nidagravel' tray system 40mm deep backfilled with 40mm+, clean stone or gravel - NO FINES can be laid directly over the level correction layer. This system provides a wheelchair-friendly finish.

OR

SLABS

A fine-mesh geogrid such as Tensar TriAx' shall be laid. The grid size shall be sufficiently small to retain the level correction/bedding layer stone to be laid; granite chippings, NO FINES. Paving shall be laid open-jointed and the joints rammed with granite chippings.

**Method 8: TREE PLANTING AREA (Aim of method: to ensure thrift of new planting)**

This method shall apply after completion of main build only. Ground preparation for tree planting areas shall entail removal of hard surfacing using hand tools or hand-held power tools only, the removal of degraded or compacted or contaminated soil to a depth of at least 0.45m below finished surrounding ground level. The base and sides of the pit shall be forked over to at least one hand fork's spit in depth. Screened topsoil (to BS3882: 2015 topsoil) with biochar (such as <https://www.soilfixer.co.uk/biochar-article>) - 5% of the topsoil volume shall be used as planting medium. This equates to about 20 kgs of product per cubic metre of topsoil (to BS3882: 2015 topsoil) to a maximum depth of 0.45m within 1.3m of the trunk location of each tree to be planted. Soil handling of any kind shall take place only after a minimum of 3 days after heavy rain, and shall where possible be carried out 7 days or more after such rainfall. Tree planting shall be in accordance with British Standard 9545:2014 'Trees: from nursery to independence in the landscape - Recommendations'. This enshrines good arboricultural practice: the tree shall be planted so that the root collar lies at finished ground level, shall be short-staked and tied with proprietary tree tie. The ground surface shall be mulched within 0.75m of the trunk location to a depth of 100mm with composted organic material or proprietary mulch mat.

**Method 9: LANDSCAPING PREPARATION IN ROOT PROTECTION AREAS (Aim of method: to ensure thrift of topsoil)**

This method shall apply after completion of main build only. Operations shall take place only after a minimum of 3 days after heavy rain, and shall where possible be carried out 7 days or more after such rainfall. Ground preparation within root protection areas shall entail use of hand tools only. The ground surface shall be thoroughly hand-forked over in vertical mode only to one spit's depth (250mm). Care shall be taken not to damage tree roots greater than 20mm diameter. Weed treatment if required shall be via BASIS qualified operatives. Surface debris shall be removed by hand to borrow and disposed of off-site. No wheeled or tracked plant shall be used: hand-held power tools may be used. (Outside root protection areas, mechanical cultivation shall be permitted.) The finishing soil horizon where additional planting medium is required shall be composed of biochar (see: <https://www.soilfixer.co.uk/biochar-article>) mixed with topsoil (to BS3882:2015 topsoil) - 5% by volume (equating to 20 kgs of product per cubic metre of topsoil), which shall be laid by hand-barrow: no mechanical plant shall over-run the loose-tipped material. All handling of soils/soil-mix shall take place only after a minimum of 3 days after heavy rain, and shall where possible be carried out 7 days or more after such rainfall. The mix shall be laid to finish to required levels and allowed to settle via mist irrigation / watering-in / natural rainfall. The ground surface shall be worked to a fine tilth with hand tools prior to planting. No mechanical compaction whatever shall be used. Levelling and minimal consolidation shall be by hand tools / foot and board only, or naturally. Earthworm Inoculation Units (see: <https://www.wormsdirectuk.co.uk/product/worm-colonies-lawm-areas/>) shall be placed with their tops 150mm below ground level at 5m intervals in all soil build-up areas. The units, which are typically cardboard, shall be earthed in and irrigated.

**Method 10: MAINTENANCE (Aim of method: to prevent expensive losses soon after planting)**

Maintenance shall consist of the regular moderate watering of any plant the subject of the planting proposal during the first season (April 15 to October 15) after planting and thereafter in the following four years if drought conditions occur. Hedges shall be trimmed twice yearly to a height of no less than 1.3m and no less than 0.5m thickness (cross sectional). Mulch shall be kept topped up to a maximum depth of 100mm. Grassed areas shall be cut weekly (April 15 to October 15).

**Method 11: REPLACEMENT (Aim of method: to maintain treescape as planned and consented)**

If within five years of issue of certificate of completion any plant the subject of the planting proposal dies or in the opinion of the LPA becomes seriously damaged or diseased, the same shall be replaced according to the above methods.

(All design subject to engineering approval, but used on other sites and known to be practicable and reliable).

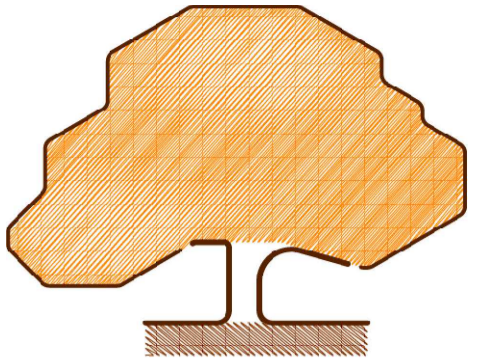
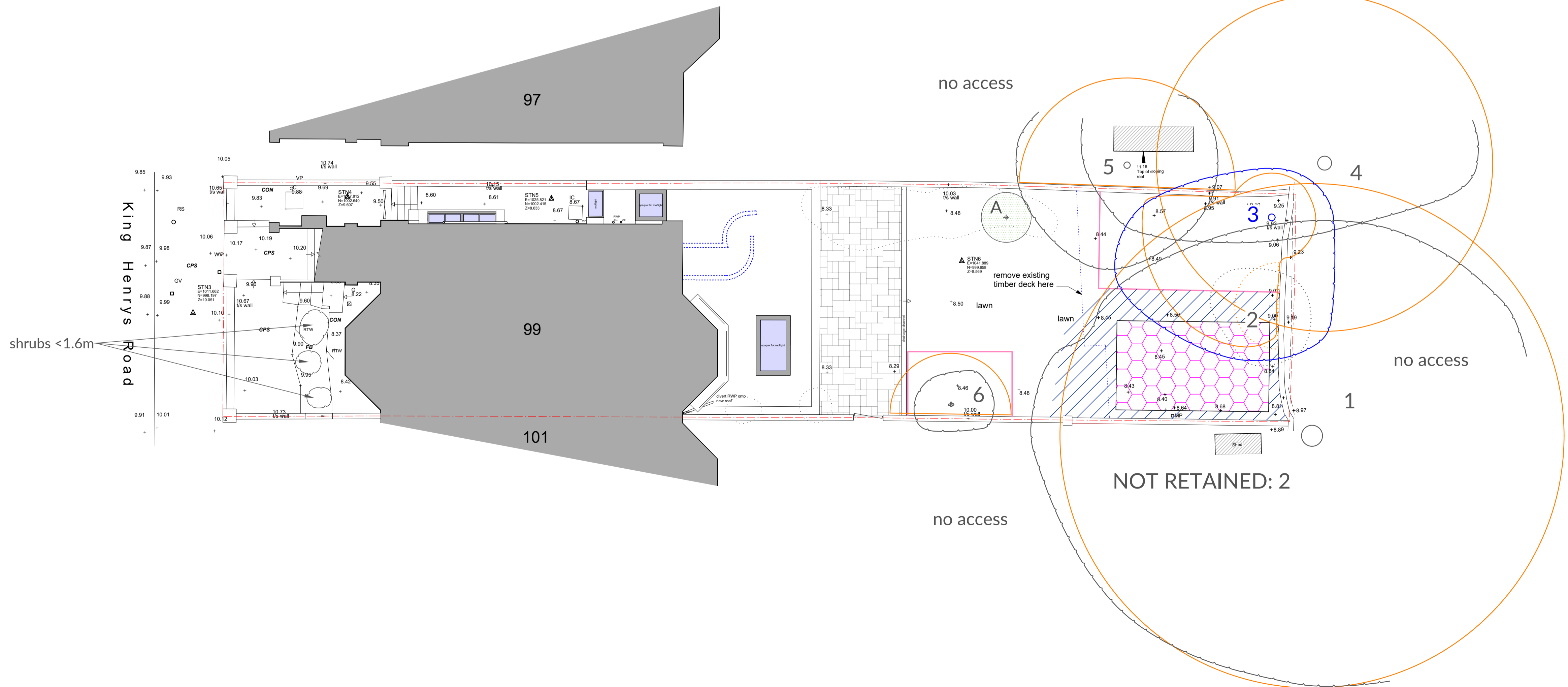

**JOHN CROMAR'S  
ARBORICULTURAL  
COMPANY  
LIMITED**

THE OLD SCHOOL,  
TITLEY, KINGTON,  
HR5 3RN.  
at Wheatley, Oxford  
& Harpenden, Herts.

TEL 01582 808020  
FAX 01544 231006  
MOB 07860 453072  
admin@treescan.co.uk  
[www.treescan.co.uk](http://www.treescan.co.uk)



**KEY TO COLOURS /  
LINETYPES USED IN  
RELATION TO TREES**

- GREEN - High Value (A)
- BLUE - Moderate Value (B)
- BLACK - Low Value (C)
- RED - Very short life expectancy (U)
- ORANGE SHAPES: Root Protection Areas

**Spread and trunk colours correspond directly to those used in British Standard 5837:2012, Table 2.**

**PROPOSED NEW PLANTING:**  
This is indicated by green stipple within roundels (trees) or other shapes, e.g., for hedges. For key to the letters designating locations, please see report.

**DRG. NAME  
TREE RETENTION  
& TREE  
PROTECTION  
MEASURES**

**NOTES**  
Do not use for setting out purposes.  
All dimensions to be checked on site.  
Any scale referenced below applies ONLY when plan printed at ISO A1 size.  
The original of this drawing was produced in colour - a monochrome copy should not be relied upon.  
TEXT FOR FULL METHOD DETAILS PLEASE SEE REPORT

BASED ON  
BROD WIGHT ARCHITECTS DRG.  
NO.: 1133-AP01 SUPPLIED

SITE ADDRESS  
99 King Henry's Road, London,  
NW3 3QX

DRG. REF.	REV. NO.
S1113-J1-P2	v1
SCALE & SIZE	DATE
1:100 @ A1	13-Jun-23
0	5