

DRAWING NOTES

GENERAL NOTES

- Read in conjunction with [00], [21], [22], [24], [32], [35], [43], [45], [46], [50], [68], [74], [75], [90] series drawings
- Read in conjunction with NBS specification
- Read in conjunction with M&E consultants' information
- Read in conjunction with Structural engineers' information
- Read in conjunction with Lighting designers' information
- Read in conjunction with Fire consultant's information
- All overall assembly dimensions are nominal and need to be verified by the contractor from site dimensions in order to achieve the details described in the Architectural Component [AC] series of drawings
- Refer to AL_122*_series for internal wall types
- Read in conjunction with Transport consultant's information

REVISION DATE NOTE

| | | |
|-----|----------|----------------|
| P01 | 17.03.23 | PLANNING ISSUE |
| P02 | 01.06.23 | PLANNING ISSUE |
| P03 | 15.06.23 | PLANNING ISSUE |

TEAM

| | |
|---------------------|--------------------|
| CLIENT | Lazari Investments |
| STRUCTURAL ENGINEER | Guardant Harmon |
| CIVIL ENGINEER | GLP |
| MEP ENGINEER | GLP |
| COST CONSULTANT | CN Associates |
| PROJECT MANAGER | Cushman Wakefield |
| APPROVED INSPECTOR | Salus |
| CDM ADVISOR | Shore Engineering |
| LANDSCAPE DESIGN | Studio OHB |
| FIRE ENGINEER | Jensen Hughes |
| LIGHTING DESIGN | Studio 29 |

GENERAL NOTES

1. Do not scale from this drawing.
2. All dimensions to be checked on site by the contractor and such dimensions to be his responsibility.
3. Report all drawing errors, omissions and discrepancies to the architect.
4. This document may be issued in an uncontrolled CAD format to enable others to use it as background information to make alterations and/or additions. In that instance the file will be accompanied by a PDF version. It is for those making such alterations and additions to ensure that they make use of current background information. Gibson Thornley Architects accepts no liability for any such alterations or additions to the background information or arising out of changes to background information which occur prior to alterations of additions being made.

LOCATION

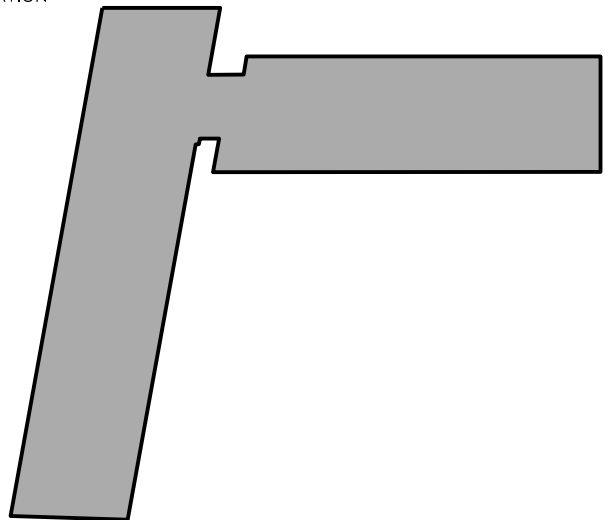

GIBSON THORNLEY

Gibson Thornley Architects Limited
No. 4 The Hangar
Perseverance Works
25-27 Hackney Road
London E2 7NX
www.gibsonthornley.com
info@gibsonthornley.com
+44 (0)20 7729 7064

JOB TITLE
MAPLE HOUSE
DRAWING TITLE
PROPOSED RAMP ENTRANCE ELEVATIONS

| | | | |
|----------|---------|--------------------|----------|
| DRAWN BY | CHECKED | SCALE | STATUS |
| CK | BG | 1:20@A1 1:40@A3 | PLANNING |

| | | | | | |
|---------|------|------|----------------|------------|----------|
| PROJECT | ZONE | TYPE | CLASSIFICATION | DRAWING NO | REVISION |
| 20024 | - | AL | [24] | 210 | P03 |