

250x250x10 SHS CROSS BEAM  
INSTALLED JUST ABOVE EXISTING  
HANDRAIL, 25mm OFF FACE OF WALL.

8No. 80x80x5 SHS NEEDLE BEAMS CUT INTO  
POCKETS IN PIERS AT MAXIMUM 325mm c/c FOR  
FULL 215mm DEPTH OF OUTER BRICK FACE

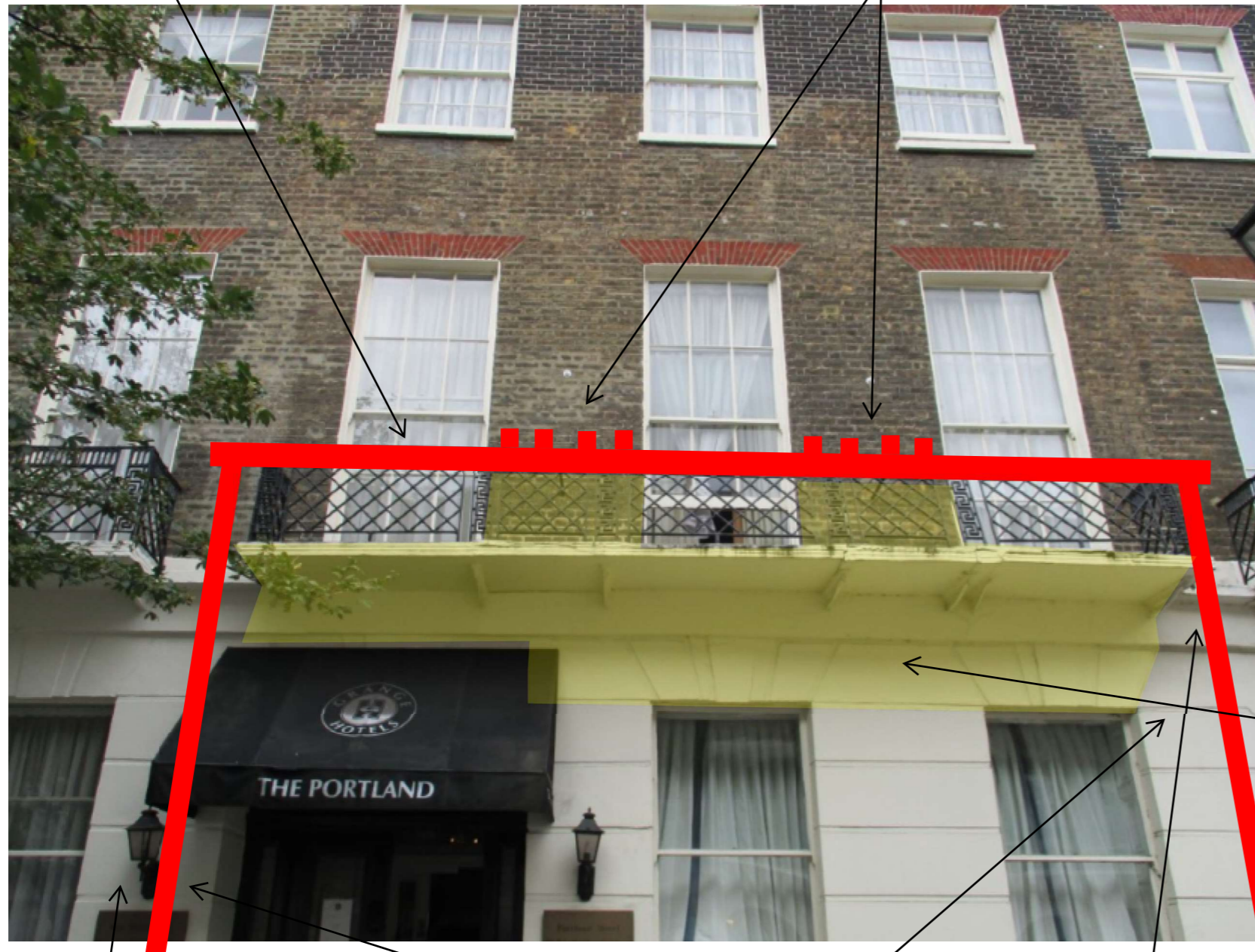

FRONT ELEVATION

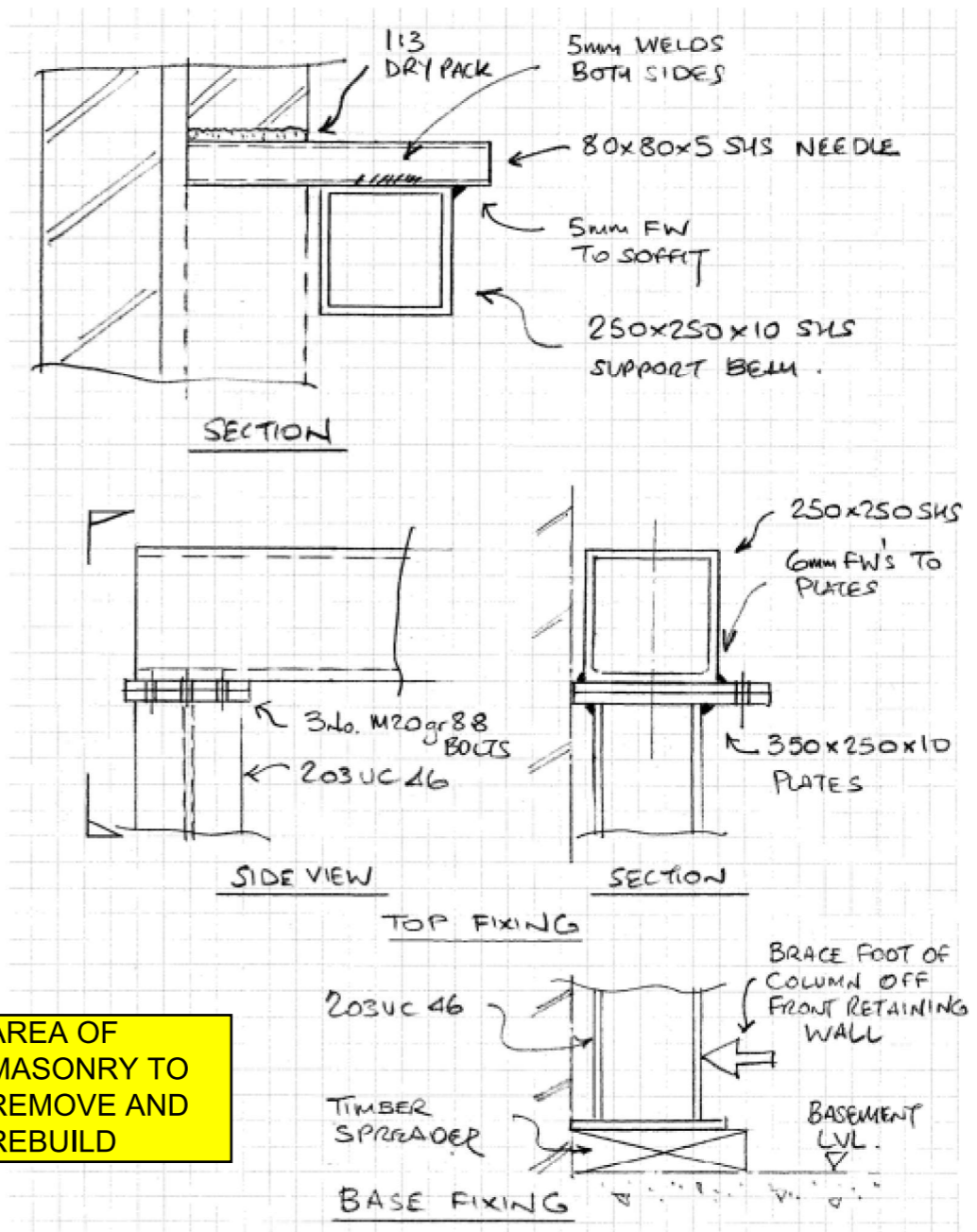

AREA OF  
MASONRY TO  
REMOVE AND  
REBUILD

STEEL GOAL POST FRAME CONNECTION DETAILS

TEMPORARILY REMOVE FIXTURES  
AND FITTINGS AS REQUIRED

203UC46 SUPPORT POSTS OFF  
BASEMENT LIGHTWELL SLAB BELOW.

BRACE 203UC46 SUPPORT POSTS OFF  
BASEMENT LIGHTWELL RETAINING WALL  
WITH DIAGONAL SCAFFOLD TUBES.

<p>NOTES</p>	<p>CDM DETAILS (Refer to note 2)</p>	<p>ENG. <b>Hurst Peirce + Malcolm LLP</b> CONSULTING CIVIL &amp; STRUCTURAL ENGINEERS <b>HPM</b></p>	<p>Client GRANGE HOTELS</p>	<p>Title TEMPORARY SUPPORT TO FRONT ELEVATION</p>
<p>1. THIS DRAWING IS TO BE READ IN CONJUNCTION WITH ALL RELEVANT DRAWINGS DETAILS AND SPECIFICATIONS 2. CDM DETAILS REFERS TO THE CONSTRUCTION (DESIGN AND MANAGEMENT) REGULATIONS. THE READER MUST REFER TO METHOD STATEMENTS OR RISK ASSESSMENT AS APPROPRIATE, WHICH IDENTIFY UNUSUAL AND ABNORMAL RISKS THAT A COMPETENT CONTRACTOR COULD NOT EXPECT TO ANTICIPATE.</p>	<p>TEMPORARY SUPPORTS TO BE INSTALLED AND BRACED OFF FRONT LIGHTWELL RETAINING WALL. SUPPORTS TO REMAIN IN PLACE UNTIL WALL AND BALCONY REBUILT.</p>	<p>NB CELTIC HOUSE 33 JOHN'S MEWS HOLBORN LONDON WC1N 2QL TEL: 020 7242 3593 FAX: 020 7405 5274 E-MAIL: enquiries@hurstpm.co.uk WEB PAGE: www.hurstpm.co.uk</p>	<p>Project GRANGE PORTLAND HOTEL 31-32 BEDFORD PLACE LONDON WC1B 5JH Status CONSTRUCTION Scale NTS</p>	<p>Drawn NB Checked Passed Date OCT'22 Drawing No. 26658/SK01</p>