

BUCKS PLANT CARE LTD

Arboricultural Method Statement  
(AMS)  
551-557 Finchley Road,  
London,  
NW3 7BJ

2022



BUCKS PLANT CARE LTD

## **ARBORICULTURAL METHOD STATEMENT (AMS)**

**Site: 551-557 Finchley Road, London, NW3 7BJ**

To be read in conjunction with the Tree Report PBA/551FLY/AIA/02a by landmark Trees and Tree Protection Plan at Appendix 2. NB The original of this plan was produced in colour – a monochrome copy should not be relied upon.

This AMS lays down the methodology for any demolition and/or construction works that may have an effect upon trees on and adjacent to this site. It is essential within the scope of any contracts - related to this development - that this AMS is observed and adhered to. It is recommended that this document forms part of the work schedule and that specifications are issued to the building contractor(s) and these must be used to form part of their contract.

Consulting Arborist contact details:

Patrick Prendergast – mob. No. 07952 338564

This report related to approved planning application 20290/5444/P and is prepared to discharge condition 8

- 8 Prior to the commencement of any works on site, details demonstrating how trees to be retained shall be protected during construction work shall be submitted to and approved by the Council in writing. Such details shall follow guidelines and standards set out in BS5837:2012 "Trees in Relation to Construction" and should include details of appropriate working processes in the vicinity of trees, and details of an auditable system of site monitoring. All trees on the site, or parts of trees growing from adjoining sites, unless shown on the permitted drawings as being removed, shall be retained and protected from damage in accordance with the approved protection details.

Reason: To ensure that the development will not have an adverse effect on

existing trees and in order to maintain the character and amenity of the area in accordance with the requirements of policies A2 and A3 of the London Borough of Camden Local Plan 2017 and policy 18 of the Fortune Green and West Hampstead Neighbourhood Plan 2015.

## SEQUENCE OF WORKS

From commencement of the subject development, the following methodology will be implemented in the manner and sequence described:

1. Pre-commencement site meeting.
  2. Tree removal and pruning
  3. Install tree protection barriers and trunk protection
  4. Main construction works.
  5. Remove barriers
- 
1. **PRE- COMMENCEMENT SITE MEETING** To outline on-site working methods in relation to trees prior to any demolition and/or construction activity, a site meeting of the following shall take place:
    - Client • Architect/Planning Consultant • Structural Engineer • Main Contractor • LPA Arboricultural Officer (optional) • Consulting Arborist • Site Agent

## 2. TREE REMOVAL AND PRUNING

As per the approved arboricultural report by Landmark Trees Appendix 3 trees T4 and T5 will be removed.

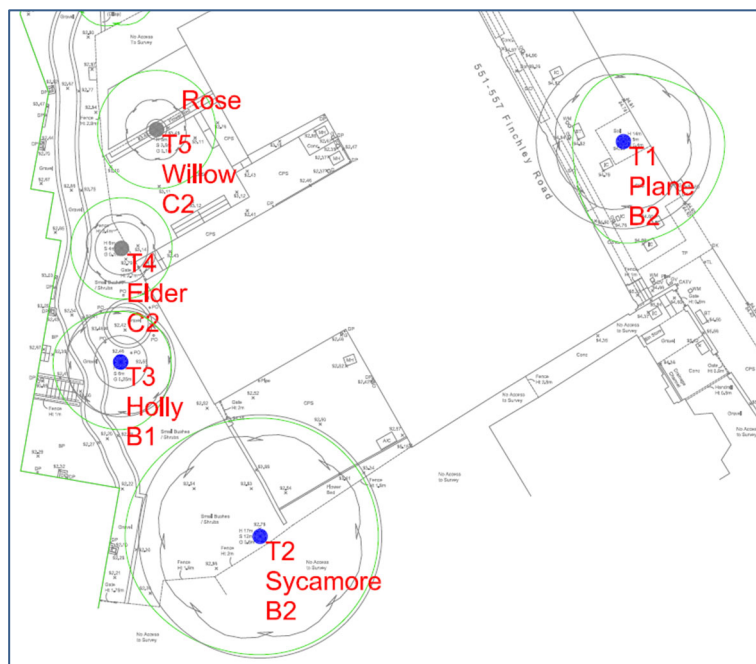

The sycamore T2 was reduced in size last winter and will not be in conflict with the extension.



**3. ESTABLISH THE CONSTRUCTION EXCLUSION ZONE (CEZ):**

As per the tree protection plan (TPP), ref PBC 20768, the defined fencing must be installed as per the detail on the plan and Appendix 2 around the hatched area as it is a Construction Exclusion Zone.

Install the trunk protection as shown on the plan to the london plane street tree. A gantry will be installed to the right of the street tree, as highlighted, in order to deliver materials and remove waste.



**4. MAIN CONSTRUCTION WORKS**

1. Before commencing work on site, all operatives must be briefed by the Site Agent/Contract Manager on the importance of protecting on site trees. The basis of this briefing will be the protection measures as set out on the Tree Protection Plan (TPP) including the position of Construction

Exclusion Zones. NB during the construction the Site Agent/Contract Manager will be responsible for all tree protection measures. Regular monitoring visits will be undertaken by the Consulting arborist. This will take place every 5 weeks during the demolition and build process.

2. There must be no:

- (a) storage or disposal of any soil, building materials, rubble, machinery, fuel, chemicals, liquids waste residues or materials/debris of any other description
- (b) preparation of noxious substances (e.g. cement)
- (c) Parking/use of tracked or wheeled machinery or vehicles of any description.
- (d) Siting of any temporary structures of any description including site office/sales buildings, temporary car parking facilities, porta-loos, storage compounds or hard standing areas of any other description
- (e) Soil/turf stripping, raising/lowering of existing levels, excavation or alterations to the existing surfaces/ ground conditions of any other description
- (f) Installation/siting of any underground services, temporary or otherwise including; drainage, water, gas, electricity, telephone, television, external lighting or any associated ducting.

in any area designated as the Construction Exclusion Zone (CEZ)

In addition to the protection measures specified above,

- a) No fires shall be lit within 20 metres of the trunks of the canopies any trees or the spread of any hedgerow shown to be retained.
- b) No signs, cables, fixtures or fittings of any other description shall be attached to any part of any retained tree.

- c) No chemicals, fuel, liquids/waste residues of any other description to be stored or disposed of within close proximity to or drained towards/ into protection areas.

Regular monitoring must take place every 5 weeks to ensure the AMS is being adhered to using the monitoring form in Appendix 3. The monitoring form will be filled out and submitted to the planning officer following each visit.

#### 5. **REMOVAL OF TEMPORARY TREE PROTECTION**

Once all works have been completed the ground and tree protection can be removed.

## **Appendix 1**

### **Tree Protection Plan**



## Appendix 2- Tree protection fencing specification

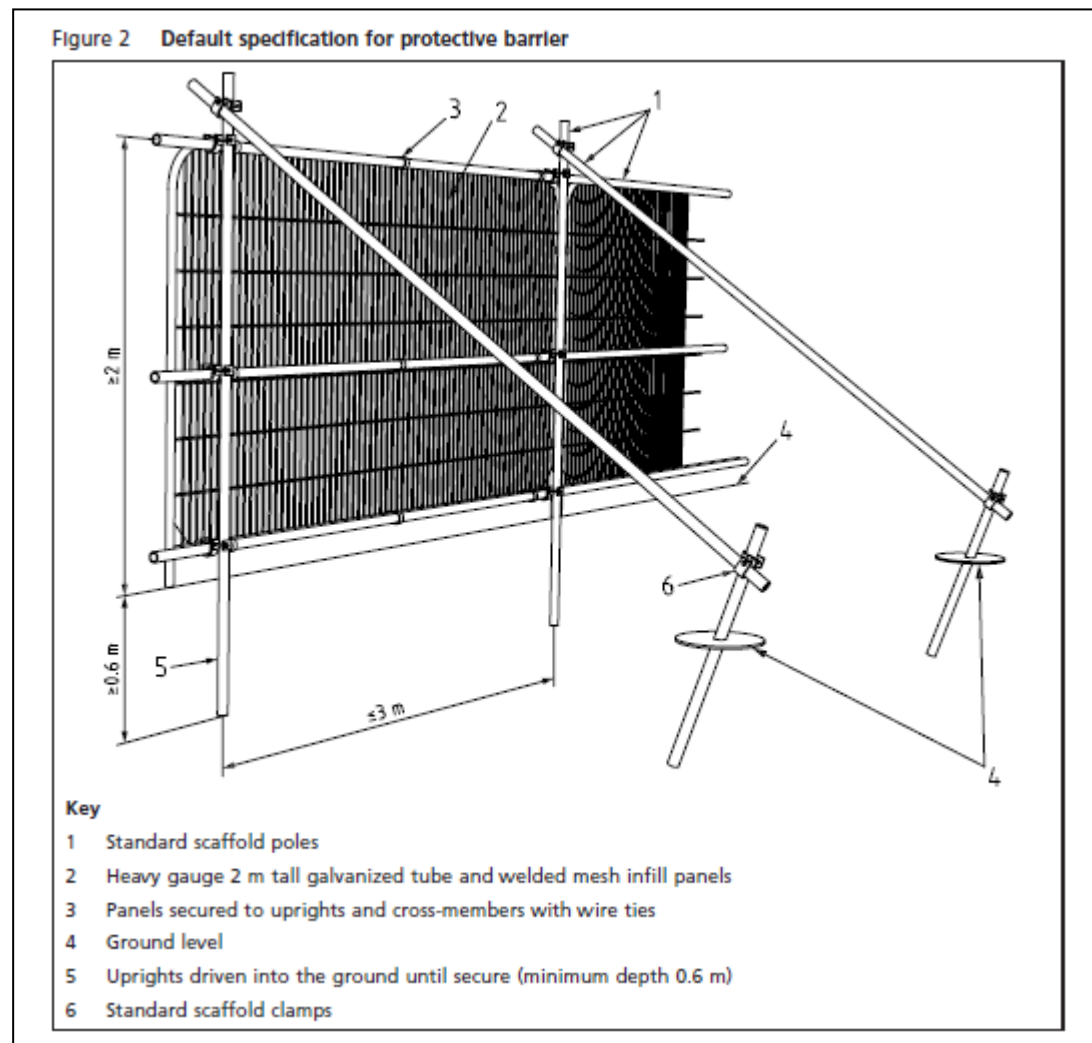

This sign must be displayed on each panel of the protective fencing



### Appendix 3: Arboricultural Site Monitoring Form

Client contact details:

Site:

Ref:

LPA Tree Officer (if applicable):

Consultant:

Date of inspection:

Accompanied by site manager ☐  
Previous actions complied with ☐

Site currently active ☐

#### INSPECTION DETAILS:

Any signs/evidence within the RPA of:

Ground contamination ☐  
Excavations ☐  
Water run off ☐  
Unauthorised tree works ☐

Changed soil levels ☐  
Material storage ☐  
Ground compaction ☐

If yes to any of the above provide details:

#### CONDITION OF FENCING:

Erected according to approved details ☐  
Fencing in place/intact ☐  
Bracing & clamps in place ☐

Protective signs present ☐  
Upright poles in ground ☐  
Any signs of breach ☐

#### ADDITIONAL NOTES including action taken/required:

Date of next inspection:

Copied to Client ☐ Copied to Site manager ☐ Copied to LPA ☐

Signed – Patrick Prendergast -----

---

## Bucks Plant Care Ltd

18<sup>th</sup> October 2022

[www.bucksplantcare.co.uk](http://www.bucksplantcare.co.uk)

Phone : 01844 761206

Mobile : 07952 338564

E-mail: [Patrickprendergast@bucksplantcare.co.uk](mailto:Patrickprendergast@bucksplantcare.co.uk)

