

NOTES

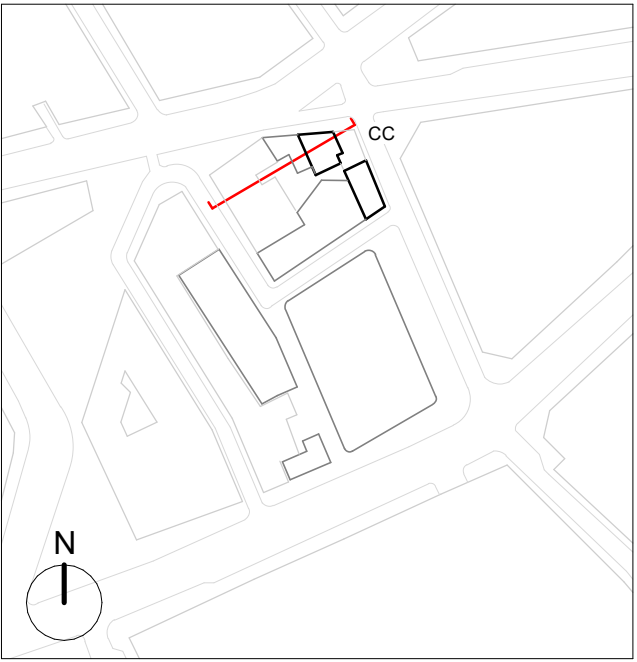

GENERAL NOTES:

Existing drawings are for The internal layouts within commercial floor space, residential apartments and ancillary areas of buildings are indicative and will be subject to design development.

The precise location of walls, internal doors, columns, risers and the detailed layout of office, bathroom and kitchen areas will be the subject of nonmaterial changes and may vary from the internal layouts set out in these plans.

These minor alterations will not affect the position and arrangements of external doors and windows nor will they affect the relative relationship between habitable rooms and windows.

Landscape proposals are indicative only.

Plant layouts are indicative only.

All materials shown or highlighted are indicative only and may be subject to changes made during detailed design development.

only - not for approval.



West Central Street 45 New Oxford Street 43 New Oxford Street 41-39 New Oxford Street Site Extends (37-35 New Oxford Street) The Old Crown Public House Museum Street

1 West Central Street - Proposed Section CC
1 : 100

- 24.05.23 IM Issued for Listed Building Consent

PLANNING

| rev | date | author / check | comments |
|--|------|---|----------|
| DSDHA 357 Kennington Lane London SE11 5QY T 020 7703 3555 F 020 7703 3890 E info@dsdha.co.uk W www.dsdha.co.uk | | | |
| project | | | |
| 10-12 Museum Street and 35-37 New Oxford Street | | | |
| London, WC1A 1JR | | | |
| drawing title | | | |
| Proposed Section CC | | | |
| drawn | size | date | scale |
| MA | A1 | 24/05/23 | 1 : 100 |
| drawing number | | | revision |
| 295B_P40.132 | | | - |
| REPORT DISCREPANCIES DO NOT SCALE FROM THIS DRAWING COPYRIGHT DSDHA | | USE LATEST REVISION CHECK DIMENSIONS ON SITE | |

