

NOTES

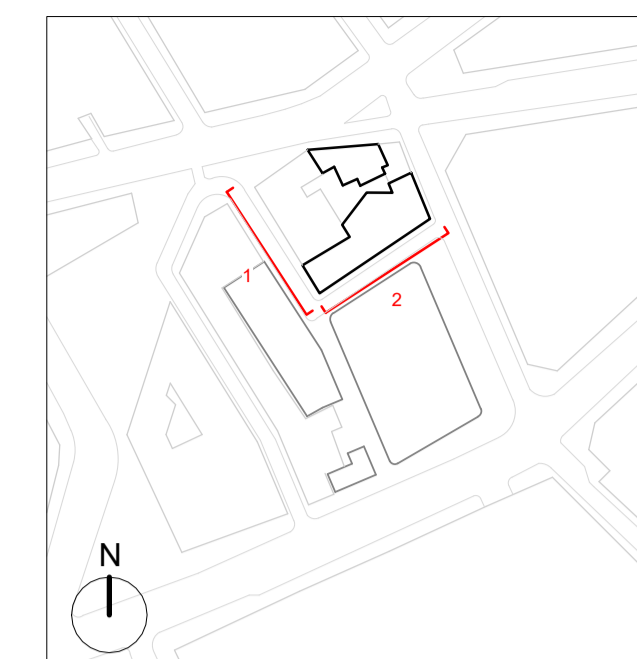

GENERAL NOTES:

Planning Boundary shown is intended to align with proposed West End Project kerb extents along High Holborn. Post-submission amendment to as-built kerb line may be required.

The internal layouts within office floor space, residential apartments and ancillary areas of buildings are indicative and will be subject to design development.

The precise location of walls, internal doors, columns, risers and the detailed layout of office, bathroom and kitchen areas will be the subject of non-material changes and may vary from the internal layouts set out in these plans.

These minor alterations will not affect the position and arrangements of external doors and windows nor will they affect the relative relationship between habitable rooms and windows.

Landscape proposals are indicative only, refer to Landscape drawings for details.

Plant layouts are indicative only.

All materials shown or highlighted are indicative only and may be subject to changes made during detailed design development.

Museum Street landscape proposals are indicative.

Materials Key

1. Replacement Timber shopfronts
2. Replacement Timber Retail Entrance
3. Timber signage zone
4. Existing windows to be repaired and upgraded thermally to match 33 NOS
5. Existing façade repaired and repainted
6. Existing windows to be repaired and upgraded thermally to match existing
7. Existing windows to be replaced with timber double glazed units
8. Replacement shopfronts
9. Replacement Retail Entrance
10. Replacement Timber Residential Entrance
11. Timber door
12. Existing windows to be repaired and upgraded thermally to match existing; Existing secondary glazing to the removed and upgraded
13. Bespoke PPC guardrail
14. PPC metalwork, colour varies
15. GRC Cladding
16. Insulated Render System with Deco profiles
17. Curtain walling, colour varies
18. Aluminium Casement Window, colour varies
19. Bespoke PPC Aluminium Louvred Door
20. Brickwork
21. Pre-cast Brick Cornice
22. Brickwork: Corbel Detail
23. Existing Brickwork: repaired and repointed
24. New timber door to access courtyard
25. Metal stair
26. Generator Vents Screen
27. New render to match existing (10-12 Museum Street) East facade
28. New timber window to match existing (11 Museum Street)
29. New Timber Door to Residential Entrance
30. Existing handrails repaired and repainted
31. Existing opening to be infilled in brick, walls made good, rendered and tooled to imitate Ashlar to match existing Museum St façade.

B 24.05.23 IM Issued for Planning  
 A 01.06.22 IM Issued for Planning Addendum  
 - 22.03.21 IM Issued for Planning

# PLANNING

**DSDHA**  
 357 Kennington Lane London SE11 5QY  
 T 020 7703 3555  
 F 020 7703 3890  
 E info@dshda.co.uk  
 W www.dshda.co.uk

project  
**Museum Street and West Central Street**

London, WC1A 1JR

drawing title

WCS - West Central Street Elevations

drawn	size	date	scale
Author	A1	22/03/21	1 : 100
drawing number	revision		

295B\_P30.141 B

REPORT DISCREPANCIES DO NOT SCALE FROM THIS DRAWING COPYRIGHT DSDHA USE LATEST REVISION CHECK DIMENSIONS ON SITE



1 West Central Street - Proposed South West Elevation

1 : 100



2 West Central Street - Proposed South East Elevation

1 : 100

