

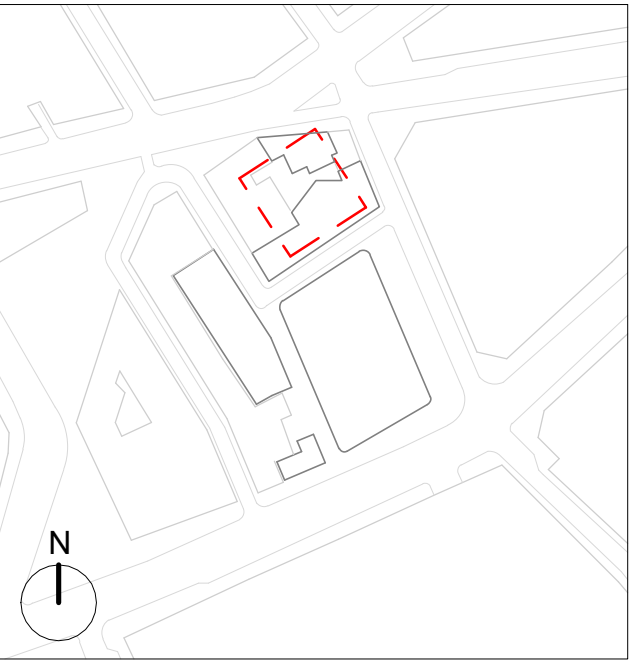

NOTES



**GENERAL NOTES:**

Areas are approximate and subject to change throughout planning, design and development of the proposals

Area measurement definitions have been taken from IPMS but area interpretations should be measured and verified by Quantity Surveyor

- Planning Boundary shown is intended to align with proposed West End Project Kerb extents along High Holborn. Post-submission amendment to as-built kerb line may be required
- Museum Street landscape proposals are indicative only.
- Hatches on the drawings are indicative only
- Existing public realm elements based on survey.
- All dimensions to be verified on site before proceeding.
- Plant layouts are indicative only.
- All materials shown or highlighted are indicative only and may be subject to changes made during detailed design development.
- Planning Boundary shown is intended to align with proposed West End Project Kerb extents along High Holborn, and is based on available information as submitted.

- PAVING**
- PT23 Brick paving (to match building facade specification)
- PT24 Play bark
- FURNITURE**
- F20 Metal planter
- F21 375mm high brick play wall - refer to drawing 3/40.013 for detail
- F22 2.5m high Metal Frame with stainless steel trellis to vent
- F23 2.5m high stainless steel trellis to existing wall
- F24 Timber Bench fixed onto brick wall, refer to drawing 4/40.013 for detail
- F25 Water feature - Metal bird bath
- ST2 Brick Steps to play area (to match building facade specification)
- ST3 Brick Steps (to match building facade specification) , refer to 1/40.013 for detail
- H1 Stainless Steel Handrail
- B1 Metal balustrade to existing building, 2.5m height
- PLAY EQUIPMENT**
- PL1 1M High Stainless Steel Slide
- PL2 Timber Stepping Logs, height varies: 100mm-250mm above ground level
- PL3 Timber Balancing Beam

Refer to BHSLA drawing for soft landscape detail and specification

- Mixed planting (refer to soft landscape drawing for detail proposal)
- Multi-stem large shrub / small tree (refer to soft landscape drawing for detail proposal)
- Slot Drain

A 24.05.23 IM Issued for Planning  
- 22.03.21 CG Issued for Planning

PLANNING

rev	date	author / check	comments
<b>DSDHA</b>			
357 Kennington Lane London SE11 5QY			
T 020 7703 3555			
F 020 7703 3890			
E info@dshdha.co.uk			
W www.dshdha.co.uk			
project			
<b>Museum Street and West Central Street</b>			
London, WC1A 1JR			
drawing title			
<b>WCS - Level 1 Landscape Plan</b>			
drawn	size	date	scale
Author	A1	22/03/21	As indicated
drawing number			revision
295 B_P20.121			A
REPORT DISCREPANCIES DO NOT SCALE FROM THIS DRAWING COPYRIGHT DSDHA		USE LATEST REVISION CHECK DIMENSIONS ON SITE	