



West Central Street - South West - Proposed Demolition Elevation

1 : 100

2

NOTES

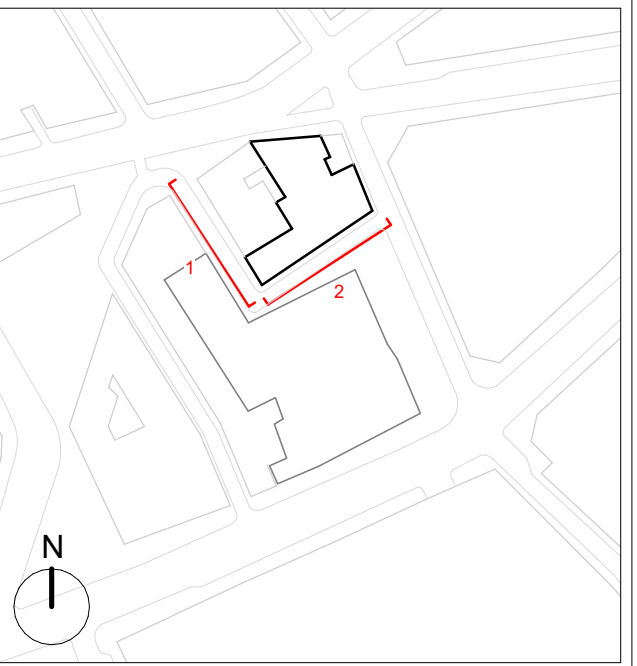

**GENERAL NOTES:**  
Existing drawings are for reference only - not for approval.  
Planning Boundary shown is intended to align with proposed West End Project front extents along High Holborn, and is based on available information as submitted.

**KEY:**

- Planning Boundary
- Extent of Walls Demolition
- Extent of Demolition
- Extent of Existing Strip-out  
\* Modern fixtures and fittings are to be removed  
\*\* Modern floor finishes as part of strip-out, however existing slab structure to be retained except where noted.  
\*\*\* Historic details to be retained
- Extent of Existing Strip-Out
- Extent of demolition/strip-out is unclear: further site investigations are required
- Existing structure removed and replaced
- Existing structure to be retained and repaired subject to further investigations
- Existing structural opening closed
- Existing window/door frame removed and replaced
- Existing windows to be deglazed, repaired and fitted with vacuum glazing; glazing bars to be added to match 33 New Oxford Street
- Existing windows to be deglazed, repaired and fitted with vacuum glazing; Existing secondary glazing to be removed and replaced/upgraded

B 24.05.23 IM Issued for Planning  
A 01.06.22 IM Issued for Planning Addendum  
- 22.03.21 IM Issued for Planning

# PLANNING

rev	date	author / check	comments
<b>DSDHA</b>			
357 Kennington Lane London SE11 5QY			
T 020 7703 3555			
F 020 7703 3890			
E info@dshda.co.uk			
W www.dshda.co.uk			
project			
<b>Museum Street and West Central Street</b>			
London, WC1A 1JR			
drawing title			
<b>WCS - Demolition Elevations - West Central Street</b>			
drawn	size	date	scale
Author	A1	22/03/21	1 : 100
drawing number			revision
295B_P10.401			B
REPORT DISCREPANCIES DO NOT SCALE FROM THIS DRAWING COPYRIGHT DSDHA		USE LATEST REVISION CHECK DIMENSIONS ON SITE	

**DSDHA**  
357 Kennington Lane London SE11 5QY  
T 020 7703 3555  
F 020 7703 3890  
E info@dshda.co.uk  
W www.dshda.co.uk

project  
**Museum Street and West Central Street**

London, WC1A 1JR

drawing title

**WCS - Demolition Elevations - West Central Street**

drawn	size	date	scale
Author	A1	22/03/21	1 : 100
drawing number			revision
295B_P10.401			B
REPORT DISCREPANCIES DO NOT SCALE FROM THIS DRAWING COPYRIGHT DSDHA		USE LATEST REVISION CHECK DIMENSIONS ON SITE	

drawn	size	date	scale
Author	A1	22/03/21	1 : 100
drawing number			revision
295B_P10.401			B
REPORT DISCREPANCIES DO NOT SCALE FROM THIS DRAWING COPYRIGHT DSDHA		USE LATEST REVISION CHECK DIMENSIONS ON SITE	

drawn	size	date	scale
Author	A1	22/03/21	1 : 100
drawing number			revision
295B_P10.401			B
REPORT DISCREPANCIES DO NOT SCALE FROM THIS DRAWING COPYRIGHT DSDHA		USE LATEST REVISION CHECK DIMENSIONS ON SITE	

drawn	size	date	scale
Author	A1	22/03/21	1 : 100
drawing number			revision
295B_P10.401			B
REPORT DISCREPANCIES DO NOT SCALE FROM THIS DRAWING COPYRIGHT DSDHA		USE LATEST REVISION CHECK DIMENSIONS ON SITE	

drawn	size	date	scale
Author	A1	22/03/21	1 : 100
drawing number			revision
295B_P10.401			B
REPORT DISCREPANCIES DO NOT SCALE FROM THIS DRAWING COPYRIGHT DSDHA		USE LATEST REVISION CHECK DIMENSIONS ON SITE	

drawn	size	date	scale
Author	A1	22/03/21	1 : 100
drawing number			revision
295B_P10.401			B
REPORT DISCREPANCIES DO NOT SCALE FROM THIS DRAWING COPYRIGHT DSDHA		USE LATEST REVISION CHECK DIMENSIONS ON SITE	

drawn	size	date	scale
Author	A1	22/03/21	1 : 100
drawing number			revision
295B_P10.401			B
REPORT DISCREPANCIES DO NOT SCALE FROM THIS DRAWING COPYRIGHT DSDHA		USE LATEST REVISION CHECK DIMENSIONS ON SITE	



West Central Street - South East - Proposed Demolition Elevation

1 : 100

1

